

VENTILATION AUDIT REPORT

SCHOOL:	Kandos Public School (2254)
AMU REGION:	North Western NSW
STATE ELECTORATE:	Bathurst
LOCAL GOVERNMENT AREA:	Mid-Western

2254 - Kandos Public School
Site Plan (11754)

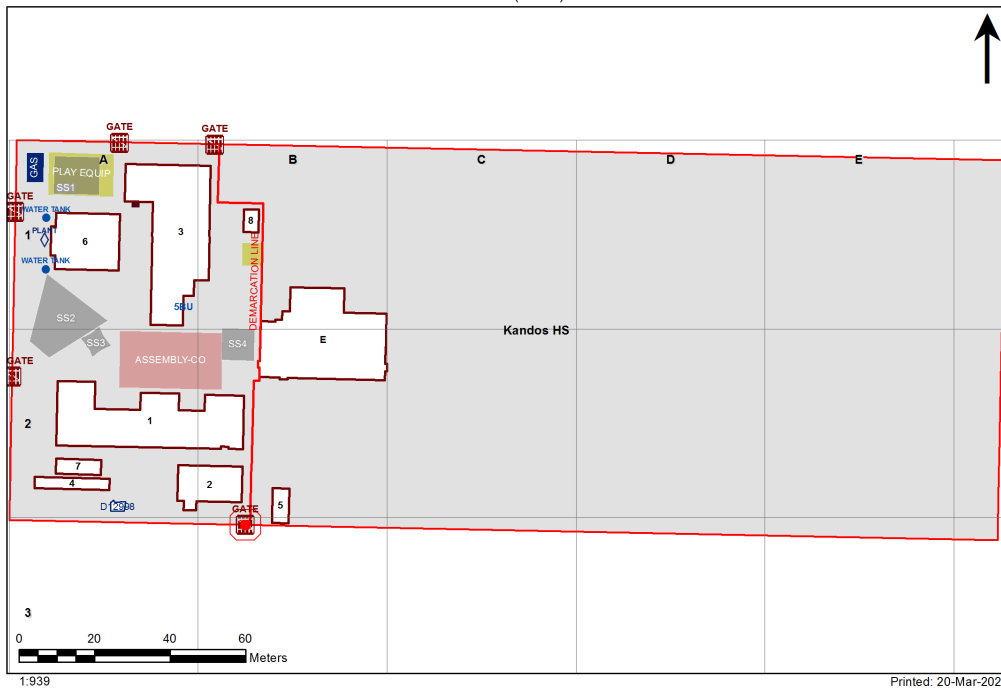

Ventilation Audit Key

Category	Description
	Category A Operate this space in line with COVID safe school operations . It has the required level of natural ventilation. NB. Circulation and storage areas should not be used for groups or gatherings.
	Category B This space should be occupied at 1 person per 4m ² to comply with COVID safe school operations and the guided use of spaces . The report details the number of people who can be accommodated safely in each of the identified spaces.

Entity Location	Audit Condition Classification (Capacity)	Comment
B001 - R0005 - Special Programs Room - (46.24 SQM)	● Student Space (21)	
B001 - R0007 - Home Base - (44.85 SQM) - Teaching Space: 1	● Student Space (20)	
B001 - R0008 - Home Base - (45.19 SQM) - Teaching Space: 1	● Student Space (20)	
B001 - R0009 - Home Base - M - (45.12 SQM) - Teaching Space: 1	● Student Space (20)	
B001 - R0011 - Movement - (13.46 SQM)	Not Applicable	Circulation or storage space.
B001 - R0012 - Movement - (73.54 SQM)	Not Applicable	Circulation or storage space.
B001 - R0016 - Staff Room - (32.2 SQM)	● Office (8)	
B001 - R0018 - Seminar/Study - (13.14 SQM)	● Office (3)	
B001 - R0019 - Sick Bay - (5.31 SQM)	● Student Space (2)	
B001 - R0020 - Principal - (14.41 SQM)	● Office (3)	
B001 - R0021 - Duplicating Workroom - (16.08 SQM)	● Office (4)	
B001 - R0022 - Clerical Office - (13.47 SQM)	● Office (3)	
B001 - R0023 - Interview - (11.84 SQM)	● Office (2)	
B001 - R0024 - Deputy Principal - (11.8 SQM)	● Office (2)	
B001 - R0026 - Movement - (25.45 SQM)	Not Applicable	Circulation or storage space.
B001 - R0029 - Movement - (17.7 SQM)	Not Applicable	Circulation or storage space.
B001 - R0030 - Home Base - (41.92 SQM) - Teaching Space: 1	● Student Space (19)	
B001 - R0031 - Staff Kitchen - (10.84 SQM)	● Office (2)	
B001 - R0032 - Staff Room - (34.16 SQM)	● Office (8)	
B002 - R0001 - Withdrawal Space - 1hb - (11.32 SQM)	● Student Space (5)	
B002 - R0003 - Movement - (11.43 SQM)	Not Applicable	Circulation or storage space.
B002 - R0004 - Movement - (11.72 SQM)	Not Applicable	Circulation or storage space.
B002 - R0007 - Home Base - (46.17 SQM) - Teaching Space: 1	● Student Space (21)	
B002 - R0008 - Home Base - (41.34 SQM) - Teaching Space: 1	● Student Space (19)	
B003 - R0006 - Home Base - (78.91 SQM) - Teaching Space: 1	● Student Space (36)	
B003 - R0007 - Home Base - (56.29 SQM) - Teaching Space: 1	● Student Space (26)	
B003 - R0010 - Deputy Principal - (13.33 SQM)	● Office (3)	
B003 - R0012 - Movement - (37.98 SQM)	Not Applicable	Circulation or storage space.
B003 - R0015 - Withdrawal Space - 1hb - (17.25 SQM)	● Student Space (8)	
B003 - R0016 - Home Base - (59.18 SQM) - Teaching Space: 1	● Student Space (27)	
B003 - R0018 - Home Base - (67.13 SQM) - Teaching Space: 1	● Student Space (31)	
B003 - R0026 - Practical Activities - 1hb - (5.06 SQM)	● Student Space (2)	
B006 - R0003 - Reading Area - (163.64 SQM)	● Student Space (75)	