

VENTILATION AUDIT REPORT

SCHOOL:	James Ruse Agricultural High School (8235)
AMU REGION:	Western Sydney
STATE ELECTORATE:	Parramatta
LOCAL GOVERNMENT AREA:	Parramatta

8235 - James Ruse Agricultural High School
Site Plan (11674)

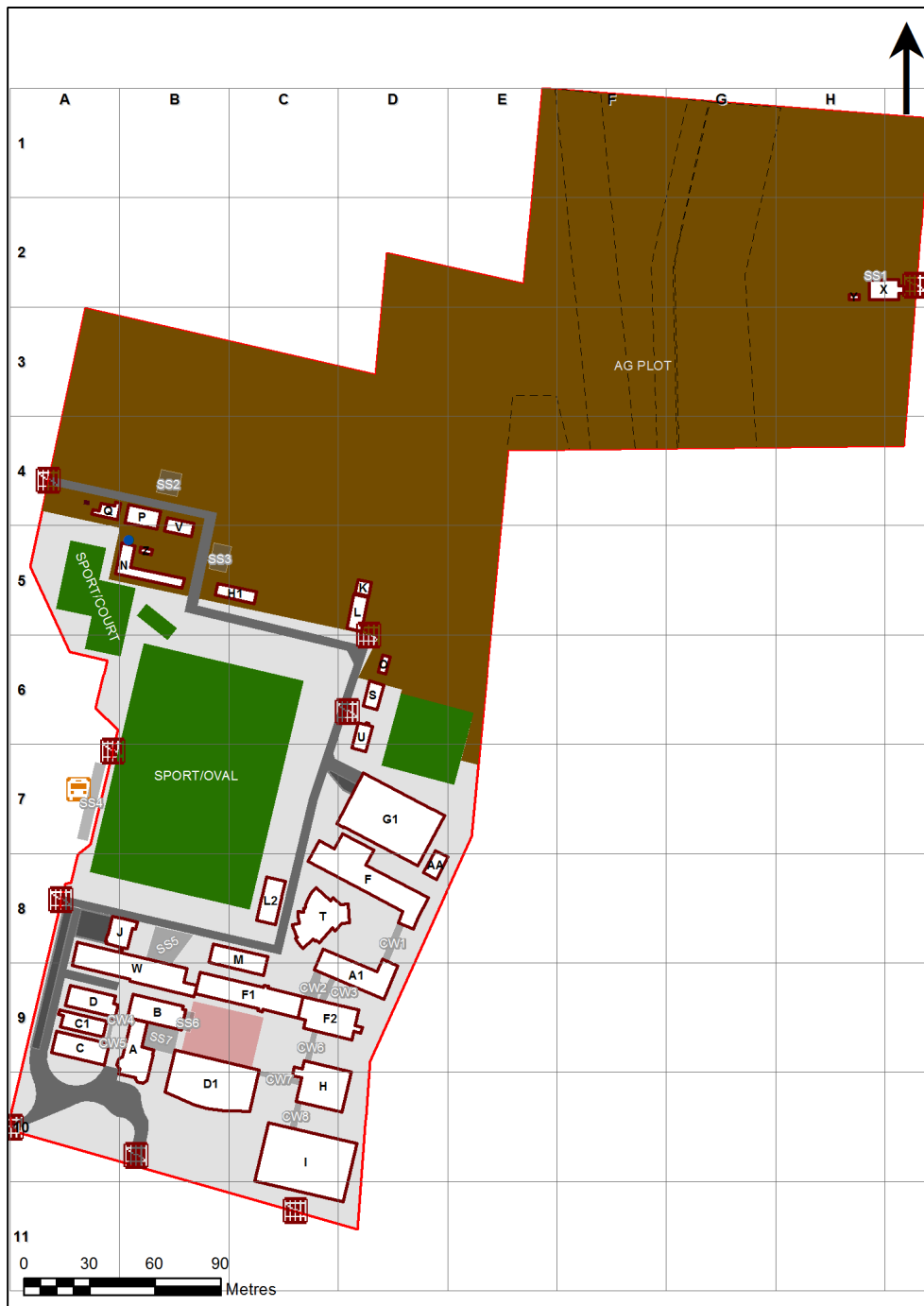

1:2,167

Printed: 15-Dec-2020









Ventilation Audit Key

Category	Description
	Category A Operate this space in line with COVID safe school operations . It has the required level of natural ventilation. NB. Circulation and storage areas should not be used for groups or gatherings.
	Category B This space should be occupied at 1 person per 4m ² to comply with COVID safe school operations and the guided use of spaces . The report details the number of people who can be accommodated safely in each of the identified spaces.

Entity Location	Audit Condition Classification (Capacity)	Comment
B00A - R0003 - Administration - Clerical - (19.28 SQM)	Office (4)	
B00A - R0005 - Movement - (19.71 SQM)	Not Applicable	Circulation or storage space.
B00A - R0006 - Movement - (8.71 SQM)	Not Applicable	Circulation or storage space.
B00A - R0008 - Ancillary Staff - (19.34 SQM)	Office (4)	
B00A - R0009 - Administration - Clerical - (29.92 SQM)	Office (7)	
B00A - R0010 - Movement - (17.28 SQM)	Not Applicable	Circulation or storage space.
B00A - R0011 - Movement - (18.71 SQM)	Not Applicable	Circulation or storage space.
B00A - R0014 - Deputy Principal Office - (22.85 SQM)	Office (5)	
B00A - R0017 - Principal Office - (29.49 SQM)	Office (7)	
B00A - R1002 - Interview/Office - Type 1 - (9.18 SQM)	Office (2)	
B00A - R1003 - Seminar - (14.69 SQM)	Office (3)	
B00A - R1006 - Movement - (29.19 SQM)	Not Applicable	Circulation or storage space.
B00A - R1008 - Commonroom - (29.92 SQM)	Office (7)	
B00A - R1009 - Movement - (17.28 SQM)	Not Applicable	Circulation or storage space.
B00A - R1011 - Commonroom - (62.26 SQM)	Office (15)	
B00B - R0006 - Duplicating Workroom - (61.17 SQM)	Office (15)	
B00B - R0008 - Senior Seminar - (60.44 SQM)	Office (15)	
B00B - R0010 - General Learning Space - (52.86 SQM) - Teaching Space: 1	Student Space (24)	
B00B - R0013 - General Learning Space - (50.88 SQM) - Teaching Space: 1	Student Space (23)	
B00C - R0002 - Movement - (52.7 SQM)	Not Applicable	Circulation or storage space.
B00C - R0003 - Laboratory L.S. - (46.74 SQM) - Teaching Space: 1	Student Space (21)	
B00C - R0004 - Staff Study - (14.58 SQM)	Office (3)	
B00C - R0005 - Preparation - (24.99 SQM)	Not Applicable	Circulation or storage space.
B00C - R0006 - Laboratory L.S. - (89.47 SQM) - Teaching Space: 1	Student Space (41)	
B00D - R0002 - Practice/Seminar - (8.79 SQM)	Not Applicable	Circulation or storage space.
B00D - R0003 - Practice/Seminar - (8.92 SQM)	Not Applicable	Circulation or storage space.
B00D - R0004 - Practice/Seminar - (8.86 SQM)	Not Applicable	Circulation or storage space.
B00D - R0005 - Movement - (15.27 SQM)	Not Applicable	Circulation or storage space.
B00D - R0006 - Staff Study - (11.5 SQM)	Office (2)	
B00D - R0007 - Practice/Seminar - (11.42 SQM)	Not Applicable	Circulation or storage space.
B00D - R0011 - Movement - (9.01 SQM)	Not Applicable	Circulation or storage space.
B00D - R0012 - Music Learning Space - (127.53 SQM) - Teaching Space: 1	Student Space (59)	
B00F - R0001 - Computer Learning Space - (70.34 SQM) - Teaching Space: 1	Student Space (32)	
B00F - R0006 - General Learning Space - (66.68 SQM) - Teaching Space: 1	Student Space (30)	
B00F - R0008 - Materials Technology L.S. - (120.36 SQM) - Teaching Space: 1	Student Space (55)	
B00F - R0012 - Welding/Hot Metals Area - (6.1 SQM)	Not Applicable	Circulation or storage space.
B00F - R0013 - Metal Technology L.S. - (107.38 SQM) - Teaching Space: 1	Student Space (49)	
B00F - R0015 - General Learning Space - (67.53 SQM) - Teaching Space: 1	Student Space (31)	
B00F - R0016 - Movement - (156.97 SQM)	Not Applicable	Circulation or storage space.
B00F - R1001 - General Learning Space - (59.39 SQM) - Teaching Space: 1	Student Space (27)	
B00F - R1002 - Staff Study - (33.22 SQM)	Office (8)	
B00F - R1005 - General Learning Space - (58.93 SQM) - Teaching Space: 1	Student Space (27)	
B00F - R1007 - General Learning Space - (59.02 SQM) - Teaching Space: 1	Student Space (27)	
B00F - R1008 - General Learning Space - (59.93 SQM) - Teaching Space: 1	Student Space (27)	
B00F - R1009 - Staff Study - (24.66 SQM)	Office (6)	
B00F - R1010 - Computer Learning Space - (60.02 SQM) - Teaching Space: 1	Student Space (27)	
B00F - R1011 - General Learning Space - (59.24 SQM) - Teaching Space: 1	Student Space (27)	
B00F - R1012 - Movement - (158.25 SQM)	Not Applicable	Circulation or storage space.
B00H - R0003 - Laboratory L.S. - (92.65 SQM) - Teaching Space: 1	Student Space (42)	
B00H - R0006 - Movement - (13.01 SQM)	Not Applicable	Circulation or storage space.

Entity Location	Audit Condition Classification (Capacity)	Comment
B00H - R0008 - Preparation - (48.4 SQM)	Not Applicable	Circulation or storage space.
B00H - R0012 - Staff Study - (58.96 SQM)	Office (14)	
B00H - R0013 - Movement - (41.98 SQM)	Not Applicable	Circulation or storage space.
B00H - R0015 - Science Laboratory - (86.92 SQM)	Student Space (40)	
B00H - R1005 - Preparation - (29.06 SQM)	Not Applicable	Circulation or storage space.
B00H - R1013 - Laboratory L.S. - (100.19 SQM) - Teaching Space: 1	Student Space (46)	
B00H - R1014 - Laboratory L.S. - (100.39 SQM) - Teaching Space: 1	Student Space (46)	
B00H - R1018 - Movement - (25.68 SQM)	Not Applicable	Circulation or storage space.
B00H - R1019 - Movement - (32.38 SQM)	Not Applicable	Circulation or storage space.
B00I - R0003 - Movement - (16 SQM)	Not Applicable	Circulation or storage space.
B00I - R0007 - Stage - (67.8 SQM)	Not Applicable	Circulation or storage space.
B00I - R0008 - Movement - (67.86 SQM)	Not Applicable	Circulation or storage space.
B00I - R0012 - Movement - (16 SQM)	Not Applicable	Circulation or storage space.
B00I - R0013 - Staff Kitchen - (16.07 SQM)	Office (4)	
B00I - R0017 - Multi-Purpose Space - (484.06 SQM)	Student Space (224)	
B00I - R0018 - Movement - (202.29 SQM)	Not Applicable	Circulation or storage space.
B00J - R0001 - General Assistants - (21.06 SQM)	Office (5)	
B00J - R1001 - General Learning Space - (58.54 SQM) - Teaching Space: 1	Student Space (27)	
B00M - R0008 - Staff Study - (25.84 SQM)	Office (6)	
B00M - R0014 - Staff Study - (13.52 SQM)	Office (3)	
B00M - R0015 - Movement - (46.6 SQM)	Not Applicable	Circulation or storage space.
B00N - R0007 - Staff Study - (10.62 SQM)	Office (2)	
B00P - R0001 - Movement - (25.7 SQM)	Not Applicable	Circulation or storage space.
B00P - R0003 - General Learning Space - (78.74 SQM) - Teaching Space: 1	Student Space (36)	
B00Q - R0004 - Ancillary Staff - (13.37 SQM)	Office (3)	
B00T - R0002 - Tiered Learning Area - (247.19 SQM)	Student Space (114)	
B00T - R0004 - Movement - (35.99 SQM)	Not Applicable	Circulation or storage space.
B00T - R0007 - Staff Kitchen - (12.81 SQM)	Office (3)	
B00W - R0001 - Duplicating Workroom - (42.03 SQM)	Office (10)	
B00W - R0002 - Administration - Clerical - (10.05 SQM)	Office (2)	
B00W - R0005 - Movement - (14.73 SQM)	Not Applicable	Circulation or storage space.
B00W - R0006 - Clinic - Girls - (9.89 SQM)	Office (2)	
B00W - R0007 - Clinic - Boys - (8.61 SQM)	Office (2)	
B00W - R0010 - Student Canteen - (33.28 SQM)	Not Applicable	Circulation or storage space.
B00W - R0011 - Student Canteen - (60.01 SQM)	Not Applicable	Circulation or storage space.
B00W - R0013 - Movement - (37.54 SQM)	Not Applicable	Circulation or storage space.
B00W - R0017 - Movement - (69.66 SQM)	Not Applicable	Circulation or storage space.
B00W - R0018 - Movement - (43.78 SQM)	Not Applicable	Circulation or storage space.
B00X - R0002 - Seminar - (52.41 SQM)	Office (13)	
B00X - R0005 - Staff Lounge - (13.69 SQM)	Office (3)	
B00X - R0006 - Staff Kitchen - (10.28 SQM)	Office (2)	
B00X - R0008 - Movement - (8.33 SQM)	Not Applicable	Circulation or storage space.
B0A1 - R0002 - Art Learning Space - (58.77 SQM) - Teaching Space: 1	Student Space (27)	
B0A1 - R0004 - Art Learning Space - (50.68 SQM) - Teaching Space: 1	Student Space (23)	
B0A1 - R0005 - General Learning Space - (60.23 SQM) - Teaching Space: 1	Student Space (27)	
B0A1 - R0006 - Staff Study - (23.6 SQM)	Office (5)	
B0A1 - R0012 - Movement - (122.24 SQM)	Not Applicable	Circulation or storage space.
B0A1 - R1001 - Darkroom Space - (29.01 SQM)	Office (7)	
B0A1 - R1002 - General Learning Space - (46.96 SQM) - Teaching Space: 1	Student Space (21)	
B0A1 - R1003 - General Learning Space - (46.97 SQM) - Teaching Space: 1	Student Space (21)	

Entity Location	Audit Condition Classification (Capacity)	Comment
B0A1 - R1004 - General Learning Space - (45.05 SQM) - Teaching Space: 1	● Student Space (20)	
B0A1 - R1005 - Study Space - (16.31 SQM)	Not Applicable	Circulation or storage space.
B0A1 - R1008 - Movement - (103.74 SQM)	Not Applicable	Circulation or storage space.
B0AA - R0001 - General Assistants - (67.28 SQM)	● Office (16)	
B0C1 - R0002 - Staff Study - (10.2 SQM)	● Office (2)	
B0C1 - R0003 - Staff Kitchen - (5.24 SQM)	● Office (1)	
B0C1 - R0006 - Music Learning Space - (119.73 SQM) - Teaching Space: 1	● Student Space (55)	
B0D1 - R0004 - Movement - (77.12 SQM)	Not Applicable	Circulation or storage space.
B0D1 - R0005 - General Learning Space - (46.47 SQM) - Teaching Space: 1	● Student Space (21)	
B0D1 - R0006 - General Learning Space - (53.3 SQM) - Teaching Space: 1	● Student Space (24)	
B0D1 - R0007 - Commonroom - (98.7 SQM)	● Office (24)	
B0D1 - R0008 - Staff Study - (33.73 SQM)	● Office (8)	
B0D1 - R0009 - General Learning Space - (46.13 SQM) - Teaching Space: 1	● Student Space (21)	
B0D1 - R0014 - Movement - (25.03 SQM)	Not Applicable	Circulation or storage space.
B0D1 - R0015 - Interview/Office - Type 1 - (12.74 SQM)	● Office (3)	
B0D1 - R0018 - General Learning Space - (49.74 SQM) - Teaching Space: 1	● Student Space (23)	
B0D1 - R0019 - General Learning Space - (49.52 SQM) - Teaching Space: 1	● Student Space (22)	
B0D1 - R0022 - Interview/Office - Type 1 - (12.58 SQM)	● Office (3)	
B0D1 - R0023 - Movement - (25 SQM)	Not Applicable	Circulation or storage space.
B0D1 - R0024 - Movement - (95.75 SQM)	Not Applicable	Circulation or storage space.
B0D1 - R0029 - Movement - (37.84 SQM)	Not Applicable	Circulation or storage space.
B0D1 - R1001 - Interview/Office - Type 1 - (13 SQM)	● Office (3)	
B0D1 - R1003 - Senior Study - (60.47 SQM)	● Office (15)	
B0D1 - R1004 - Main Area - (378.9 SQM)	Not Applicable	Circulation or storage space.
B0D1 - R1005 - Study Space - (60.6 SQM)	Not Applicable	Circulation or storage space.
B0D1 - R1006 - Seminar - (12.97 SQM)	● Office (3)	
B0D1 - R1007 - Seminar - (13.04 SQM)	● Office (3)	
B0D1 - R1010 - Staff Study - (22.61 SQM)	● Office (5)	
B0D1 - R1014 - Movement - (140.64 SQM)	Not Applicable	Circulation or storage space.
B0F1 - R0002 - Laboratory L.S. - (67.92 SQM) - Teaching Space: 1	● Student Space (31)	
B0F1 - R0003 - Staff Study - (8.64 SQM)	● Office (2)	
B0F1 - R0004 - Preparation - (17.29 SQM)	Not Applicable	Circulation or storage space.
B0F1 - R0006 - Laboratory L.S. - (93.85 SQM) - Teaching Space: 1	● Student Space (43)	
B0F1 - R0007 - Movement - (103.05 SQM)	Not Applicable	Circulation or storage space.
B0F1 - R0008 - Movement - (22.89 SQM)	Not Applicable	Circulation or storage space.
B0F1 - R0010 - General Learning Space - (101.8 SQM) - Teaching Space: 1	● Student Space (47)	
B0F1 - R1002 - Shared Study Space - (26.57 SQM)	● Office (6)	
B0F1 - R1003 - General Learning Space - (52.94 SQM) - Teaching Space: 1	● Student Space (24)	
B0F1 - R1004 - General Learning Space - (52.94 SQM) - Teaching Space: 1	● Student Space (24)	
B0F1 - R1005 - General Learning Space - (52.94 SQM) - Teaching Space: 1	● Student Space (24)	
B0F1 - R1006 - General Learning Space - (53.31 SQM) - Teaching Space: 1	● Student Space (24)	
B0F1 - R1007 - General Learning Space - (52.57 SQM) - Teaching Space: 1	● Student Space (24)	
B0F1 - R1008 - Movement - (102.26 SQM)	Not Applicable	Circulation or storage space.
B0F2 - R0002 - Laboratory L.S. - (88.46 SQM) - Teaching Space: 1	● Student Space (41)	
B0F2 - R0006 - Movement - (7.97 SQM)	Not Applicable	Circulation or storage space.
B0F2 - R0010 - Movement - (30.08 SQM)	Not Applicable	Circulation or storage space.
B0F2 - R0011 - Preparation - (16.58 SQM)	Not Applicable	Circulation or storage space.
B0F2 - R0012 - Computer Learning Space - (35.66 SQM) - Teaching Space: 1	● Student Space (16)	
B0F2 - R0015 - Movement - (109.97 SQM)	Not Applicable	Circulation or storage space.

Entity Location	Audit Condition Classification (Capacity)	Comment
B0F2 - R1011 - General Learning Space - (55.95 SQM) - Teaching Space: 1	 Student Space (25)	
B0F2 - R1012 - Staff Study - (45.39 SQM)	 Office (11)	
B0F2 - R1013 - Movement - (106.82 SQM)	Not Applicable	Circulation or storage space.
B0F2 - R1015 - General Learning Space - (53.02 SQM) - Teaching Space: 1	 Student Space (24)	
B0F2 - R2001 - General Learning Space - (55.72 SQM) - Teaching Space: 1	 Student Space (25)	
B0F2 - R2002 - General Learning Space - (52.37 SQM) - Teaching Space: 1	 Student Space (24)	
B0F2 - R2005 - General Learning Space - (66.79 SQM) - Teaching Space: 1	 Student Space (30)	
B0F2 - R2008 - Shared Study Space - (26.29 SQM)	 Office (6)	
B0F2 - R2009 - Movement - (71.27 SQM)	Not Applicable	Circulation or storage space.
B0G1 - R0001 - Gymnasium - (644.07 SQM)	 Student Space (298)	
B0G1 - R0011 - Tiered Learning Area - (38.27 SQM)	 Student Space (17)	
BOH1 - R0002 - Movement - (15.1 SQM)	Not Applicable	Circulation or storage space.
BOL2 - R0004 - Movement - (6.4 SQM)	Not Applicable	Circulation or storage space.
BOL2 - R0010 - Movement - (37.87 SQM)	Not Applicable	Circulation or storage space.