

VENTILATION AUDIT REPORT

SCHOOL:	Homebush Boys High School (8151)
AMU REGION:	South Western Sydney
STATE ELECTORATE:	Strathfield
LOCAL GOVERNMENT AREA:	Strathfield

8151 - Homebush Boys High School
Site Plan (11750)

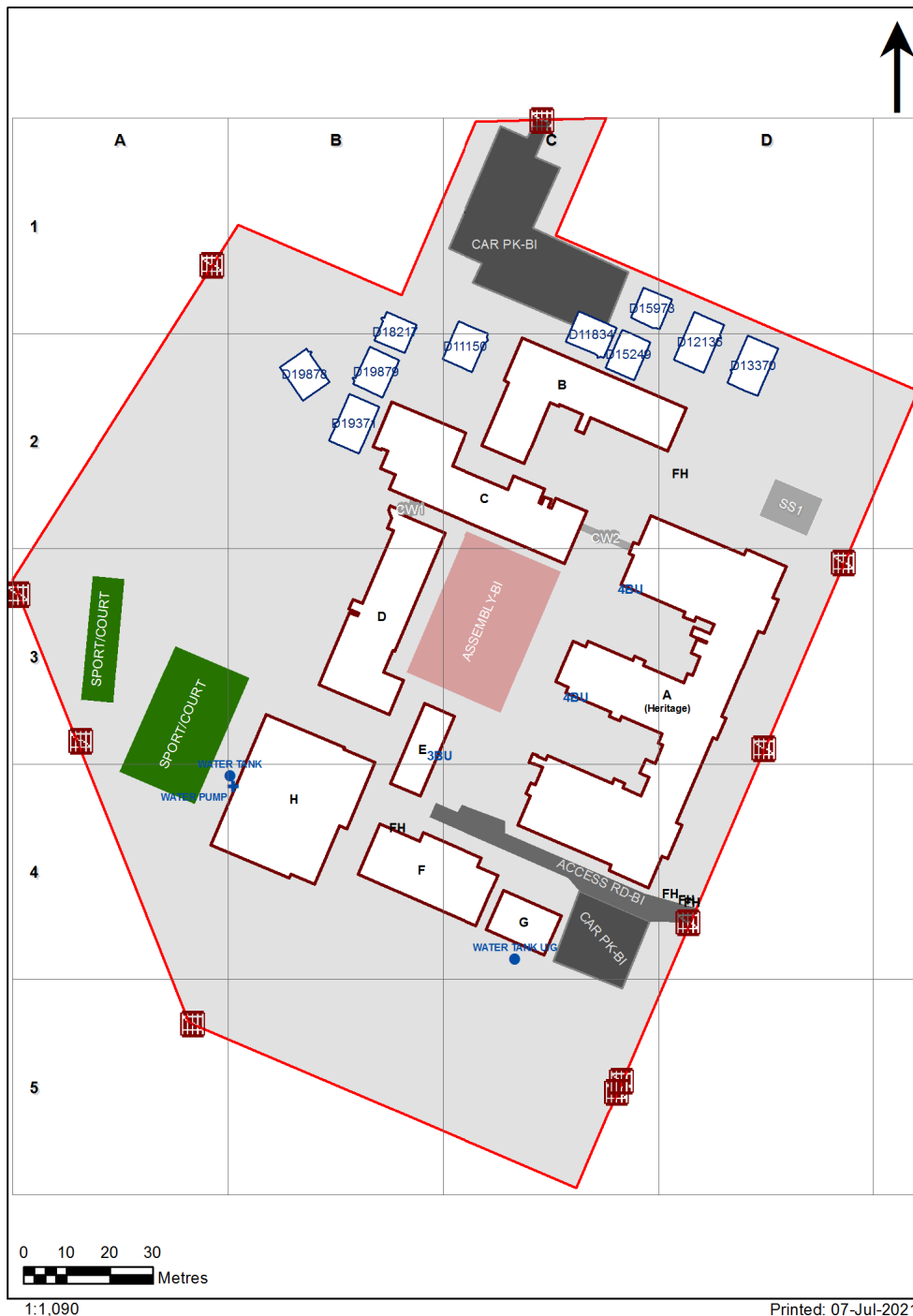

Ventilation Audit Key

Category	Description
	Category A Operate this space in line with COVID safe school operations . It has the required level of natural ventilation. NB. Circulation and storage areas should not be used for groups or gatherings.
	Category B This space should be occupied at 1 person per 4m ² to comply with COVID safe school operations and the guided use of spaces . The report details the number of people who can be accommodated safely in each of the identified spaces.

Entity Location	Audit Condition Classification (Capacity)	Comment
B00A - R0003 - Administration - Executive - (13.24 SQM)	Office (3)	
B00A - R0004 - Principal Office - (21.96 SQM)	Office (5)	
B00A - R0005 - Movement - (15.05 SQM)	Not Applicable	Circulation or storage space.
B00A - R0006 - Duplicating Workroom - (23.06 SQM)	Office (5)	
B00A - R0007 - Administration - Clerical - (51.36 SQM)	Office (12)	
B00A - R0008 - Public Entry - (21.71 SQM)	Not Applicable	Circulation or storage space.
B00A - R0009 - Public Entry - (15.6 SQM)	Not Applicable	Circulation or storage space.
B00A - R0010 - Movement - (5.34 SQM)	Not Applicable	Circulation or storage space.
B00A - R0012 - Commonroom - (78.07 SQM)	Office (19)	
B00A - R0013 - General Learning Space - (52.01 SQM) - Teaching Space: 1	Student Space (24)	
B00A - R0014 - General Learning Space - (62.82 SQM) - Teaching Space: 1	Student Space (29)	
B00A - R0015 - Staff Study - (52.07 SQM)	Office (13)	
B00A - R0016 - General Learning Space - (52.08 SQM) - Teaching Space: 1	Student Space (24)	
B00A - R0017 - General Learning Space - (52.15 SQM) - Teaching Space: 1	Student Space (24)	
B00A - R0018 - General Learning Space - (51.93 SQM) - Teaching Space: 1	Student Space (24)	
B00A - R0020 - General Learning Space - (51.94 SQM) - Teaching Space: 1	Student Space (24)	
B00A - R0021 - General Learning Space - (51.86 SQM) - Teaching Space: 1	Student Space (24)	
B00A - R0024 - Deputy Principal Office - (17.42 SQM)	Office (4)	
B00A - R0027 - Multi-Purpose Space - (241.32 SQM)	Student Space (111)	
B00A - R0028 - Stage - (55.6 SQM)	Not Applicable	Circulation or storage space.
B00A - R0033 - Deputy Principal Office - (16.87 SQM)	Office (4)	
B00A - R0035 - Movement - (14.79 SQM)	Not Applicable	Circulation or storage space.
B00A - R0037 - Laboratory L.S. - (81.37 SQM) - Teaching Space: 1	Student Space (37)	
B00A - R0038 - Preparation - (22.38 SQM)	Not Applicable	Circulation or storage space.
B00A - R0040 - General Learning Space - (51.86 SQM) - Teaching Space: 1	Student Space (24)	
B00A - R0041 - Preparation - (20.5 SQM)	Not Applicable	Circulation or storage space.
B00A - R0042 - Laboratory L.S. - (83.14 SQM) - Teaching Space: 1	Student Space (38)	
B00A - R0043 - Movement - (311.46 SQM)	Not Applicable	Circulation or storage space.
B00A - R0045 - Movement - (16.29 SQM)	Not Applicable	Circulation or storage space.
B00A - R0050 - Deputy Principal Office - (17.54 SQM)	Office (4)	
B00A - R0051 - Movement - (11.16 SQM)	Not Applicable	Circulation or storage space.
B00A - R0052 - Interview/Meeting - (8.63 SQM)	Office (2)	
B00A - R0053 - Interview/Meeting - (5.4 SQM)	Office (1)	
B00A - R0054 - Deputy Principal Office - (17.67 SQM)	Office (4)	
B00A - R0056 - Staff Study - (11.78 SQM)	Office (2)	
B00A - R0057 - Interview/Meeting - (34.13 SQM)	Office (8)	
B00A - R1002 - Staff Study - (53.53 SQM)	Office (13)	
B00A - R1003 - General Learning Space - (64.06 SQM) - Teaching Space: 1	Student Space (29)	
B00A - R1004 - General Learning Space - (52.56 SQM) - Teaching Space: 1	Student Space (24)	
B00A - R1005 - Staff Study - (24.69 SQM)	Office (6)	
B00A - R1006 - General Learning Space - (52.77 SQM) - Teaching Space: 1	Student Space (24)	
B00A - R1007 - General Learning Space - (46.39 SQM) - Teaching Space: 1	Student Space (21)	
B00A - R1009 - General Learning Space - (52.84 SQM) - Teaching Space: 1	Student Space (24)	
B00A - R1010 - Interview/Office - Type 1 - (23.81 SQM)	Office (5)	
B00A - R1012 - General Learning Space - (52.84 SQM) - Teaching Space: 1	Student Space (24)	
B00A - R1013 - Audio Visual Workroom - (58 SQM)	Student Space (26)	
B00A - R1015 - Senior Study - (72.67 SQM)	Office (18)	

Entity Location	Audit Condition Classification (Capacity)	Comment
B00A - R1018 - Main Area - (260.92 SQM)	Not Applicable	Circulation or storage space.
B00A - R1020 - Interview/Office - Type 1 - (15.94 SQM)	Office (3)	
B00A - R1025 - General Learning Space - (52.82 SQM) - Teaching Space: 1	Student Space (24)	
B00A - R1026 - General Learning Space - (53.3 SQM) - Teaching Space: 1	Student Space (24)	
B00A - R1027 - General Learning Space - (52.84 SQM) - Teaching Space: 1	Student Space (24)	
B00A - R1028 - Staff Study - (21.04 SQM)	Office (5)	
B00A - R1029 - General Learning Space - (84.03 SQM) - Teaching Space: 1	Student Space (38)	
B00A - R1030 - Movement - (236.79 SQM)	Not Applicable	Circulation or storage space.
B00A - R9009 - Gymnasium - (51.45 SQM)	Student Space (23)	
B00A - R9014 - General Assistants - (14.24 SQM)	Office (3)	
B00A - R9015 - Student Canteen - (45.73 SQM)	Not Applicable	Circulation or storage space.
B00A - R9016 - Movement - (38.6 SQM)	Not Applicable	Circulation or storage space.
B00B - R0002 - Seminar/Technology Space - (31.71 SQM)	Office (7)	
B00B - R0003 - Design L.S. - (47.6 SQM) - Teaching Space: 1	Student Space (22)	
B00B - R0004 - Metal Technology Bay - (16.13 SQM)	Not Applicable	Circulation or storage space.
B00B - R0005 - Welding Area - (5.53 SQM)	Not Applicable	Circulation or storage space.
B00B - R0006 - Materials Technology L.S. - (83.47 SQM) - Teaching Space: 1	Student Space (38)	
B00B - R0008 - Food Technology L.S. - (87.41 SQM) - Teaching Space: 1	Student Space (40)	
B00B - R0011 - Design L.S. - (52 SQM) - Teaching Space: 1	Student Space (24)	
B00B - R0012 - Staff Study - (11.48 SQM)	Office (2)	
B00B - R0013 - Staff Study - (8.96 SQM)	Office (2)	
B00B - R0014 - Seminar/Technology Space - (35.91 SQM)	Office (8)	
B00B - R0016 - Movement - (82.42 SQM)	Not Applicable	Circulation or storage space.
B00B - R1003 - Materials Technology L.S. - (79.42 SQM) - Teaching Space: 1	Student Space (36)	
B00B - R1004 - Wood Technology Bay - (18.01 SQM)	Not Applicable	Circulation or storage space.
B00B - R1007 - Wood Technology Bay - (17.96 SQM)	Not Applicable	Circulation or storage space.
B00B - R1008 - Materials Technology L.S. - (79.68 SQM) - Teaching Space: 1	Student Space (36)	
B00B - R1010 - Design L.S. - (43.57 SQM) - Teaching Space: 1	Student Space (20)	
B00B - R1011 - Staff Study - (33.77 SQM)	Office (8)	
B00B - R1014 - Movement - (79.1 SQM)	Not Applicable	Circulation or storage space.
B00C - R0009 - Laboratory L.S. - (87.02 SQM) - Teaching Space: 1	Student Space (40)	
B00C - R0010 - Preparation - (9.21 SQM)	Not Applicable	Circulation or storage space.
B00C - R0011 - Preparation - (27.23 SQM)	Not Applicable	Circulation or storage space.
B00C - R0012 - Laboratory L.S. - (86.77 SQM) - Teaching Space: 1	Student Space (40)	
B00C - R0013 - Seminar - (26.38 SQM)	Office (6)	
B00C - R0014 - Staff Study - (37.9 SQM)	Office (9)	
B00C - R0016 - Staff Study - (67.26 SQM)	Office (16)	
B00C - R0018 - Design L.S. - (51.11 SQM) - Teaching Space: 1	Student Space (23)	
B00C - R0020 - Movement - (127.56 SQM)	Not Applicable	Circulation or storage space.
B00C - R1002 - General Learning Space - (51.26 SQM) - Teaching Space: 1	Student Space (23)	
B00C - R1003 - Computer Learning Space - (52.65 SQM) - Teaching Space: 1	Student Space (24)	
B00C - R1008 - Computer Learning Space - (52.65 SQM) - Teaching Space: 1	Student Space (24)	
B00C - R1010 - Staff Study - (51.92 SQM)	Office (12)	
B00C - R1011 - Staff Study - (26.62 SQM)	Office (6)	
B00C - R1012 - Darkroom Space - (18.66 SQM)	Office (4)	
B00C - R1013 - Staff Study - (13.74 SQM)	Office (3)	
B00C - R1016 - Art Learning Space - (67.1 SQM) - Teaching Space: 1	Student Space (31)	
B00C - R1018 - Art Learning Space - (51.2 SQM) - Teaching Space: 1	Student Space (23)	

Entity Location	Audit Condition Classification (Capacity)	Comment
B00C - R1020 - Movement - (118.23 SQM)	Not Applicable	Circulation or storage space.
B00C - R2002 - General Learning Space - (52.65 SQM) - Teaching Space: 1	● Student Space (24)	
B00C - R2003 - General Learning Space - (52.44 SQM) - Teaching Space: 1	● Student Space (24)	
B00C - R2006 - General Learning Space - (52.87 SQM) - Teaching Space: 1	● Student Space (24)	
B00C - R2008 - Art Learning Space - (52.51 SQM) - Teaching Space: 1	● Student Space (24)	
B00C - R2010 - Art Learning Space - (58.8 SQM) - Teaching Space: 1	● Student Space (27)	
B00C - R2012 - Darkroom Space - (21.87 SQM)	○ Office (5)	
B00C - R2014 - Movement - (87.58 SQM)	Not Applicable	Circulation or storage space.
B00D - R0005 - Movement - (277.42 SQM)	Not Applicable	Circulation or storage space.
B00D - R0012 - Staff Study - (25.5 SQM)	○ Office (6)	
B00D - R0015 - Movement - (11.79 SQM)	Not Applicable	Circulation or storage space.
B00D - R1003 - Laboratory L.S. - (86.36 SQM) - Teaching Space: 1	● Student Space (40)	
B00D - R1004 - Preparation - (8.83 SQM)	Not Applicable	Circulation or storage space.
B00D - R1005 - Preparation - (28.23 SQM)	Not Applicable	Circulation or storage space.
B00D - R1006 - Laboratory L.S. - (88.21 SQM) - Teaching Space: 1	● Student Space (40)	
B00D - R1008 - Music Learning Space - (53.45 SQM) - Teaching Space: 1	● Student Space (24)	
B00D - R1010 - Music Learning Space - (54.05 SQM) - Teaching Space: 1	● Student Space (25)	
B00D - R1011 - Movement - (91.83 SQM)	Not Applicable	Circulation or storage space.
B00F - R0001 - Movement - (9.41 SQM)	Not Applicable	Circulation or storage space.
B00F - R0002 - Gymnasium - (348.86 SQM)	● Student Space (161)	
B00F - R0004 - Movement - (9.12 SQM)	Not Applicable	Circulation or storage space.
B00G - R0001 - General Learning Space - (52.44 SQM) - Teaching Space: 1	● Student Space (24)	
B00G - R0002 - General Learning Space - (52.36 SQM) - Teaching Space: 1	● Student Space (24)	
B00G - R0003 - Movement - (36.23 SQM)	Not Applicable	Circulation or storage space.
B00H - R0001 - Gymnasium - (620.59 SQM)	● Student Space (287)	
B00H - R0013 - Staff Kitchen - (8.42 SQM)	○ Office (2)	
B00H - R0014 - Staff Study - (24.96 SQM)	○ Office (6)	
NS 110 10627 - NS 110 10627 - Learning Unit - Single Secondary/Secure - (57 SQM)	● Student Space (26)	
NS 110 15246 - NS 110 15246 - Learning Unit - Single Secondary/Secure - (57 SQM)	● Student Space (26)	
NS 110 15249 - NS 110 15249 - Learning Unit - Single Secondary/Secure - (57 SQM)	● Student Space (26)	
OS 520 18217 - OS 520 18217 - Staff Study - (57 SQM)	○ Office (14)	
OS 600 11540 - OS 600 11540 - Learning Unit - Small - (57 SQM)	● Student Space (26)	
OS 600 13301 - OS 600 13301 - Learning Unit - Small - (57 SQM)	● Student Space (26)	
OS 600 15844 - OS 600 15844 - Learning Unit - Small - (57 SQM)	● Student Space (26)	
OS 600 15973 - OS 600 15973 - Learning Unit - Small - (57 SQM)	● Student Space (26)	
OS 601 11150 - OS 601 11150 - Learning Unit - Standard/Withdrawal - (76 SQM)	● Student Space (35)	
OS 601 11834 - OS 601 11834 - Learning Unit - Standard/Withdrawal - (76 SQM)	● Student Space (35)	
OS 601 12095 - OS 601 12095 - Learning Unit - Standard/Withdrawal - (76 SQM)	● Student Space (35)	
OS 601 19878 - OS 601 19878 - Learning Unit - Standard/Withdrawal - (SQM)	● Student Space ()	
OS 601 19879 - OS 601 19879 - Learning Unit - Standard/Withdrawal - (SQM)	● Student Space ()	
OS 621 19371 - OS 621 19371 - Learning Unit Single - PWD - (95 SQM)	● Student Space (44)	
OS 710 12136 - OS 710 12136 - Home Science/Pantry/Laundry - (95 SQM)	○ Office (23)	
OS 710 13370 - OS 710 13370 - Home Science/Pantry/Laundry - (95 SQM)	○ Office (23)	