

# VENTILATION AUDIT REPORT

<b>SCHOOL:</b>	<b>Hinton Public School (2167)</b>
<b>AMU REGION:</b>	<b>Hunter/Central Coast</b>
<b>STATE ELECTORATE:</b>	<b>Port Stephens</b>
<b>LOCAL GOVERNMENT AREA:</b>	<b>Port Stephens</b>

2167 - Hinton Public School  
Site Plan (12462)

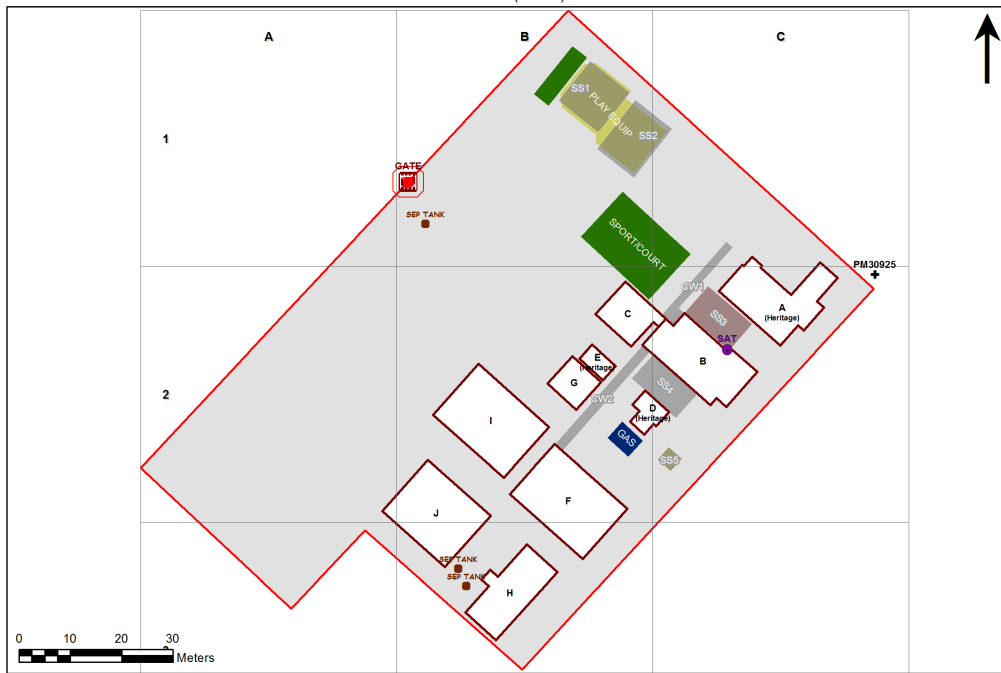

1:693

Printed: 20-Mar-2020

## Ventilation Audit Key

Category	Description
	Category A Operate this space in line with <a href="#">COVID safe school operations</a> . It has the required level of natural ventilation. NB. Circulation and storage areas should not be used for groups or gatherings.
	Category B This space should be occupied at 1 person per 4m <sup>2</sup> to comply with <a href="#">COVID safe school operations and the guided use of spaces</a> . The report details the number of people who can be accommodated safely in each of the identified spaces.

Entity Location	Audit Condition Classification (Capacity)	Comment
B00A - R0002 - Staff Room - (23.53 SQM)	Office (5)	
B00A - R0003 - Movement - (9.32 SQM)	Not Applicable	Circulation or storage space.
B00A - R0005 - Reading Area - (69.89 SQM)	Student Space (32)	
B00B - R0005 - Canteen - (25.44 SQM)	Not Applicable	Circulation or storage space.
B00B - R0006 - Movement - (6.76 SQM)	Not Applicable	Circulation or storage space.
B00B - R0007 - Movement - (115.16 SQM)	Not Applicable	Circulation or storage space.
B00B - R0008 - Movement - (12.91 SQM)	Not Applicable	Circulation or storage space.
B00C - R0007 - Movement - (21.59 SQM)	Not Applicable	Circulation or storage space.
B00F - R0001 - Practical Activities - 1hb - (16.29 SQM)	Student Space (7)	
B00F - R0004 - Home Base - (62.77 SQM) - Teaching Space: 1	Student Space (29)	
B00F - R0005 - Withdrawal Space - 1hb - (11.71 SQM)	Student Space (5)	
B00F - R0006 - Home Base - (61.5 SQM) - Teaching Space: 1	Student Space (28)	
B00F - R0009 - Practical Activities - 1hb - (16.29 SQM)	Student Space (7)	
B00F - R0010 - Movement - (39.94 SQM)	Not Applicable	Circulation or storage space.
B00H - R0001 - Clerical Office - (23.91 SQM)	Office (5)	
B00H - R0002 - Principal - (10.94 SQM)	Office (2)	
B00H - R0005 - Movement - (9.79 SQM)	Not Applicable	Circulation or storage space.
B00H - R0006 - Duplicating Workroom - (21.5 SQM)	Office (5)	
B00H - R0007 - Staff Room - (19.84 SQM)	Office (4)	
B00H - R0008 - Movement - (6.21 SQM)	Not Applicable	Circulation or storage space.
B00H - R0011 - Movement - (7.02 SQM)	Not Applicable	Circulation or storage space.
B00I - R0001 - Practical Activities - 1hb - (18.98 SQM)	Student Space (8)	
B00I - R0003 - Home Base - (59.84 SQM) - Teaching Space: 1	Student Space (27)	
B00I - R0004 - Withdrawal Space - 2hb - (11.54 SQM)	Student Space (5)	
B00I - R0005 - Home Base - (59.84 SQM) - Teaching Space: 1	Student Space (27)	
B00I - R0007 - Practical Activities - 1hb - (18.93 SQM)	Student Space (8)	
B00I - R0009 - Movement - (39.04 SQM)	Not Applicable	Circulation or storage space.
B00J - R0003 - Special Programs Room - (60.35 SQM)	Student Space (27)	
B00J - R0004 - Home Base - (58.53 SQM) - Teaching Space: 1	Student Space (27)	
B00J - R0005 - Withdrawal Space - 1hb - (8.79 SQM)	Student Space (4)	
B00J - R0007 - Practical Activities - (20.42 SQM)	Student Space (9)	