

VENTILATION AUDIT REPORT

SCHOOL:	Hilltop Road Public School (3997)
AMU REGION:	Western Sydney
STATE ELECTORATE:	Granville
LOCAL GOVERNMENT AREA:	Cumberland

3997 - Hilltop Road Public School
Site Plan (12649)

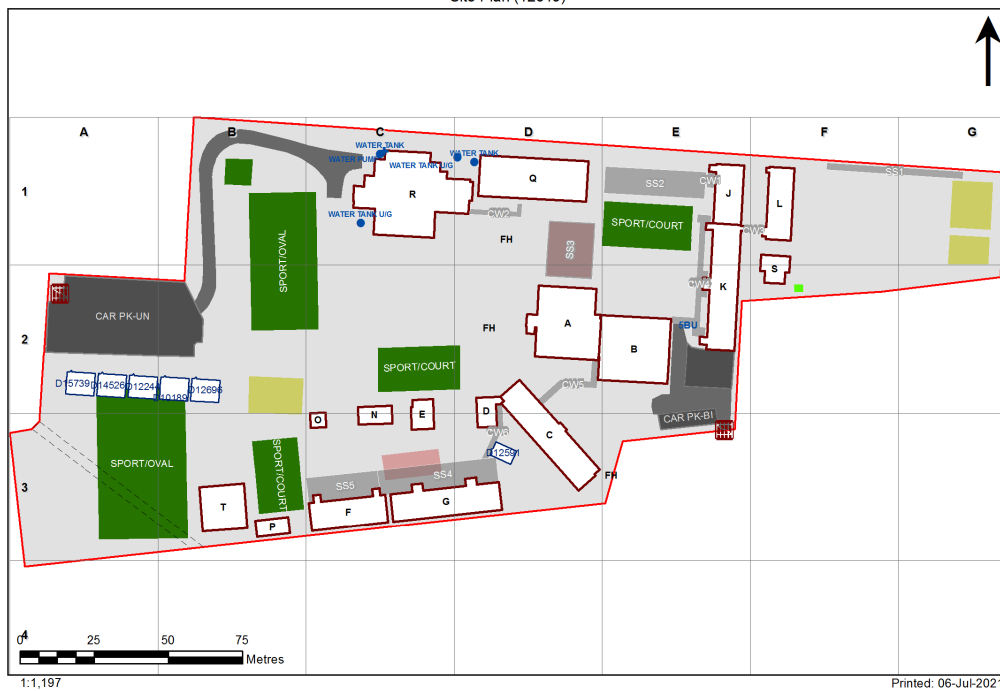

Ventilation Audit Key

Category	Description
	Category A Operate this space in line with COVID safe school operations . It has the required level of natural ventilation. NB. Circulation and storage areas should not be used for groups or gatherings.
	Category B This space should be occupied at 1 person per 4m ² to comply with COVID safe school operations and the guided use of spaces . The report details the number of people who can be accommodated safely in each of the identified spaces.

Entity Location	Audit Condition Classification (Capacity)	Comment
B00A - R0003 - Movement - (10.44 SQM)	Not Applicable	Circulation or storage space.
B00A - R0010 - Movement - (7.04 SQM)	Not Applicable	Circulation or storage space.
B00A - R0012 - Movement - (148.2 SQM)	Not Applicable	Circulation or storage space.
B00A - R1001 - Home Base - (65.22 SQM) - Teaching Space: 1	● Student Space (30)	
B00A - R1002 - Movement - (65.31 SQM)	Not Applicable	Circulation or storage space.
B00A - R1003 - Home Base - (68.22 SQM) - Teaching Space: 1	● Student Space (31)	
B00A - R1005 - Home Base - (68.91 SQM) - Teaching Space: 1	● Student Space (31)	
B00A - R1007 - Home Base - (65.47 SQM) - Teaching Space: 1	● Student Space (30)	
B00B - R0005 - Movement - (31.75 SQM)	Not Applicable	Circulation or storage space.
B00B - R0007 - Deputy Principal - (14.62 SQM)	● Office (3)	
B00B - R0011 - Interview - (14.32 SQM)	● Office (3)	
B00B - R0012 - Entry Vestibule - (11.93 SQM)	Not Applicable	Circulation or storage space.
B00B - R0013 - Principal - (16.09 SQM)	● Office (4)	
B00B - R0016 - Sick Bay - (8.6 SQM)	● Student Space (3)	
B00B - R0017 - Clerical Office - (16.14 SQM)	● Office (4)	
B00B - R0019 - Duplicating Workroom - (12.27 SQM)	● Office (3)	
B00B - R0026 - Staff Kitchen - (5.49 SQM)	● Office (1)	
B00B - R0027 - Staff Room - (58.59 SQM)	● Office (14)	
B00B - R0028 - Staff Kitchen - (8.29 SQM)	● Office (2)	
B00B - R0029 - Special Programs Room - (39.89 SQM)	● Student Space (18)	
B00B - R0031 - Movement - (36.1 SQM)	Not Applicable	Circulation or storage space.
B00B - R1001 - Reading Area - (218.44 SQM)	● Student Space (101)	
B00B - R1002 - Home Base - (54.11 SQM) - Teaching Space: 1	● Student Space (25)	
B00B - R1003 - Movement - (38.08 SQM)	Not Applicable	Circulation or storage space.
B00B - R1004 - Staff Room - (19.32 SQM)	● Office (4)	
B00C - R0006 - Interview - (12.68 SQM)	● Office (3)	
B00C - R0007 - Home Base - (53.68 SQM) - Teaching Space: 1	● Student Space (24)	
B00C - R0008 - Home Base - (53.82 SQM) - Teaching Space: 1	● Student Space (24)	
B00C - R0009 - Interview - (9.31 SQM)	● Office (2)	
B00C - R0011 - Home Base - (53.53 SQM) - Teaching Space: 1	● Student Space (24)	
B00C - R0012 - Home Base - (53.17 SQM) - Teaching Space: 1	● Student Space (24)	
B00E - R0001 - Movement - (15.62 SQM)	Not Applicable	Circulation or storage space.
B00F - R0007 - Home Base - (69.01 SQM) - Teaching Space: 1	● Student Space (32)	
B00F - R0008 - Practical Activities - 1hb - (18.62 SQM)	● Student Space (8)	
B00F - R0011 - Withdrawal Space - 2hb - (21.65 SQM)	● Student Space (10)	
B00F - R0012 - Home Base - (71.09 SQM) - Teaching Space: 1	● Student Space (32)	
B00F - R0013 - Practical Activities - 1hb - (19.81 SQM)	● Student Space (9)	
B00G - R0001 - Home Base - (66.28 SQM) - Teaching Space: 1	● Student Space (30)	
B00G - R0006 - Movement - (7.5 SQM)	Not Applicable	Circulation or storage space.
B00G - R0008 - Home Base - (65.76 SQM) - Teaching Space: 1	● Student Space (30)	
B00G - R0009 - Home Base - (66.22 SQM) - Teaching Space: 1	● Student Space (30)	
B00G - R0014 - Movement - (7.44 SQM)	Not Applicable	Circulation or storage space.
B00G - R0015 - Home Base - (65.91 SQM) - Teaching Space: 1	● Student Space (30)	
B00J - R0002 - Home Base - (92.54 SQM) - Teaching Space: 1	● Student Space (42)	
B00J - R0003 - Home Base - (66.06 SQM) - Teaching Space: 1	● Student Space (30)	
B00J - R0005 - Movement - (9.31 SQM)	Not Applicable	Circulation or storage space.
B00K - R0003 - Home Base - (65.98 SQM) - Teaching Space: 1	● Student Space (30)	
B00K - R0004 - Home Base - (93.45 SQM) - Teaching Space: 1	● Student Space (43)	

Entity Location	Audit Condition Classification (Capacity)	Comment
B00K - R0006 - Movement - (10.97 SQM)	Not Applicable	Circulation or storage space.
B00K - R0010 - Home Base - (66.1 SQM) - Teaching Space: 1	● Student Space (30)	
B00K - R0011 - Home Base - (66.16 SQM) - Teaching Space: 1	● Student Space (30)	
B00K - R0013 - Movement - (6.34 SQM)	Not Applicable	Circulation or storage space.
B00L - R0002 - Home Base - (56.62 SQM) - Teaching Space: 1	● Student Space (26)	
B00L - R0006 - Home Base - (85.01 SQM) - Teaching Space: 1	● Student Space (39)	
B00L - R0010 - Movement - (8.09 SQM)	Not Applicable	Circulation or storage space.
B00Q - R0001 - Home Base - (60.25 SQM) - Teaching Space: 1	● Student Space (27)	
B00Q - R0003 - Practical Activities - 1hb - (18.78 SQM)	● Student Space (8)	
B00Q - R0004 - Withdrawal Space - 2hb - (11.48 SQM)	● Student Space (5)	
B00Q - R0005 - Home Base - (60.69 SQM) - Teaching Space: 1	● Student Space (28)	
B00Q - R0007 - Practical Activities - 1hb - (18.96 SQM)	● Student Space (8)	
B00Q - R0008 - Home Base - (60.53 SQM) - Teaching Space: 1	● Student Space (28)	
B00Q - R0010 - Practical Activities - 1hb - (18.95 SQM)	● Student Space (8)	
B00Q - R0011 - Withdrawal Space - 2hb - (11.51 SQM)	● Student Space (5)	
B00Q - R0012 - Home Base - (60.26 SQM) - Teaching Space: 1	● Student Space (27)	
B00Q - R0014 - Practical Activities - 1hb - (18.84 SQM)	● Student Space (8)	
B00R - R0001 - Communal Space - (202.01 SQM)	● Student Space (93)	
B00R - R0002 - Raised Platform - (60.3 SQM)	Not Applicable	Circulation or storage space.
B00R - R0014 - Canteen - (43.66 SQM)	Not Applicable	Circulation or storage space.
B00R - R0018 - Movement - (5.23 SQM)	Not Applicable	Circulation or storage space.
B00R - R0020 - Movement - (12.77 SQM)	Not Applicable	Circulation or storage space.
B00T - R0001 - Staff Room - (16.37 SQM)	● Office (4)	
B00T - R0002 - Staff Room - (11.2 SQM)	● Office (2)	
B00T - R0003 - Staff Room - (11.2 SQM)	● Office (2)	
B00T - R0004 - Staff Kitchen - (7.84 SQM)	● Office (1)	
B00T - R0009 - Practical Activities - (108.41 SQM)	● Student Space (50)	
B00T - R0010 - Clerical Office - (11.6 SQM)	● Office (2)	
B00T - R0011 - Staff Room - (14.29 SQM)	● Office (3)	
B00T - R0012 - Staff Room - (9.87 SQM)	● Office (2)	
OS 602 12244 - OS 602 12244 - Learning Unit - Standard With P.A.A. - (76 SQM)	● Student Space (35)	
OS 602 12696 - OS 602 12696 - Learning Unit - Standard With P.A.A. - (76 SQM)	● Student Space (35)	
OS 602 14526 - OS 602 14526 - Learning Unit - Standard With P.A.A. - (76 SQM)	● Student Space (35)	
OS 602 15739 - OS 602 15739 - Learning Unit - Standard With P.A.A. - (76 SQM)	● Student Space (35)	
OS 603 10189 - OS 603 10189 - Learning Unit - Standard With P.A.A. A/C - (76 SQM)	● Student Space (35)	