

VENTILATION AUDIT REPORT

| | |
|-------------------------------|--|
| SCHOOL: | Hampden Park Public School (4494) |
| AMU REGION: | South Western Sydney |
| STATE ELECTORATE: | Lakemba |
| LOCAL GOVERNMENT AREA: | Canterbury-Bankstown |

4494 - Hampden Park Public School
Site Plan (11662)

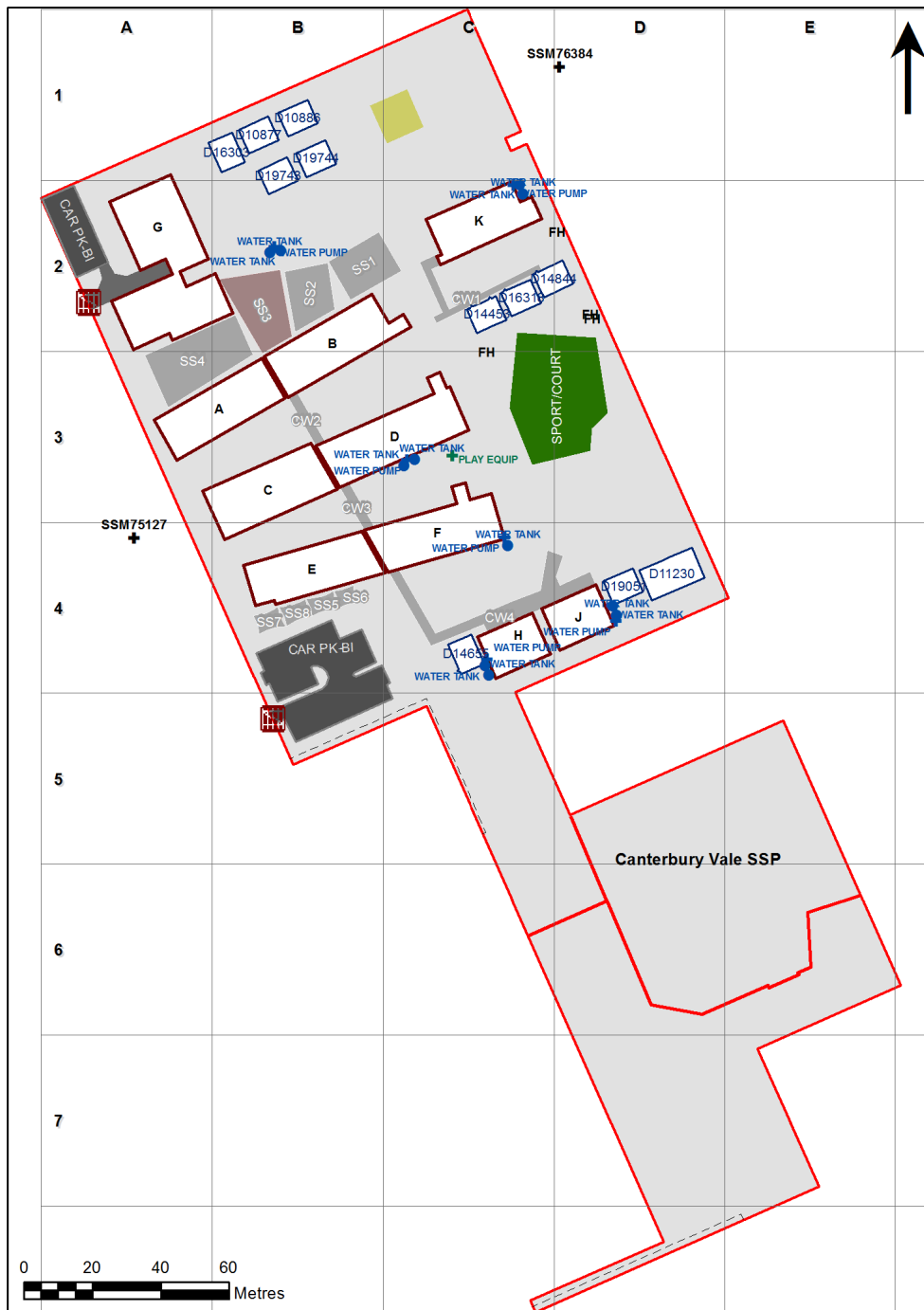

1:1,390

Printed: 17-Jul-2021

Ventilation Audit Key

| Category | Description |
|---|--|
|  | Category A Operate this space in line with COVID safe school operations . It has the required level of natural ventilation. NB. Circulation and storage areas should not be used for groups or gatherings. |
|  | Category B This space should be occupied at 1 person per 4m ² to comply with COVID safe school operations and the guided use of spaces . The report details the number of people who can be accommodated safely in each of the identified spaces. |

| Entity Location | Audit Condition Classification (Capacity) | Comment |
|--|---|-------------------------------|
| B00A - R0001 - Movement - (17.76 SQM) | Not Applicable | Circulation or storage space. |
| B00A - R0003 - Special Programs Room - (30.29 SQM) | ● Student Space (14) | |
| B00A - R0004 - Special Programs Room - (43.65 SQM) | ● Student Space (20) | |
| B00A - R0008 - Home Base - (59.39 SQM) - Teaching Space: 1 | ● Student Space (27) | |
| B00A - R0011 - Practical Activities - 1hb - (29.94 SQM) | ● Student Space (13) | |
| B00A - R0013 - Withdrawal Space - 1hb - (5.9 SQM) | ● Student Space (2) | |
| B00A - R0014 - Home Base - (50.35 SQM) - Teaching Space: 1 | ● Student Space (23) | |
| B00A - R0015 - Practical Activities - 1hb - (31.24 SQM) | ● Student Space (14) | |
| B00A - R0017 - Withdrawal Space - 1hb - (5.92 SQM) | ● Student Space (2) | |
| B00A - R0018 - Home Base - (50.64 SQM) - Teaching Space: 1 | ● Student Space (23) | |
| B00A - R0019 - Movement - (88.12 SQM) | Not Applicable | Circulation or storage space. |
| B00B - R0001 - Home Base - (46.56 SQM) - Teaching Space: 1 | ● Student Space (21) | |
| B00B - R0002 - Practical Activities - 1hb - (28.39 SQM) | ● Student Space (13) | |
| B00B - R0004 - Withdrawal Space - 1hb - (5.88 SQM) | ● Student Space (2) | |
| B00B - R0005 - Home Base - (50.71 SQM) - Teaching Space: 1 | ● Student Space (23) | |
| B00B - R0006 - Practical Activities - 1hb - (26.75 SQM) | ● Student Space (12) | |
| B00B - R0008 - Withdrawal Space - 1hb - (6.42 SQM) | ● Student Space (2) | |
| B00B - R0009 - Home Base - (49.99 SQM) - Teaching Space: 1 | ● Student Space (23) | |
| B00B - R0011 - Movement - (180.06 SQM) | Not Applicable | Circulation or storage space. |
| B00B - R1002 - Practical Activities - 1hb - (28.52 SQM) | ● Student Space (13) | |
| B00B - R1003 - Home Base - (56.27 SQM) - Teaching Space: 1 | ● Student Space (26) | |
| B00B - R1004 - Withdrawal Space - 1hb - (11.49 SQM) | ● Student Space (5) | |
| B00B - R1005 - Home Base - (56.46 SQM) - Teaching Space: 1 | ● Student Space (26) | |
| B00B - R1006 - Practical Activities - 1hb - (28.23 SQM) | ● Student Space (13) | |
| B00B - R1008 - Practical Activities - 1hb - (30.82 SQM) | ● Student Space (14) | |
| B00B - R1010 - Withdrawal Space - 1hb - (6.3 SQM) | ● Student Space (2) | |
| B00B - R1011 - Home Base - (52.48 SQM) - Teaching Space: 1 | ● Student Space (24) | |
| B00B - R1015 - Special Programs Room - (31.94 SQM) | ● Student Space (14) | |
| B00B - R1016 - Movement - (105.84 SQM) | Not Applicable | Circulation or storage space. |
| B00C - R0001 - Movement - (121.51 SQM) | Not Applicable | Circulation or storage space. |
| B00C - R0002 - Staff Room - (80.66 SQM) | ● Office (20) | |
| B00C - R0008 - Sick Bay - (10.93 SQM) | ● Student Space (5) | |
| B00C - R0010 - Deputy Principal - (13.13 SQM) | ● Office (3) | |
| B00C - R0011 - Interview - (13.13 SQM) | ● Office (3) | |
| B00C - R0012 - Principal - (16.63 SQM) | ● Office (4) | |
| B00C - R0016 - Entry Vestibule - (29.13 SQM) | Not Applicable | Circulation or storage space. |
| B00C - R0020 - Staff Room Annexe - (13.08 SQM) | ● Office (3) | |
| B00C - R0022 - Movement - (55.99 SQM) | Not Applicable | Circulation or storage space. |
| B00C - R0024 - Clerical Office/Workroom - (50.89 SQM) | ● Office (12) | |
| B00C - R0025 - Deputy Principal - Type 2 - (26.87 SQM) | ● Office (6) | |
| B00D - R0001 - Movement - (195.65 SQM) | Not Applicable | Circulation or storage space. |
| B00D - R0002 - Reading Area - (282.67 SQM) | ● Student Space (131) | |
| B00D - R1001 - Movement - (144.05 SQM) | Not Applicable | Circulation or storage space. |
| B00D - R1002 - Practical Activities - 1hb - (27.63 SQM) | ● Student Space (12) | |
| B00D - R1004 - Withdrawal Space - 1hb - (6.29 SQM) | ● Student Space (2) | |
| B00D - R1005 - Home Base - (52.48 SQM) - Teaching Space: 1 | ● Student Space (24) | |
| B00D - R1006 - Home Base - (52.91 SQM) - Teaching Space: 1 | ● Student Space (24) | |
| B00D - R1007 - Withdrawal Space - 1hb - (6.31 SQM) | ● Student Space (2) | |

| Entity Location | Audit Condition Classification (Capacity) | Comment |
|--|---|-------------------------------|
| B00D - R1009 - Practical Activities - 1hb - (27.42 SQM) | ● Student Space (12) | |
| B00D - R1011 - Practical Activities - 1hb - (30.82 SQM) | ● Student Space (14) | |
| B00D - R1013 - Withdrawal Space - 1hb - (6.29 SQM) | ● Student Space (2) | |
| B00D - R1014 - Home Base - (52.56 SQM) - Teaching Space: 1 | ● Student Space (24) | |
| B00D - R1015 - Home Base - (63.51 SQM) - Teaching Space: 1 | ● Student Space (29) | |
| B00E - R0001 - Movement - (83.55 SQM) | Not Applicable | Circulation or storage space. |
| B00E - R0004 - Special Programs Room - (30.5 SQM) | ● Student Space (14) | |
| B00E - R0007 - Practical Activities - 1hb - (27.31 SQM) | ● Student Space (12) | |
| B00E - R0009 - Home Base - (54.59 SQM) - Teaching Space: 1 | ● Student Space (25) | |
| B00E - R0010 - Withdrawal Space - 1hb - (11.12 SQM) | ● Student Space (5) | |
| B00E - R0011 - Home Base - (54.36 SQM) - Teaching Space: 1 | ● Student Space (25) | |
| B00E - R0013 - Practical Activities - 1hb - (27.31 SQM) | ● Student Space (12) | |
| B00E - R0014 - Practical Activities - 1hb - (31.28 SQM) | ● Student Space (14) | |
| B00E - R0016 - Withdrawal Space - 1hb - (5.9 SQM) | ● Student Space (2) | |
| B00E - R0017 - Home Base - (51.35 SQM) - Teaching Space: 1 | ● Student Space (23) | |
| B00E - R0018 - Staff Room Annexe - (40.61 SQM) | ● Office (10) | |
| B00F - R0001 - Movement - (197.44 SQM) | Not Applicable | Circulation or storage space. |
| B00F - R0005 - Practical Activities - 1hb - (28.19 SQM) | ● Student Space (13) | |
| B00F - R0007 - Home Base - (53.72 SQM) - Teaching Space: 1 | ● Student Space (24) | |
| B00F - R0008 - Withdrawal Space - 1hb - (12.09 SQM) | ● Student Space (5) | |
| B00F - R0009 - Home Base - (53.5 SQM) - Teaching Space: 1 | ● Student Space (24) | |
| B00F - R0011 - Practical Activities - 1hb - (26.81 SQM) | ● Student Space (12) | |
| B00F - R1001 - Movement - (106.28 SQM) | Not Applicable | Circulation or storage space. |
| B00F - R1002 - Practical Activities - 1hb - (28.52 SQM) | ● Student Space (13) | |
| B00F - R1004 - Home Base - (56.04 SQM) - Teaching Space: 1 | ● Student Space (26) | |
| B00F - R1005 - Withdrawal Space - 1hb - (11.59 SQM) | ● Student Space (5) | |
| B00F - R1006 - Home Base - (56.38 SQM) - Teaching Space: 1 | ● Student Space (26) | |
| B00F - R1008 - Practical Activities - 1hb - (28.02 SQM) | ● Student Space (13) | |
| B00F - R1010 - Practical Activities - 1hb - (30.74 SQM) | ● Student Space (14) | |
| B00F - R1011 - Home Base - (52.35 SQM) - Teaching Space: 1 | ● Student Space (24) | |
| B00F - R1012 - Withdrawal Space - 1hb - (6.27 SQM) | ● Student Space (2) | |
| B00F - R1016 - Special Programs Room - (37 SQM) | ● Student Space (17) | |
| B00G - M0001 - Withdrawal Space - 1hb - (19.56 SQM) | ● Student Space (9) | |
| B00G - M0002 - Staff Room Annexe - (8.26 SQM) | ● Office (2) | |
| B00G - R0001 - Withdrawal Space - 1hb - (7.25 SQM) | ● Student Space (3) | |
| B00G - R0002 - Home Base - (50.01 SQM) - Teaching Space: 1 | ● Student Space (23) | |
| B00G - R0003 - Movement - (8.85 SQM) | Not Applicable | Circulation or storage space. |
| B00G - R0005 - Withdrawal Space - 1hb - (10.17 SQM) | ● Student Space (4) | |
| B00G - R0006 - Movement - (26.88 SQM) | Not Applicable | Circulation or storage space. |
| B00G - R0007 - Practical Activities - 1hb - (49.45 SQM) | ● Student Space (22) | |
| B00G - R0009 - Home Base - (50.38 SQM) - Teaching Space: 1 | ● Student Space (23) | |
| B00G - R0010 - Practical Activities - 1hb - (7.79 SQM) | ● Student Space (3) | |
| B00G - R0011 - Movement - (8.28 SQM) | Not Applicable | Circulation or storage space. |
| B00G - R0020 - Canteen - (37.01 SQM) | Not Applicable | Circulation or storage space. |
| B00G - R0021 - Movement - (38.74 SQM) | Not Applicable | Circulation or storage space. |
| B00G - R0022 - Movement - (57.41 SQM) | Not Applicable | Circulation or storage space. |
| B00G - R0024 - Communal Space - (184.42 SQM) | ● Student Space (85) | |
| B00G - R0025 - Raised Platform - (40.34 SQM) | Not Applicable | Circulation or storage space. |

| Entity Location | Audit Condition Classification (Capacity) | Comment |
|--|---|-------------------------------|
| B00G - R0026 - Movement - (7.43 SQM) | Not Applicable | Circulation or storage space. |
| B00G - R0030 - Movement - (8.2 SQM) | Not Applicable | Circulation or storage space. |
| B00G - R0032 - Withdrawal Space - 1hb - (11.58 SQM) | ● Student Space (5) | |
| B00G - R0033 - Movement - (140.25 SQM) | Not Applicable | Circulation or storage space. |
| B00G - R0038 - Staff Room Annexe - (11.03 SQM) | ● Office (2) | |
| B00G - R0041 - Practical Activities - 1hb - (9.42 SQM) | ● Student Space (4) | |
| B00H - R0001 - Movement - (38.51 SQM) | Not Applicable | Circulation or storage space. |
| B00H - R0002 - Practical Activities - 1hb - (19.4 SQM) | ● Student Space (9) | |
| B00H - R0004 - Home Base - (59.23 SQM) - Teaching Space: 1 | ● Student Space (27) | |
| B00H - R0005 - Withdrawal Space - 2hb - (11.37 SQM) | ● Student Space (5) | |
| B00H - R0006 - Home Base - (59.21 SQM) - Teaching Space: 1 | ● Student Space (27) | |
| B00H - R0008 - Practical Activities - 1hb - (19.42 SQM) | ● Student Space (9) | |
| B00J - R0001 - Movement - (38.51 SQM) | Not Applicable | Circulation or storage space. |
| B00J - R0002 - Practical Activities - 1hb - (19.4 SQM) | ● Student Space (9) | |
| B00J - R0004 - Home Base - (59.23 SQM) - Teaching Space: 1 | ● Student Space (27) | |
| B00J - R0005 - Withdrawal Space - 2hb - (11.37 SQM) | ● Student Space (5) | |
| B00J - R0006 - Home Base - (59.21 SQM) - Teaching Space: 1 | ● Student Space (27) | |
| B00J - R0008 - Practical Activities - 1hb - (19.42 SQM) | ● Student Space (9) | |
| B00K - R0001 - Practical Activities - (18.98 SQM) | ● Student Space (8) | |
| B00K - R0002 - Home Base - (60.88 SQM) - Teaching Space: 1 | ● Student Space (28) | |
| B00K - R0004 - Withdrawal Space - 2hb - (11.4 SQM) | ● Student Space (5) | |
| B00K - R0005 - Practical Activities - (17.73 SQM) | ● Student Space (8) | |
| B00K - R0006 - Home Base - (60.94 SQM) - Teaching Space: 1 | ● Student Space (28) | |
| B00K - R0008 - Practical Activities - (18.98 SQM) | ● Student Space (8) | |
| B00K - R0009 - Home Base - (59.24 SQM) - Teaching Space: 1 | ● Student Space (27) | |
| B00K - R0010 - Withdrawal Space - 1hb - (7.45 SQM) | ● Student Space (3) | |
| B00K - R1001 - Practical Activities - (19.21 SQM) | ● Student Space (8) | |
| B00K - R1002 - Home Base - (61.27 SQM) - Teaching Space: 1 | ● Student Space (28) | |
| B00K - R1004 - Withdrawal Space - 2hb - (11.78 SQM) | ● Student Space (5) | |
| B00K - R1005 - Practical Activities - (19.21 SQM) | ● Student Space (8) | |
| B00K - R1006 - Home Base - (61.33 SQM) - Teaching Space: 1 | ● Student Space (28) | |
| B00K - R1008 - Practical Activities - (19.06 SQM) | ● Student Space (8) | |
| B00K - R1009 - Home Base - (59.47 SQM) - Teaching Space: 1 | ● Student Space (27) | |
| B00K - R1010 - Withdrawal Space - 1hb - (7.66 SQM) | ● Student Space (3) | |
| NS 101 11230 - NS 101 11230 - Learning Unit - Double Primary/PAA - (133 SQM) | ● Student Space (61) | |
| OS 602 14655 - OS 602 14655 - Learning Unit - Standard With P.A.A. - (76 SQM) | ● Student Space (35) | |
| OS 602 14844 - OS 602 14844 - Learning Unit - Standard With P.A.A. - (76 SQM) | ● Student Space (35) | |
| OS 602 16318 - OS 602 16318 - Learning Unit - Standard With P.A.A. - (76 SQM) | ● Student Space (35) | |
| OS 606 10877 - OS 606 10877 - Learning Unit - Standard With P.A.A A/C - (76 SQM) | ● Student Space (35) | |
| OS 606 10886 - OS 606 10886 - Learning Unit - Standard With P.A.A A/C - (76 SQM) | ● Student Space (35) | |
| OS 606 16303 - OS 606 16303 - Learning Unit - Standard With P.A.A A/C - (76 SQM) | ● Student Space (35) | |
| OS 606 19051 - OS 606 19051 - Learning Unit - Standard With P.A.A A/C - (76 SQM) | ● Student Space (35) | |
| OS 606 19743 - OS 606 19743 - Learning Unit - Standard With P.A.A A/C - (76 SQM) | ● Student Space (35) | |
| OS 606 19744 - OS 606 19744 - Learning Unit - Standard With P.A.A A/C - (76 SQM) | ● Student Space (35) | |
| OS 751 14453 - OS 751 14453 - Learning Unit - ESL - (76 SQM) | ● Student Space (35) | |