

VENTILATION AUDIT REPORT

SCHOOL:	Hamilton Public School (7420)
AMU REGION:	Hunter/Central Coast
STATE ELECTORATE:	Newcastle
LOCAL GOVERNMENT AREA:	Newcastle

7420 - Hamilton Public School
Site Plan (13071)

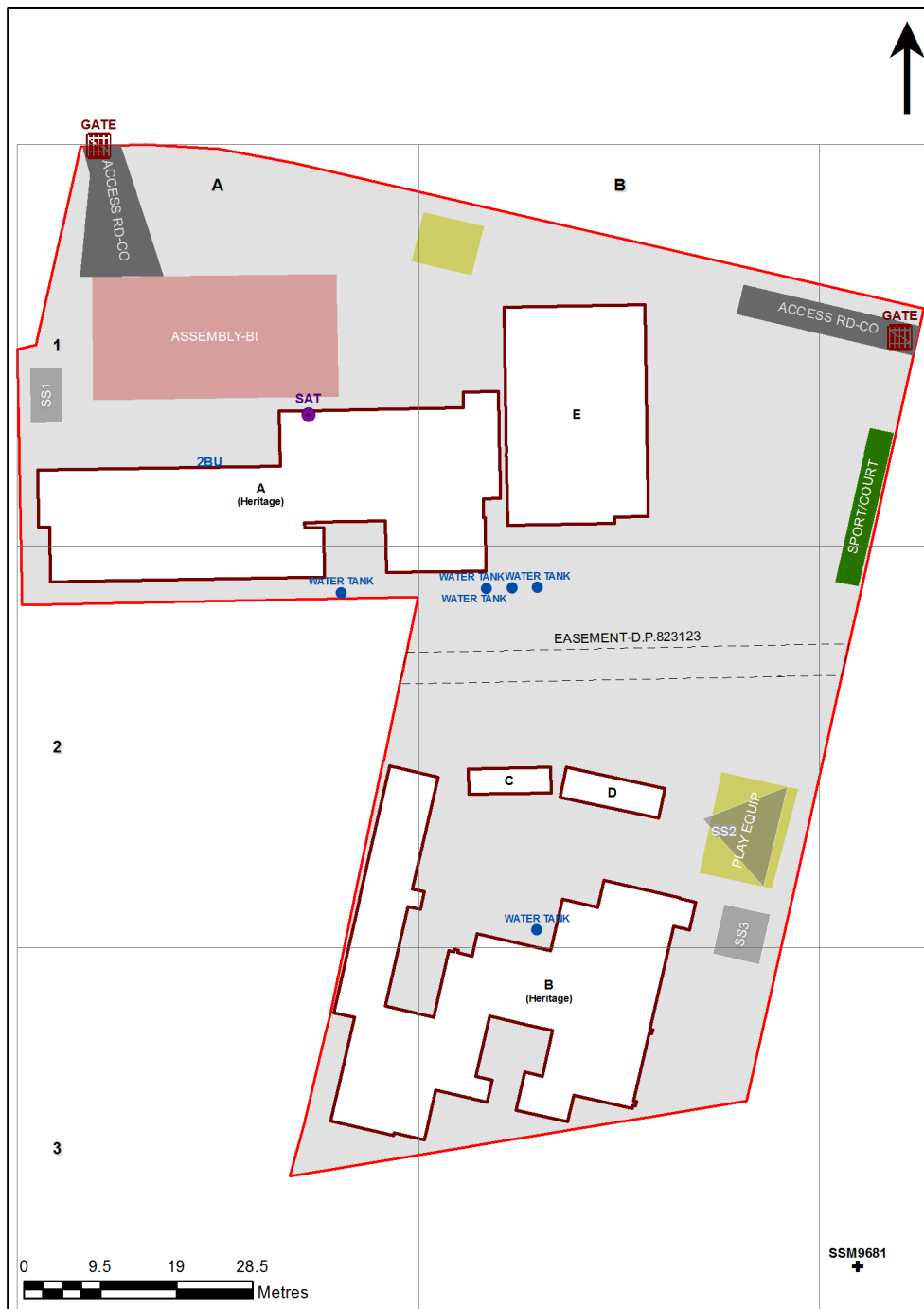

1:591

Printed: 21-Aug-2021

Ventilation Audit Key

Category	Description
	Category A Operate this space in line with COVID safe school operations . It has the required level of natural ventilation. NB. Circulation and storage areas should not be used for groups or gatherings.
	Category B This space should be occupied at 1 person per 4m ² to comply with COVID safe school operations and the guided use of spaces . The report details the number of people who can be accommodated safely in each of the identified spaces.

Entity Location	Audit Condition Classification (Capacity)	Comment
B00A - R0004 - Canteen - (43.18 SQM)	Not Applicable	Circulation or storage space.
B00A - R0009 - Movement - (47.02 SQM)	Not Applicable	Circulation or storage space.
B00A - R0015 - Home Base - (52.81 SQM) - Teaching Space: 1	● Student Space (24)	
B00A - R0016 - Sick Bay - (7.5 SQM)	● Student Space (3)	
B00A - R0017 - Movement - (14.97 SQM)	Not Applicable	Circulation or storage space.
B00A - R0019 - Movement - (8.5 SQM)	Not Applicable	Circulation or storage space.
B00A - R0021 - Movement - (8.56 SQM)	Not Applicable	Circulation or storage space.
B00A - R0022 - Entry Vestibule - (11.55 SQM)	Not Applicable	Circulation or storage space.
B00A - R0023 - Clerical Office - (14.41 SQM)	● Office (3)	
B00A - R0025 - Movement - (55.75 SQM)	Not Applicable	Circulation or storage space.
B00A - R0027 - Duplicating Workroom - (17.35 SQM)	● Office (4)	
B00A - R0028 - Staff Room - (48.07 SQM)	● Office (12)	
B00A - R0029 - Deputy Principal - (15.91 SQM)	● Office (3)	
B00A - R0030 - Reading Area - (47.59 SQM)	● Student Space (22)	
B00A - R0031 - Reading Area - (41.39 SQM)	● Student Space (19)	
B00A - R0033 - Principal - (15.44 SQM)	● Office (3)	
B00A - R0034 - Movement - (8.56 SQM)	Not Applicable	Circulation or storage space.
B00A - R0035 - Movement - (8.47 SQM)	Not Applicable	Circulation or storage space.
B00A - R1001 - Movement - (81.8 SQM)	Not Applicable	Circulation or storage space.
B00A - R1002 - Home Base - M - (47.53 SQM) - Teaching Space: 1	● Student Space (22)	
B00A - R1004 - Interview - (11.33 SQM)	● Office (2)	
B00A - R1005 - Home Base - (48.03 SQM) - Teaching Space: 1	● Student Space (22)	
B00A - R1006 - Practical Activities - 1hb - (40.41 SQM)	● Student Space (18)	
B00A - R1007 - Home Base - (47.45 SQM) - Teaching Space: 1	● Student Space (22)	
B00A - R1010 - Withdrawal Space - 1hb - (15.06 SQM)	● Student Space (6)	
B00A - R1011 - Home Base - (52.33 SQM) - Teaching Space: 1	● Student Space (24)	
B00A - R1012 - Home Base - (55.44 SQM) - Teaching Space: 1	● Student Space (25)	
B00A - R1014 - Movement - (7.99 SQM)	Not Applicable	Circulation or storage space.
B00B - R0001 - Movement - (6.67 SQM)	Not Applicable	Circulation or storage space.
B00B - R0005 - Movement - (105.65 SQM)	Not Applicable	Circulation or storage space.
B00B - R0008 - Movement - (7.41 SQM)	Not Applicable	Circulation or storage space.
B00B - R0010 - Home Base - (76.45 SQM) - Teaching Space: 1	● Student Space (35)	
B00B - R0011 - Movement - (12.48 SQM)	Not Applicable	Circulation or storage space.
B00B - R0013 - Movement - (5.31 SQM)	Not Applicable	Circulation or storage space.
B00B - R0015 - Home Base - (47.88 SQM) - Teaching Space: 1	● Student Space (22)	
B00B - R0016 - Home Base - (100.65 SQM) - Teaching Space: 1	● Student Space (46)	
B00B - R0020 - Movement - (15.86 SQM)	Not Applicable	Circulation or storage space.
B00B - R0021 - Home Base - (57.4 SQM) - Teaching Space: 1	● Student Space (26)	
B00B - R0022 - Practical Activities - (45.96 SQM)	● Student Space (21)	
B00B - R0026 - Movement - (6.2 SQM)	Not Applicable	Circulation or storage space.
B00B - R0028 - Raised Platform - (26.38 SQM)	Not Applicable	Circulation or storage space.
B00B - R0029 - Communal Space - (103.75 SQM)	● Student Space (48)	
B00B - R0031 - Staff Kitchen - (16.54 SQM)	● Office (4)	
B00B - R1001 - Movement - (120.04 SQM)	Not Applicable	Circulation or storage space.
B00B - R1002 - Home Base - (45.16 SQM) - Teaching Space: 1	● Student Space (20)	
B00B - R1003 - Seminar/Study - (15.63 SQM)	● Office (3)	
B00B - R1006 - Home Base - (47.73 SQM) - Teaching Space: 1	● Student Space (22)	
B00B - R1007 - Withdrawal Space - 1hb - (47.88 SQM)	● Student Space (22)	
B00B - R1008 - Home Base - (51.26 SQM) - Teaching Space: 1	● Student Space (23)	

Entity Location	Audit Condition Classification (Capacity)	Comment
B00E - R0004 - Communal Space - (144.64 SQM)	● Student Space (67)	
B00E - R0015 - Movement - (13.32 SQM)	Not Applicable	Circulation or storage space.
B00E - R0016 - Raised Platform - (62.36 SQM)	Not Applicable	Circulation or storage space.
B00E - R0017 - Movement - (11.26 SQM)	Not Applicable	Circulation or storage space.
B00E - R0018 - Movement - (5.47 SQM)	Not Applicable	Circulation or storage space.