

VENTILATION AUDIT REPORT

SCHOOL:	Guyra Central School (2114)
AMU REGION:	North Western NSW
STATE ELECTORATE:	Northern Tablelands
LOCAL GOVERNMENT AREA:	Armidale

2114 - Guyra Central School
Site Plan (14653)

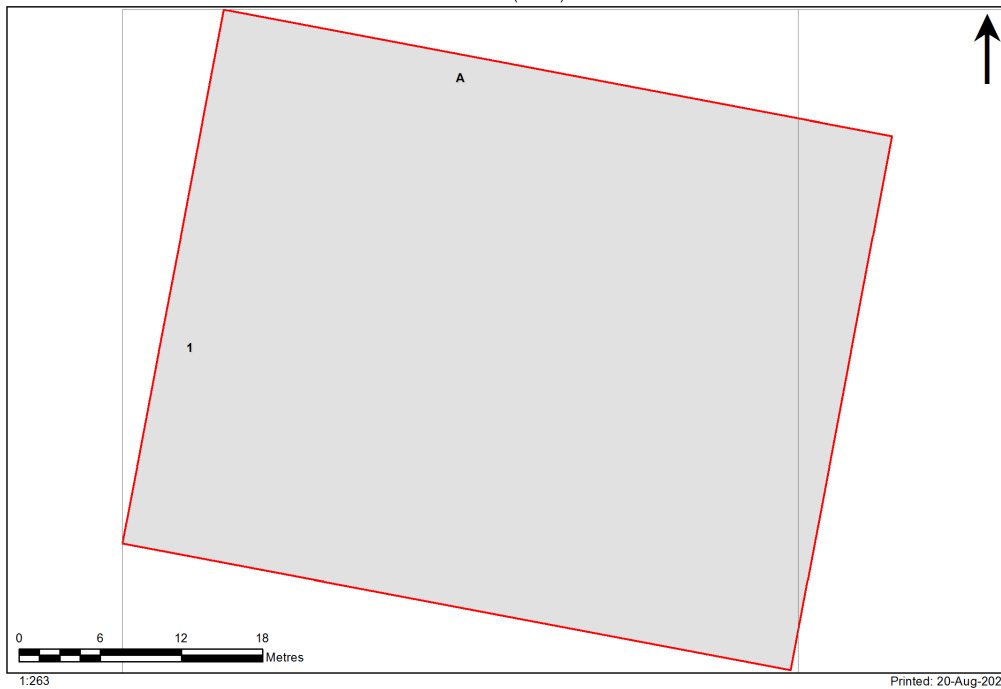

Ventilation Audit Key

Category	Description
	Category A Operate this space in line with COVID safe school operations . It has the required level of natural ventilation. NB. Circulation and storage areas should not be used for groups or gatherings.
	Category B This space should be occupied at 1 person per 4m ² to comply with COVID safe school operations and the guided use of spaces . The report details the number of people who can be accommodated safely in each of the identified spaces.

Entity Location	Audit Condition Classification (Capacity)	Comment
B00A - R0001 - Seminar/Study - (11.29 SQM)	Office (2)	
B00A - R0002 - Seminar/Study - (11.29 SQM)	Office (2)	
B00A - R0003 - Reading Area - (286.16 SQM)	Student Space (132)	
B00A - R0010 - Withdrawal Space - 1hb - (16.66 SQM)	Student Space (7)	
B00A - R0012 - Movement - (128.33 SQM)	Not Applicable	Circulation or storage space.
B00A - R0013 - Home Base - (56.84 SQM) - Teaching Space: 1	Student Space (26)	
B00A - R0014 - Practical Activities - 1hb - (21.7 SQM)	Student Space (10)	
B00A - R0015 - Home Base - (56.6 SQM) - Teaching Space: 1	Student Space (26)	
B00A - R0016 - Home Base - (73.27 SQM) - Teaching Space: 1	Student Space (33)	
B00A - R0018 - Practical Activities - 1hb - (22.03 SQM)	Student Space (10)	
B00A - R0020 - Home Base - (73.61 SQM) - Teaching Space: 1	Student Space (34)	
B00A - R0021 - Home Base - (57.25 SQM) - Teaching Space: 1	Student Space (26)	
B00A - R0022 - Practical Activities - 1hb - (12.45 SQM)	Student Space (5)	
B00A - R0023 - Practical Activities - 1hb - (12.45 SQM)	Student Space (5)	
B00A - R0024 - Special Programs Room - (56.53 SQM)	Student Space (26)	
B00A - R0025 - Home Base - (56.53 SQM) - Teaching Space: 1	Student Space (26)	
B00A - R0026 - Practical Activities - 1hb - (21.64 SQM)	Student Space (10)	
B00A - R0027 - Home Base - (56.53 SQM) - Teaching Space: 1	Student Space (26)	
B00A - R0028 - Home Base - (56.53 SQM) - Teaching Space: 1	Student Space (26)	
B00A - R0029 - Practical Activities - 1hb - (21.64 SQM)	Student Space (10)	
B00A - R0030 - Home Base - (57.25 SQM) - Teaching Space: 1	Student Space (26)	
B00A - R0031 - Movement - (5.14 SQM)	Not Applicable	Circulation or storage space.
B00A - R0032 - Staff Room Annexe - (15.57 SQM)	Office (3)	
B00A - R0038 - Movement - (12.7 SQM)	Not Applicable	Circulation or storage space.
B00A - R0040 - Staff Room - (97.79 SQM)	Office (24)	
B00A - R0042 - Movement - (63.31 SQM)	Not Applicable	Circulation or storage space.
B00A - R0045 - Staff Room - (5.4 SQM)	Office (1)	
B00A - R0052 - Staff Room Annexe - (14.84 SQM)	Office (3)	
B00A - R0053 - Staff Room Annexe - (14.88 SQM)	Office (3)	
B00A - R0054 - Staff Room Annexe - (14.89 SQM)	Office (3)	
B00A - R0055 - Principal - (30.34 SQM)	Office (7)	
B00A - R0056 - Duplicating Workroom - (14.93 SQM)	Office (3)	
B00A - R0061 - Movement - (19 SQM)	Not Applicable	Circulation or storage space.
B00A - R0071 - Sick Bay - (6.87 SQM)	Student Space (3)	
B00A - R0072 - Sick Bay - (9.02 SQM)	Student Space (4)	
B00A - R0073 - Clerical Office - (41.57 SQM)	Office (10)	
B00A - R0074 - Entry Vestibule - (37.87 SQM)	Not Applicable	Circulation or storage space.
B00A - R0075 - Movement - (318 SQM)	Not Applicable	Circulation or storage space.
B00B - R0001 - Music Learning Space - (96.1 SQM) - Teaching Space: 1	Student Space (44)	
B00B - R0002 - Seminar/Study - (62.29 SQM)	Office (15)	
B00B - R0005 - Staff Room Annexe - (28.7 SQM)	Office (7)	
B00B - R0007 - General Learning Space - (52.84 SQM) - Teaching Space: 1	Student Space (24)	
B00B - R0008 - Laboratory L.S. - (85.69 SQM) - Teaching Space: 1	Student Space (39)	
B00B - R0009 - Preparation - (49.84 SQM)	Not Applicable	Circulation or storage space.
B00B - R0015 - Movement - (102.67 SQM)	Not Applicable	Circulation or storage space.
B00B - R0016 - General Learning Space - (86.03 SQM) - Teaching Space: 1	Student Space (39)	
B00C - R0006 - Food Technology L.S. - (79.51 SQM) - Teaching Space: 1	Student Space (36)	
B00C - R0007 - Food/Research Space - (12.83 SQM)	Not Applicable	Circulation or storage space.

Entity Location	Audit Condition Classification (Capacity)	Comment
B00C - R0017 - Multi-Purpose Space - (168.29 SQM)	● Student Space (78)	
B00C - R0020 - Canteen - (36.3 SQM)	Not Applicable	Circulation or storage space.
B00C - R0025 - Canteen - (19.14 SQM)	Not Applicable	Circulation or storage space.
B00C - R0026 - Communal Space - (117.26 SQM)	● Student Space (54)	
B00C - R0028 - Movement - (17.1 SQM)	Not Applicable	Circulation or storage space.
B00C - R0033 - Staff Room - (39.36 SQM)	● Office (9)	
B00C - R0035 - Withdrawal Space - 1hb - (21.36 SQM)	● Student Space (9)	
B00C - R0036 - Staff Room Annexe - (32.78 SQM)	● Office (8)	
B00C - R0037 - Staff Room Annexe - (18.58 SQM)	● Office (4)	
B00C - R0047 - Clerical Office - (21.97 SQM)	● Office (5)	
B00C - R0048 - Movement - (64.13 SQM)	Not Applicable	Circulation or storage space.
B00C - R0049 - Public Entry - (66.49 SQM)	Not Applicable	Circulation or storage space.
B00C - R0050 - Movement - (6.4 SQM)	Not Applicable	Circulation or storage space.
B00C - R0051 - Interview - (12.3 SQM)	● Office (3)	
B00C - R0052 - Interview - (12.3 SQM)	● Office (3)	
B00C - R0053 - General Learning Space - (57.49 SQM) - Teaching Space: 1	● Student Space (26)	
B00C - R0055 - Staff Room Annexe - (9.87 SQM)	● Office (2)	
B00C - R0056 - General Learning Space - (52.74 SQM) - Teaching Space: 1	● Student Space (24)	
B00C - R0057 - General Learning Space - (52.96 SQM) - Teaching Space: 1	● Student Space (24)	
B00C - R0058 - General Learning Space - (52.97 SQM) - Teaching Space: 1	● Student Space (24)	
B00C - R0062 - Computer Learning Space - (52.74 SQM) - Teaching Space: 1	● Student Space (24)	
B00C - R0066 - Art Learning Space - (79.56 SQM) - Teaching Space: 1	● Student Space (36)	
B00C - R0067 - Movement - (157.48 SQM)	Not Applicable	Circulation or storage space.
B00C - R0074 - General Learning Space - (90.26 SQM) - Teaching Space: 1	● Student Space (41)	
B00C - R0081 - Preparation - Materials - (21.83 SQM)	Not Applicable	Circulation or storage space.
B00C - R0083 - Wood Technology Bay - (158.37 SQM)	Not Applicable	Circulation or storage space.
B00D - R0001 - General Learning Space - (52.59 SQM) - Teaching Space: 1	● Student Space (24)	
B00D - R0002 - Movement - (17.68 SQM)	Not Applicable	Circulation or storage space.
B00D - R0003 - General Learning Space - (39.86 SQM) - Teaching Space: 1	● Student Space (18)	
B00D - R0004 - General Learning Space - (38.4 SQM) - Teaching Space: 1	● Student Space (17)	
B00D - R0005 - Staff Room Annexe - (13.63 SQM)	● Office (3)	
B00D - R0006 - Staff Room Annexe - (13.63 SQM)	● Office (3)	
B00D - R0007 - Movement - (34.8 SQM)	Not Applicable	Circulation or storage space.
B00D - R0008 - Movement - (33.75 SQM)	Not Applicable	Circulation or storage space.
B00H - R0001 - Movement - (22.54 SQM)	Not Applicable	Circulation or storage space.
B00M - R0006 - Movement - (6.58 SQM)	Not Applicable	Circulation or storage space.
B00M - R0012 - Movement - (5.86 SQM)	Not Applicable	Circulation or storage space.
B00M - R0014 - Stage - (61.65 SQM)	Not Applicable	Circulation or storage space.
B00M - R0015 - Movement - (24.3 SQM)	Not Applicable	Circulation or storage space.
B00M - R0018 - Movement - (6.54 SQM)	Not Applicable	Circulation or storage space.
B00M - R0026 - Gymnasium - (325.15 SQM)	● Student Space (150)	
B00N - R0001 - General Learning Space - (59.62 SQM) - Teaching Space: 1	● Student Space (27)	
B00N - R0002 - Science Laboratory - (59.62 SQM)	● Student Space (27)	
B00N - R0003 - Preparation - Science - (30.06 SQM)	Not Applicable	Circulation or storage space.
B00N - R0006 - Staff Room - (21.34 SQM)	● Office (5)	
B00N - R0007 - Seminar - Type 1 - (21.34 SQM)	● Office (5)	
B00N - R0008 - Movement - (5.19 SQM)	Not Applicable	Circulation or storage space.
B00Q - R0003 - Design L.S. - (32.79 SQM) - Teaching Space: 1	● Student Space (15)	
B00Q - R0005 - Workshop Area - (129.15 SQM)	● Student Space (59)	