

# VENTILATION AUDIT REPORT

<b>SCHOOL:</b>	<b>Gunnedah Public School (2109)</b>
<b>AMU REGION:</b>	<b>North Western NSW</b>
<b>STATE ELECTORATE:</b>	<b>Tamworth</b>
<b>LOCAL GOVERNMENT AREA:</b>	<b>Gunnedah</b>

2109 - Gunnedah Public School  
Site Plan (12703)

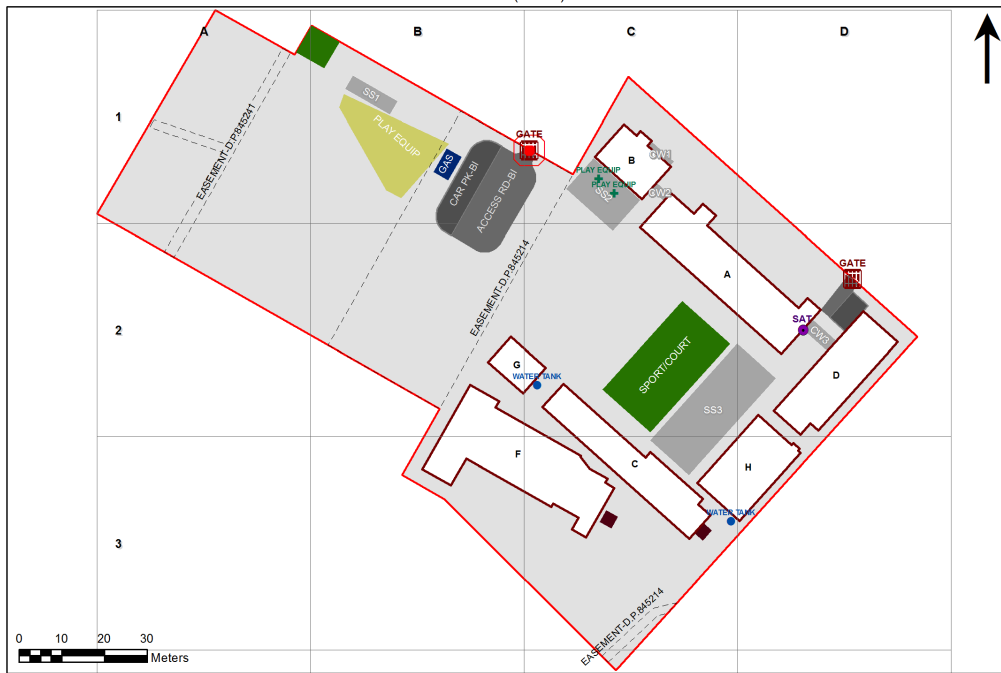





1:831

Printed: 20-Mar-2020

## Ventilation Audit Key

Category	Description
	Category A Operate this space in line with <a href="#">COVID safe school operations</a> . It has the required level of natural ventilation. NB. Circulation and storage areas should not be used for groups or gatherings.
	Category B This space should be occupied at 1 person per 4m <sup>2</sup> to comply with <a href="#">COVID safe school operations and the guided use of spaces</a> . The report details the number of people who can be accommodated safely in each of the identified spaces.

Entity Location	Audit Condition Classification (Capacity)	Comment
B00A - R0001 - Movement - (13.01 SQM)	Not Applicable	Circulation or storage space.
B00A - R0002 - Movement - (13.53 SQM)	Not Applicable	Circulation or storage space.
B00A - R0003 - Movement - (60.51 SQM)	Not Applicable	Circulation or storage space.
B00A - R0004 - Movement - (13.58 SQM)	Not Applicable	Circulation or storage space.
B00A - R0005 - Home Base - (57.01 SQM) - Teaching Space: 1	● Student Space (26)	
B00A - R0009 - Movement - (5.25 SQM)	Not Applicable	Circulation or storage space.
B00A - R0010 - Home Base - (57.61 SQM) - Teaching Space: 1	● Student Space (26)	
B00A - R0011 - Home Base - (56.97 SQM) - Teaching Space: 1	● Student Space (26)	
B00A - R0015 - Movement - (5.33 SQM)	Not Applicable	Circulation or storage space.
B00A - R0016 - Home Base - (57.61 SQM) - Teaching Space: 1	● Student Space (26)	
B00A - R0017 - Staff Room - (52.89 SQM)	● Office (13)	
B00A - R1003 - Movement - (77.17 SQM)	Not Applicable	Circulation or storage space.
B00A - R1004 - Home Base - (56.69 SQM) - Teaching Space: 1	● Student Space (26)	
B00A - R1008 - Movement - (5.14 SQM)	Not Applicable	Circulation or storage space.
B00A - R1009 - Home Base - (57.31 SQM) - Teaching Space: 1	● Student Space (26)	
B00A - R1010 - Home Base - (57.09 SQM) - Teaching Space: 1	● Student Space (26)	
B00A - R1014 - Movement - (5.26 SQM)	Not Applicable	Circulation or storage space.
B00A - R1015 - Home Base - (57.26 SQM) - Teaching Space: 1	● Student Space (26)	
B00A - R1017 - Home Base - M - (58.02 SQM) - Teaching Space: 1	● Student Space (26)	
B00B - R0001 - Principal - (17.5 SQM)	● Office (4)	
B00B - R0002 - Movement - (7.94 SQM)	Not Applicable	Circulation or storage space.
B00B - R0003 - Entry Vestibule - (18.3 SQM)	Not Applicable	Circulation or storage space.
B00B - R0004 - Clerical Office - (23.76 SQM)	● Office (5)	
B00B - R0005 - Duplicating Workroom - (10.74 SQM)	● Office (2)	
B00B - R0006 - Movement - (10.17 SQM)	Not Applicable	Circulation or storage space.
B00B - R0011 - Sick Bay - (9.42 SQM)	● Student Space (4)	
B00B - R0012 - Interview - (9.06 SQM)	● Office (2)	
B00B - R0013 - Deputy Principal - (15.61 SQM)	● Office (3)	
B00C - R0001 - Movement - (83.73 SQM)	Not Applicable	Circulation or storage space.
B00C - R0002 - Practical Activities - 1hb - (11.19 SQM)	● Student Space (5)	
B00C - R0003 - Home Base - (72.68 SQM) - Teaching Space: 1	● Student Space (33)	
B00C - R0009 - Canteen - (20.43 SQM)	Not Applicable	Circulation or storage space.
B00D - R0001 - Movement - (57.28 SQM)	Not Applicable	Circulation or storage space.
B00D - R0004 - Home Base - (56.93 SQM) - Teaching Space: 1	● Student Space (26)	
B00D - R0005 - Home Base - (57.1 SQM) - Teaching Space: 1	● Student Space (26)	
B00D - R0010 - Home Base - (57.1 SQM) - Teaching Space: 1	● Student Space (26)	
B00D - R1001 - Movement - (60.17 SQM)	Not Applicable	Circulation or storage space.
B00D - R1004 - Reading Area - (119.23 SQM)	● Student Space (55)	
B00D - R1008 - Home Base - (57.02 SQM) - Teaching Space: 1	● Student Space (26)	
B00F - R0001 - Practical Activities - 1hb - (51.9 SQM)	● Student Space (24)	
B00F - R0002 - Communal Space - (296.75 SQM)	● Student Space (137)	
B00F - R0003 - Movement - (8.19 SQM)	Not Applicable	Circulation or storage space.
B00F - R0008 - Movement - (11.3 SQM)	Not Applicable	Circulation or storage space.
B00F - R0010 - Staff Kitchen - (17.8 SQM)	● Office (4)	
B00F - R0011 - Canteen - (11.46 SQM)	Not Applicable	Circulation or storage space.
B00F - R0014 - Movement - (12.85 SQM)	Not Applicable	Circulation or storage space.
B00F - R0015 - Movement - (9.18 SQM)	Not Applicable	Circulation or storage space.
B00G - R0001 - Movement - (9.01 SQM)	Not Applicable	Circulation or storage space.
B00G - R0002 - Staff Room Annexe - (6.04 SQM)	● Office (1)	
B00G - R0005 - Interview - (17.24 SQM)	● Office (4)	

Entity Location	Audit Condition Classification (Capacity)	Comment
B00G - R0006 - Staff Room Annexe - (5.22 SQM)	 Office (1)	
B00G - R0010 - Movement - (19.02 SQM)	Not Applicable	Circulation or storage space.
B00H - R0002 - Home Base - (67.58 SQM) - Teaching Space: 1	 Student Space (31)	
B00H - R0008 - Home Base - (67.72 SQM) - Teaching Space: 1	 Student Space (31)	
B00H - R0010 - Practical Activities - 2hb - (38.77 SQM)	 Student Space (17)	