

VENTILATION AUDIT REPORT

SCHOOL:	Goulburn Public School (2053)
AMU REGION:	Southern NSW
STATE ELECTORATE:	Goulburn
LOCAL GOVERNMENT AREA:	Goulburn Mulwaree

2053 - Goulburn Public School
Site Plan (11765)

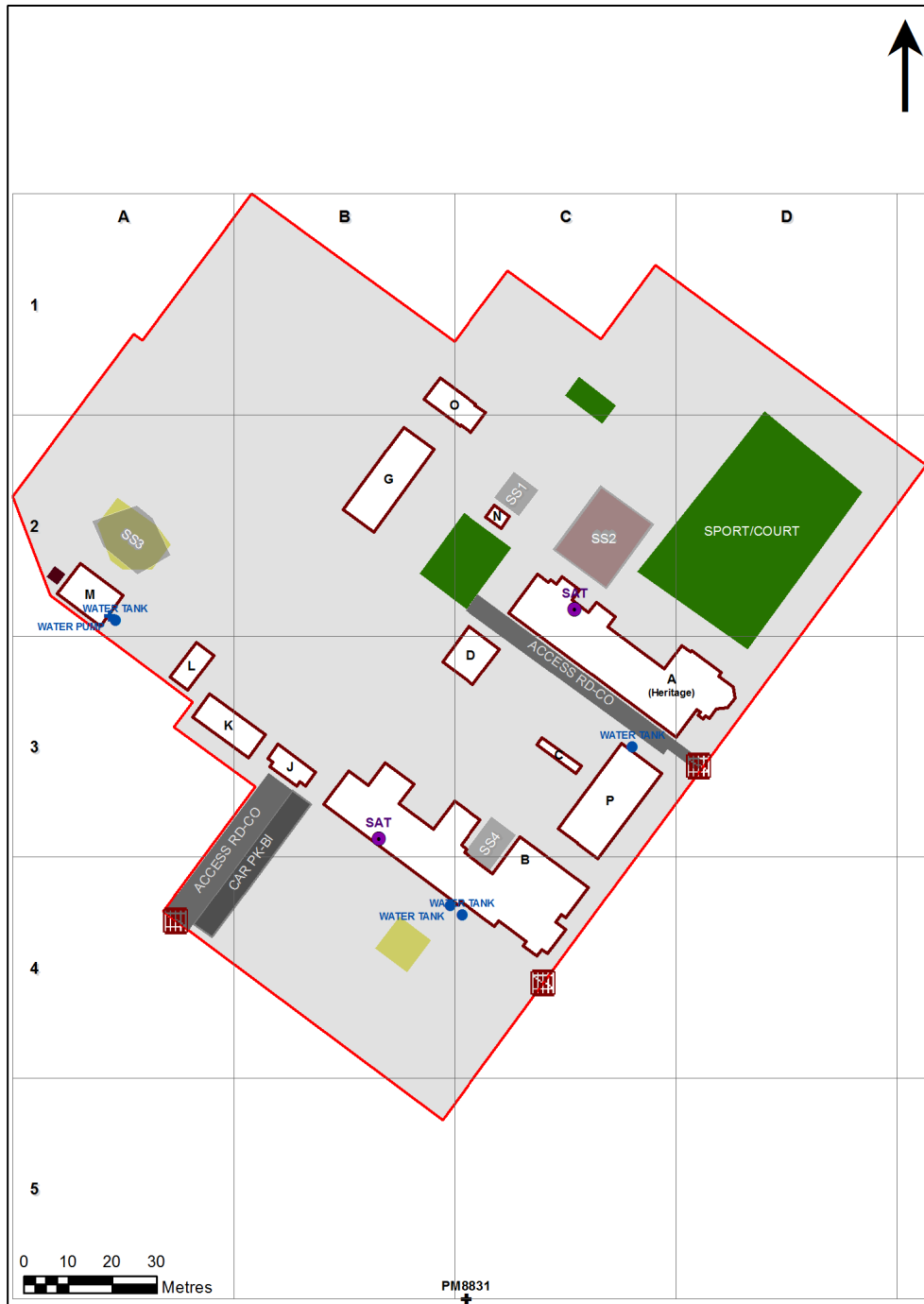

Ventilation Audit Key

Category	Description
	Category A Operate this space in line with COVID safe school operations . It has the required level of natural ventilation. NB. Circulation and storage areas should not be used for groups or gatherings.
	Category B This space should be occupied at 1 person per 4m ² to comply with COVID safe school operations and the guided use of spaces . The report details the number of people who can be accommodated safely in each of the identified spaces.

Entity Location	Audit Condition Classification (Capacity)	Comment
B00A - R0004 - Entry Vestibule - (9.02 SQM)	Not Applicable	Circulation or storage space.
B00A - R0008 - Sick Bay - (6.85 SQM)	● Student Space (3)	
B00A - R0009 - Movement - (18.69 SQM)	Not Applicable	Circulation or storage space.
B00A - R0012 - Staff Room Annexe - (9.77 SQM)	● Office (2)	
B00A - R0016 - Home Base - (61.04 SQM) - Teaching Space: 1	● Student Space (28)	
B00A - R0017 - Home Base - (39.09 SQM) - Teaching Space: 1	● Student Space (18)	
B00A - R0018 - Staff Room - (38.33 SQM)	● Office (9)	
B00A - R0024 - Practical Activities - 1hb - (20.5 SQM)	● Student Space (9)	
B00A - R0027 - Principal - (28.3 SQM)	● Office (7)	
B00A - R0029 - Movement - (64.76 SQM)	Not Applicable	Circulation or storage space.
B00A - R0031 - Clerical Office/Workroom - (40.99 SQM)	● Office (10)	
B00A - R0036 - Reading Area - (51.38 SQM)	● Student Space (23)	
B00A - R0037 - Reading Area - (51.29 SQM)	● Student Space (23)	
B00B - R0001 - Home Base - (66.92 SQM) - Teaching Space: 1	● Student Space (31)	
B00B - R0002 - Practical Activities - 1hb - (45.93 SQM)	● Student Space (21)	
B00B - R0008 - Movement - (6.03 SQM)	Not Applicable	Circulation or storage space.
B00B - R0009 - Movement - (55.65 SQM)	Not Applicable	Circulation or storage space.
B00B - R0010 - Movement - (43.42 SQM)	Not Applicable	Circulation or storage space.
B00B - R0012 - Home Base - (50.14 SQM) - Teaching Space: 1	● Student Space (23)	
B00B - R0013 - Movement - (36.65 SQM)	Not Applicable	Circulation or storage space.
B00B - R0015 - Staff Room Annexe - (24.05 SQM)	● Office (6)	
B00B - R0016 - Special Programs Room - (12.6 SQM)	● Student Space (5)	
B00B - R0017 - Home Base - (47.65 SQM) - Teaching Space: 1	● Student Space (22)	
B00B - R0018 - Home Base - (52.7 SQM) - Teaching Space: 1	● Student Space (24)	
B00B - R0019 - Home Base - (55.27 SQM) - Teaching Space: 1	● Student Space (25)	
B00B - R0020 - Home Base - (44.08 SQM) - Teaching Space: 1	● Student Space (20)	
B00B - R0021 - Home Base - (40.6 SQM) - Teaching Space: 1	● Student Space (18)	
B00B - R0022 - Practical Activities - 1hb - (18.62 SQM)	● Student Space (8)	
B00B - R0023 - Home Base - (43.21 SQM) - Teaching Space: 1	● Student Space (20)	
B00B - R0024 - Special Programs Room - (12.73 SQM)	● Student Space (5)	
B00B - R0025 - Home Base - (54.59 SQM) - Teaching Space: 1	● Student Space (25)	
B00B - R0026 - Staff Room Annexe - (29.26 SQM)	● Office (7)	
B00D - R0001 - Movement - (51.07 SQM)	Not Applicable	Circulation or storage space.
B00D - R0002 - Canteen - (28.32 SQM)	Not Applicable	Circulation or storage space.
B00G - R0001 - Raised Platform - (28.81 SQM)	Not Applicable	Circulation or storage space.
B00G - R0002 - Communal Space - (131.52 SQM)	● Student Space (61)	
B00G - R0003 - Staff Kitchen - (26.26 SQM)	● Office (6)	
B00P - R0002 - Reading Area - (170.05 SQM)	● Student Space (78)	