

VENTILATION AUDIT REPORT

SCHOOL:	Gorokan Public School (4517)
AMU REGION:	Hunter/Central Coast
STATE ELECTORATE:	Wyong
LOCAL GOVERNMENT AREA:	Central Coast

4517 - Gorokan Public School
Site Plan (13065)

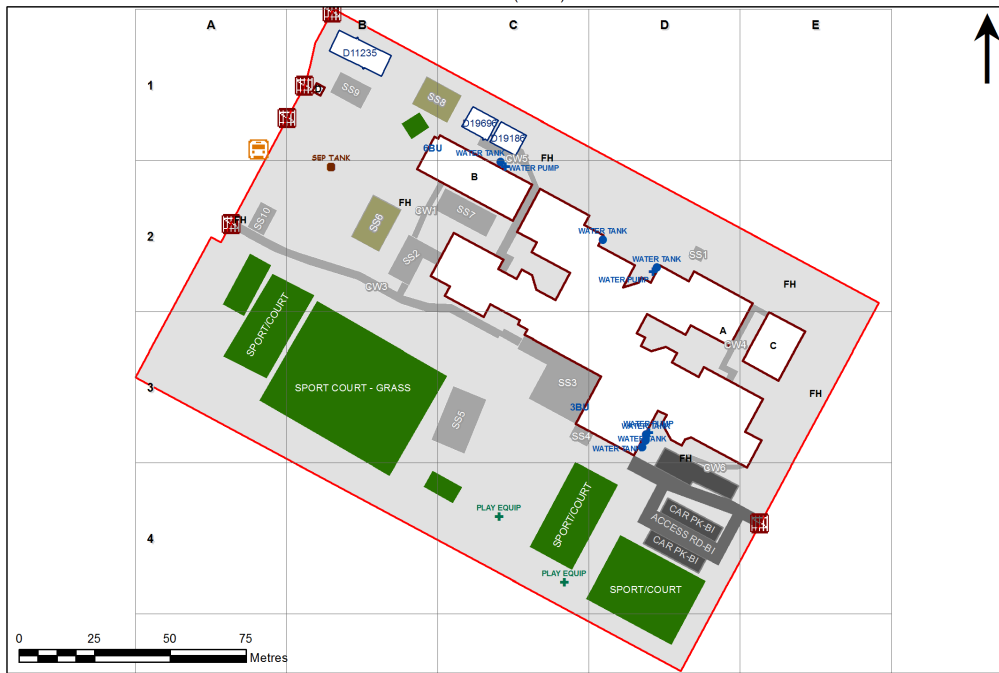

1:1,173

Printed: 13-Jan-2021

Ventilation Audit Key

Category	Description
	Category A Operate this space in line with COVID safe school operations . It has the required level of natural ventilation. NB. Circulation and storage areas should not be used for groups or gatherings.
	Category B This space should be occupied at 1 person per 4m ² to comply with COVID safe school operations and the guided use of spaces . The report details the number of people who can be accommodated safely in each of the identified spaces.

Entity Location	Audit Condition Classification (Capacity)	Comment
B00A - M0001 - Practical Activities - 1hb - (55.41 SQM)	● Student Space (25)	
B00A - R0001 - Movement - (5.54 SQM)	Not Applicable	Circulation or storage space.
B00A - R0004 - Home Base - (56.48 SQM) - Teaching Space: 1	● Student Space (26)	
B00A - R0005 - Movement - (11.16 SQM)	Not Applicable	Circulation or storage space.
B00A - R0006 - Withdrawal Space - 1hb - (11.56 SQM)	● Student Space (5)	
B00A - R0007 - Home Base - (56.97 SQM) - Teaching Space: 1	● Student Space (26)	
B00A - R0008 - Movement - (11.02 SQM)	Not Applicable	Circulation or storage space.
B00A - R0009 - Withdrawal Space - 1hb - (11.56 SQM)	● Student Space (5)	
B00A - R0010 - Home Base - (58.57 SQM) - Teaching Space: 1	● Student Space (27)	
B00A - R0014 - Movement - (9.88 SQM)	Not Applicable	Circulation or storage space.
B00A - R0017 - Withdrawal Space - 1hb - (14.29 SQM)	● Student Space (6)	
B00A - R0018 - Practical Activities - 1hb - (66.13 SQM)	● Student Space (30)	
B00A - R0023 - Movement - (51.25 SQM)	Not Applicable	Circulation or storage space.
B00A - R0024 - Movement - (34.85 SQM)	Not Applicable	Circulation or storage space.
B00A - R0026 - Tiered Learning Space - (44.33 SQM)	● Student Space (20)	
B00A - R0031 - Movement - (55.64 SQM)	Not Applicable	Circulation or storage space.
B00A - R0032 - Movement - (12.48 SQM)	Not Applicable	Circulation or storage space.
B00A - R0033 - Entry Vestibule - (49.2 SQM)	Not Applicable	Circulation or storage space.
B00A - R0034 - Clerical Office - (13.1 SQM)	● Office (3)	
B00A - R0036 - Interview - (12.96 SQM)	● Office (3)	
B00A - R0037 - Deputy Principal - (12.63 SQM)	● Office (3)	
B00A - R0038 - Movement - (5.78 SQM)	Not Applicable	Circulation or storage space.
B00A - R0042 - Movement - (9.61 SQM)	Not Applicable	Circulation or storage space.
B00A - R0045 - Withdrawal Space - 1hb - (14.54 SQM)	● Student Space (6)	
B00A - R0046 - Movement - (6.48 SQM)	Not Applicable	Circulation or storage space.
B00A - R0049 - Home Base - (55.42 SQM) - Teaching Space: 1	● Student Space (25)	
B00A - R0050 - Movement - (12.22 SQM)	Not Applicable	Circulation or storage space.
B00A - R0051 - Withdrawal Space - 1hb - (11.12 SQM)	● Student Space (5)	
B00A - R0052 - Home Base - (55.53 SQM) - Teaching Space: 1	● Student Space (25)	
B00A - R0053 - Movement - (11.06 SQM)	Not Applicable	Circulation or storage space.
B00A - R0054 - Withdrawal Space - 1hb - (11.19 SQM)	● Student Space (5)	
B00A - R0055 - Home Base - (55.1 SQM) - Teaching Space: 1	● Student Space (25)	
B00A - R0056 - Practical Activities - 1hb - (65.58 SQM)	● Student Space (30)	
B00A - R0061 - Sick Bay - (12.39 SQM)	● Student Space (5)	
B00A - R0062 - Principal - (21.99 SQM)	● Office (5)	
B00A - R0063 - Deputy Principal - (12.81 SQM)	● Office (3)	
B00A - R0064 - Duplicating Workroom - (34.06 SQM)	● Office (8)	
B00A - R0079 - Tiered Learning Space - (31.92 SQM)	● Student Space (14)	
B00A - R0080 - Movement - (24.35 SQM)	Not Applicable	Circulation or storage space.
B00A - R0081 - Tiered Learning Space - (42.57 SQM)	● Student Space (19)	
B00A - R0082 - Reading Area - (272.79 SQM)	● Student Space (126)	
B00A - R0083 - Movement - (51.33 SQM)	Not Applicable	Circulation or storage space.
B00A - R0088 - Movement - (9.77 SQM)	Not Applicable	Circulation or storage space.
B00A - R0091 - Withdrawal Space - 1hb - (15.66 SQM)	● Student Space (7)	
B00A - R0092 - Movement - (9.77 SQM)	Not Applicable	Circulation or storage space.
B00A - R0093 - Movement - (6.3 SQM)	Not Applicable	Circulation or storage space.
B00A - R0096 - Home Base - (56.78 SQM) - Teaching Space: 1	● Student Space (26)	
B00A - R0097 - Movement - (12.53 SQM)	Not Applicable	Circulation or storage space.
B00A - R0098 - Withdrawal Space - 1hb - (11.8 SQM)	● Student Space (5)	
B00A - R0099 - Home Base - (55.22 SQM) - Teaching Space: 1	● Student Space (25)	

Entity Location	Audit Condition Classification (Capacity)	Comment
B00A - R0100 - Home Base - (55.22 SQM) - Teaching Space: 1	● Student Space (25)	
B00A - R0101 - Movement - (11.52 SQM)	Not Applicable	Circulation or storage space.
B00A - R0102 - Withdrawal Space - 1hb - (11.76 SQM)	● Student Space (5)	
B00A - R0103 - Home Base - (58.9 SQM) - Teaching Space: 1	● Student Space (27)	
B00A - R0111 - Practical Activities - 1hb - (32.09 SQM)	● Student Space (14)	
B00A - R0112 - Movement - (17.68 SQM)	Not Applicable	Circulation or storage space.
B00A - R0113 - Practical Activities - 1hb - (34.16 SQM)	● Student Space (15)	
B00A - R0114 - Movement - (34.32 SQM)	Not Applicable	Circulation or storage space.
B00A - R0115 - Movement - (32.97 SQM)	Not Applicable	Circulation or storage space.
B00A - R0117 - Tiered Learning Space - (44.29 SQM)	● Student Space (20)	
B00A - R0118 - Movement - (49.22 SQM)	Not Applicable	Circulation or storage space.
B00A - R0122 - Movement - (9.92 SQM)	Not Applicable	Circulation or storage space.
B00A - R0123 - Movement - (20.87 SQM)	Not Applicable	Circulation or storage space.
B00A - R0124 - Practical Activities - 1hb - (34.45 SQM)	● Student Space (15)	
B00A - R0127 - Withdrawal Space - 1hb - (15.71 SQM)	● Student Space (7)	
B00A - R0128 - Movement - (16.84 SQM)	Not Applicable	Circulation or storage space.
B00A - R0129 - Movement - (10.3 SQM)	Not Applicable	Circulation or storage space.
B00A - R0130 - Practical Activities - 1hb - (34.74 SQM)	● Student Space (16)	
B00A - R0131 - Movement - (6.66 SQM)	Not Applicable	Circulation or storage space.
B00A - R0134 - Home Base - (55.5 SQM) - Teaching Space: 1	● Student Space (25)	
B00A - R0135 - Movement - (12.18 SQM)	Not Applicable	Circulation or storage space.
B00A - R0136 - Withdrawal Space - 1hb - (10.92 SQM)	● Student Space (5)	
B00A - R0137 - Home Base - (55.5 SQM) - Teaching Space: 1	● Student Space (25)	
B00A - R0140 - Home Base - (55.5 SQM) - Teaching Space: 1	● Student Space (25)	
B00A - R0141 - Movement - (11.7 SQM)	Not Applicable	Circulation or storage space.
B00A - R0142 - Withdrawal Space - 1hb - (10.86 SQM)	● Student Space (5)	
B00A - R0143 - Special Programs Room - (57.87 SQM)	● Student Space (26)	
B00A - R0154 - Canteen - (43.38 SQM)	Not Applicable	Circulation or storage space.
B00A - R0155 - Movement - (12.38 SQM)	Not Applicable	Circulation or storage space.
B00A - R0159 - Movement - (34.84 SQM)	Not Applicable	Circulation or storage space.
B00A - R0160 - Communal Space - (204.21 SQM)	● Student Space (94)	
B00A - R0161 - Raised Platform - (48.9 SQM)	Not Applicable	Circulation or storage space.
B00A - R0163 - Movement - (5.41 SQM)	Not Applicable	Circulation or storage space.
B00A - R0167 - Movement - (27.15 SQM)	Not Applicable	Circulation or storage space.
B00A - R0175 - Movement - (25.3 SQM)	Not Applicable	Circulation or storage space.
B00A - R0177 - Movement - (41.57 SQM)	Not Applicable	Circulation or storage space.
B00A - R0178 - Interview - (15.72 SQM)	● Office (3)	
B00A - R0180 - Outdoor Learning Area - (87.12 SQM)	Not Applicable	Circulation or storage space.
B00A - R0181 - Breakout Area - (61.99 SQM)	Not Applicable	Circulation or storage space.
B00A - R0182 - Breakout Area - (33.03 SQM)	Not Applicable	Circulation or storage space.
B00A - R0183 - Breakout Area - (98.86 SQM)	Not Applicable	Circulation or storage space.
B00A - R0186 - Movement - (126.74 SQM)	Not Applicable	Circulation or storage space.
B00A - R0187 - Clerical Office - (22.63 SQM)	● Office (5)	
B00A - R0188 - Entry Vestibule - (14.71 SQM)	Not Applicable	Circulation or storage space.
B00A - R0189 - Movement - (20.71 SQM)	Not Applicable	Circulation or storage space.
B00A - R1004 - Home Base - (55.42 SQM) - Teaching Space: 1	● Student Space (25)	
B00A - R1005 - Movement - (12.21 SQM)	Not Applicable	Circulation or storage space.
B00A - R1006 - Withdrawal Space - 1hb - (11.12 SQM)	● Student Space (5)	
B00A - R1009 - Home Base - (55.53 SQM) - Teaching Space: 1	● Student Space (25)	
B00A - R1010 - Movement - (11.05 SQM)	Not Applicable	Circulation or storage space.
B00A - R1011 - Withdrawal Space - 1hb - (11.18 SQM)	● Student Space (5)	

Entity Location	Audit Condition Classification (Capacity)	Comment
B00A - R1014 - Home Base - (55.1 SQM) - Teaching Space: 1	● Student Space (25)	
B00A - R1016 - Practical Activities - 1hb - (63.24 SQM)	● Student Space (29)	
B00A - R1017 - Withdrawal Space - 1hb - (14.54 SQM)	● Student Space (6)	
B00A - R1020 - Movement - (9.61 SQM)	Not Applicable	Circulation or storage space.
B00A - R1024 - Movement - (36.74 SQM)	Not Applicable	Circulation or storage space.
B00A - R1025 - Staff Room - (72.17 SQM)	● Office (18)	
B00A - R1026 - Movement - (117.5 SQM)	Not Applicable	Circulation or storage space.
B00A - R1027 - Movement - (54.7 SQM)	Not Applicable	Circulation or storage space.
B00A - R1028 - Movement - (37.71 SQM)	Not Applicable	Circulation or storage space.
B00A - R1032 - Movement - (9.92 SQM)	Not Applicable	Circulation or storage space.
B00A - R1035 - Withdrawal Space - 1hb - (15.7 SQM)	● Student Space (7)	
B00A - R1036 - Movement - (10.3 SQM)	Not Applicable	Circulation or storage space.
B00A - R1038 - Practical Activities - 1hb - (32.53 SQM)	● Student Space (15)	
B00A - R1040 - Movement - (16.41 SQM)	Not Applicable	Circulation or storage space.
B00A - R1041 - Practical Activities - 1hb - (32.81 SQM)	● Student Space (15)	
B00A - R1042 - Movement - (20.87 SQM)	Not Applicable	Circulation or storage space.
B00A - R1045 - Home Base - (55.5 SQM) - Teaching Space: 1	● Student Space (25)	
B00A - R1046 - Movement - (12.18 SQM)	Not Applicable	Circulation or storage space.
B00A - R1047 - Withdrawal Space - 1hb - (10.92 SQM)	● Student Space (5)	
B00A - R1050 - Home Base - (55.5 SQM) - Teaching Space: 1	● Student Space (25)	
B00A - R1053 - Home Base - (55.5 SQM) - Teaching Space: 1	● Student Space (25)	
B00A - R1054 - Movement - (11.69 SQM)	Not Applicable	Circulation or storage space.
B00A - R1055 - Withdrawal Space - 1hb - (10.85 SQM)	● Student Space (5)	
B00A - R1058 - Home Base - (57.86 SQM) - Teaching Space: 1	● Student Space (26)	
B00B - R0001 - Staff Kitchen - (16.22 SQM)	● Office (4)	
B00B - R0002 - Staff Room Annexe - (13.76 SQM)	● Office (3)	
B00B - R0003 - Practical Activities - 1hb - (14.35 SQM)	● Student Space (6)	
B00B - R0005 - Withdrawal Space - 1hb - (9.2 SQM)	● Student Space (4)	
B00B - R0007 - Home Base - (58.56 SQM) - Teaching Space: 1	● Student Space (27)	
B00B - R0008 - Practical Activities - 1hb - (14.16 SQM)	● Student Space (6)	
B00B - R0011 - Home Base - (60.89 SQM) - Teaching Space: 1	● Student Space (28)	
B00B - R0012 - Withdrawal Space - 2hb - (11.51 SQM)	● Student Space (5)	
B00B - R0013 - Practical Activities - 1hb - (14.15 SQM)	● Student Space (6)	
B00B - R0016 - Home Base - (61.09 SQM) - Teaching Space: 1	● Student Space (28)	
B00C - R0001 - Practical Activities - 1hb - (14.56 SQM)	● Student Space (6)	
B00C - R0004 - Home Base - (60.32 SQM) - Teaching Space: 1	● Student Space (27)	
B00C - R0005 - Withdrawal Space - 2hb - (11.52 SQM)	● Student Space (5)	
B00C - R0006 - Practical Activities - 1hb - (14.6 SQM)	● Student Space (6)	
B00C - R0009 - Home Base - (60.67 SQM) - Teaching Space: 1	● Student Space (28)	
OS 534 11235 - OS 534 11235 - Library/Group Study/Office/A V Store - (152 SQM)	● Student Space (70)	
OS 602 19696 - OS 602 19696 - Learning Unit - Standard With P.A.A. - (76 SQM)	● Student Space (35)	
OS 606 11229 - OS 606 11229 - Learning Unit - Standard With P.A.A A/C - (76 SQM)	● Student Space (35)	
OS 606 19186 - OS 606 19186 - Learning Unit - Standard With P.A.A A/C - (76 SQM)	● Student Space (35)	