

VENTILATION AUDIT REPORT

SCHOOL:	Glendale East Public School (4207)
AMU REGION:	Hunter/Central Coast
STATE ELECTORATE:	Wallsend
LOCAL GOVERNMENT AREA:	Lake Macquarie

4207 - Glendale East Public School
Site Plan (12733)

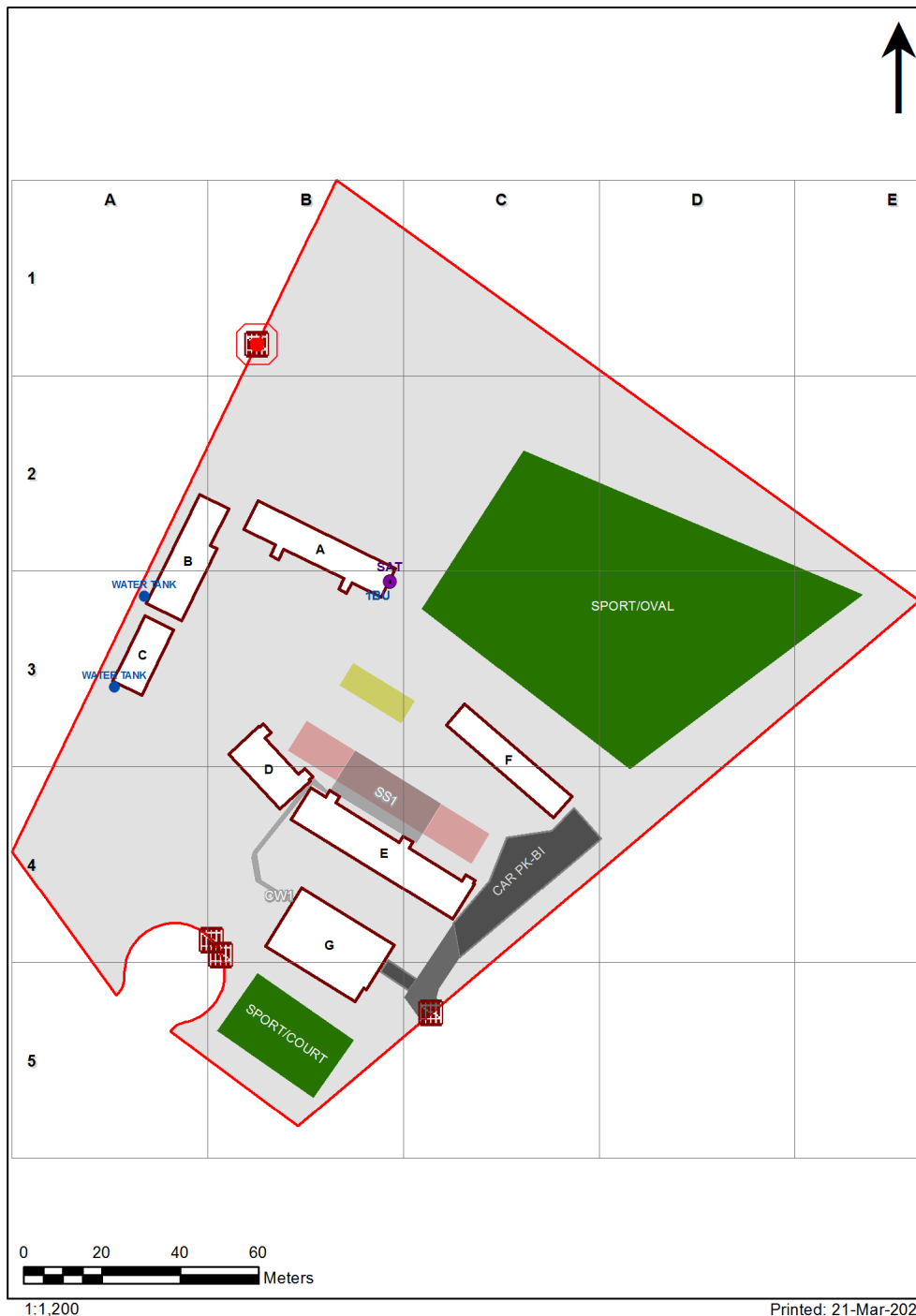

Ventilation Audit Key

Category	Description
	Category A Operate this space in line with COVID safe school operations . It has the required level of natural ventilation. NB. Circulation and storage areas should not be used for groups or gatherings.
	Category B This space should be occupied at 1 person per 4m ² to comply with COVID safe school operations and the guided use of spaces . The report details the number of people who can be accommodated safely in each of the identified spaces.

Entity Location	Audit Condition Classification (Capacity)	Comment
B00A - R0003 - Reading Area - (187.37 SQM)	● Student Space (86)	
B00A - R0006 - Entry Vestibule - (21.88 SQM)	Not Applicable	Circulation or storage space.
B00A - R0007 - Clerical Office - (23.92 SQM)	● Office (5)	
B00A - R0008 - Duplicating Workroom - (17.18 SQM)	● Office (4)	
B00A - R0010 - Movement - (9.95 SQM)	Not Applicable	Circulation or storage space.
B00A - R0011 - Principal - (16.1 SQM)	● Office (4)	
B00B - R0002 - Staff Room - (58.02 SQM)	● Office (14)	
B00B - R0004 - Movement - (39.79 SQM)	Not Applicable	Circulation or storage space.
B00B - R0005 - Movement - (7.56 SQM)	Not Applicable	Circulation or storage space.
B00B - R0008 - Home Base - (58.08 SQM) - Teaching Space: 1	● Student Space (26)	
B00B - R0013 - Home Base - (58.17 SQM) - Teaching Space: 1	● Student Space (26)	
B00C - R0001 - Home Base - (57.19 SQM) - Teaching Space: 1	● Student Space (26)	
B00C - R0003 - Movement - (7.94 SQM)	Not Applicable	Circulation or storage space.
B00C - R0006 - Home Base - (57.32 SQM) - Teaching Space: 1	● Student Space (26)	
B00D - R0001 - Movement - (6.22 SQM)	Not Applicable	Circulation or storage space.
B00D - R0005 - Home Base - (67.85 SQM) - Teaching Space: 1	● Student Space (31)	
B00D - R0006 - Home Base - (67.92 SQM) - Teaching Space: 1	● Student Space (31)	
B00D - R0010 - Movement - (5.37 SQM)	Not Applicable	Circulation or storage space.
B00E - R0001 - Movement - (5.2 SQM)	Not Applicable	Circulation or storage space.
B00E - R0005 - Home Base - (68.25 SQM) - Teaching Space: 1	● Student Space (31)	
B00E - R0006 - Home Base - (68.32 SQM) - Teaching Space: 1	● Student Space (31)	
B00E - R0008 - Movement - (5.31 SQM)	Not Applicable	Circulation or storage space.
B00E - R0009 - Movement - (10.56 SQM)	Not Applicable	Circulation or storage space.
B00E - R0014 - Home Base - (95.6 SQM) - Teaching Space: 1	● Student Space (44)	
B00E - R0015 - Home Base - (67.71 SQM) - Teaching Space: 1	● Student Space (31)	
B00E - R0018 - Movement - (24.85 SQM)	Not Applicable	Circulation or storage space.
B00E - R0019 - Withdrawal Space - 1hb - (16.37 SQM)	● Student Space (7)	
B00E - R0021 - Special Programs Room - (18.87 SQM)	● Student Space (8)	
B00E - R0023 - Movement - (5.31 SQM)	Not Applicable	Circulation or storage space.
B00F - R0002 - Movement - (16.45 SQM)	Not Applicable	Circulation or storage space.
B00F - R0003 - Movement - (16.51 SQM)	Not Applicable	Circulation or storage space.
B00F - R0005 - Movement - (8.32 SQM)	Not Applicable	Circulation or storage space.
B00F - R0006 - Movement - (51.91 SQM)	Not Applicable	Circulation or storage space.
B00F - R0007 - Canteen - (27.92 SQM)	Not Applicable	Circulation or storage space.
B00G - R0002 - Communal Space - (144.78 SQM)	● Student Space (67)	
B00G - R0003 - Movement - (5.57 SQM)	Not Applicable	Circulation or storage space.
B00G - R0004 - Raised Platform - (61.03 SQM)	Not Applicable	Circulation or storage space.
B00G - R0005 - Movement - (11.11 SQM)	Not Applicable	Circulation or storage space.
B00G - R0006 - Movement - (13.55 SQM)	Not Applicable	Circulation or storage space.