

# VENTILATION AUDIT REPORT

<b>SCHOOL:</b>	<b>Georges River College Hurstville Boys Campus (8813)</b>
<b>AMU REGION:</b>	<b>Sydney</b>
<b>STATE ELECTORATE:</b>	<b>Kogarah</b>
<b>LOCAL GOVERNMENT AREA:</b>	<b>Georges River</b>

8813 - Georges River College Hurstville Boys Campus  
Site Plan (12544)

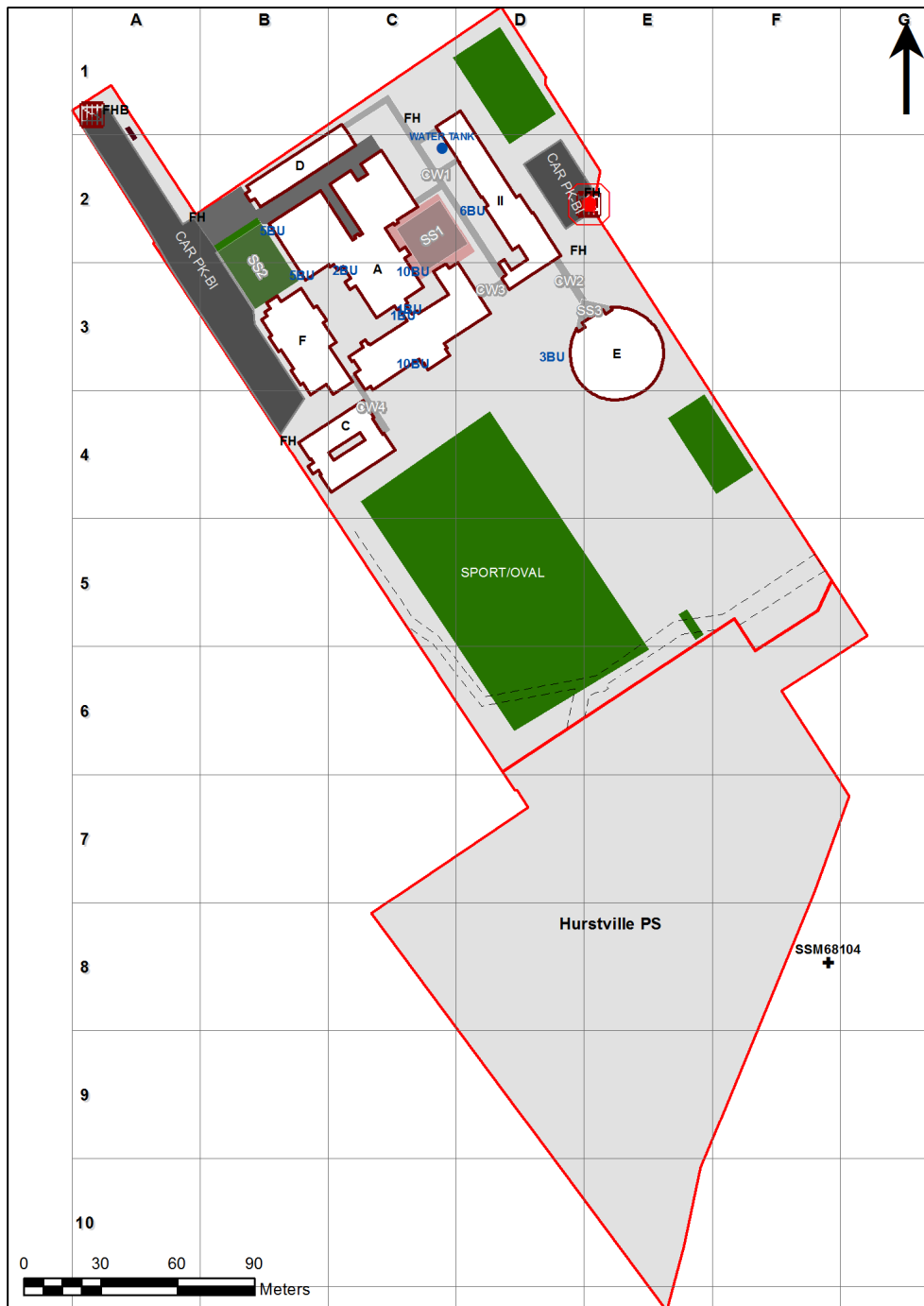

1:1,851

Printed: 21-Mar-2020

## Ventilation Audit Key

Category	Description
	Category A Operate this space in line with <a href="#">COVID safe school operations</a> . It has the required level of natural ventilation. NB. Circulation and storage areas should not be used for groups or gatherings.
	Category B This space should be occupied at 1 person per 4m <sup>2</sup> to comply with <a href="#">COVID safe school operations and the guided use of spaces</a> . The report details the number of people who can be accommodated safely in each of the identified spaces.

Entity Location	Audit Condition Classification (Capacity)	Comment
B00A - R0001 - General Learning Space - (47.23 SQM) - Teaching Space: 1	Student Space (21)	
B00A - R0002 - General Learning Space - (47.23 SQM) - Teaching Space: 1	Student Space (21)	
B00A - R0003 - General Learning Space - (47.83 SQM) - Teaching Space: 1	Student Space (22)	
B00A - R0005 - Principal Office - (15.73 SQM)	Office (3)	
B00A - R0007 - Ancillary Staff - (28.05 SQM)	Office (7)	
B00A - R0010 - General Learning Space - (47.24 SQM) - Teaching Space: 1	Student Space (21)	
B00A - R0022 - Commonroom - (27.99 SQM)	Office (6)	
B00A - R0023 - Leading Teacher - (14.01 SQM)	Office (3)	
B00A - R0024 - General Learning Space - (47.23 SQM) - Teaching Space: 1	Student Space (21)	
B00A - R0028 - Movement - (18.76 SQM)	Not Applicable	Circulation or storage space.
B00A - R0030 - Computer Learning Space - (60.5 SQM) - Teaching Space: 1	Student Space (28)	
B00A - R0032 - Computer Learning Space - (60.4 SQM) - Teaching Space: 1	Student Space (28)	
B00A - R0044 - Staff Study - (5.86 SQM)	Office (1)	
B00A - R0046 - Wood Technology L.S. - (166.96 SQM) - Teaching Space: 1	Student Space (77)	
B00A - R0047 - Staff Study - (7.52 SQM)	Office (1)	
B00A - R0049 - Wood Technology Bay - (74.19 SQM)	Not Applicable	Circulation or storage space.
B00A - R0050 - Wood Technology L.S. - (167.51 SQM) - Teaching Space: 1	Student Space (77)	
B00A - R0055 - Design L.S. - (55.02 SQM) - Teaching Space: 1	Student Space (25)	
B00A - R0056 - Design L.S. - (54.93 SQM) - Teaching Space: 1	Student Space (25)	
B00A - R0057 - Staff Study - (7.34 SQM)	Office (1)	
B00A - R0058 - Commonroom - (123.14 SQM)	Office (30)	
B00A - R0059 - Ancillary Staff - (10.77 SQM)	Office (2)	
B00A - R0060 - Staff Study - (6.61 SQM)	Office (1)	
B00A - R0075 - Movement - (6.3 SQM)	Not Applicable	Circulation or storage space.
B00A - R0078 - General Learning Space - (47.39 SQM) - Teaching Space: 1	Student Space (21)	
B00A - R0079 - General Learning Space - (47.39 SQM) - Teaching Space: 1	Student Space (21)	
B00A - R0080 - Movement - (77.83 SQM)	Not Applicable	Circulation or storage space.
B00A - R0081 - Movement - (206.95 SQM)	Not Applicable	Circulation or storage space.
B00A - R0082 - Interview/Office - Type 1 - (37.92 SQM)	Office (9)	
B00A - R0083 - Shared Learning Space - (69.42 SQM)	Student Space (32)	
B00A - R0084 - Staff Study - (19.98 SQM)	Office (4)	
B00A - R0085 - Movement - (119.48 SQM)	Not Applicable	Circulation or storage space.
B00A - R0090 - Metal Technology L.S. - (151.79 SQM) - Teaching Space: 1	Student Space (70)	
B00A - R0091 - Welding Area - (7.65 SQM)	Not Applicable	Circulation or storage space.
B00A - R0092 - Welding Area - (7.56 SQM)	Not Applicable	Circulation or storage space.
B00A - R0093 - Art Learning Space - (61.71 SQM) - Teaching Space: 1	Student Space (28)	
B00A - R0094 - Art Learning Space - (65.33 SQM) - Teaching Space: 1	Student Space (30)	
B00A - R0095 - Movement - (35.67 SQM)	Not Applicable	Circulation or storage space.
B00A - R0098 - Special Learning Space - (53.29 SQM) - Teaching Space: 1	Student Space (24)	
B00A - R1006 - General Learning Space - (49.72 SQM) - Teaching Space: 1	Student Space (23)	
B00A - R1011 - General Learning Space - (49.36 SQM) - Teaching Space: 1	Student Space (22)	
B00A - R1013 - General Learning Space - (49.08 SQM) - Teaching Space: 1	Student Space (22)	
B00A - R1019 - Movement - (5.71 SQM)	Not Applicable	Circulation or storage space.
B00A - R1020 - Movement - (5.76 SQM)	Not Applicable	Circulation or storage space.
B00A - R1022 - Isolation Space - (7.63 SQM)	Office (1)	
B00A - R1023 - General Learning Space - (48.7 SQM) - Teaching Space: 1	Student Space (22)	
B00A - R1024 - Movement - (162.2 SQM)	Not Applicable	Circulation or storage space.
B00A - R1025 - General Learning Space - (49.83 SQM) - Teaching Space: 1	Student Space (23)	

Entity Location	Audit Condition Classification (Capacity)	Comment
B00A - R1027 - Staff Study - (15.34 SQM)	Office (3)	
B00A - R1029 - Gymnasium - (77.05 SQM)	Student Space (35)	
B00A - R1030 - Isolation Space - (21.88 SQM)	Office (5)	
B00A - R1032 - Staff Study - (15.34 SQM)	Office (3)	
B00A - R9004 - Multi-Purpose Space - (161.97 SQM)	Student Space (75)	
B00A - R9008 - Movement - (9.75 SQM)	Not Applicable	Circulation or storage space.
B00A - R9012 - Movement - (6.25 SQM)	Not Applicable	Circulation or storage space.
B00A - R9016 - Movement - (25.91 SQM)	Not Applicable	Circulation or storage space.
B00A - R9020 - Staff Study - (15.74 SQM)	Office (3)	
B00C - R0001 - General Learning Space - (53.46 SQM) - Teaching Space: 1	Student Space (24)	
B00C - R0002 - General Learning Space - (52.73 SQM) - Teaching Space: 1	Student Space (24)	
B00C - R0003 - General Learning Space - (52.79 SQM) - Teaching Space: 1	Student Space (24)	
B00C - R0004 - General Learning Space - (53.46 SQM) - Teaching Space: 1	Student Space (24)	
B00C - R0011 - Laboratory L.S. - (86.23 SQM) - Teaching Space: 1	Student Space (40)	
B00C - R0014 - Movement - (120.15 SQM)	Not Applicable	Circulation or storage space.
B00C - R0018 - Staff Kitchen - (25.89 SQM)	Office (6)	
B00C - R0020 - Staff Kitchen - (6.45 SQM)	Office (1)	
B00C - R0021 - Performance Workspace - (53.67 SQM) - Teaching Space: 1	Student Space (24)	
B00C - R1001 - General Learning Space - (53.6 SQM) - Teaching Space: 1	Student Space (24)	
B00C - R1002 - General Learning Space - (52.73 SQM) - Teaching Space: 1	Student Space (24)	
B00C - R1003 - General Learning Space - (52.79 SQM) - Teaching Space: 1	Student Space (24)	
B00C - R1004 - General Learning Space - (53.6 SQM) - Teaching Space: 1	Student Space (24)	
B00C - R1010 - Staff Kitchen - (25.93 SQM)	Office (6)	
B00C - R1014 - General Learning Space - (60.4 SQM) - Teaching Space: 1	Student Space (28)	
B00C - R1015 - Movement - (120.86 SQM)	Not Applicable	Circulation or storage space.
B00C - R1018 - General Learning Space - (53.23 SQM) - Teaching Space: 1	Student Space (24)	
B00C - R1019 - Staff Kitchen - (6.19 SQM)	Office (1)	
B00C - R1020 - General Learning Space - (48.39 SQM) - Teaching Space: 1	Student Space (22)	
B00C - R1021 - Staff Kitchen - (5.04 SQM)	Office (1)	
B00D - R0003 - Movement - (12.61 SQM)	Not Applicable	Circulation or storage space.
B00D - R0008 - Darkroom Space - (19.18 SQM)	Office (4)	
B00D - R0009 - Staff Study - (25.18 SQM)	Office (6)	
B00D - R0011 - Movement - (7.41 SQM)	Not Applicable	Circulation or storage space.
B00D - R0015 - Music Learning Space - (59.6 SQM) - Teaching Space: 1	Student Space (27)	
B00D - R0016 - Practice/Seminar - (26.07 SQM)	Not Applicable	Circulation or storage space.
B00D - R0018 - Music Learning Space - (53.01 SQM) - Teaching Space: 1	Student Space (24)	
B00D - R0019 - Music Learning Space - (53.31 SQM) - Teaching Space: 1	Student Space (24)	
B00D - R1001 - Art Learning Space - (52.79 SQM) - Teaching Space: 1	Student Space (24)	
B00D - R1004 - Art Learning Space - (59.23 SQM) - Teaching Space: 1	Student Space (27)	
B00D - R1005 - Art Learning Space - (52.87 SQM) - Teaching Space: 1	Student Space (24)	
B00D - R1008 - General Learning Space - (52.36 SQM) - Teaching Space: 1	Student Space (24)	
B00D - R9006 - Movement - (8.69 SQM)	Not Applicable	Circulation or storage space.
B00E - R0003 - Movement - (16.14 SQM)	Not Applicable	Circulation or storage space.
B00E - R0006 - Stage - (60.27 SQM)	Not Applicable	Circulation or storage space.
B00E - R0008 - Staff Study - (9.76 SQM)	Office (2)	
B00E - R0014 - Student Canteen - (61.65 SQM)	Not Applicable	Circulation or storage space.
B00E - R0015 - Movement - (12.24 SQM)	Not Applicable	Circulation or storage space.
B00E - R0020 - Staff Study - (9.91 SQM)	Office (2)	

Entity Location	Audit Condition Classification (Capacity)	Comment
B00E - R0022 - Multi-Purpose Space - (568.16 SQM)	● Student Space (263)	
B00F - R0008 - General Learning Space - (51.33 SQM) - Teaching Space: 1	● Student Space (23)	
B00F - R0009 - General Learning Space - (50.33 SQM) - Teaching Space: 1	● Student Space (23)	
B00F - R0013 - Laboratory L.S. - (80.58 SQM) - Teaching Space: 1	● Student Space (37)	
B00F - R0014 - Preparation - (51.14 SQM)	Not Applicable	Circulation or storage space.
B00F - R0015 - Laboratory L.S. - (81.47 SQM) - Teaching Space: 1	● Student Space (37)	
B00F - R0017 - Movement - (65.08 SQM)	Not Applicable	Circulation or storage space.
B00F - R0022 - Movement - (86.53 SQM)	Not Applicable	Circulation or storage space.
B00F - R0026 - General Learning Space - Type 3 - (50.4 SQM) - Teaching Space: 1	● Student Space (23)	
B00F - R1001 - Interview/Office - Type 1 - (11.95 SQM)	● Office (2)	
B00F - R1008 - Workroom - (44.63 SQM)	● Office (11)	
B00F - R1009 - Seminar - (11.24 SQM)	● Office (2)	
B00F - R1010 - Seminar - (11.05 SQM)	● Office (2)	
B00F - R1011 - Seminar - (11.27 SQM)	● Office (2)	
B00F - R1013 - Movement - (48.16 SQM)	Not Applicable	Circulation or storage space.
B00F - R1017 - Main Area - (341.71 SQM)	Not Applicable	Circulation or storage space.
B00F - R1018 - Staff Study - (23.14 SQM)	● Office (5)	
B00F - R1020 - Seminar - (74.06 SQM)	● Office (18)	
B011 - R0002 - Movement - (47.92 SQM)	Not Applicable	Circulation or storage space.
B011 - R0003 - Deputy Principal Office - (12.22 SQM)	● Office (3)	
B011 - R0005 - Tea Room - (6.25 SQM)	Not Applicable	Circulation or storage space.
B011 - R0008 - Interview/Meeting - (12.53 SQM)	● Office (3)	
B011 - R0009 - Interview/Meeting - (13.07 SQM)	● Office (3)	
B011 - R0012 - Principal Office - (20.02 SQM)	● Office (5)	
B011 - R0013 - Principal Office - (20.32 SQM)	● Office (5)	
B011 - R0014 - Public Reception - (23.85 SQM)	Not Applicable	Circulation or storage space.
B011 - R0016 - Interview/Meeting - (12.78 SQM)	● Office (3)	
B011 - R0017 - Deputy Principal Office - (11.97 SQM)	● Office (2)	
B011 - R0018 - Movement - (28.06 SQM)	Not Applicable	Circulation or storage space.
B011 - R0020 - Interview/Office - Type 1 - (16.77 SQM)	● Office (4)	
B011 - R0024 - Administration - Clerical - (100.49 SQM)	● Office (25)	
B011 - R0025 - Student Reception - (21.35 SQM)	Not Applicable	Circulation or storage space.
B011 - R0026 - Clinic - (12.25 SQM)	● Office (3)	
B011 - R0028 - Visitors Office - (13.53 SQM)	● Office (3)	
B011 - R0029 - Interview/Office - Type 1 - (12.46 SQM)	● Office (3)	
B011 - R0031 - Movement - (5.83 SQM)	Not Applicable	Circulation or storage space.
B011 - R9001 - Movement - (5.5 SQM)	Not Applicable	Circulation or storage space.