

VENTILATION AUDIT REPORT

SCHOOL:	Forest Hill Public School (1930)
AMU REGION:	Southern NSW
STATE ELECTORATE:	Wagga Wagga
LOCAL GOVERNMENT AREA:	Wagga Wagga

1930 - Forest Hill Public School
Site Plan (12987)

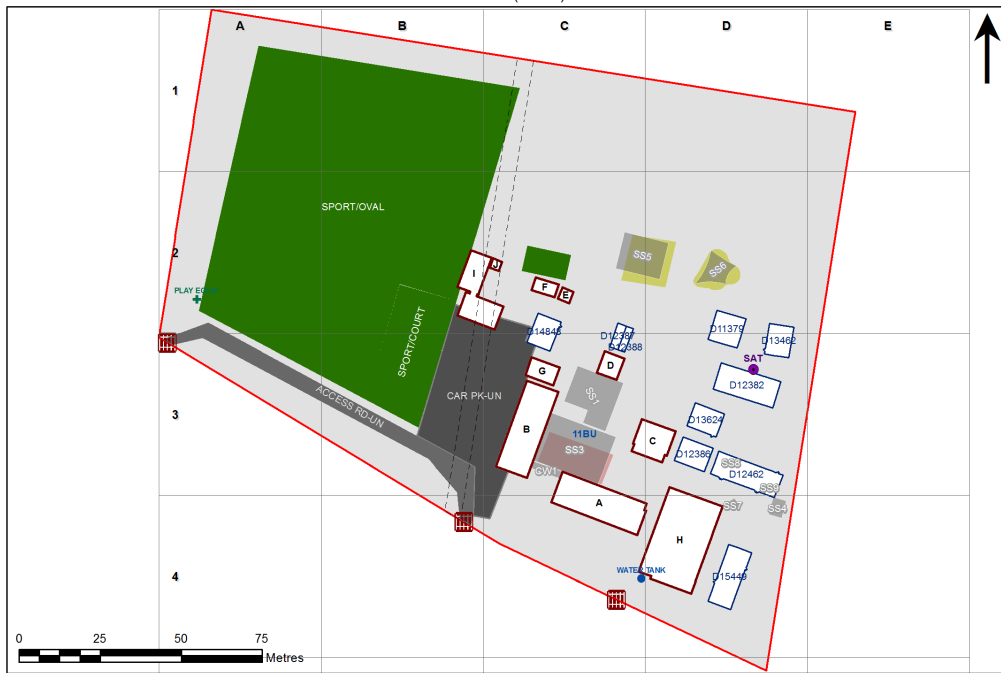

Ventilation Audit Key

Category	Description
	Category A Operate this space in line with COVID safe school operations . It has the required level of natural ventilation. NB. Circulation and storage areas should not be used for groups or gatherings.
	Category B This space should be occupied at 1 person per 4m ² to comply with COVID safe school operations and the guided use of spaces . The report details the number of people who can be accommodated safely in each of the identified spaces.

Entity Location	Audit Condition Classification (Capacity)	Comment
B00A - R0002 - Home Base - (53.43 SQM) - Teaching Space: 1	● Student Space (24)	
B00A - R0003 - Special Programs Room - (53.65 SQM)	● Student Space (24)	
B00A - R0004 - Home Base - (66.64 SQM) - Teaching Space: 1	● Student Space (30)	
B00B - R0003 - Home Base - (55.42 SQM) - Teaching Space: 1	● Student Space (25)	
B00B - R0004 - Home Base - (56.96 SQM) - Teaching Space: 1	● Student Space (26)	
B00B - R0011 - Withdrawal Space - 1hb - (18.34 SQM)	● Student Space (8)	
B00C - R0001 - Practical Activities - 1hb - (13.49 SQM)	● Student Space (6)	
B00C - R0003 - Movement - (16.46 SQM)	Not Applicable	Circulation or storage space.
B00C - R0004 - Home Base - (53.66 SQM) - Teaching Space: 1	● Student Space (24)	
B00H - R0001 - Communal Space - (147.11 SQM)	● Student Space (68)	
B00H - R0002 - Raised Platform - (61.03 SQM)	Not Applicable	Circulation or storage space.
B00H - R0015 - Movement - (11.54 SQM)	Not Applicable	Circulation or storage space.
B00H - R0017 - Movement - (6.07 SQM)	Not Applicable	Circulation or storage space.
NS 100 11379 - NS 100 11379 - Learning Unit - Single Primary/PAA - (76 SQM)	● Student Space (35)	
OS 502 15449 - OS 502 15449 - Admin Staff/Principal/Clerk/Dup/Clinic - (152 SQM)	● Office (38)	
OS 534 12382 - OS 534 12382 - Library/Group Study/Office/A V Store - (152 SQM)	● Student Space (70)	
OS 601 12386 - OS 601 12386 - Learning Unit - Standard/Withdrawal - (76 SQM)	● Student Space (35)	
OS 601 14848 - OS 601 14848 - Learning Unit - Standard/Withdrawal - (76 SQM)	● Student Space (35)	
OS 602 13624 - OS 602 13624 - Learning Unit - Standard With P.A.A. - (76 SQM)	● Student Space (35)	
OS 603 13462 - OS 603 13462 - Learning Unit - Standard With P.A.A. A/C - (76 SQM)	● Student Space (35)	