

VENTILATION AUDIT REPORT

SCHOOL:	Finley Public School (3945)
AMU REGION:	Southern NSW
STATE ELECTORATE:	Murray
LOCAL GOVERNMENT AREA:	Berrigan

3945 - Finley Public School
Site Plan (12983)

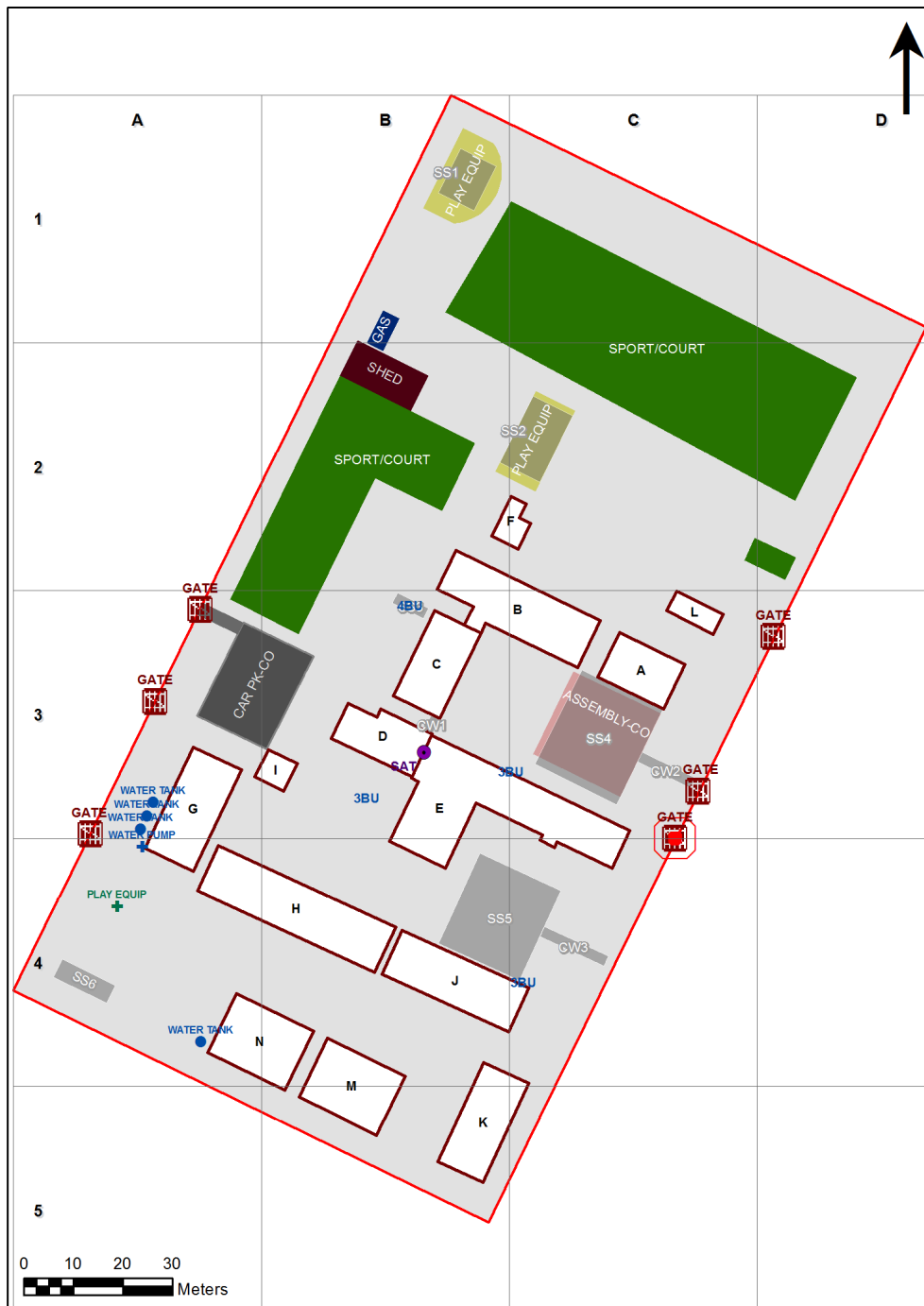





1:956

Printed: 21-Mar-2020

Ventilation Audit Key

Category	Description
	Category A Operate this space in line with COVID safe school operations . It has the required level of natural ventilation. NB. Circulation and storage areas should not be used for groups or gatherings.
	Category B This space should be occupied at 1 person per 4m ² to comply with COVID safe school operations and the guided use of spaces . The report details the number of people who can be accommodated safely in each of the identified spaces.

Entity Location	Audit Condition Classification (Capacity)	Comment
B00A - R0001 - Home Base - (52.34 SQM) - Teaching Space: 1	● Student Space (24)	
B00A - R0002 - Movement - (27.07 SQM)	Not Applicable	Circulation or storage space.
B00A - R0003 - Home Base - (52.34 SQM) - Teaching Space: 1	● Student Space (24)	
B00B - R0001 - Home Base - (73.79 SQM) - Teaching Space: 1	● Student Space (34)	
B00B - R0002 - Movement - (63.27 SQM)	Not Applicable	Circulation or storage space.
B00B - R0009 - Staff Room Annexe - (14.18 SQM)	● Office (3)	
B00B - R0010 - Home Base - (73.79 SQM) - Teaching Space: 1	● Student Space (34)	
B00C - R0001 - Movement - (35 SQM)	Not Applicable	Circulation or storage space.
B00C - R0002 - Home Base - (56.81 SQM) - Teaching Space: 1	● Student Space (26)	
B00C - R0005 - Home Base - (56.88 SQM) - Teaching Space: 1	● Student Space (26)	
B00D - R0001 - Movement - (79.93 SQM)	Not Applicable	Circulation or storage space.
B00D - R0002 - Canteen - (26.5 SQM)	Not Applicable	Circulation or storage space.
B00E - R0001 - Interview - (17.13 SQM)	● Office (4)	
B00E - R0002 - Principal - (18.36 SQM)	● Office (4)	
B00E - R0006 - Sick Bay - (10.48 SQM)	● Student Space (4)	
B00E - R0008 - Deputy Principal - (12.54 SQM)	● Office (3)	
B00E - R0009 - Movement - (46.48 SQM)	Not Applicable	Circulation or storage space.
B00E - R0011 - Reading Area - (170.02 SQM)	● Student Space (78)	
B00E - R0012 - Movement - (12.49 SQM)	Not Applicable	Circulation or storage space.
B00E - R0014 - Special Programs Room - (34.97 SQM)	● Student Space (16)	
B00E - R0019 - Duplicating Workroom - (11.44 SQM)	● Office (2)	
B00E - R0020 - Clerical Office - (23.29 SQM)	● Office (5)	
B00E - R0022 - Staff Room - (49.79 SQM)	● Office (12)	
B00E - R0023 - Staff Kitchen - (7.02 SQM)	● Office (1)	
B00G - R0001 - Movement - (42.36 SQM)	Not Applicable	Circulation or storage space.
B00G - R0005 - Home Base - (73.71 SQM) - Teaching Space: 1	● Student Space (34)	
B00G - R0006 - Withdrawal Space - 1hb - (26.86 SQM)	● Student Space (12)	
B00G - R0009 - Staff Room Annexe - (11.12 SQM)	● Office (2)	
B00H - R0001 - Movement - (92.47 SQM)	Not Applicable	Circulation or storage space.
B00H - R0002 - Withdrawal Space - 1hb - (10.98 SQM)	● Student Space (5)	
B00H - R0004 - Home Base - (53.51 SQM) - Teaching Space: 1	● Student Space (24)	
B00H - R0005 - Home Base - (53.51 SQM) - Teaching Space: 1	● Student Space (24)	
B00H - R0012 - Home Base - (107.48 SQM) - Teaching Space: 1	● Student Space (49)	
B00I - R0001 - Movement - (13.17 SQM)	Not Applicable	Circulation or storage space.
B00I - R0002 - Withdrawal Space - 1hb - (17.74 SQM)	● Student Space (8)	
B00J - R0004 - Home Base - (89.84 SQM) - Teaching Space: 1	● Student Space (41)	
B00J - R0005 - Home Base - (43.34 SQM) - Teaching Space: 1	● Student Space (20)	
B00J - R0008 - Movement - (58.64 SQM)	Not Applicable	Circulation or storage space.
B00K - R0001 - Home Base - (52.27 SQM) - Teaching Space: 1	● Student Space (24)	
B00K - R0002 - Home Base - M - (38.23 SQM) - Teaching Space: 1	● Student Space (17)	
B00K - R0003 - Practical Activities - M - 1hb - (8.85 SQM)	● Student Space (4)	
B00K - R0004 - Sick Bay - (19.47 SQM)	● Student Space (9)	
B00K - R0009 - Movement - (27.35 SQM)	Not Applicable	Circulation or storage space.
B00K - R0011 - Practical Activities - M - 1hb - (13.6 SQM)	● Student Space (6)	
B00M - R0002 - Practical Activities - 1hb - (19.4 SQM)	● Student Space (9)	
B00M - R0004 - Home Base - (59.2 SQM) - Teaching Space: 1	● Student Space (27)	
B00M - R0005 - Withdrawal Space - 2hb - (11.36 SQM)	● Student Space (5)	
B00M - R0006 - Home Base - (59.19 SQM) - Teaching Space: 1	● Student Space (27)	
B00M - R0008 - Practical Activities - 1hb - (19.41 SQM)	● Student Space (9)	

Entity Location	Audit Condition Classification (Capacity)	Comment
B00N - R0002 - Practical Activities - 1hb - (19.4 SQM)	 Student Space (9)	
B00N - R0004 - Home Base - (59.2 SQM) - Teaching Space: 1	 Student Space (27)	
B00N - R0005 - Withdrawal Space - 2hb - (11.36 SQM)	 Student Space (5)	
B00N - R0006 - Home Base - (59.19 SQM) - Teaching Space: 1	 Student Space (27)	
B00N - R0008 - Practical Activities - 1hb - (19.41 SQM)	 Student Space (9)	