

# VENTILATION AUDIT REPORT

<b>SCHOOL:</b>	<b>Figtree Heights Public School (4462)</b>
<b>AMU REGION:</b>	<b>Southern NSW</b>
<b>STATE ELECTORATE:</b>	<b>Keira</b>
<b>LOCAL GOVERNMENT AREA:</b>	<b>Wollongong</b>

4462 - Figtree Heights Public School  
Site Plan (10378)

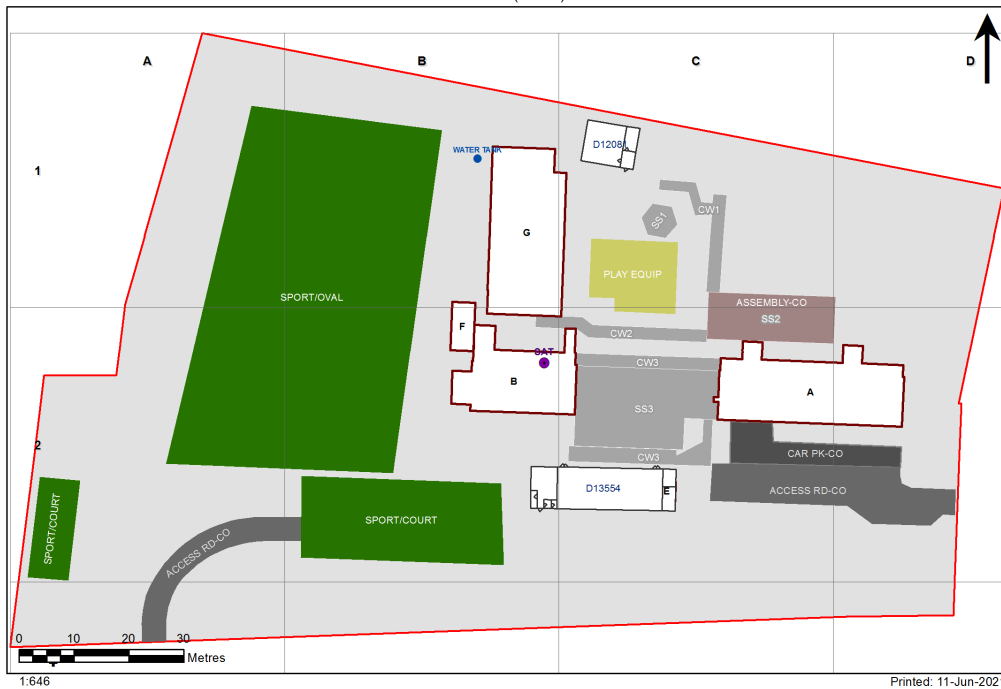

## Ventilation Audit Key

Category	Description
	Category A Operate this space in line with <a href="#">COVID safe school operations</a> . It has the required level of natural ventilation. NB. Circulation and storage areas should not be used for groups or gatherings.
	Category B This space should be occupied at 1 person per 4m <sup>2</sup> to comply with <a href="#">COVID safe school operations and the guided use of spaces</a> . The report details the number of people who can be accommodated safely in each of the identified spaces.

Entity Location	Audit Condition Classification (Capacity)	Comment
B00A - R0004 - Home Base - (59.59 SQM) - Teaching Space: 1	● Student Space (27)	
B00A - R0007 - Deputy Principal - (14.44 SQM)	● Office (3)	
B00A - R0010 - Principal - (17.66 SQM)	● Office (4)	
B00A - R0011 - Entry Vestibule - (9.44 SQM)	Not Applicable	Circulation or storage space.
B00A - R0012 - Clerical Office - (11.68 SQM)	● Office (2)	
B00A - R0013 - Sick Bay - (9.27 SQM)	● Student Space (4)	
B00A - R0015 - Duplicating Workroom - (14.44 SQM)	● Office (3)	
B00A - R0018 - Staff Room - (33.48 SQM)	● Office (8)	
B00A - R0019 - Movement - (21.49 SQM)	Not Applicable	Circulation or storage space.
B00A - R0021 - Clerical Office/Workroom - (12.04 SQM)	● Office (3)	
B00A - R0023 - Movement - (80.72 SQM)	Not Applicable	Circulation or storage space.
B00A - R1002 - Home Base - (59.99 SQM) - Teaching Space: 1	● Student Space (27)	
B00A - R1006 - Home Base - (59.43 SQM) - Teaching Space: 1	● Student Space (27)	
B00A - R1008 - Home Base - (59.42 SQM) - Teaching Space: 1	● Student Space (27)	
B00A - R1014 - Movement - (78.23 SQM)	Not Applicable	Circulation or storage space.
B00B - R0005 - Home Base - (74.59 SQM) - Teaching Space: 1	● Student Space (34)	
B00B - R0010 - Home Base - (74.83 SQM) - Teaching Space: 1	● Student Space (34)	
B00B - R0013 - Movement - (47.87 SQM)	Not Applicable	Circulation or storage space.
B00B - R1001 - Movement - (37.77 SQM)	Not Applicable	Circulation or storage space.
B00B - R1010 - Home Base - (74.91 SQM) - Teaching Space: 1	● Student Space (34)	
B00B - R1011 - Home Base - (75 SQM) - Teaching Space: 1	● Student Space (34)	
B00G - R0003 - Practical Activities - 1hb - (20.58 SQM)	● Student Space (9)	
B00G - R0004 - Withdrawal Space - 1hb - (9.2 SQM)	● Student Space (4)	
B00G - R0006 - Home Base - (58.5 SQM) - Teaching Space: 1	● Student Space (27)	
B00G - R0007 - Reading Area - (90.82 SQM)	● Student Space (42)	
OS 534 13555 - OS 534 13555 - Library/Group Study/Office/A V Store - (152 SQM)	● Student Space (70)	
OS 601 12081 - OS 601 12081 - Learning Unit - Standard/Withdrawal - (76 SQM)	● Student Space (35)	
OS 811 13554 - OS 811 13554 - FSU/Shelter/Stores - (209 SQM)	Not Applicable	Circulation or storage space.