

# VENTILATION AUDIT REPORT

<b>SCHOOL:</b>	<b>Ferncourt Public School (5114)</b>
<b>AMU REGION:</b>	<b>Sydney</b>
<b>STATE ELECTORATE:</b>	<b>Summer Hill</b>
<b>LOCAL GOVERNMENT AREA:</b>	<b>Inner West</b>

5114 - Ferncourt Public School  
Site Plan (10377)

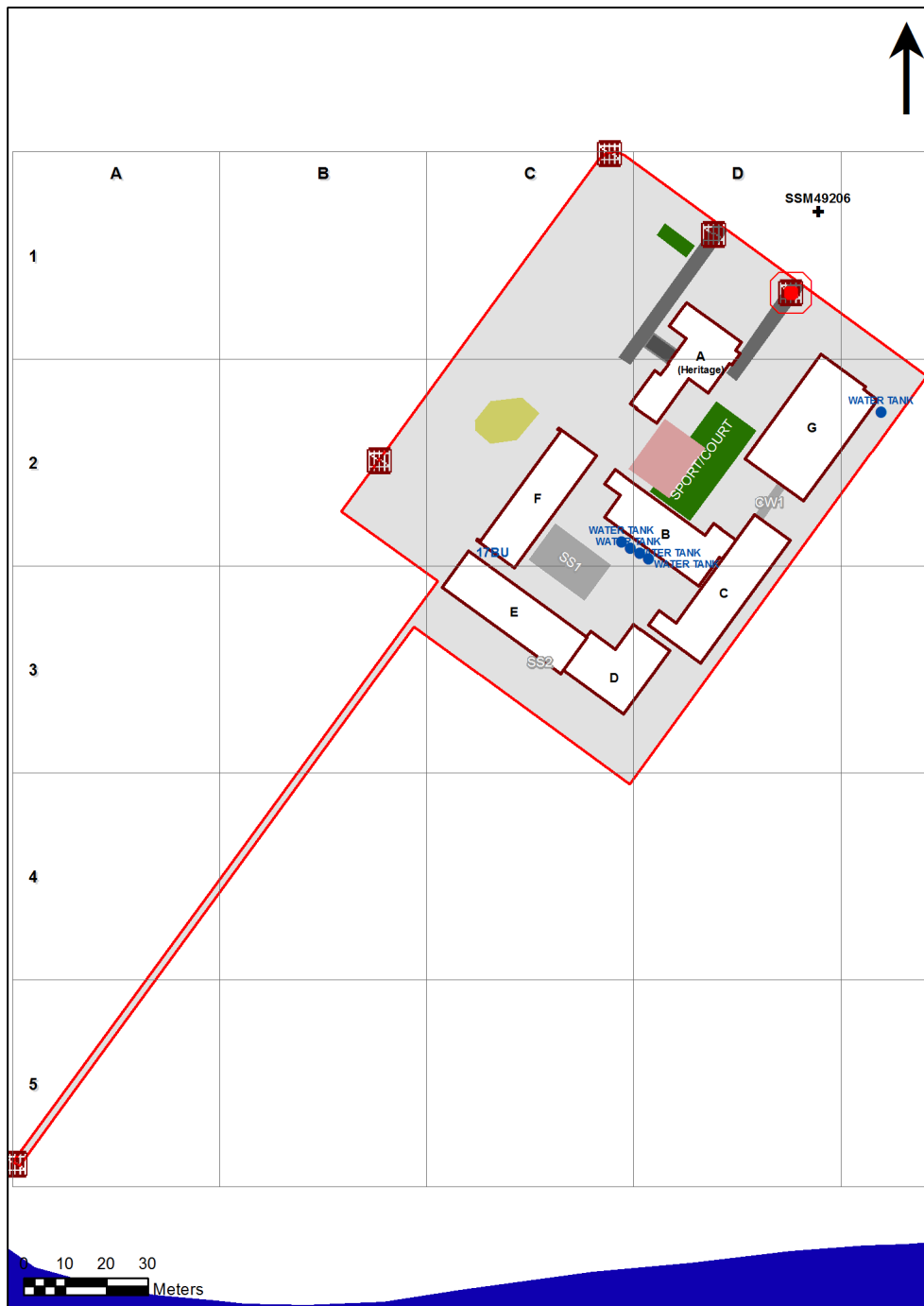

1:1,144

Printed: 21-Mar-2020

## Ventilation Audit Key

Category	Description
	Category A Operate this space in line with <a href="#">COVID safe school operations</a> . It has the required level of natural ventilation. NB. Circulation and storage areas should not be used for groups or gatherings.
	Category B This space should be occupied at 1 person per 4m <sup>2</sup> to comply with <a href="#">COVID safe school operations and the guided use of spaces</a> . The report details the number of people who can be accommodated safely in each of the identified spaces.

Entity Location	Audit Condition Classification (Capacity)	Comment
B00A - R0001 - Movement - (8.25 SQM)	Not Applicable	Circulation or storage space.
B00A - R0002 - Clerical Office - (34.88 SQM)	Office (8)	
B00A - R0003 - Duplicating Workroom - (21.46 SQM)	Office (5)	
B00A - R0004 - Duplicating Workroom - (14.48 SQM)	Office (3)	
B00A - R0005 - Movement - (20.4 SQM)	Not Applicable	Circulation or storage space.
B00A - R0007 - Sick Bay - (7.92 SQM)	Student Space (3)	
B00A - R0008 - Canteen - (19.89 SQM)	Not Applicable	Circulation or storage space.
B00A - R0010 - Movement - (8.89 SQM)	Not Applicable	Circulation or storage space.
B00A - R0011 - Movement - (17.06 SQM)	Not Applicable	Circulation or storage space.
B00A - R0012 - Movement - (8.13 SQM)	Not Applicable	Circulation or storage space.
B00A - R0014 - Movement - (16.34 SQM)	Not Applicable	Circulation or storage space.
B00A - R0015 - Entry Vestibule - (17.86 SQM)	Not Applicable	Circulation or storage space.
B00A - R0016 - Principal - (18.48 SQM)	Office (4)	
B00A - R0018 - Entry Vestibule - (6.01 SQM)	Not Applicable	Circulation or storage space.
B00A - R1005 - Reading Area - (36.81 SQM)	Student Space (17)	
B00A - R1007 - Movement - (7.34 SQM)	Not Applicable	Circulation or storage space.
B00A - R1009 - Staff Kitchen - (8.02 SQM)	Office (2)	
B00A - R1010 - Staff Room - (33.58 SQM)	Office (8)	
B00B - R0003 - Home Base - (57.6 SQM) - Teaching Space: 1	Student Space (26)	
B00B - R1001 - Movement - (62.1 SQM)	Not Applicable	Circulation or storage space.
B00B - R1002 - Reading Area - (57.69 SQM)	Student Space (26)	
B00B - R1007 - Home Base - (56.44 SQM) - Teaching Space: 1	Student Space (26)	
B00B - R1008 - Home Base - (55.65 SQM) - Teaching Space: 1	Student Space (25)	
B00C - R0001 - Home Base - (50.38 SQM) - Teaching Space: 1	Student Space (23)	
B00C - R0002 - Practical Activities - 1hb - (19.55 SQM)	Student Space (9)	
B00C - R0003 - Practical Activities - 1hb - (19.45 SQM)	Student Space (9)	
B00C - R0004 - Home Base - (49.37 SQM) - Teaching Space: 1	Student Space (22)	
B00C - R0005 - Home Base - (49.05 SQM) - Teaching Space: 1	Student Space (22)	
B00C - R0006 - Practical Activities - 1hb - (19.61 SQM)	Student Space (9)	
B00C - R0007 - Practical Activities - 1hb - (19.81 SQM)	Student Space (9)	
B00C - R0008 - Home Base - (50.36 SQM) - Teaching Space: 1	Student Space (23)	
B00C - R0009 - Movement - (58.68 SQM)	Not Applicable	Circulation or storage space.
B00C - R1001 - Home Base - (50.38 SQM) - Teaching Space: 1	Student Space (23)	
B00C - R1002 - Practical Activities - 1hb - (19.52 SQM)	Student Space (9)	
B00C - R1003 - Practical Activities - 1hb - (19.63 SQM)	Student Space (9)	
B00C - R1004 - Home Base - (49.44 SQM) - Teaching Space: 1	Student Space (22)	
B00C - R1005 - Home Base - (49.28 SQM) - Teaching Space: 1	Student Space (22)	
B00C - R1006 - Practical Activities - 1hb - (19.55 SQM)	Student Space (9)	
B00C - R1007 - Practical Activities - 1hb - (19.56 SQM)	Student Space (9)	
B00C - R1008 - Home Base - (50.3 SQM) - Teaching Space: 1	Student Space (23)	
B00C - R1009 - Movement - (70.58 SQM)	Not Applicable	Circulation or storage space.
B00C - R9002 - Movement - (16.57 SQM)	Not Applicable	Circulation or storage space.
B00D - R0001 - Home Base - (56.5 SQM) - Teaching Space: 1	Student Space (26)	
B00D - R0006 - Home Base - (56.82 SQM) - Teaching Space: 1	Student Space (26)	
B00D - R0007 - Movement - (119.12 SQM)	Not Applicable	Circulation or storage space.
B00D - R1006 - Home Base - (90.7 SQM) - Teaching Space: 1	Student Space (42)	
B00D - R1007 - Movement - (110.1 SQM)	Not Applicable	Circulation or storage space.
B00E - R0001 - Movement - (71.61 SQM)	Not Applicable	Circulation or storage space.
B00E - R0007 - Home Base - (100.55 SQM) - Teaching Space: 1	Student Space (46)	
B00E - R0008 - Home Base - (85.76 SQM) - Teaching Space: 1	Student Space (39)	

Entity Location	Audit Condition Classification (Capacity)	Comment
B00E - R1001 - Movement - (77.07 SQM)	Not Applicable	Circulation or storage space.
B00E - R1002 - Movement - (7.79 SQM)	Not Applicable	Circulation or storage space.
B00E - R1004 - Home Base - (56.88 SQM) - Teaching Space: 1	● Student Space (26)	
B00E - R1008 - Home Base - (57.11 SQM) - Teaching Space: 1	● Student Space (26)	
B00E - R1009 - Home Base - (57.12 SQM) - Teaching Space: 1	● Student Space (26)	
B00E - R1014 - Movement - (7.97 SQM)	Not Applicable	Circulation or storage space.
B00F - R0001 - Movement - (67.35 SQM)	Not Applicable	Circulation or storage space.
B00F - R0002 - Deputy Principal - (21.15 SQM)	● Office (5)	
B00F - R0003 - Interview - (18.28 SQM)	● Office (4)	
B00F - R0004 - Movement - (14.44 SQM)	Not Applicable	Circulation or storage space.
B00F - R0011 - Clerical Office/Workroom - (16.68 SQM)	● Office (4)	
B00F - R0013 - Home Base - (56.9 SQM) - Teaching Space: 1	● Student Space (26)	
B00G - R0001 - Communal Space - (161.34 SQM)	● Student Space (74)	
B00G - R0002 - Raised Platform - (50.59 SQM)	Not Applicable	Circulation or storage space.
B00G - R0016 - Canteen - (26.54 SQM)	Not Applicable	Circulation or storage space.
B00G - R0020 - Movement - (11.2 SQM)	Not Applicable	Circulation or storage space.
B00G - R0021 - Movement - (11.59 SQM)	Not Applicable	Circulation or storage space.