

VENTILATION AUDIT REPORT

SCHOOL:	Epping Public School (1850)
AMU REGION:	Northern Sydney
STATE ELECTORATE:	Epping
LOCAL GOVERNMENT AREA:	Parramatta

1850 - Epping Public School
Site Plan (10366)

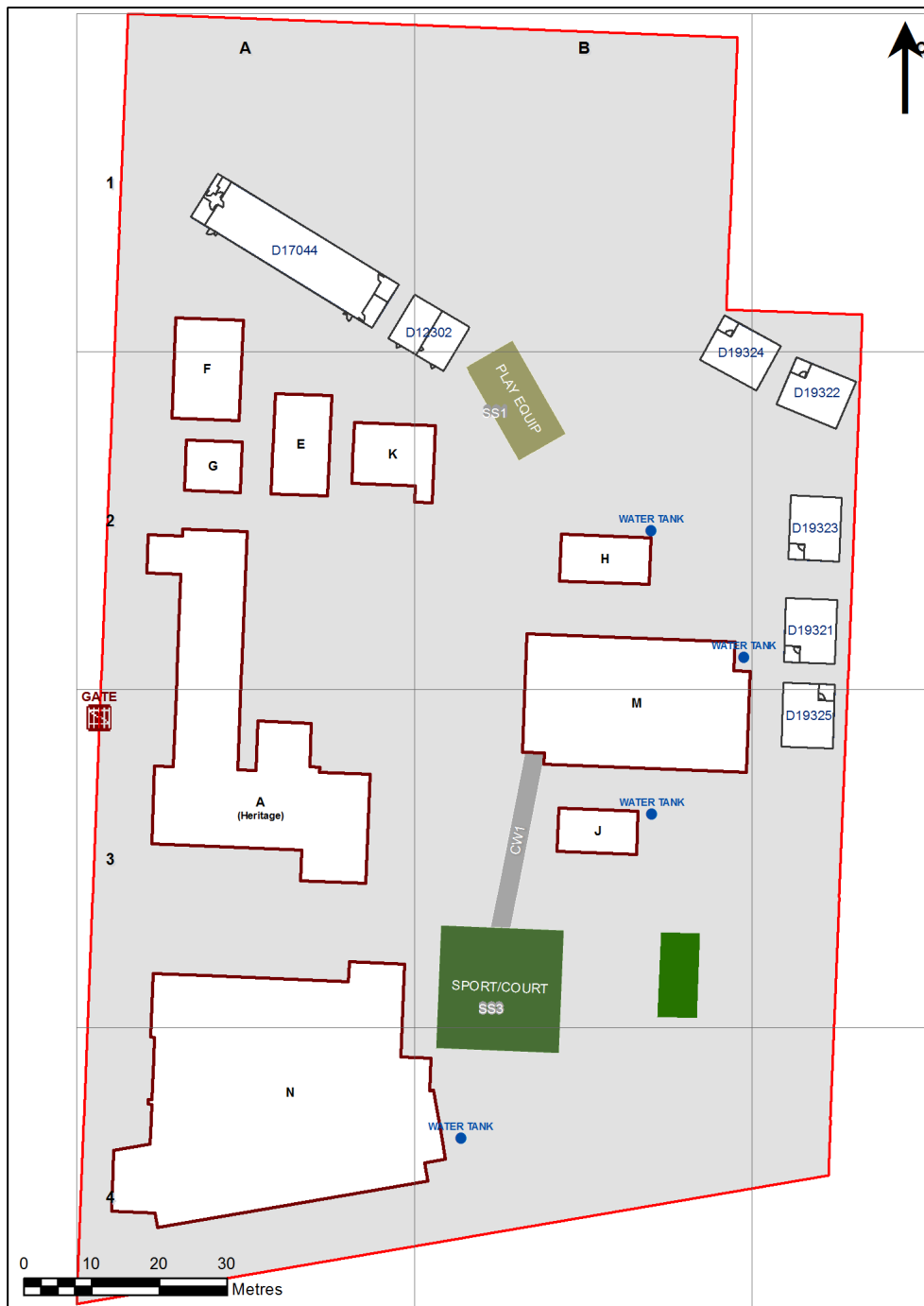

1:701

Printed: 20-Aug-2021

Ventilation Audit Key

Category	Description
	Category A Operate this space in line with COVID safe school operations . It has the required level of natural ventilation. NB. Circulation and storage areas should not be used for groups or gatherings.
	Category B This space should be occupied at 1 person per 4m ² to comply with COVID safe school operations and the guided use of spaces . The report details the number of people who can be accommodated safely in each of the identified spaces.

Entity Location	Audit Condition Classification (Capacity)	Comment
B00A - R0002 - Reading Area - (51.97 SQM)	Student Space (24)	
B00A - R0003 - Reading Area - (39.7 SQM)	Student Space (18)	
B00A - R0005 - Movement - (93.62 SQM)	Not Applicable	Circulation or storage space.
B00A - R0010 - Staff Room - (41.31 SQM)	Office (10)	
B00A - R0011 - Home Base - (56.88 SQM) - Teaching Space: 1	Student Space (26)	
B00A - R0012 - Home Base - (63.4 SQM) - Teaching Space: 1	Student Space (29)	
B00A - R0015 - Principal - (13.05 SQM)	Office (3)	
B00A - R0018 - Clerical Office - (20.9 SQM)	Office (5)	
B00A - R0019 - Home Base - (46.19 SQM) - Teaching Space: 1	Student Space (21)	
B00A - R0020 - Withdrawal Space - 2hb - (46.19 SQM)	Student Space (21)	
B00A - R0021 - Home Base - (46.19 SQM) - Teaching Space: 1	Student Space (21)	
B00A - R0022 - Withdrawal Space - 2hb - (46.39 SQM)	Student Space (21)	
B00A - R0023 - Movement - (60.02 SQM)	Not Applicable	Circulation or storage space.
B00A - R0024 - Deputy Principal - (15.33 SQM)	Office (3)	
B00A - R0029 - Interview - (10.34 SQM)	Office (2)	
B00E - R0001 - Movement - (25.21 SQM)	Not Applicable	Circulation or storage space.
B00E - R0002 - Home Base - (47.03 SQM) - Teaching Space: 1	Student Space (21)	
B00E - R0003 - Withdrawal Space - 2hb - (47.16 SQM)	Student Space (21)	
B00F - R0001 - Movement - (23.03 SQM)	Not Applicable	Circulation or storage space.
B00F - R0003 - Home Base - (53.67 SQM) - Teaching Space: 1	Student Space (24)	
B00F - R0004 - Home Base - (52.15 SQM) - Teaching Space: 1	Student Space (24)	
B00G - R0001 - Movement - (12.23 SQM)	Not Applicable	Circulation or storage space.
B00G - R0004 - Staff Room Annexe - (18.59 SQM)	Office (4)	
B00K - R0004 - Communal Space - (83.28 SQM)	Student Space (38)	
B00M - R0002 - Communal Space - (136.28 SQM)	Student Space (63)	
B00M - R0003 - Raised Platform - (67.87 SQM)	Not Applicable	Circulation or storage space.
B00M - R0016 - Canteen - (26.59 SQM)	Not Applicable	Circulation or storage space.
B00M - R0019 - Movement - (6.18 SQM)	Not Applicable	Circulation or storage space.
B00M - R0020 - Movement - (14.47 SQM)	Not Applicable	Circulation or storage space.
B00N - R0001 - Movement - (218.77 SQM)	Not Applicable	Circulation or storage space.
B00N - R0011 - Home Base - (65.01 SQM) - Teaching Space: 1	Student Space (30)	
B00N - R0013 - Home Base - (61.61 SQM) - Teaching Space: 1	Student Space (28)	
B00N - R0014 - Withdrawal Space - 2hb - (12.55 SQM)	Student Space (5)	
B00N - R0015 - Home Base - (61.61 SQM) - Teaching Space: 1	Student Space (28)	
B00N - R0016 - Home Base - (61.61 SQM) - Teaching Space: 1	Student Space (28)	
B00N - R0017 - Withdrawal Space - 2hb - (12.54 SQM)	Student Space (5)	
B00N - R0018 - Home Base - (62.25 SQM) - Teaching Space: 1	Student Space (28)	
B00N - R0020 - Practical Activities - 4hb - (123.51 SQM)	Student Space (57)	
B00N - R0021 - Reading Area - (310.16 SQM)	Student Space (143)	
B00N - R1006 - Movement - (5.67 SQM)	Not Applicable	Circulation or storage space.
B00N - R1009 - Practical Activities - 4hb - (44.46 SQM)	Student Space (20)	
B00N - R1010 - Movement - (20.89 SQM)	Not Applicable	Circulation or storage space.
B00N - R1011 - Home Base - (65.01 SQM) - Teaching Space: 1	Student Space (30)	
B00N - R1012 - Withdrawal Space - 1hb - (8.72 SQM)	Student Space (4)	
B00N - R1013 - Home Base - (61.61 SQM) - Teaching Space: 1	Student Space (28)	
B00N - R1014 - Withdrawal Space - 2hb - (12.55 SQM)	Student Space (5)	
B00N - R1015 - Home Base - (61.61 SQM) - Teaching Space: 1	Student Space (28)	
B00N - R1016 - Home Base - (61.61 SQM) - Teaching Space: 1	Student Space (28)	
B00N - R1017 - Withdrawal Space - 2hb - (12.54 SQM)	Student Space (5)	

Entity Location	Audit Condition Classification (Capacity)	Comment
B00N - R1018 - Home Base - (62.25 SQM) - Teaching Space: 1	● Student Space (28)	
B00N - R1019 - Movement - (18.29 SQM)	Not Applicable	Circulation or storage space.
B00N - R1020 - Practical Activities - 4hb - (21.47 SQM)	● Student Space (9)	
B00N - R1021 - Home Base - (61.45 SQM) - Teaching Space: 1	● Student Space (28)	
B00N - R1022 - Withdrawal Space - 2hb - (12.1 SQM)	● Student Space (5)	
B00N - R1023 - Home Base - (61.11 SQM) - Teaching Space: 1	● Student Space (28)	
B00N - R1024 - Home Base - (60.59 SQM) - Teaching Space: 1	● Student Space (28)	
B00N - R1025 - Withdrawal Space - 2hb - (12.14 SQM)	● Student Space (5)	
B00N - R1026 - Home Base - (60.62 SQM) - Teaching Space: 1	● Student Space (28)	
B00N - R1027 - Tiered Learning Space - (24.66 SQM)	● Student Space (11)	
B00N - R1031 - Movement - (333.37 SQM)	Not Applicable	Circulation or storage space.
B00N - R2006 - Movement - (5.67 SQM)	Not Applicable	Circulation or storage space.
B00N - R2009 - Practical Activities - 4hb - (39.75 SQM)	● Student Space (18)	
B00N - R2011 - Home Base - (65.01 SQM) - Teaching Space: 1	● Student Space (30)	
B00N - R2012 - Withdrawal Space - 1hb - (8.72 SQM)	● Student Space (4)	
B00N - R2013 - Home Base - (61.61 SQM) - Teaching Space: 1	● Student Space (28)	
B00N - R2014 - Withdrawal Space - 2hb - (12.55 SQM)	● Student Space (5)	
B00N - R2015 - Home Base - (61.61 SQM) - Teaching Space: 1	● Student Space (28)	
B00N - R2016 - Home Base - (61.61 SQM) - Teaching Space: 1	● Student Space (28)	
B00N - R2017 - Withdrawal Space - 2hb - (12.54 SQM)	● Student Space (5)	
B00N - R2018 - Home Base - (62.25 SQM) - Teaching Space: 1	● Student Space (28)	
B00N - R2020 - Practical Activities - 4hb - (39.2 SQM)	● Student Space (18)	
B00N - R2021 - Home Base - (60.88 SQM) - Teaching Space: 1	● Student Space (28)	
B00N - R2022 - Withdrawal Space - 2hb - (12.1 SQM)	● Student Space (5)	
B00N - R2023 - Home Base - (60.86 SQM) - Teaching Space: 1	● Student Space (28)	
B00N - R2024 - Home Base - (61 SQM) - Teaching Space: 1	● Student Space (28)	
B00N - R2025 - Withdrawal Space - 2hb - (12.14 SQM)	● Student Space (5)	
B00N - R2026 - Home Base - (60.64 SQM) - Teaching Space: 1	● Student Space (28)	
B00N - R2027 - Movement - (334.01 SQM)	Not Applicable	Circulation or storage space.
B00N - R2031 - Tiered Learning Space - (18.11 SQM)	● Student Space (8)	
OH 060 17044 - OH 060 17044 - OSHC Hub 60 - (SQM)	● Student Space ()	
OS 600 16198 - OS 600 16198 - Learning Unit - Small - (57 SQM)	● Student Space (26)	
OS 602 10178 - OS 602 10178 - Learning Unit - Standard With P.A.A. - (76 SQM)	● Student Space (35)	
OS 602 10197 - OS 602 10197 - Learning Unit - Standard With P.A.A. - (76 SQM)	● Student Space (35)	
OS 603 12289 - OS 603 12289 - Learning Unit - Standard With P.A.A. A/C - (76 SQM)	● Student Space (35)	
OS 606 17096 - OS 606 17096 - Learning Unit - Standard With P.A.A A/C - (76 SQM)	● Student Space (35)	
OS 606 17097 - OS 606 17097 - Learning Unit - Standard With P.A.A A/C - (76 SQM)	● Student Space (35)	
OS 606 17395 - OS 606 17395 - Learning Unit - Standard With P.A.A A/C - (76 SQM)	● Student Space (35)	
OS 606 19003 - OS 606 19003 - Learning Unit - Standard With P.A.A A/C - (76 SQM)	● Student Space (35)	
OS 606 19321 - OS 606 19321 - Learning Unit - Standard With P.A.A A/C - (76 SQM)	● Student Space (35)	
OS 606 19322 - OS 606 19322 - Learning Unit - Standard With P.A.A A/C - (76 SQM)	● Student Space (35)	
OS 606 19323 - OS 606 19323 - Learning Unit - Standard With P.A.A A/C - (76 SQM)	● Student Space (35)	
OS 606 19324 - OS 606 19324 - Learning Unit - Standard With P.A.A A/C - (76 SQM)	● Student Space (35)	
OS 606 19325 - OS 606 19325 - Learning Unit - Standard With P.A.A A/C - (76 SQM)	● Student Space (35)	
OS 751 12302 - OS 751 12302 - Learning Unit - ESL - (76 SQM)	● Student Space (35)	