

# VENTILATION AUDIT REPORT

<b>SCHOOL:</b>	<b>Elizabeth Macarthur High School (8584)</b>
<b>AMU REGION:</b>	<b>South Western Sydney</b>
<b>STATE ELECTORATE:</b>	<b>Camden</b>
<b>LOCAL GOVERNMENT AREA:</b>	<b>Camden</b>

8584 - Elizabeth Macarthur High School  
Site Plan (10361)

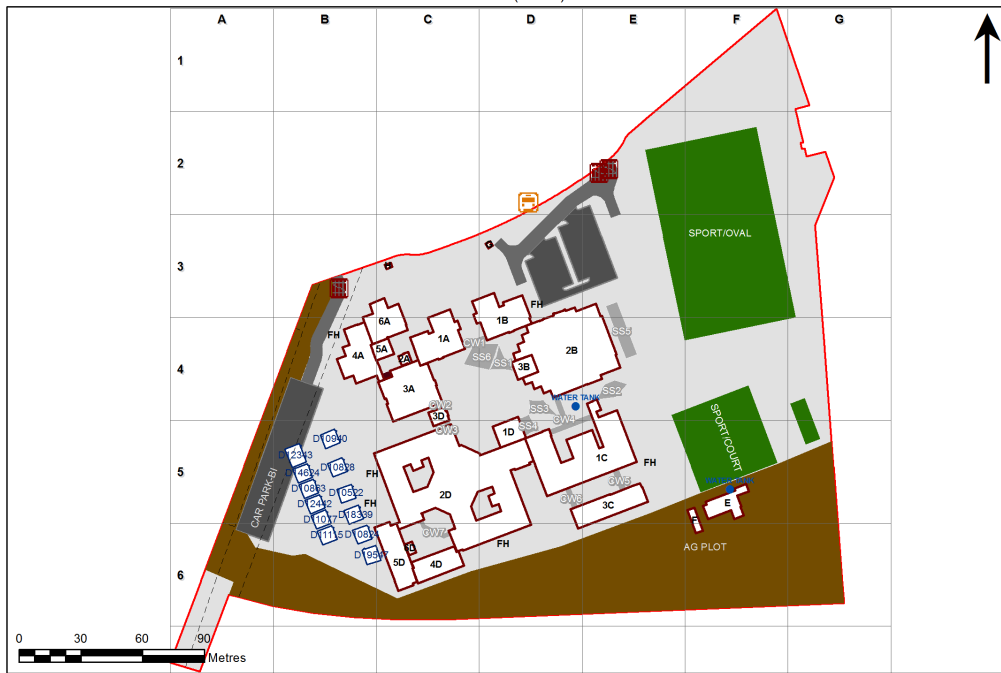

1:1,723

Printed: 16-Mar-2021

## Ventilation Audit Key

Category	Description
	Category A Operate this space in line with <a href="#">COVID safe school operations</a> . It has the required level of natural ventilation. NB. Circulation and storage areas should not be used for groups or gatherings.
	Category B This space should be occupied at 1 person per 4m <sup>2</sup> to comply with <a href="#">COVID safe school operations and the guided use of spaces</a> . The report details the number of people who can be accommodated safely in each of the identified spaces.

Entity Location	Audit Condition Classification (Capacity)	Comment
B00E - R0001 - Growing/Breeding - (9.95 SQM)	Not Applicable	Circulation or storage space.
B00E - R0002 - Growing/Breeding - (23.65 SQM)	Not Applicable	Circulation or storage space.
B01A - R0001 - Music Learning Space - (77.35 SQM) - Teaching Space: 1	● Student Space (35)	
B01A - R0008 - Music Learning Space - (62.12 SQM) - Teaching Space: 1	● Student Space (28)	
B01A - R0009 - Movement - (37.62 SQM)	Not Applicable	Circulation or storage space.
B01A - R0014 - Staff Study - (30.57 SQM)	● Office (7)	
B01B - R0002 - Clinic - Girls - (15.48 SQM)	● Office (3)	
B01B - R0005 - Clinic - Boys - (14.7 SQM)	● Office (3)	
B01B - R0006 - Leading Teacher - (15.36 SQM)	● Office (3)	
B01B - R0009 - Administration - Clerical - (43.83 SQM)	● Office (10)	
B01B - R0010 - Deputy Principal Office - (13.12 SQM)	● Office (3)	
B01B - R0011 - Deputy Principal Office - (13.17 SQM)	● Office (3)	
B01B - R0012 - Principal Office - (19.13 SQM)	● Office (4)	
B01B - R0019 - Public Entry - (32.66 SQM)	Not Applicable	Circulation or storage space.
B01B - R0021 - Ancillary Staff - (19.74 SQM)	● Office (4)	
B01B - R0023 - Pupil Entry - (45.07 SQM)	Not Applicable	Circulation or storage space.
B01C - R0018 - Laboratory L.S. - (81.11 SQM) - Teaching Space: 1	● Student Space (37)	
B01C - R0023 - Food Technology L.S. - (103.94 SQM) - Teaching Space: 1	● Student Space (48)	
B01C - R0024 - Preparation - (20.39 SQM)	Not Applicable	Circulation or storage space.
B01C - R0025 - Food Technology L.S. - (104.33 SQM) - Teaching Space: 1	● Student Space (48)	
B01C - R0027 - Design/Technology L.S. - (70.6 SQM) - Teaching Space: 1	● Student Space (32)	
B01C - R0031 - Laboratory L.S. - (81.47 SQM) - Teaching Space: 1	● Student Space (37)	
B01C - R0033 - Movement - (42.88 SQM)	Not Applicable	Circulation or storage space.
B01C - R0036 - Design L.S. - (66.04 SQM) - Teaching Space: 1	● Student Space (30)	
B01C - R0038 - Staff Study - (34.35 SQM)	● Office (8)	
B01C - R9022 - Laboratory L.S. - (80.84 SQM) - Teaching Space: 1	● Student Space (37)	
B01C - R9023 - Preparation - Science - (32.59 SQM)	Not Applicable	Circulation or storage space.
B01C - R9024 - Laboratory L.S. - (81.2 SQM) - Teaching Space: 1	● Student Space (37)	
B01C - R9027 - Laboratory L.S. - (81.47 SQM) - Teaching Space: 1	● Student Space (37)	
B01C - R9029 - Laboratory L.S. - (81.74 SQM) - Teaching Space: 1	● Student Space (37)	
B01D - R0001 - Interview/Office - Type 1 - (12.91 SQM)	● Office (3)	
B01D - R0005 - Commonroom - (102.41 SQM)	● Office (25)	
B01D - R0006 - Tea Room - (7.39 SQM)	Not Applicable	Circulation or storage space.
B02B - R0029 - Stage - (96.8 SQM)	Not Applicable	Circulation or storage space.
B02B - R0033 - Fitness Laboratory - (38.22 SQM)	● Student Space (17)	
B02B - R0036 - Staff Study - (17.6 SQM)	● Office (4)	
B02B - R0046 - General Assistants - (13.5 SQM)	● Office (3)	
B02B - R0047 - General Assistants - (5.43 SQM)	● Office (1)	
B02B - R0052 - Staff Study - (19.03 SQM)	● Office (4)	
B02B - R0054 - Movement - (5.18 SQM)	Not Applicable	Circulation or storage space.
B02B - R0057 - Multi-Purpose Space - (466.81 SQM)	● Student Space (216)	
B02B - R0059 - Movement - (14.12 SQM)	Not Applicable	Circulation or storage space.
B02B - R0062 - Movement - (15.21 SQM)	Not Applicable	Circulation or storage space.
B02B - R0067 - Staff Study - (19.49 SQM)	● Office (4)	
B02B - R1026 - Movement - (111.7 SQM)	Not Applicable	Circulation or storage space.
B02B - R9014 - Movement - (10.49 SQM)	Not Applicable	Circulation or storage space.
B02B - R9022 - Movement - (9.37 SQM)	Not Applicable	Circulation or storage space.
B02D - R0008 - General Learning Space - (47.29 SQM) - Teaching Space: 1	● Student Space (21)	
B02D - R0009 - General Learning Space - (47.67 SQM) - Teaching Space: 1	● Student Space (22)	

Entity Location	Audit Condition Classification (Capacity)	Comment
B02D - R0012 - Staff Study - (39.82 SQM)	Office (9)	
B02D - R0015 - General Learning Space - (49.67 SQM) - Teaching Space: 1	Student Space (23)	
B02D - R0016 - General Learning Space - (49.81 SQM) - Teaching Space: 1	Student Space (23)	
B02D - R0017 - General Learning Space - (49.9 SQM) - Teaching Space: 1	Student Space (23)	
B02D - R0020 - Staff Study - (15.52 SQM)	Office (3)	
B02D - R0029 - Seminar/Study - (13.15 SQM)	Office (3)	
B02D - R0030 - Audio Visual Workroom - (31.99 SQM)	Student Space (14)	
B02D - R0033 - Staff Study - (15.22 SQM)	Office (3)	
B02D - R0037 - General Learning Space - (49.73 SQM) - Teaching Space: 1	Student Space (23)	
B02D - R0038 - General Learning Space - (49.82 SQM) - Teaching Space: 1	Student Space (23)	
B02D - R0039 - General Learning Space - (49.82 SQM) - Teaching Space: 1	Student Space (23)	
B02D - R0043 - Shared Study Space - (39.67 SQM)	Office (9)	
B02D - R0045 - General Learning Space - (47.87 SQM) - Teaching Space: 1	Student Space (22)	
B02D - R0046 - General Learning Space - (47.67 SQM) - Teaching Space: 1	Student Space (22)	
B02D - R0047 - General Learning Space - (43.96 SQM) - Teaching Space: 1	Student Space (20)	
B02D - R0050 - Movement - (482.35 SQM)	Not Applicable	Circulation or storage space.
B02D - R0056 - Staff Study - (24.11 SQM)	Office (6)	
B02D - R0058 - Darkroom Space - (10.17 SQM)	Office (2)	
B02D - R0059 - Dark Room - (16.39 SQM)	Office (4)	
B02D - R0060 - Study Space - (16.14 SQM)	Not Applicable	Circulation or storage space.
B02D - R0065 - Main Entry - (18.17 SQM)	Not Applicable	Circulation or storage space.
B02D - R0066 - Main Area - (378.67 SQM)	Not Applicable	Circulation or storage space.
B02D - R0069 - Seminar/Study - (26.46 SQM)	Office (6)	
B02D - R0072 - Movement Studio - (92.29 SQM)	Not Applicable	Circulation or storage space.
B02D - R0078 - Tiered Learning Area - (58.15 SQM)	Student Space (26)	
B02D - R1001 - Leading Teacher - (12.3 SQM)	Office (3)	
B02D - R1003 - General Learning Space - (47.55 SQM) - Teaching Space: 1	Student Space (22)	
B02D - R1004 - General Learning Space - (46.84 SQM) - Teaching Space: 1	Student Space (21)	
B02D - R1005 - General Learning Space - (47.02 SQM) - Teaching Space: 1	Student Space (21)	
B02D - R1007 - General Learning Space - (39.49 SQM) - Teaching Space: 1	Student Space (18)	
B02D - R1009 - Staff Study - (15.24 SQM)	Office (3)	
B02D - R1010 - Movement - (90.64 SQM)	Not Applicable	Circulation or storage space.
B02D - R1012 - Computer Learning Space - (39.54 SQM) - Teaching Space: 1	Student Space (18)	
B02D - R1014 - General Learning Space - (47.58 SQM) - Teaching Space: 1	Student Space (22)	
B02D - R1015 - General Learning Space - (47.39 SQM) - Teaching Space: 1	Student Space (21)	
B02D - R1016 - Computer Learning Space - (47.31 SQM) - Teaching Space: 1	Student Space (21)	
B02D - R1019 - Study Space - (15.22 SQM)	Not Applicable	Circulation or storage space.
B02D - R1020 - Movement - (90.45 SQM)	Not Applicable	Circulation or storage space.
B02D - R1021 - Staff Study - (38.24 SQM)	Office (9)	
B02D - R1025 - Staff Study - (38.13 SQM)	Office (9)	
B03A - R0001 - Art Learning Space - (61.24 SQM) - Teaching Space: 1	Student Space (28)	
B03A - R0002 - Staff Study - (25.84 SQM)	Office (6)	
B03A - R0005 - Art Learning Space - (61.42 SQM) - Teaching Space: 1	Student Space (28)	
B03A - R0008 - Art Learning Space - (61.56 SQM) - Teaching Space: 1	Student Space (28)	
B03A - R0010 - Art Learning Space - (61.41 SQM) - Teaching Space: 1	Student Space (28)	
B03A - R0011 - Movement - (55.2 SQM)	Not Applicable	Circulation or storage space.
B03A - R0016 - Craft Room - (44.73 SQM)	Office (11)	
B03A - R1001 - Design/Technology L.S. - (56.3 SQM) - Teaching Space: 1	Student Space (26)	

Entity Location	Audit Condition Classification (Capacity)	Comment
B03A - R1004 - Design/Technology L.S. - (56.53 SQM) - Teaching Space: 1	● Student Space (26)	
B03A - R1005 - Movement - (15.97 SQM)	Not Applicable	Circulation or storage space.
B03A - R1007 - Staff Study - (25.55 SQM)	● Office (6)	
B03B - R0001 - Student Canteen - (62.08 SQM)	Not Applicable	Circulation or storage space.
B03C - R0001 - General Learning Space - (53.87 SQM) - Teaching Space: 1	● Student Space (24)	
B03C - R0002 - General Learning Space - (53.08 SQM) - Teaching Space: 1	● Student Space (24)	
B03C - R0003 - General Learning Space - (53.15 SQM) - Teaching Space: 1	● Student Space (24)	
B03C - R0005 - General Learning Space - (53.59 SQM) - Teaching Space: 1	● Student Space (24)	
B03C - R9005 - Staff Study - (92.29 SQM)	● Office (23)	
B04A - R0001 - Materials Technology L.S. - (91.83 SQM) - Teaching Space: 1	● Student Space (42)	
B04A - R0002 - Wood Technology Bay - (34.91 SQM)	Not Applicable	Circulation or storage space.
B04A - R0003 - Materials Technology L.S. - (92.01 SQM) - Teaching Space: 1	● Student Space (42)	
B04D - R0002 - General Learning Space - (48.58 SQM) - Teaching Space: 1	● Student Space (22)	
B04D - R0003 - General Learning Space - (48.79 SQM) - Teaching Space: 1	● Student Space (22)	
B04D - R0004 - General Learning Space - (48.51 SQM) - Teaching Space: 1	● Student Space (22)	
B05A - R0005 - Workshop - (50.87 SQM)	● Student Space (23)	
B05D - R0001 - General Learning Space - (48.43 SQM) - Teaching Space: 1	● Student Space (22)	
B05D - R0002 - General Learning Space - (48.5 SQM) - Teaching Space: 1	● Student Space (22)	
B05D - R0003 - General Learning Space - (48.5 SQM) - Teaching Space: 1	● Student Space (22)	
B06A - R0001 - Materials Technology L.S. - (91.75 SQM) - Teaching Space: 1	● Student Space (42)	
B06A - R0002 - Metal Technology Bay - (34.45 SQM)	Not Applicable	Circulation or storage space.
B06A - R0003 - Materials Technology L.S. - (91.76 SQM) - Teaching Space: 1	● Student Space (42)	
B06D - R0001 - Interview/Office - Type 1 - (15.62 SQM)	● Office (3)	
OS 600 10522 - OS 600 10522 - Learning Unit - Small - (57 SQM)	● Student Space (26)	
OS 600 10824 - OS 600 10824 - Learning Unit - Small - (57 SQM)	● Student Space (26)	
OS 600 10828 - OS 600 10828 - Learning Unit - Small - (57 SQM)	● Student Space (26)	
OS 600 10863 - OS 600 10863 - Learning Unit - Small - (57 SQM)	● Student Space (26)	
OS 600 10940 - OS 600 10940 - Learning Unit - Small - (57 SQM)	● Student Space (26)	
OS 600 11077 - OS 600 11077 - Learning Unit - Small - (57 SQM)	● Student Space (26)	
OS 600 11115 - OS 600 11115 - Learning Unit - Small - (57 SQM)	● Student Space (26)	
OS 600 12442 - OS 600 12442 - Learning Unit - Small - (57 SQM)	● Student Space (26)	
OS 600 14624 - OS 600 14624 - Learning Unit - Small - (114 SQM)	● Student Space (52)	
OS 600 18339 - OS 600 18339 - Learning Unit - Small - (57 SQM)	● Student Space (26)	
OS 600 19547 - OS 600 19547 - Learning Unit - Small - (57 SQM)	● Student Space (26)	
OS 601 12343 - OS 601 12343 - Learning Unit - Standard/Withdrawal - (76 SQM)	● Student Space (35)	