

VENTILATION AUDIT REPORT

SCHOOL:	Dunedoo Central School (1789)
AMU REGION:	North Western NSW
STATE ELECTORATE:	Barwon
LOCAL GOVERNMENT AREA:	Warrumbungle

1789 - Dunedoo Central School
Site Plan (12481)

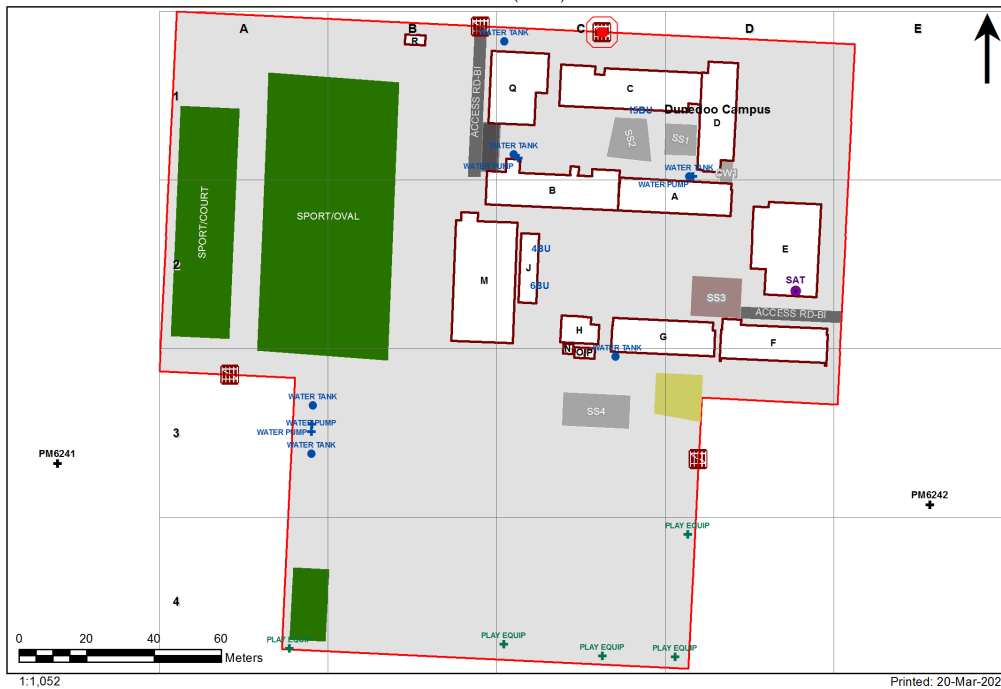







1:1,052

Printed: 20-Mar-2020

Ventilation Audit Key

Category	Description
	Category A Operate this space in line with COVID safe school operations . It has the required level of natural ventilation. NB. Circulation and storage areas should not be used for groups or gatherings.
	Category B This space should be occupied at 1 person per 4m ² to comply with COVID safe school operations and the guided use of spaces . The report details the number of people who can be accommodated safely in each of the identified spaces.

Entity Location	Audit Condition Classification (Capacity)	Comment
B00A - R0002 - Deputy Principal - (29.01 SQM)	Office (7)	
B00A - R0004 - Movement - (12.53 SQM)	Not Applicable	Circulation or storage space.
B00A - R0007 - General Learning Space - (52.12 SQM) - Teaching Space: 1	Student Space (24)	
B00A - R0008 - General Learning Space - (52.18 SQM) - Teaching Space: 1	Student Space (24)	
B00A - R0009 - Design L.S. - (79.41 SQM) - Teaching Space: 1	Student Space (36)	
B00B - R0001 - Darkroom Space - (6.7 SQM)	Office (1)	
B00B - R0002 - Movement - (6.14 SQM)	Not Applicable	Circulation or storage space.
B00B - R0012 - Movement - (29.31 SQM)	Not Applicable	Circulation or storage space.
B00B - R0013 - Canteen - (37.6 SQM)	Not Applicable	Circulation or storage space.
B00B - R0017 - Movement - (10.45 SQM)	Not Applicable	Circulation or storage space.
B00B - R0018 - Movement - (7.2 SQM)	Not Applicable	Circulation or storage space.
B00B - R0024 - Materials Learning Space - Type 1 - (92.36 SQM) - Teaching Space: 1	Student Space (42)	
B00B - R0025 - Preparation - Materials - (14.31 SQM)	Not Applicable	Circulation or storage space.
B00B - R1001 - Movement - (7.95 SQM)	Not Applicable	Circulation or storage space.
B00B - R1003 - Computer Learning Space - (52.55 SQM) - Teaching Space: 1	Student Space (24)	
B00B - R1004 - Computer Learning Space - (52.55 SQM) - Teaching Space: 1	Student Space (24)	
B00B - R1005 - General Learning Space - (38.14 SQM) - Teaching Space: 1	Student Space (17)	
B00B - R1006 - Senior Study - (39.26 SQM)	Office (9)	
B00B - R1008 - Staff Room Annexe - (25.62 SQM)	Office (6)	
B00B - R1009 - Staff Room Annexe - (25.69 SQM)	Office (6)	
B00B - R1010 - Staff Room Annexe - (21.78 SQM)	Office (5)	
B00B - R1011 - Movement - (17.84 SQM)	Not Applicable	Circulation or storage space.
B00C - R0006 - Duplicating Workroom - (12.11 SQM)	Office (3)	
B00C - R0007 - Duplicating Workroom - (16.82 SQM)	Office (4)	
B00C - R0008 - Interview - (8.58 SQM)	Office (2)	
B00C - R0012 - Principal - (21.39 SQM)	Office (5)	
B00C - R0014 - Clerical Office - (21.67 SQM)	Office (5)	
B00C - R0015 - Clerical Office - (12.98 SQM)	Office (3)	
B00C - R0016 - Movement - (9.95 SQM)	Not Applicable	Circulation or storage space.
B00C - R0017 - Entry Vestibule - (16.87 SQM)	Not Applicable	Circulation or storage space.
B00C - R0020 - General Learning Space - (62.66 SQM) - Teaching Space: 1	Student Space (29)	
B00C - R1005 - Staff Room - (50.41 SQM)	Office (12)	
B00D - R0010 - Materials Technology L.S. - (191.85 SQM) - Teaching Space: 1	Student Space (89)	
B00D - R0011 - Welding Area - (8.26 SQM)	Not Applicable	Circulation or storage space.
B00D - R1003 - Laboratory L.S. - (104.08 SQM) - Teaching Space: 1	Student Space (48)	
B00D - R1004 - Preparation - (17.59 SQM)	Not Applicable	Circulation or storage space.
B00E - R0002 - Reading Area - (155.58 SQM)	Student Space (72)	
B00E - R0006 - Special Programs Room - (43.92 SQM)	Student Space (20)	
B00E - R0011 - Computer Learning Space - (80.47 SQM) - Teaching Space: 1	Student Space (37)	
B00E - R0012 - Movement - (26.8 SQM)	Not Applicable	Circulation or storage space.
B00F - R0002 - Movement - (6.87 SQM)	Not Applicable	Circulation or storage space.
B00F - R0003 - Deputy Principal - (15.57 SQM)	Office (3)	
B00F - R0004 - Home Base - (56.55 SQM) - Teaching Space: 1	Student Space (26)	
B00F - R0007 - Practical Activities - 1hb - (16.75 SQM)	Student Space (7)	
B00F - R0009 - Home Base - (57.18 SQM) - Teaching Space: 1	Student Space (26)	
B00F - R0010 - Home Base - (56.71 SQM) - Teaching Space: 1	Student Space (26)	
B00G - R0003 - Home Base - (50.08 SQM) - Teaching Space: 1	Student Space (23)	
B00G - R0004 - Staff Room Annexe - (26.75 SQM)	Office (6)	
B00G - R0005 - Home Base - (49.28 SQM) - Teaching Space: 1	Student Space (22)	

Entity Location	Audit Condition Classification (Capacity)	Comment
B00G - R0008 - Home Base - (63.56 SQM) - Teaching Space: 1	 Student Space (29)	
B00H - R0002 - Music Learning Space - (59.87 SQM) - Teaching Space: 1	 Student Space (27)	
B00M - R0001 - Multi-Purpose Space - (485.41 SQM)	 Student Space (225)	
B00M - R0002 - Stage - (53.03 SQM)	Not Applicable	Circulation or storage space.
B00Q - R0001 - General Learning Space - Type 3 - (60 SQM) - Teaching Space: 1	 Student Space (27)	
B00Q - R0002 - Science Laboratory - (60 SQM)	 Student Space (27)	
B00Q - R0003 - Preparation - (30.32 SQM)	Not Applicable	Circulation or storage space.
B00Q - R0004 - Staff Study - (21.03 SQM)	 Office (5)	
B00Q - R0005 - Seminar - Type 2 - (21.03 SQM)	 Office (5)	
B00Q - R0008 - Movement - (5.96 SQM)	Not Applicable	Circulation or storage space.