

VENTILATION AUDIT REPORT

SCHOOL:	Dulwich High School of Visual Arts and Design (8833)
AMU REGION:	Sydney
STATE ELECTORATE:	Summer Hill
LOCAL GOVERNMENT AREA:	Inner West

8833 - Dulwich High School of Visual Arts and Design
Site Plan (12480)

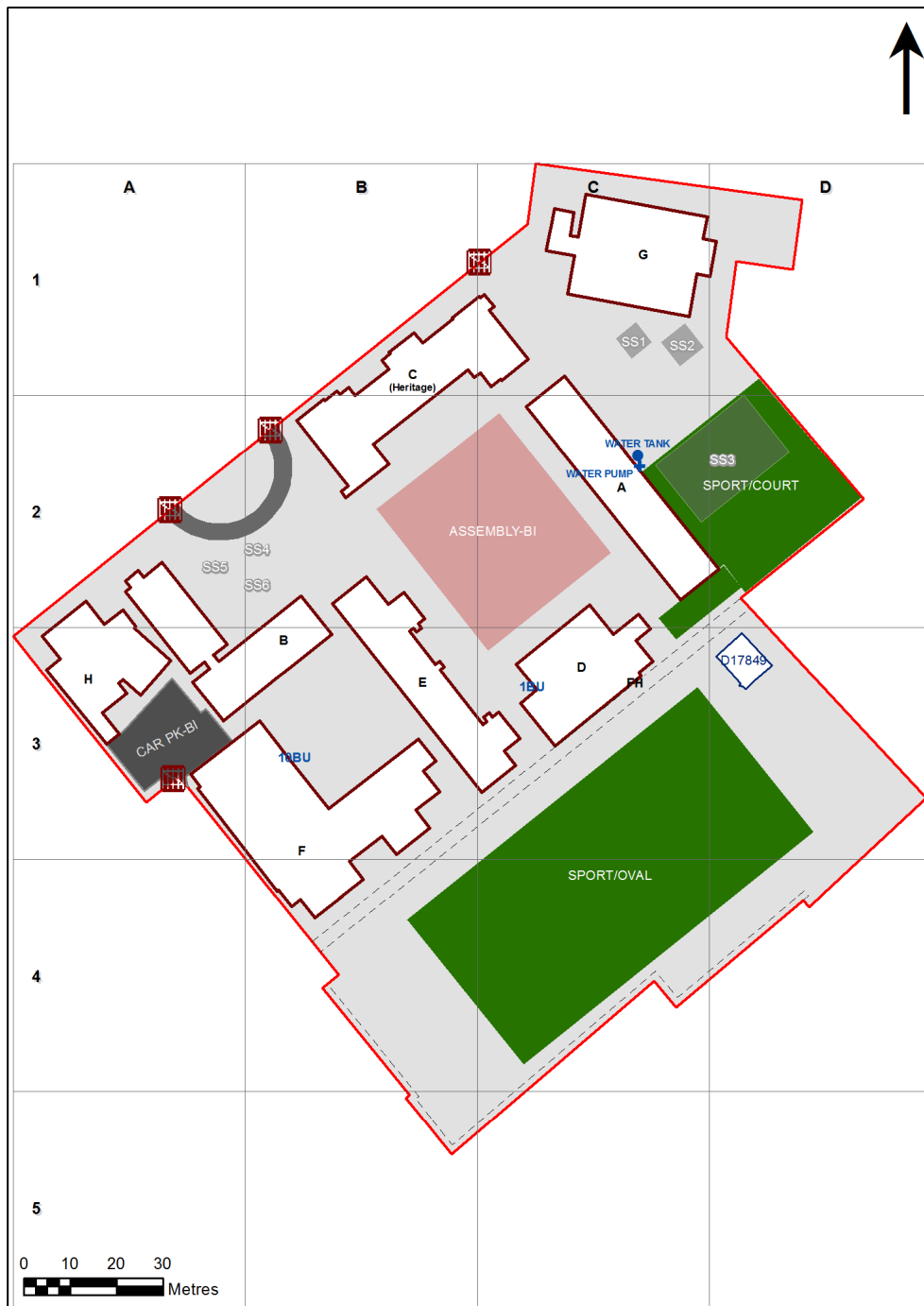

1:1,021

Printed: 30-Mar-2021

Ventilation Audit Key

Category	Description
	Category A Operate this space in line with COVID safe school operations . It has the required level of natural ventilation. NB. Circulation and storage areas should not be used for groups or gatherings.
	Category B This space should be occupied at 1 person per 4m ² to comply with COVID safe school operations and the guided use of spaces . The report details the number of people who can be accommodated safely in each of the identified spaces.

Entity Location	Audit Condition Classification (Capacity)	Comment
B00A - R0001 - Computer Learning Space - (65.45 SQM) - Teaching Space: 1	● Student Space (30)	
B00A - R0008 - Food Technology L.S. - (79.45 SQM) - Teaching Space: 1	● Student Space (36)	
B00A - R0010 - Staff Study - (18.76 SQM)	○ Office (4)	
B00A - R0013 - Movement - (105.7 SQM)	Not Applicable	Circulation or storage space.
B00A - R0016 - Movement - (15.03 SQM)	Not Applicable	Circulation or storage space.
B00A - R0018 - Movement - (9.84 SQM)	Not Applicable	Circulation or storage space.
B00A - R0019 - Preparation - Materials - (17.54 SQM)	Not Applicable	Circulation or storage space.
B00A - R0021 - Food Technology L.S. - (77.41 SQM) - Teaching Space: 1	● Student Space (35)	
B00A - R1003 - Preparation - (25.01 SQM)	Not Applicable	Circulation or storage space.
B00A - R1004 - Laboratory L.S. - (86.91 SQM) - Teaching Space: 1	● Student Space (40)	
B00A - R1005 - Design L.S. - (65.8 SQM) - Teaching Space: 1	● Student Space (30)	
B00A - R1010 - Movement - (105.74 SQM)	Not Applicable	Circulation or storage space.
B00A - R1012 - Movement - (9.43 SQM)	Not Applicable	Circulation or storage space.
B00A - R1014 - Movement - (9.43 SQM)	Not Applicable	Circulation or storage space.
B00A - R1015 - Staff Study - (13.5 SQM)	○ Office (3)	
B00A - R1016 - Staff Study - (13.2 SQM)	○ Office (3)	
B00A - R1017 - Staff Study - (56.49 SQM)	○ Office (14)	
B00A - R9001 - Staff Study - (25.19 SQM)	○ Office (6)	
B00A - R9010 - Movement - (53.66 SQM)	Not Applicable	Circulation or storage space.
B00A - R9015 - Movement - (16.93 SQM)	Not Applicable	Circulation or storage space.
B00B - R0001 - Staff Study - (25.01 SQM)	○ Office (6)	
B00B - R0002 - Movement - (11.23 SQM)	Not Applicable	Circulation or storage space.
B00B - R0003 - Staff Study - (9.79 SQM)	○ Office (2)	
B00B - R0004 - Staff Study - (9.9 SQM)	○ Office (2)	
B00B - R0005 - General Learning Space - (47.54 SQM) - Teaching Space: 1	● Student Space (22)	
B00B - R0006 - General Learning Space - (51.54 SQM) - Teaching Space: 1	● Student Space (23)	
B00B - R0007 - Movement - (11.4 SQM)	Not Applicable	Circulation or storage space.
B00B - R0023 - Movement - (69.52 SQM)	Not Applicable	Circulation or storage space.
B00B - R1001 - Movement - (11.27 SQM)	Not Applicable	Circulation or storage space.
B00B - R1007 - Staff Study - (25.05 SQM)	○ Office (6)	
B00B - R1011 - Movement - (11.23 SQM)	Not Applicable	Circulation or storage space.
B00B - R1012 - Movement - (65.44 SQM)	Not Applicable	Circulation or storage space.
B00B - R9002 - General Assistants - (9.78 SQM)	○ Office (2)	
B00C - R0001 - Staff Study - (35.41 SQM)	○ Office (8)	
B00C - R0002 - Special Learning Space - (44.67 SQM) - Teaching Space: 1	● Student Space (20)	
B00C - R0003 - Movement - (10.54 SQM)	Not Applicable	Circulation or storage space.
B00C - R0005 - Movement - (24.95 SQM)	Not Applicable	Circulation or storage space.
B00C - R0012 - Staff Study - (9.58 SQM)	○ Office (2)	
B00C - R0018 - Pupil Entry - (5.99 SQM)	Not Applicable	Circulation or storage space.
B00C - R0021 - Movement - (84.91 SQM)	Not Applicable	Circulation or storage space.
B00C - R0022 - Public Reception - (17.02 SQM)	Not Applicable	Circulation or storage space.
B00C - R0024 - Interview/Office - Type 1 - (11.95 SQM)	○ Office (2)	
B00C - R0025 - Principal Office - (21.46 SQM)	○ Office (5)	
B00C - R0026 - Movement - (6.68 SQM)	Not Applicable	Circulation or storage space.
B00C - R0028 - Deputy Principal Office - (11.62 SQM)	○ Office (2)	
B00C - R0029 - Administration - Clerical - (44.5 SQM)	○ Office (11)	
B00C - R0030 - Duplicating Workroom - (16.67 SQM)	○ Office (4)	
B00C - R0031 - Clinic - (6.77 SQM)	○ Office (1)	
B00C - R0032 - Interview/Office - Type 1 - (12.36 SQM)	○ Office (3)	
B00C - R0033 - Administration - Executive - (20.76 SQM)	○ Office (5)	
B00C - R0034 - Movement - (16.85 SQM)	Not Applicable	Circulation or storage space.

Entity Location	Audit Condition Classification (Capacity)	Comment
B00C - R0038 - Interview/Meeting - (47.43 SQM)	Office (11)	
B00C - R0040 - Staff Kitchen - (7.03 SQM)	Office (1)	
B00C - R0041 - Commonroom - (45.95 SQM)	Office (11)	
B00C - R1001 - General Learning Space - (35.66 SQM) - Teaching Space: 1	Student Space (16)	
B00C - R1003 - General Learning Space - (39.05 SQM) - Teaching Space: 1	Student Space (18)	
B00C - R1004 - Staff Study - (14.51 SQM)	Office (3)	
B00C - R1005 - General Learning Space - (41.85 SQM) - Teaching Space: 1	Student Space (19)	
B00C - R1006 - General Learning Space - (40.47 SQM) - Teaching Space: 1	Student Space (18)	
B00C - R1007 - Staff Study - (36.54 SQM)	Office (9)	
B00C - R1008 - Computer Learning Space - (58.43 SQM) - Teaching Space: 1	Student Space (27)	
B00C - R1011 - General Learning Space - (52.79 SQM) - Teaching Space: 1	Student Space (24)	
B00C - R1012 - General Learning Space - (47.22 SQM) - Teaching Space: 1	Student Space (21)	
B00C - R1015 - Movement - (104.87 SQM)	Not Applicable	Circulation or storage space.
B00C - R1016 - Movement - (18.38 SQM)	Not Applicable	Circulation or storage space.
B00C - R9001 - Art Learning Space - (33.19 SQM) - Teaching Space: 1	Student Space (15)	
B00D - R0002 - General Learning Space - (47.07 SQM) - Teaching Space: 1	Student Space (21)	
B00D - R0004 - General Learning Space - (48.03 SQM) - Teaching Space: 1	Student Space (22)	
B00D - R0005 - General Learning Space - (47.34 SQM) - Teaching Space: 1	Student Space (21)	
B00D - R0008 - General Learning Space - (49.6 SQM) - Teaching Space: 1	Student Space (23)	
B00D - R0009 - General Learning Space - (48.58 SQM) - Teaching Space: 1	Student Space (22)	
B00D - R0011 - Movement - (61.21 SQM)	Not Applicable	Circulation or storage space.
B00D - R0014 - Movement - (7.17 SQM)	Not Applicable	Circulation or storage space.
B00D - R0015 - Movement - (18.96 SQM)	Not Applicable	Circulation or storage space.
B00D - R1001 - General Learning Space - (47.19 SQM) - Teaching Space: 1	Student Space (21)	
B00D - R1002 - Senior Seminar - (18.39 SQM)	Office (4)	
B00D - R1003 - General Learning Space - (48.21 SQM) - Teaching Space: 1	Student Space (22)	
B00D - R1005 - Staff Study - (28.28 SQM)	Office (7)	
B00D - R1007 - General Learning Space - (49.92 SQM) - Teaching Space: 1	Student Space (23)	
B00D - R1008 - General Learning Space - (49.83 SQM) - Teaching Space: 1	Student Space (23)	
B00D - R1011 - Movement - (70.83 SQM)	Not Applicable	Circulation or storage space.
B00D - R1012 - Movement - (5.21 SQM)	Not Applicable	Circulation or storage space.
B00E - R0003 - General Learning Space - (63.92 SQM) - Teaching Space: 1	Student Space (29)	
B00E - R0006 - Movement - (31.98 SQM)	Not Applicable	Circulation or storage space.
B00E - R0007 - Darkroom Space - (8.04 SQM)	Office (2)	
B00E - R0008 - Darkroom Space - (23.45 SQM)	Office (5)	
B00E - R0009 - General Learning Space - (32.08 SQM) - Teaching Space: 1	Student Space (14)	
B00E - R0010 - Design L.S. - (62.1 SQM) - Teaching Space: 1	Student Space (28)	
B00E - R0011 - Movement - (5.76 SQM)	Not Applicable	Circulation or storage space.
B00E - R0013 - Staff Study - (28.66 SQM)	Office (7)	
B00E - R0028 - Movement - (5.82 SQM)	Not Applicable	Circulation or storage space.
B00E - R0030 - Computer Learning Space - (82.98 SQM) - Teaching Space: 1	Student Space (38)	
B00E - R0031 - Seminar - (83.58 SQM)	Office (20)	
B00E - R0035 - Movement - (10.17 SQM)	Not Applicable	Circulation or storage space.
B00E - R1001 - Music Learning Space - (65.25 SQM) - Teaching Space: 1	Student Space (30)	
B00E - R1006 - Music Learning Space - (65.19 SQM) - Teaching Space: 1	Student Space (30)	
B00E - R1007 - Materials Technology L.S. - (65.47 SQM) - Teaching Space: 1	Student Space (30)	
B00E - R1009 - Materials Technology L.S. - (88.5 SQM) - Teaching Space: 1	Student Space (41)	
B00E - R1013 - Materials Technology L.S. - (81.62 SQM) - Teaching Space: 1	Student Space (37)	

Entity Location	Audit Condition Classification (Capacity)	Comment
B00E - R1015 - Movement - (28.67 SQM)	Not Applicable	Circulation or storage space.
B00E - R1016 - Movement - (17.48 SQM)	Not Applicable	Circulation or storage space.
B00F - R0004 - Student Canteen - (32.65 SQM)	Not Applicable	Circulation or storage space.
B00F - R0006 - Gymnasium - (450.79 SQM)	● Student Space (209)	
B00F - R0007 - Movement - (5.33 SQM)	Not Applicable	Circulation or storage space.
B00F - R0021 - Movement - (119.98 SQM)	Not Applicable	Circulation or storage space.
B00G - M2002 - Main Area - (127.2 SQM)	Not Applicable	Circulation or storage space.
B00G - M2003 - Seminar - (15.06 SQM)	● Office (3)	
B00G - M2004 - Seminar - (20.77 SQM)	● Office (5)	
B00G - R0001 - General Learning Space - (56.68 SQM) - Teaching Space: 1	● Student Space (26)	
B00G - R0003 - Staff Study - (27.79 SQM)	● Office (6)	
B00G - R0004 - General Learning Space - (56.16 SQM) - Teaching Space: 1	● Student Space (26)	
B00G - R0005 - Staff Study - (26.87 SQM)	● Office (6)	
B00G - R0011 - General Learning Space - (55.36 SQM) - Teaching Space: 1	● Student Space (25)	
B00G - R0012 - General Learning Space - (55.95 SQM) - Teaching Space: 1	● Student Space (25)	
B00G - R0013 - General Learning Space - (56.75 SQM) - Teaching Space: 1	● Student Space (26)	
B00G - R0014 - Movement - (67.73 SQM)	Not Applicable	Circulation or storage space.
B00G - R0018 - Movement - (19.27 SQM)	Not Applicable	Circulation or storage space.
B00G - R0020 - Movement - (43.39 SQM)	Not Applicable	Circulation or storage space.
B00G - R0021 - Movement - (26.86 SQM)	Not Applicable	Circulation or storage space.
B00G - R0024 - Movement - (43.38 SQM)	Not Applicable	Circulation or storage space.
B00G - R1001 - Laboratory L.S. - (91.8 SQM) - Teaching Space: 1	● Student Space (42)	
B00G - R1003 - Preparation - (47.32 SQM)	Not Applicable	Circulation or storage space.
B00G - R1004 - Laboratory L.S. - (92.17 SQM) - Teaching Space: 1	● Student Space (42)	
B00G - R1005 - Laboratory L.S. - (91.98 SQM) - Teaching Space: 1	● Student Space (42)	
B00G - R1006 - Preparation - (47.15 SQM)	Not Applicable	Circulation or storage space.
B00G - R1007 - Laboratory L.S. - (91.99 SQM) - Teaching Space: 1	● Student Space (42)	
B00G - R1008 - Movement - (66.48 SQM)	Not Applicable	Circulation or storage space.
B00G - R1012 - Movement - (10.83 SQM)	Not Applicable	Circulation or storage space.
B00G - R1013 - Movement - (25.68 SQM)	Not Applicable	Circulation or storage space.
B00G - R2001 - Seminar - (15.06 SQM)	● Office (3)	
B00G - R2002 - Seminar - (15.06 SQM)	● Office (3)	
B00G - R2005 - Seminar - (15.49 SQM)	● Office (3)	
B00G - R2006 - Seminar - (15.53 SQM)	● Office (3)	
B00G - R2007 - Main Area - (392.58 SQM)	Not Applicable	Circulation or storage space.
B00G - R2008 - Audio Visual Workroom - (27.47 SQM)	● Student Space (12)	
B00G - R2010 - Workroom - (22.98 SQM)	● Office (5)	
B00G - R2018 - Movement - (22.01 SQM)	Not Applicable	Circulation or storage space.
B00H - R0001 - Staff Study - (20.86 SQM)	● Office (5)	
B00H - R0004 - Movement - (8.64 SQM)	Not Applicable	Circulation or storage space.
B00H - R0005 - Movement - (44.73 SQM)	Not Applicable	Circulation or storage space.
B00H - R0006 - Workshop - (116.56 SQM)	● Student Space (54)	
B00H - R0007 - Movement - (8.03 SQM)	Not Applicable	Circulation or storage space.
B00H - R0010 - Movement - (10.99 SQM)	Not Applicable	Circulation or storage space.
B00H - R0011 - Art Entry/Display - (71.29 SQM)	Not Applicable	Circulation or storage space.
B00H - R0013 - Movement - (6.84 SQM)	Not Applicable	Circulation or storage space.
B00H - R0019 - Movement - (20.88 SQM)	Not Applicable	Circulation or storage space.
B00H - R1001 - Computer Learning Space - (57.7 SQM) - Teaching Space: 1	● Student Space (26)	
B00H - R1004 - Movement - (16.67 SQM)	Not Applicable	Circulation or storage space.
B00H - R1005 - Workshop - (106.47 SQM)	● Student Space (49)	