

VENTILATION AUDIT REPORT

SCHOOL:	Drummoyne Public School (1774)
AMU REGION:	Sydney
STATE ELECTORATE:	Drummoyne
LOCAL GOVERNMENT AREA:	Canada Bay

1774 - Drummoyne Public School
Site Plan (12478)

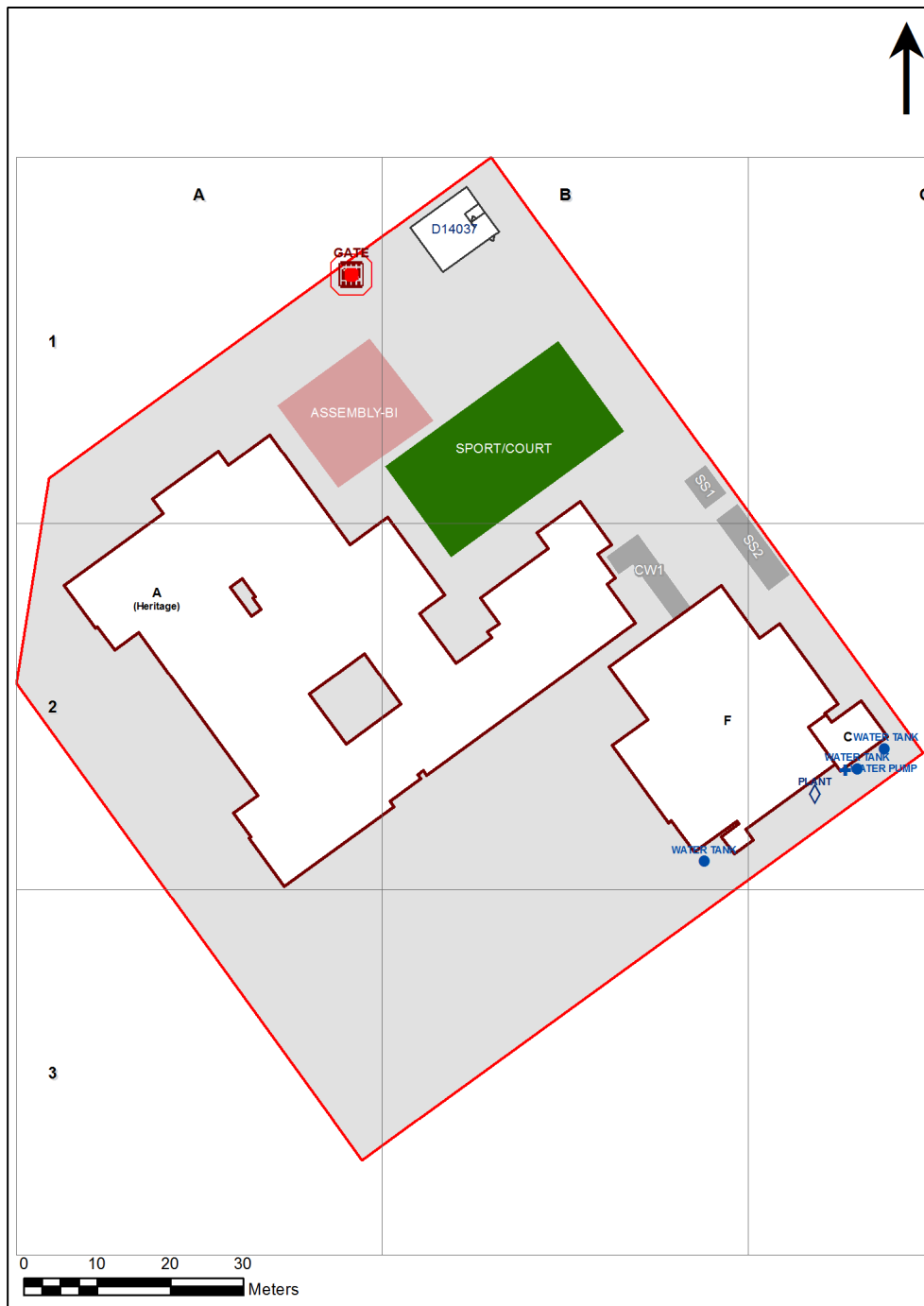







1:648

Printed: 20-Mar-2020

Ventilation Audit Key

Category	Description
	Category A Operate this space in line with COVID safe school operations . It has the required level of natural ventilation. NB. Circulation and storage areas should not be used for groups or gatherings.
	Category B This space should be occupied at 1 person per 4m ² to comply with COVID safe school operations and the guided use of spaces . The report details the number of people who can be accommodated safely in each of the identified spaces.

Entity Location	Audit Condition Classification (Capacity)	Comment
B00A - R0008 - Home Base - (45.03 SQM) - Teaching Space: 1	Student Space (20)	
B00A - R0009 - Home Base - (38.06 SQM) - Teaching Space: 1	Student Space (17)	
B00A - R0010 - Practical Activities - 1hb - (7.03 SQM)	Student Space (3)	
B00A - R0011 - Home Base - (45.22 SQM) - Teaching Space: 1	Student Space (20)	
B00A - R0012 - Home Base - (44.85 SQM) - Teaching Space: 1	Student Space (20)	
B00A - R0014 - Movement - (5.3 SQM)	Not Applicable	Circulation or storage space.
B00A - R0019 - Home Base - (50.52 SQM) - Teaching Space: 1	Student Space (23)	
B00A - R0020 - Home Base - (49.1 SQM) - Teaching Space: 1	Student Space (22)	
B00A - R0024 - Home Base - (49.72 SQM) - Teaching Space: 1	Student Space (23)	
B00A - R0025 - Home Base - (49.58 SQM) - Teaching Space: 1	Student Space (23)	
B00A - R0026 - Home Base - (49.58 SQM) - Teaching Space: 1	Student Space (23)	
B00A - R0030 - Movement - (12.81 SQM)	Not Applicable	Circulation or storage space.
B00A - R0031 - Movement - (23.5 SQM)	Not Applicable	Circulation or storage space.
B00A - R0032 - Home Base - (51.78 SQM) - Teaching Space: 1	Student Space (24)	
B00A - R0033 - Principal - (52.06 SQM)	Office (13)	
B00A - R0034 - Clerical Office - (38.18 SQM)	Office (9)	
B00A - R0035 - Movement - (16.72 SQM)	Not Applicable	Circulation or storage space.
B00A - R0036 - Entry Vestibule - (19.65 SQM)	Not Applicable	Circulation or storage space.
B00A - R0045 - Interview - (8.81 SQM)	Office (2)	
B00A - R0054 - Canteen - (26.1 SQM)	Not Applicable	Circulation or storage space.
B00A - R0058 - Canteen - (18.35 SQM)	Not Applicable	Circulation or storage space.
B00A - R0064 - Movement - (68.6 SQM)	Not Applicable	Circulation or storage space.
B00A - R0065 - Movement - (134.04 SQM)	Not Applicable	Circulation or storage space.
B00A - R0066 - Special Programs Room - (20.94 SQM)	Student Space (9)	
B00A - R0069 - Home Base - (60.46 SQM) - Teaching Space: 1	Student Space (28)	
B00A - R0070 - Home Base - (54.81 SQM) - Teaching Space: 1	Student Space (25)	
B00A - R0071 - Movement - (15.98 SQM)	Not Applicable	Circulation or storage space.
B00A - R0072 - Movement - (6.48 SQM)	Not Applicable	Circulation or storage space.
B00A - R0077 - Staff Room - (40.36 SQM)	Office (10)	
B00A - R0088 - Reading Area - (210.45 SQM)	Student Space (97)	
B00A - R1004 - Home Base - (46.69 SQM) - Teaching Space: 1	Student Space (21)	
B00A - R1005 - Home Base - (46.75 SQM) - Teaching Space: 1	Student Space (21)	
B00A - R1006 - Home Base - (46.69 SQM) - Teaching Space: 1	Student Space (21)	
B00A - R1007 - Home Base - (46.81 SQM) - Teaching Space: 1	Student Space (21)	
B00A - R1011 - Home Base - (51.62 SQM) - Teaching Space: 1	Student Space (23)	
B00A - R1012 - Home Base - (48.29 SQM) - Teaching Space: 1	Student Space (22)	
B00A - R1013 - Interview - (13.18 SQM)	Office (3)	
B00A - R1015 - Home Base - (49.29 SQM) - Teaching Space: 1	Student Space (22)	
B00A - R1016 - Home Base - (49.57 SQM) - Teaching Space: 1	Student Space (22)	
B00A - R1017 - Home Base - (40.32 SQM) - Teaching Space: 1	Student Space (18)	
B00A - R1018 - Practical Activities - 1hb - (5.4 SQM)	Student Space (2)	
B00A - R1019 - Home Base - (53.14 SQM) - Teaching Space: 1	Student Space (24)	
B00A - R1020 - Practical Activities - 1hb - (26.61 SQM)	Student Space (12)	
B00A - R1021 - Home Base - (53.08 SQM) - Teaching Space: 1	Student Space (24)	
B00A - R1022 - Home Base - (52.17 SQM) - Teaching Space: 1	Student Space (24)	
B00A - R1023 - Staff Room Annexe - (27.9 SQM)	Office (6)	
B00A - R1025 - Home Base - (61.57 SQM) - Teaching Space: 1	Student Space (28)	
B00A - R1026 - Home Base - (55.65 SQM) - Teaching Space: 1	Student Space (25)	

Entity Location	Audit Condition Classification (Capacity)	Comment
B00A - R1027 - Practical Activities - 1hb - (6.62 SQM)	 Student Space (3)	
B00A - R1031 - Duplicating Workroom - (7.74 SQM)	 Office (1)	
B00A - R1032 - Home Base - (54.38 SQM) - Teaching Space: 1	 Student Space (25)	
B00A - R1035 - Movement - (65.08 SQM)	Not Applicable	Circulation or storage space.
B00A - R1036 - Movement - (152 SQM)	Not Applicable	Circulation or storage space.
B00F - R0009 - Communal Space - (202.2 SQM)	 Student Space (93)	
B00F - R0010 - Raised Platform - (62.88 SQM)	Not Applicable	Circulation or storage space.
B00F - R0017 - Movement - (7.62 SQM)	Not Applicable	Circulation or storage space.
B00F - R0018 - Movement - (13.73 SQM)	Not Applicable	Circulation or storage space.
B00F - R0020 - Movement - (5.88 SQM)	Not Applicable	Circulation or storage space.
OS 602 14037 - OS 602 14037 - Learning Unit - Standard With P.A.A. - (76 SQM)	 Student Space (35)	
OS 750 10823 - OS 750 10823 - Learning Unit - ESL - (38 SQM)	 Student Space (17)	
OS 750 17707 - OS 750 17707 - Learning Unit - ESL - (38 SQM)	 Student Space (17)	