

VENTILATION AUDIT REPORT

SCHOOL:	Curl Curl North Public School (3925)
AMU REGION:	Northern Sydney
STATE ELECTORATE:	Manly
LOCAL GOVERNMENT AREA:	Northern Beaches

3925 - Curl Curl North Public School
Site Plan (10284)

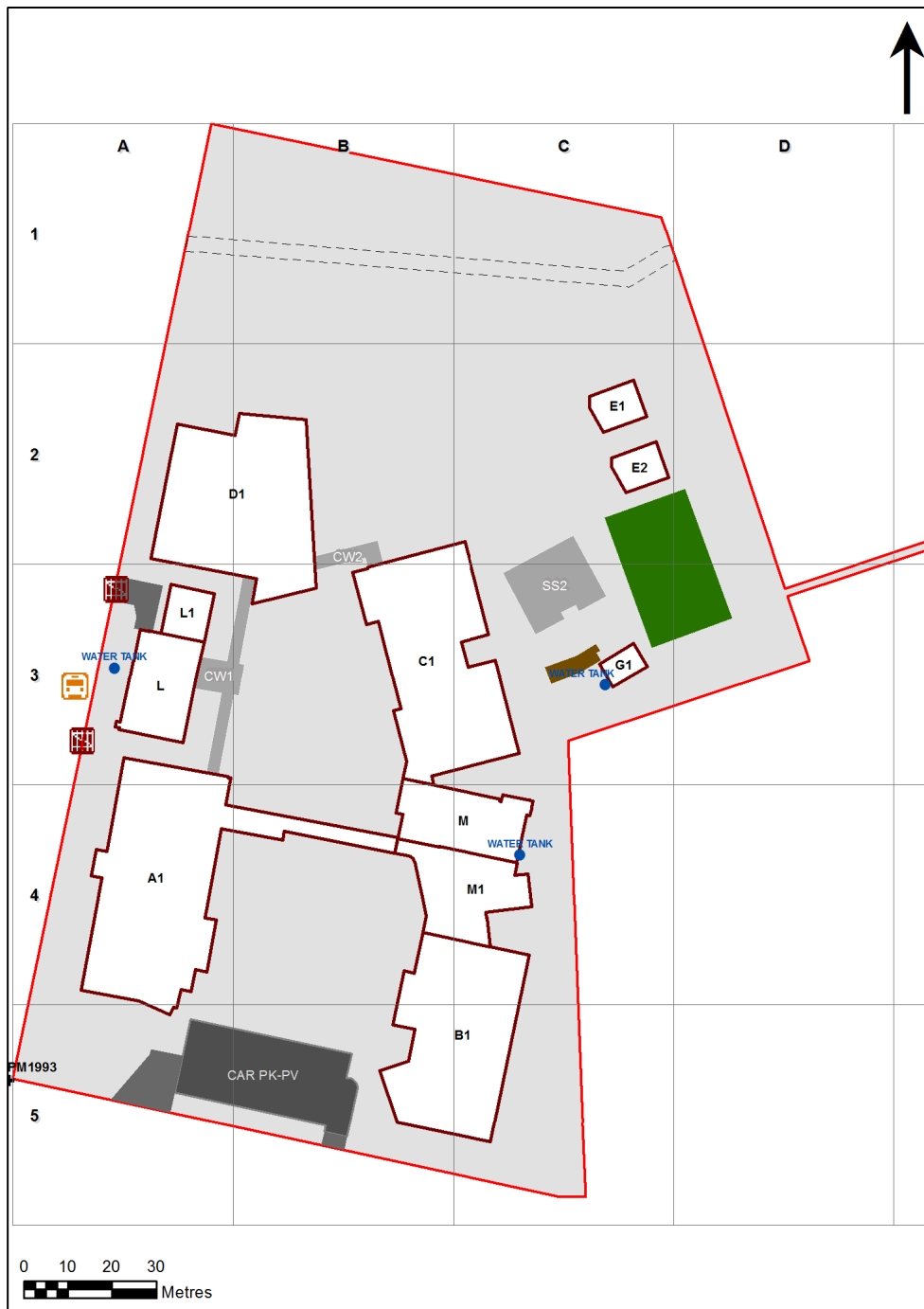

1:1,077

Printed: 18-Aug-2021

Ventilation Audit Key

Category	Description
	Category A Operate this space in line with COVID safe school operations . It has the required level of natural ventilation. NB. Circulation and storage areas should not be used for groups or gatherings.
	Category B This space should be occupied at 1 person per 4m ² to comply with COVID safe school operations and the guided use of spaces . The report details the number of people who can be accommodated safely in each of the identified spaces.

Entity Location	Audit Condition Classification (Capacity)	Comment
B00E - R0001 - Canteen - (27.4 SQM)	Not Applicable	Circulation or storage space.
B00E - R0003 - Home Base - (81.06 SQM)	● Student Space (37)	
B00F - R0003 - Practical Activities - 4hb - (76.19 SQM)	● Student Space (35)	
B00G - R0001 - Clerical Office - (12.92 SQM)	● Office (3)	
B00G - R0002 - Principal - (17.38 SQM)	● Office (4)	
B00G - R0003 - Entry Vestibule - (11.81 SQM)	Not Applicable	Circulation or storage space.
B00G - R0004 - Clerical Office - (15.04 SQM)	● Office (3)	
B00G - R0008 - Staff Room Annexe - (11.33 SQM)	● Office (2)	
B00G - R0011 - Staff Room Annexe - (12.31 SQM)	● Office (3)	
B00G - R0013 - Staff Room - (38.25 SQM)	● Office (9)	
B00G - R0015 - Staff Room Annexe - (14.48 SQM)	● Office (3)	
B00G - R0019 - Clerical Office - (11.64 SQM)	● Office (2)	
B00G - R0020 - Clerical Office - (10.4 SQM)	● Office (2)	
B00G - R0024 - Sick Bay - (11.08 SQM)	● Student Space (5)	
B00H - R0001 - Home Base - (56.95 SQM)	● Student Space (26)	
B00H - R0003 - Movement - (6.47 SQM)	Not Applicable	Circulation or storage space.
B00H - R0008 - Home Base - (56.41 SQM)	● Student Space (26)	
B00H - R0009 - Home Base - (56.41 SQM)	● Student Space (26)	
B00H - R0011 - Movement - (6.43 SQM)	Not Applicable	Circulation or storage space.
B00H - R0014 - Home Base - (56.94 SQM)	● Student Space (26)	
B00I - R0002 - Practical Activities - 1hb - (19.4 SQM)	● Student Space (9)	
B00I - R0004 - Home Base - (59.22 SQM)	● Student Space (27)	
B00I - R0005 - Withdrawal Space - 2hb - (11.36 SQM)	● Student Space (5)	
B00I - R0006 - Home Base - (59.22 SQM)	● Student Space (27)	
B00I - R0008 - Practical Activities - 1hb - (19.41 SQM)	● Student Space (9)	
B00K - R0001 - Communal Space - (170.85 SQM)	● Student Space (79)	
B00K - R0002 - Communal Space - (167.33 SQM)	● Student Space (77)	
B00L - R0002 - Reading Area - (176.02 SQM)	● Student Space (81)	
B00L - R0008 - Seminar/Study - (34.36 SQM)	● Office (8)	
B00L - R0013 - Practical Activities - M - 1hb - (35.75 SQM)	● Student Space (16)	
B00L - R0014 - Home Base - M - (35.79 SQM) - Teaching Space: 1	● Student Space (16)	
B00L - R0015 - Home Base - M - (108.77 SQM) - Teaching Space: 1	● Student Space (50)	
B00M - R0017 - Withdrawal Space - 1hb - (10.57 SQM)	● Student Space (4)	
B00M - R0019 - Home Base X4 - (160.48 SQM) - Teaching Space: 4	● Student Space (74)	
B00M - R0023 - Collaboration Space - (42.13 SQM)	● Student Space (19)	
B00M - R0024 - Special Programs Room - Type 1 - (26.9 SQM)	● Student Space (12)	
B00M - R1015 - Withdrawal Space - 2hb - (10.38 SQM)	● Student Space (4)	
B00M - R1018 - Special Programs Room - (20.86 SQM)	● Student Space (9)	
B00M - R1019 - Collaboration Space - (43.05 SQM)	● Student Space (19)	
B00M - R1020 - Home Base X4 - (162.53 SQM) - Teaching Space: 4	● Student Space (75)	
B00N - R0002 - Canteen - (43.23 SQM)	Not Applicable	Circulation or storage space.
BOA1 - R0001 - Entry Vestibule - (22.49 SQM)	Not Applicable	Circulation or storage space.
BOA1 - R0002 - Interview - (12.03 SQM)	● Office (3)	
BOA1 - R0004 - Interview/Office - Type 3 - (16.25 SQM)	● Office (4)	
BOA1 - R0005 - Movement - (57.24 SQM)	Not Applicable	Circulation or storage space.
BOA1 - R0006 - Principal - (17.78 SQM)	● Office (4)	
BOA1 - R0007 - Interview - (12.39 SQM)	● Office (3)	

Entity Location	Audit Condition Classification (Capacity)	Comment
B0A1 - R0008 - Deputy Principal - Type 1 - (12.17 SQM)	Office (3)	
B0A1 - R0010 - Deputy Principal - Type 1 - (13.29 SQM)	Office (3)	
B0A1 - R0011 - Clerical/Printing - (11.57 SQM)	Not Applicable	Circulation or storage space.
B0A1 - R0012 - Deputy Principal - (24.27 SQM)	Office (6)	
B0A1 - R0013 - Clerical Office - (31.1 SQM)	Office (7)	
B0A1 - R0017 - Sick Bay - (15.33 SQM)	Student Space (7)	
B0A1 - R0020 - Staff Room - (77.22 SQM)	Office (19)	
B0A1 - R0021 - Staff Room Annexe - (44.95 SQM)	Office (11)	
B0A1 - R0022 - Staff Kitchen - (18.19 SQM)	Office (4)	
B0A1 - R0025 - Reading Area - (225.8 SQM)	Student Space (104)	
B0A1 - R0028 - Staff Kitchen - (5.47 SQM)	Office (1)	
B0A1 - R0031 - Presentation Area - (51.5 SQM)	Not Applicable	Circulation or storage space.
B0A1 - R0032 - Practical Activities - (23.36 SQM)	Student Space (10)	
B0A1 - R1001 - Home Base X3 - (150.52 SQM) - Teaching Space: 3	Student Space (69)	
B0A1 - R1002 - Practical Activities/Movement - 2hb - (92.47 SQM)	Student Space (42)	
B0A1 - R1003 - Withdrawal Space - 2hb - (12.41 SQM)	Student Space (5)	
B0A1 - R1004 - Presentation Area - (49.86 SQM)	Not Applicable	Circulation or storage space.
B0A1 - R1006 - Practical Activities/Movement - 2hb - (86.12 SQM)	Student Space (39)	
B0A1 - R1007 - Practical Activities - 3hb - (49.78 SQM)	Student Space (23)	
B0A1 - R1008 - Home Base X3 - (152.16 SQM) - Teaching Space: 3	Student Space (70)	
B0A1 - R1010 - Withdrawal Space - 2hb - (12.2 SQM)	Student Space (5)	
B0A1 - R1011 - Withdrawal Space - 2hb - (12.25 SQM)	Student Space (5)	
B0A1 - R1013 - Home Base X3 - (150.53 SQM) - Teaching Space: 3	Student Space (69)	
B0A1 - R1015 - Presentation Area - (49.51 SQM)	Not Applicable	Circulation or storage space.
B0A1 - R1017 - Practical Activities - 3hb - (49.11 SQM)	Student Space (22)	
B0A1 - R1018 - Home Base X3 - (151.2 SQM) - Teaching Space: 3	Student Space (70)	
B0A1 - R1020 - Withdrawal Space - 2hb - (12.39 SQM)	Student Space (5)	
B0A1 - R1026 - Movement - (9.41 SQM)	Not Applicable	Circulation or storage space.
B0B1 - R0001 - Home Base - (63.62 SQM) - Teaching Space: 1	Student Space (29)	
B0B1 - R0002 - Home Base - (63.75 SQM) - Teaching Space: 1	Student Space (29)	
B0B1 - R0003 - Withdrawal Space - 2hb - (11.64 SQM)	Student Space (5)	
B0B1 - R0004 - Collaboration Space - (69.66 SQM)	Student Space (32)	
B0B1 - R0005 - Practical Activities - (45.71 SQM)	Student Space (21)	
B0B1 - R0008 - Home Base - (62.32 SQM) - Teaching Space: 1	Student Space (28)	
B0B1 - R0009 - Withdrawal Space - 2hb - (13.1 SQM)	Student Space (6)	
B0B1 - R0010 - Home Base - (59.14 SQM) - Teaching Space: 1	Student Space (27)	
B0B1 - R0011 - Withdrawal Space - 2hb - (11.65 SQM)	Student Space (5)	
B0B1 - R0012 - Collaboration Space - (70.01 SQM)	Student Space (32)	
B0B1 - R0013 - Withdrawal Space - 2hb - (11.75 SQM)	Student Space (5)	
B0B1 - R0014 - Practical Activities - (44.58 SQM)	Student Space (20)	
B0B1 - R0018 - Home Base - (62.03 SQM) - Teaching Space: 1	Student Space (28)	
B0B1 - R0019 - Home Base - (62.84 SQM) - Teaching Space: 1	Student Space (29)	
B0B1 - R0022 - Practical Activities/Movement - 2hb - (107.81 SQM)	Student Space (50)	
B0B1 - R0024 - Practical Activities/Movement - 2hb - (30.71 SQM)	Student Space (14)	
B0B1 - R1001 - Home Base X3 - (152.11 SQM) - Teaching Space: 3	Student Space (70)	
B0B1 - R1003 - Withdrawal Space - 2hb - (12.3 SQM)	Student Space (5)	
B0B1 - R1004 - Presentation Area - (48.98 SQM)	Not Applicable	Circulation or storage space.
B0B1 - R1007 - Practical Activities - 2hb - (48.81 SQM)	Student Space (22)	

Entity Location	Audit Condition Classification (Capacity)	Comment
B0B1 - R1008 - Home Base X3 - (151.02 SQM) - Teaching Space: 3	● Student Space (70)	
B0B1 - R1010 - Withdrawal Space - 2hb - (12.41 SQM)	● Student Space (5)	
B0C1 - R0001 - Home Base - (60.46 SQM) - Teaching Space: 1	● Student Space (28)	
B0C1 - R0002 - Home Base - (64.27 SQM) - Teaching Space: 1	● Student Space (29)	
B0C1 - R0003 - Withdrawal Space - 2hb - (11.95 SQM)	● Student Space (5)	
B0C1 - R0004 - Collaboration Space - (70.85 SQM)	● Student Space (32)	
B0C1 - R0006 - Practical Activities - 3hb - (50.15 SQM)	● Student Space (23)	
B0C1 - R0007 - Home Base - (60.02 SQM) - Teaching Space: 1	● Student Space (27)	
B0C1 - R0008 - Withdrawal Space - 1hb - (11.31 SQM)	● Student Space (5)	
B0C1 - R0009 - Home Base - (59.88 SQM) - Teaching Space: 1	● Student Space (27)	
B0C1 - R0010 - Withdrawal Space - 1hb - (11.2 SQM)	● Student Space (5)	
B0C1 - R0011 - Collaboration Space - (68.74 SQM)	● Student Space (31)	
B0C1 - R0012 - Withdrawal Space - 2hb - (12.28 SQM)	● Student Space (5)	
B0C1 - R0013 - Practical Activities - 3hb - (50.21 SQM)	● Student Space (23)	
B0C1 - R0015 - Home Base - (62.82 SQM) - Teaching Space: 1	● Student Space (29)	
B0C1 - R0016 - Home Base - (59.45 SQM) - Teaching Space: 1	● Student Space (27)	
B0C1 - R0028 - Practical Activities - 2hb - (47.94 SQM)	● Student Space (22)	
B0C1 - R0029 - Practical Activities - 2hb - (47.37 SQM)	● Student Space (21)	
B0C1 - R1001 - Home Base X3 - (150.56 SQM) - Teaching Space: 3	● Student Space (69)	
B0C1 - R1002 - Practical Activities/Movement - 2hb - (95.55 SQM)	● Student Space (44)	
B0C1 - R1003 - Withdrawal Space - 2hb - (13.35 SQM)	● Student Space (6)	
B0C1 - R1004 - Presentation Area - (48.94 SQM)	Not Applicable	Circulation or storage space.
B0C1 - R1007 - Practical Activities - 3hb - (48.59 SQM)	● Student Space (22)	
B0C1 - R1008 - Home Base X3 - (151.38 SQM) - Teaching Space: 3	● Student Space (70)	
B0C1 - R1010 - Withdrawal Space - 2hb - (12.61 SQM)	● Student Space (5)	
B0C1 - R1011 - Home Base X3 - (151.04 SQM) - Teaching Space: 3	● Student Space (70)	
B0C1 - R1012 - Practical Activities/Movement - 2hb - (70.09 SQM)	● Student Space (32)	
B0C1 - R1013 - Withdrawal Space - 2hb - (12.35 SQM)	● Student Space (5)	
B0C1 - R1016 - Practical Activities - 3hb - (48.66 SQM)	● Student Space (22)	
B0C1 - R1017 - Presentation Area - (50.71 SQM)	Not Applicable	Circulation or storage space.
B0C1 - R1018 - Withdrawal Space - 2hb - (13.33 SQM)	● Student Space (6)	
B0C1 - R1020 - Home Base X3 - (152.09 SQM) - Teaching Space: 3	● Student Space (70)	
B0C1 - R1023 - Movement - (11.82 SQM)	Not Applicable	Circulation or storage space.
B0D1 - R0001 - Communal Space - (441.31 SQM)	● Student Space (204)	
B0D1 - R0002 - Canteen - (52.14 SQM)	Not Applicable	Circulation or storage space.
B0D1 - R0015 - Movement - (10.84 SQM)	Not Applicable	Circulation or storage space.
B0D1 - R0017 - Movement - (36.57 SQM)	Not Applicable	Circulation or storage space.
B0D1 - R0019 - Communal Space - (60.48 SQM)	● Student Space (28)	
B0M1 - R0001 - Home Base X2 - (117.28 SQM) - Teaching Space: 2	● Student Space (54)	
B0M1 - R0003 - Withdrawal Space - 2hb - (10.77 SQM)	● Student Space (4)	
B0M1 - R0004 - Presentation Area - (40.76 SQM)	Not Applicable	Circulation or storage space.
B0M1 - R0005 - Practical Activities - 2hb - (48.08 SQM)	● Student Space (22)	
B0M1 - R1001 - Home Base X2 - (122.97 SQM) - Teaching Space: 2	● Student Space (57)	
B0M1 - R1003 - Withdrawal Space - 2hb - (11.82 SQM)	● Student Space (5)	
B0M1 - R1004 - Presentation Area - (40.91 SQM)	Not Applicable	Circulation or storage space.

Entity Location	Audit Condition Classification (Capacity)	Comment
BOM1 - R1005 - Practical Activities - 2hb - (48.66 SQM)	 Student Space (22)	