

VENTILATION AUDIT REPORT

SCHOOL:	Cronulla South Public School (3668)
AMU REGION:	Sydney
STATE ELECTORATE:	Cronulla
LOCAL GOVERNMENT AREA:	Sutherland

3668 - Cronulla South Public School
Site Plan (12372)

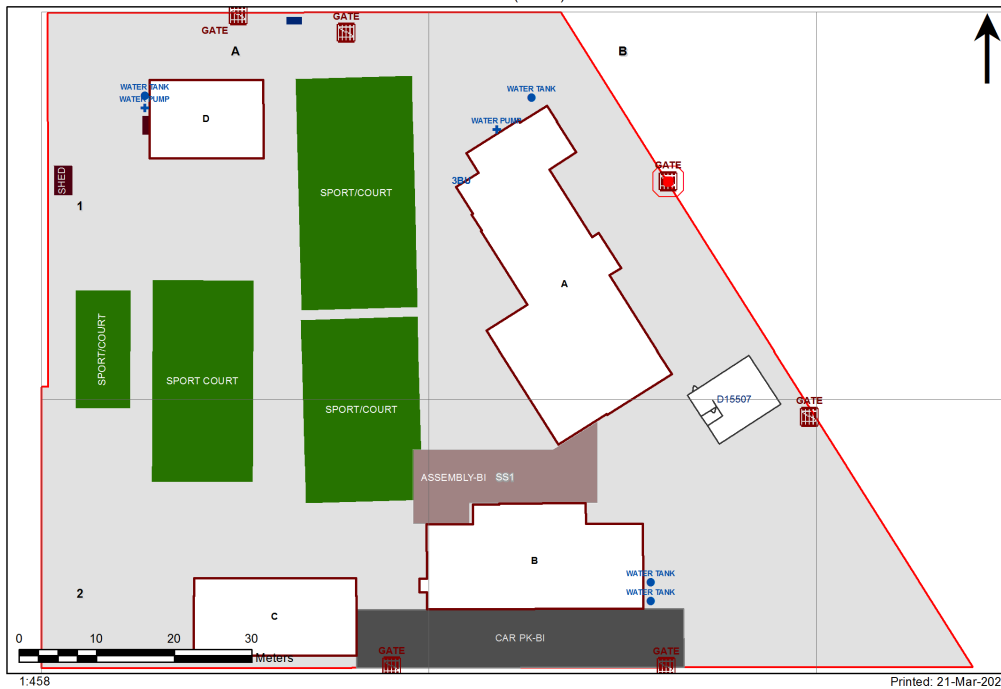

Ventilation Audit Key

Category	Description
	Category A Operate this space in line with COVID safe school operations . It has the required level of natural ventilation. NB. Circulation and storage areas should not be used for groups or gatherings.
	Category B This space should be occupied at 1 person per 4m ² to comply with COVID safe school operations and the guided use of spaces . The report details the number of people who can be accommodated safely in each of the identified spaces.

Entity Location	Audit Condition Classification (Capacity)	Comment
B00A - R0022 - Staff Room - (58.1 SQM)	Office (14)	
B00A - R0023 - Clerical/Printing - (11.66 SQM)	Not Applicable	Circulation or storage space.
B00A - R0024 - Deputy Principal - (14.39 SQM)	Office (3)	
B00A - R0025 - Principal - (19.92 SQM)	Office (4)	
B00A - R0026 - Interview - (13.2 SQM)	Office (3)	
B00A - R0027 - Movement - (25.45 SQM)	Not Applicable	Circulation or storage space.
B00A - R0028 - Movement - (43.27 SQM)	Not Applicable	Circulation or storage space.
B00A - R0030 - Clerical Office - (32.42 SQM)	Office (8)	
B00A - R0032 - Sick Bay - (10.63 SQM)	Student Space (4)	
B00A - R0034 - Home Base - (51.73 SQM) - Teaching Space: 1	Student Space (24)	
B00A - R0036 - Movement - (14.68 SQM)	Not Applicable	Circulation or storage space.
B00B - R0003 - Home Base - (57.29 SQM) - Teaching Space: 1	Student Space (26)	
B00B - R0016 - Movement - (11.59 SQM)	Not Applicable	Circulation or storage space.
B00B - R1001 - Movement - (64.14 SQM)	Not Applicable	Circulation or storage space.
B00B - R1002 - Home Base - (56.9 SQM) - Teaching Space: 1	Student Space (26)	
B00B - R1006 - Home Base - (57.05 SQM) - Teaching Space: 1	Student Space (26)	
B00B - R1007 - Home Base - (56.89 SQM) - Teaching Space: 1	Student Space (26)	
B00B - R1009 - Withdrawal Space - 1hb - (6.71 SQM)	Student Space (3)	
B00C - R0002 - Home Base - (52.21 SQM) - Teaching Space: 1	Student Space (24)	
B00C - R0006 - Canteen - (22.27 SQM)	Not Applicable	Circulation or storage space.
B00D - R0002 - Reading Area - (105.8 SQM)	Student Space (49)	
B00D - R0004 - Movement - (10.6 SQM)	Not Applicable	Circulation or storage space.
B00E - R0002 - Movement - (10 SQM)	Not Applicable	Circulation or storage space.
B00E - R0005 - Home Base - (56.45 SQM) - Teaching Space: 1	Student Space (26)	
B00E - R0007 - Home Base - (56.69 SQM) - Teaching Space: 1	Student Space (26)	
B00E - R0019 - Home Base - (86.13 SQM) - Teaching Space: 1	Student Space (39)	
B00E - R0020 - Home Base - (56.9 SQM) - Teaching Space: 1	Student Space (26)	
B00E - R0023 - Staff Room Annexe - (18.08 SQM)	Office (4)	
B00E - R0024 - Movement - (162.58 SQM)	Not Applicable	Circulation or storage space.
B00E - R1001 - Movement - (16.11 SQM)	Not Applicable	Circulation or storage space.
B00E - R1003 - Home Base - (56.6 SQM) - Teaching Space: 1	Student Space (26)	
B00E - R1005 - Home Base - (56.84 SQM) - Teaching Space: 1	Student Space (26)	
B00E - R1006 - Staff Room Annexe - (23.07 SQM)	Office (5)	
B00E - R1013 - Movement - (5.04 SQM)	Not Applicable	Circulation or storage space.
B00E - R1015 - Home Base - (56.89 SQM) - Teaching Space: 1	Student Space (26)	
B00E - R1017 - Special Programs Room - (58 SQM)	Student Space (26)	
B00E - R1028 - Movement - (132.98 SQM)	Not Applicable	Circulation or storage space.
B00G - R0001 - Communal Space - (238.36 SQM)	Student Space (110)	
OS 603 15507 - OS 603 15507 - Learning Unit - Standard With P.A.A. A/C - (76 SQM)	Student Space (35)	