

VENTILATION AUDIT REPORT

SCHOOL:	Cronulla High School (8261)
AMU REGION:	Sydney
STATE ELECTORATE:	Cronulla
LOCAL GOVERNMENT AREA:	Sutherland

8261 - Cronulla High School
Site Plan (12046)

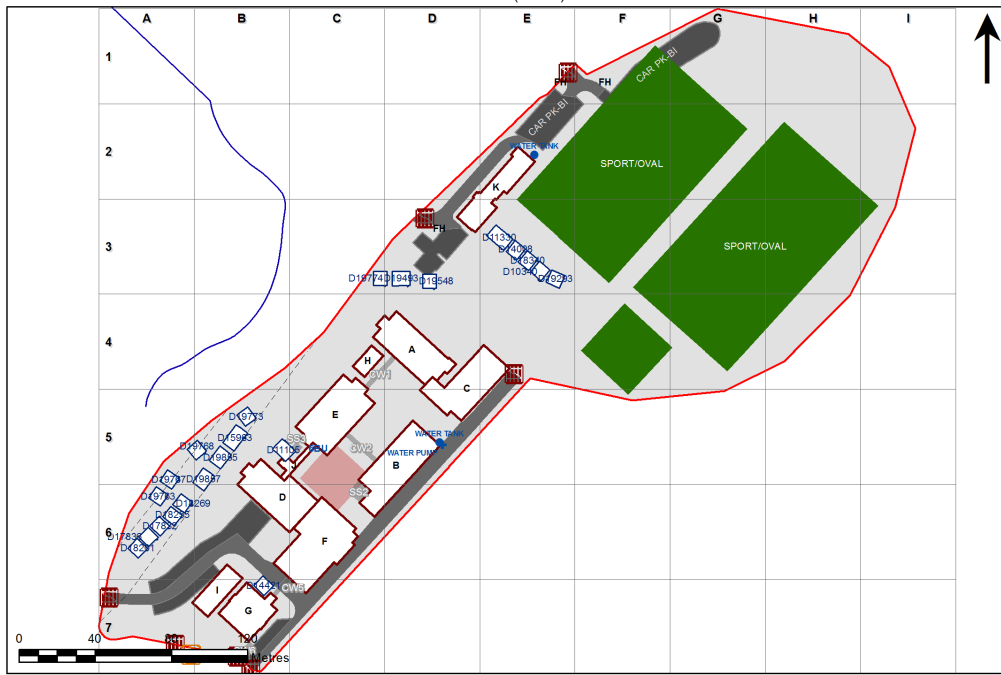

1:1,863

Printed: 30-Mar-2021

Ventilation Audit Key

Category	Description
	Category A Operate this space in line with COVID safe school operations . It has the required level of natural ventilation. NB. Circulation and storage areas should not be used for groups or gatherings.
	Category B This space should be occupied at 1 person per 4m ² to comply with COVID safe school operations and the guided use of spaces . The report details the number of people who can be accommodated safely in each of the identified spaces.

Entity Location	Audit Condition Classification (Capacity)	Comment
B00A - R0004 - Staff Study - (24.93 SQM)	Office (6)	
B00A - R0012 - Food Technology L.S. - (64.73 SQM) - Teaching Space: 1	Student Space (30)	
B00A - R0013 - Laboratory L.S. - (77.57 SQM) - Teaching Space: 1	Student Space (35)	
B00A - R0014 - Preparation - (6.89 SQM)	Not Applicable	Circulation or storage space.
B00A - R0015 - Preparation - (11.08 SQM)	Not Applicable	Circulation or storage space.
B00A - R0016 - Staff Study - (25.28 SQM)	Office (6)	
B00A - R0017 - Preparation - (8.94 SQM)	Not Applicable	Circulation or storage space.
B00A - R0018 - Preparation - (15.75 SQM)	Not Applicable	Circulation or storage space.
B00A - R0019 - Laboratory L.S. - (90.77 SQM) - Teaching Space: 1	Student Space (42)	
B00A - R0021 - Movement - (142.16 SQM)	Not Applicable	Circulation or storage space.
B00A - R0027 - Food/Research Space - (25.07 SQM)	Not Applicable	Circulation or storage space.
B00A - R0030 - Food Technology L.S. - (89.65 SQM) - Teaching Space: 1	Student Space (41)	
B00A - R1001 - General Learning Space - (51.78 SQM) - Teaching Space: 1	Student Space (24)	
B00A - R1003 - General Learning Space - (51.41 SQM) - Teaching Space: 1	Student Space (23)	
B00A - R1006 - Darkroom Space - (7.33 SQM)	Office (1)	
B00A - R1008 - Music Learning Space - (51.71 SQM) - Teaching Space: 1	Student Space (23)	
B00A - R1012 - Staff Study - (24.93 SQM)	Office (6)	
B00A - R1013 - Design L.S. - (64.06 SQM) - Teaching Space: 1	Student Space (29)	
B00A - R1017 - Design L.S. - (64.82 SQM) - Teaching Space: 1	Student Space (30)	
B00A - R1018 - Movement - (128.74 SQM)	Not Applicable	Circulation or storage space.
B00A - R1024 - Art Learning Space - (70.18 SQM) - Teaching Space: 1	Student Space (32)	
B00A - R1025 - Art Learning Space - (69.59 SQM) - Teaching Space: 1	Student Space (32)	
B00B - R0006 - Student Canteen - (43.7 SQM)	Not Applicable	Circulation or storage space.
B00B - R0020 - Movement - (201.06 SQM)	Not Applicable	Circulation or storage space.
B00C - R0003 - Design L.S. - (49.5 SQM) - Teaching Space: 1	Student Space (22)	
B00C - R0006 - Design L.S. - (51.43 SQM) - Teaching Space: 1	Student Space (23)	
B00C - R0008 - Materials Technology L.S. - (77.17 SQM) - Teaching Space: 1	Student Space (35)	
B00C - R0009 - Welding Area - (25.67 SQM)	Not Applicable	Circulation or storage space.
B00C - R0010 - Materials Technology L.S. - (77.77 SQM) - Teaching Space: 1	Student Space (36)	
B00C - R0013 - Staff Study - (25.31 SQM)	Office (6)	
B00C - R0015 - Materials Technology L.S. - (77.45 SQM) - Teaching Space: 1	Student Space (35)	
B00C - R0020 - Movement - (95.87 SQM)	Not Applicable	Circulation or storage space.
B00D - R0002 - Computer Learning Space - (51.71 SQM) - Teaching Space: 1	Student Space (23)	
B00D - R0004 - Administration - Clerical - (38.11 SQM)	Office (9)	
B00D - R0005 - Deputy Principal Office - (15.43 SQM)	Office (3)	
B00D - R0006 - Sick Bay - (9.13 SQM)	Student Space (4)	
B00D - R0007 - Ancillary Staff - (18.52 SQM)	Office (4)	
B00D - R0010 - Interview/Office - Type 1 - (10.31 SQM)	Office (2)	
B00D - R0013 - Interview/Office - Type 1 - (10.81 SQM)	Office (2)	
B00D - R0014 - Interview/Office - Type 1 - (10.44 SQM)	Office (2)	
B00D - R0015 - Principal Office - (18.21 SQM)	Office (4)	
B00D - R0020 - Interview/Office - Type 1 - (8.64 SQM)	Office (2)	
B00D - R0023 - Computer Learning Space - (50.85 SQM) - Teaching Space: 1	Student Space (23)	
B00D - R0026 - Computer Learning Space - (58.1 SQM) - Teaching Space: 1	Student Space (26)	
B00D - R0029 - Movement - (20.48 SQM)	Not Applicable	Circulation or storage space.
B00D - R0033 - Movement - (96.12 SQM)	Not Applicable	Circulation or storage space.
B00D - R0034 - Movement - (61.57 SQM)	Not Applicable	Circulation or storage space.
B00D - R0036 - Administration - Executive - (9.24 SQM)	Office (2)	
B00D - R0039 - Clinic - (18.3 SQM)	Office (4)	

Entity Location	Audit Condition Classification (Capacity)	Comment
B00D - R0040 - Computer Room - (12.09 SQM)	Student Space (5)	
B00D - R1001 - General Learning Space - (64.78 SQM) - Teaching Space: 1	Student Space (30)	
B00D - R1004 - General Learning Space - (63.92 SQM) - Teaching Space: 1	Student Space (29)	
B00D - R1005 - Staff Study - (25.29 SQM)	Office (6)	
B00D - R1008 - General Learning Space - (51.64 SQM) - Teaching Space: 1	Student Space (23)	
B00D - R1009 - General Learning Space - (64.63 SQM) - Teaching Space: 1	Student Space (29)	
B00D - R1010 - Interview/Office - Type 1 - (31.69 SQM)	Office (7)	
B00D - R1011 - Interview/Office - Type 1 - (18.59 SQM)	Office (4)	
B00D - R1013 - General Learning Space - (37.09 SQM) - Teaching Space: 1	Student Space (17)	
B00D - R1015 - Movement - (125.35 SQM)	Not Applicable	Circulation or storage space.
B00D - R1017 - General Learning Space - (51.13 SQM) - Teaching Space: 1	Student Space (23)	
B00D - R1018 - Staff Study - (34.52 SQM)	Office (8)	
B00D - R1019 - Staff Kitchen - (16.48 SQM)	Office (4)	
B00E - R0001 - General Learning Space - (51.7 SQM) - Teaching Space: 1	Student Space (23)	
B00E - R0002 - General Learning Space - (51.2 SQM) - Teaching Space: 1	Student Space (23)	
B00E - R0007 - Preparation - (18.61 SQM)	Not Applicable	Circulation or storage space.
B00E - R0008 - Laboratory L.S. - (77.8 SQM) - Teaching Space: 1	Student Space (36)	
B00E - R0009 - Laboratory L.S. - (90.74 SQM) - Teaching Space: 1	Student Space (42)	
B00E - R0012 - Laboratory L.S. - (90.38 SQM) - Teaching Space: 1	Student Space (41)	
B00E - R0013 - General Learning Space - (51.84 SQM) - Teaching Space: 1	Student Space (24)	
B00E - R0015 - Movement - (136.34 SQM)	Not Applicable	Circulation or storage space.
B00E - R0020 - Preparation - Science - (25.21 SQM)	Not Applicable	Circulation or storage space.
B00E - R1001 - General Learning Space - (51.49 SQM) - Teaching Space: 1	Student Space (23)	
B00E - R1002 - Staff Study - (51.21 SQM)	Office (12)	
B00E - R1008 - General Learning Space - (44.73 SQM) - Teaching Space: 1	Student Space (20)	
B00E - R1009 - General Learning Space - (51.84 SQM) - Teaching Space: 1	Student Space (24)	
B00E - R1010 - General Learning Space - (51.92 SQM) - Teaching Space: 1	Student Space (24)	
B00E - R1011 - General Learning Space - (51.2 SQM) - Teaching Space: 1	Student Space (23)	
B00E - R1012 - General Learning Space - (51.28 SQM) - Teaching Space: 1	Student Space (23)	
B00E - R1013 - General Learning Space - (51.28 SQM) - Teaching Space: 1	Student Space (23)	
B00E - R1014 - General Learning Space - (51.71 SQM) - Teaching Space: 1	Student Space (23)	
B00E - R1015 - Movement - (114.12 SQM)	Not Applicable	Circulation or storage space.
B00F - M0002 - Movement - (7.29 SQM)	Not Applicable	Circulation or storage space.
B00F - R0007 - Movement - (10.06 SQM)	Not Applicable	Circulation or storage space.
B00F - R0008 - Pupil Entry - (45.25 SQM)	Not Applicable	Circulation or storage space.
B00F - R0009 - Stage - (142.05 SQM)	Not Applicable	Circulation or storage space.
B00F - R0010 - Multi-Purpose Space - (375.72 SQM)	Student Space (174)	
B00F - R0011 - Student Canteen - (8.24 SQM)	Not Applicable	Circulation or storage space.
B00F - R1001 - Staff Study - (18.88 SQM)	Office (4)	
B00F - R1002 - Movement - (15.85 SQM)	Not Applicable	Circulation or storage space.
B00G - R0004 - Audio Visual Workroom - (50.48 SQM)	Student Space (23)	
B00G - R0016 - Main Area - (216.04 SQM)	Not Applicable	Circulation or storage space.
B00G - R0018 - Movement - (34.89 SQM)	Not Applicable	Circulation or storage space.
B00G - R0019 - Main Entry - (15.49 SQM)	Not Applicable	Circulation or storage space.
B00G - R0022 - Tiered Learning Area - (12.53 SQM)	Student Space (5)	
B00G - R1004 - Seminar - (16.45 SQM)	Office (4)	
B00G - R1005 - Seminar - (16.77 SQM)	Office (4)	
B00G - R1006 - Seminar - (16.53 SQM)	Office (4)	
B00G - R1007 - Seminar - (16.77 SQM)	Office (4)	

Entity Location	Audit Condition Classification (Capacity)	Comment
B00G - R1008 - Seminar - (16.44 SQM)	Office (4)	
B00G - R1014 - Seminar/Study - (46.54 SQM)	Office (11)	
B00G - R1017 - Seminar/Study - (52.91 SQM)	Office (13)	
B00G - R1018 - Movement - (11.43 SQM)	Not Applicable	Circulation or storage space.
B00G - R1019 - Main Area - (129.53 SQM)	Not Applicable	Circulation or storage space.
B00H - R0007 - Music Learning Space - (93.36 SQM) - Teaching Space: 1	Student Space (43)	
B00I - R0001 - Performance Workshop - (112.41 SQM)	Student Space (52)	
B00I - R0002 - Performance Workshop - (104.66 SQM)	Student Space (48)	
B00K - R0001 - Gymnasium - (170.85 SQM)	Student Space (79)	
B00K - R0014 - Movement - (12.87 SQM)	Not Applicable	Circulation or storage space.
B00K - R0024 - Student Canteen - (19.29 SQM)	Not Applicable	Circulation or storage space.
B00K - R1001 - Administration - Executive - (28.12 SQM)	Office (7)	
B00K - R1006 - Movement - (11.66 SQM)	Not Applicable	Circulation or storage space.
B00K - R1011 - Interview/Meeting - (95.38 SQM)	Office (23)	
OS 521 11105 - OS 521 11105 - Staff Study - (76 SQM)	Office (19)	
OS 600 10340 - OS 600 10340 - Learning Unit - Small - (57 SQM)	Student Space (26)	
OS 600 14008 - OS 600 14008 - Learning Unit - Small - (57 SQM)	Student Space (26)	
OS 600 14421 - OS 600 14421 - Learning Unit - Small - (57 SQM)	Student Space (26)	
OS 600 17832 - OS 600 17832 - Learning Unit - Small - (57 SQM)	Student Space (26)	
OS 600 17836 - OS 600 17836 - Learning Unit - Small - (57 SQM)	Student Space (26)	
OS 600 18201 - OS 600 18201 - Learning Unit - Small - (57 SQM)	Student Space (26)	
OS 600 18255 - OS 600 18255 - Learning Unit - Small - (57 SQM)	Student Space (26)	
OS 600 18269 - OS 600 18269 - Learning Unit - Small - (57 SQM)	Student Space (26)	
OS 600 18340 - OS 600 18340 - Learning Unit - Small - (57 SQM)	Student Space (26)	
OS 600 19293 - OS 600 19293 - Learning Unit - Small - (57 SQM)	Student Space (26)	
OS 600 19548 - OS 600 19548 - Learning Unit - Small - (57 SQM)	Student Space (26)	
OS 600 19763 - OS 600 19763 - Learning Unit - Small - (57 SQM)	Student Space (26)	
OS 600 19767 - OS 600 19767 - Learning Unit - Small - (57 SQM)	Student Space (26)	
OS 600 19768 - OS 600 19768 - Learning Unit - Small - (57 SQM)	Student Space (26)	
OS 600 19773 - OS 600 19773 - Learning Unit - Small - (57 SQM)	Student Space (26)	
OS 600 19774 - OS 600 19774 - Learning Unit - Small - (57 SQM)	Student Space (26)	
OS 601 19493 - OS 601 19493 - Learning Unit - Standard/Withdrawal - (76 SQM)	Student Space (35)	
OS 601 19855 - OS 601 19855 - Learning Unit - Standard/Withdrawal - (SQM)	Student Space ()	
OS 601 19857 - OS 601 19857 - Learning Unit - Standard/Withdrawal - (SQM)	Student Space ()	
OS 710 15963 - OS 710 15963 - Home Science/Pantry/Laundry - (95 SQM)	Office (23)	