

VENTILATION AUDIT REPORT

SCHOOL:	Condell Park High School (8398)
AMU REGION:	South Western Sydney
STATE ELECTORATE:	East Hills
LOCAL GOVERNMENT AREA:	Canterbury-Bankstown

8398 - Condell Park High School
Site Plan (12021)

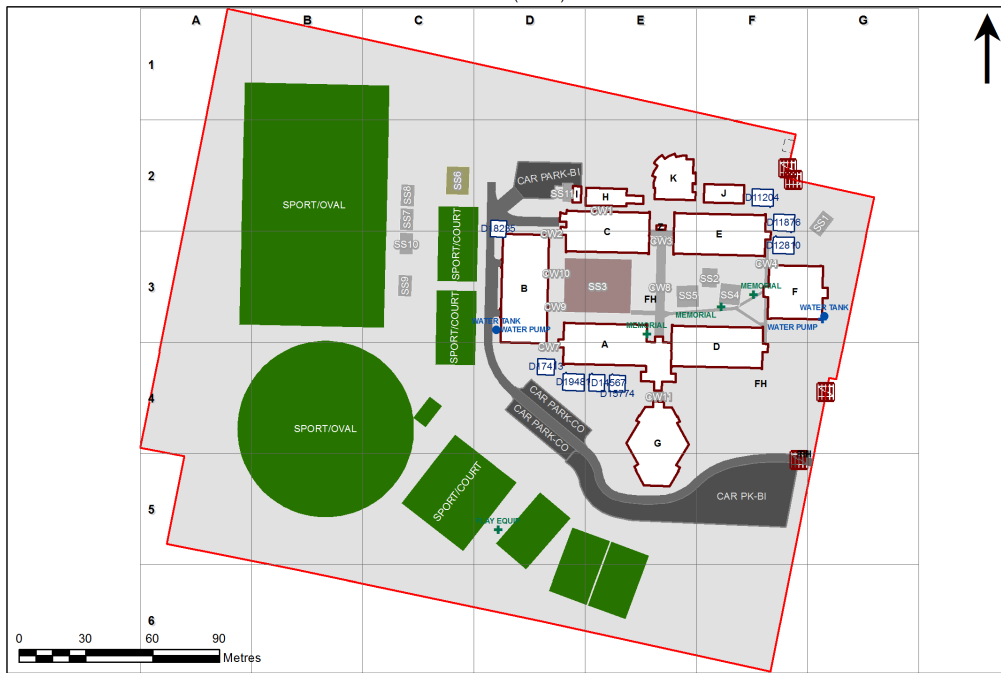

Ventilation Audit Key

Category	Description
	Category A Operate this space in line with COVID safe school operations . It has the required level of natural ventilation. NB. Circulation and storage areas should not be used for groups or gatherings.
	Category B This space should be occupied at 1 person per 4m ² to comply with COVID safe school operations and the guided use of spaces . The report details the number of people who can be accommodated safely in each of the identified spaces.

Entity Location	Audit Condition Classification (Capacity)	Comment
B00A - R0001 - Laboratory L.S. - (86.51 SQM) - Teaching Space: 1	Student Space (40)	
B00A - R0004 - Laboratory L.S. - (85.92 SQM) - Teaching Space: 1	Student Space (39)	
B00A - R0019 - Movement - (118.64 SQM)	Not Applicable	Circulation or storage space.
B00A - R0022 - Staff Study - (11.4 SQM)	Office (2)	
B00A - R0023 - Food Technology L.S. - (79.42 SQM) - Teaching Space: 1	Student Space (36)	
B00A - R0024 - Preparation - Materials - (25.96 SQM)	Not Applicable	Circulation or storage space.
B00A - R0025 - Food Technology L.S. - (79.49 SQM) - Teaching Space: 1	Student Space (36)	
B00A - R0031 - Staff Study - (24.4 SQM)	Office (6)	
B00A - R0033 - Movement - (139.18 SQM)	Not Applicable	Circulation or storage space.
B00A - R0034 - Senior Study - (55.59 SQM)	Office (13)	
B00A - R0037 - Preparation - (39.16 SQM)	Not Applicable	Circulation or storage space.
B00A - R0038 - Staff Study - (22.34 SQM)	Office (5)	
B00A - R1001 - Preparation - Science - (16.93 SQM)	Not Applicable	Circulation or storage space.
B00A - R1002 - Preparation - Science - (8.71 SQM)	Not Applicable	Circulation or storage space.
B00A - R1003 - Laboratory L.S. - (79.34 SQM) - Teaching Space: 1	Student Space (36)	
B00A - R1004 - Computer Learning Space - (66.18 SQM) - Teaching Space: 1	Student Space (30)	
B00A - R1006 - Computer Learning Space - (52.72 SQM) - Teaching Space: 1	Student Space (24)	
B00A - R1013 - Seminar - Type 1 - (26.29 SQM)	Office (6)	
B00A - R1014 - General Learning Space - (53.02 SQM) - Teaching Space: 1	Student Space (24)	
B00A - R1015 - General Learning Space - (52.8 SQM) - Teaching Space: 1	Student Space (24)	
B00A - R1016 - General Learning Space - (52.65 SQM) - Teaching Space: 1	Student Space (24)	
B00A - R1018 - Movement - (113.88 SQM)	Not Applicable	Circulation or storage space.
B00A - R1019 - Movement - (30.67 SQM)	Not Applicable	Circulation or storage space.
B00A - R1022 - Staff Study - (46.33 SQM)	Office (11)	
B00B - R0008 - Movement - (9.78 SQM)	Not Applicable	Circulation or storage space.
B00B - R0010 - Movement - (16 SQM)	Not Applicable	Circulation or storage space.
B00B - R0011 - Student Canteen - (41.22 SQM)	Not Applicable	Circulation or storage space.
B00B - R0018 - Multi-Purpose Space - (322.93 SQM)	Student Space (149)	
B00B - R0019 - Movement - (9.91 SQM)	Not Applicable	Circulation or storage space.
B00C - R0006 - Metal Technology Bay - (54.65 SQM)	Not Applicable	Circulation or storage space.
B00C - R0007 - Movement - (30.09 SQM)	Not Applicable	Circulation or storage space.
B00C - R0009 - Wood Technology L.S. - (79.49 SQM) - Teaching Space: 1	Student Space (36)	
B00C - R0016 - Materials Technology L.S. - (79.38 SQM) - Teaching Space: 1	Student Space (36)	
B00C - R0019 - Movement - (57.65 SQM)	Not Applicable	Circulation or storage space.
B00C - R0027 - Metal Technology L.S. - (65.81 SQM) - Teaching Space: 1	Student Space (30)	
B00C - R0028 - Welding Area - (26.54 SQM)	Not Applicable	Circulation or storage space.
B00C - R0029 - Wood Technology L.S. - (77.81 SQM) - Teaching Space: 1	Student Space (36)	
B00C - R0033 - Staff Study - (35.2 SQM)	Office (8)	
B00C - R1001 - Art Learning Space - (52.5 SQM) - Teaching Space: 1	Student Space (24)	
B00C - R1003 - Dark Room - (39.18 SQM)	Office (9)	
B00C - R1004 - Music Learning Space - (65.98 SQM) - Teaching Space: 1	Student Space (30)	
B00C - R1005 - Music Learning Space - (66.25 SQM) - Teaching Space: 1	Student Space (30)	
B00C - R1007 - Movement - (16.3 SQM)	Not Applicable	Circulation or storage space.
B00C - R1012 - Art Learning Space - (53.24 SQM) - Teaching Space: 1	Student Space (24)	
B00C - R1015 - Art Learning Space - (52.94 SQM) - Teaching Space: 1	Student Space (24)	
B00C - R1018 - General Learning Space - (52.72 SQM) - Teaching Space: 1	Student Space (24)	
B00C - R1020 - Movement - (80.22 SQM)	Not Applicable	Circulation or storage space.
B00C - R1021 - Movement - (9.85 SQM)	Not Applicable	Circulation or storage space.
B00C - R1024 - Staff Study - (22.58 SQM)	Office (5)	
B00D - R0005 - Seminar - (79.56 SQM)	Office (19)	

Entity Location	Audit Condition Classification (Capacity)	Comment
B00D - R0006 - General Assistants - (26.18 SQM)	Office (6)	
B00D - R0007 - Movement - (49.9 SQM)	Not Applicable	Circulation or storage space.
B00D - R0009 - Clinic - (6.09 SQM)	Office (1)	
B00D - R0010 - Deputy Principal Office - (19.37 SQM)	Office (4)	
B00D - R0011 - Leading Teacher - (9.5 SQM)	Office (2)	
B00D - R0012 - Interview/Office - Type 1 - (9.5 SQM)	Office (2)	
B00D - R0013 - Staff Kitchen - (12.92 SQM)	Office (3)	
B00D - R0015 - Principal Office - (19.52 SQM)	Office (4)	
B00D - R0016 - Administration - Clerical - (39.45 SQM)	Office (9)	
B00D - R0023 - Public Reception - (46.58 SQM)	Not Applicable	Circulation or storage space.
B00D - R0024 - Interview/Office - Type 1 - (13.43 SQM)	Office (3)	
B00D - R0025 - Interview/Office - Type 1 - (12.57 SQM)	Office (3)	
B00D - R0026 - Deputy Principal Office - (13.4 SQM)	Office (3)	
B00D - R0028 - Commonroom - (110.17 SQM)	Office (27)	
B00D - R0032 - Student Waiting - (90.67 SQM)	Not Applicable	Circulation or storage space.
B00D - R1005 - General Learning Space - (65.96 SQM) - Teaching Space: 1	Student Space (30)	
B00D - R1006 - General Learning Space - (65.96 SQM) - Teaching Space: 1	Student Space (30)	
B00D - R1008 - General Learning Space - (52.72 SQM) - Teaching Space: 1	Student Space (24)	
B00D - R1010 - General Learning Space - (52.72 SQM) - Teaching Space: 1	Student Space (24)	
B00D - R1012 - Movement - (16.09 SQM)	Not Applicable	Circulation or storage space.
B00D - R1015 - General Learning Space - (52.51 SQM) - Teaching Space: 1	Student Space (24)	
B00D - R1016 - General Learning Space - (52.58 SQM) - Teaching Space: 1	Student Space (24)	
B00D - R1017 - General Learning Space - (52.87 SQM) - Teaching Space: 1	Student Space (24)	
B00D - R1018 - Movement - (105.45 SQM)	Not Applicable	Circulation or storage space.
B00D - R1021 - General Learning Space - (64.3 SQM) - Teaching Space: 1	Student Space (29)	
B00D - R1023 - Staff Study - (31.16 SQM)	Office (7)	
B00E - R0001 - Laboratory L.S. - (93.27 SQM) - Teaching Space: 1	Student Space (43)	
B00E - R0002 - Preparation - Science - (28.9 SQM)	Not Applicable	Circulation or storage space.
B00E - R0004 - Laboratory L.S. - (92.9 SQM) - Teaching Space: 1	Student Space (43)	
B00E - R0005 - Special Learning Space - (66.51 SQM) - Teaching Space: 1	Student Space (30)	
B00E - R0017 - Movement - (130.49 SQM)	Not Applicable	Circulation or storage space.
B00E - R0024 - Special Learning Space - (50.86 SQM) - Teaching Space: 1	Student Space (23)	
B00E - R0026 - Special Learning Space - (50.12 SQM) - Teaching Space: 1	Student Space (23)	
B00E - R0028 - Special Learning Space - (50.24 SQM) - Teaching Space: 1	Student Space (23)	
B00E - R0030 - Performance Workshop - (52.72 SQM)	Student Space (24)	
B00E - R0031 - Performance Workshop - (14.61 SQM)	Student Space (6)	
B00E - R1001 - General Learning Space - (52.8 SQM) - Teaching Space: 1	Student Space (24)	
B00E - R1004 - General Learning Space - (52.51 SQM) - Teaching Space: 1	Student Space (24)	
B00E - R1008 - General Learning Space - (52.65 SQM) - Teaching Space: 1	Student Space (24)	
B00E - R1010 - General Learning Space - (52.94 SQM) - Teaching Space: 1	Student Space (24)	
B00E - R1012 - Materials Learning Space - Type 1 - (52.72 SQM) - Teaching Space: 1	Student Space (24)	
B00E - R1014 - General Learning Space - (52.65 SQM) - Teaching Space: 1	Student Space (24)	
B00E - R1015 - General Learning Space - (52.72 SQM) - Teaching Space: 1	Student Space (24)	
B00E - R1020 - Movement - (120.7 SQM)	Not Applicable	Circulation or storage space.
B00E - R1023 - Staff Study - (30.51 SQM)	Office (7)	
B00E - R1024 - Tea Room - (8.4 SQM)	Not Applicable	Circulation or storage space.
B00E - R1025 - Staff Study - (75.97 SQM)	Office (18)	
B00F - R0002 - Main Entry - (14.7 SQM)	Not Applicable	Circulation or storage space.

Entity Location	Audit Condition Classification (Capacity)	Comment
B00F - R0003 - Audio Visual Workroom - (34.85 SQM)	● Student Space (16)	
B00F - R0008 - Senior Study - (18 SQM)	● Office (4)	
B00F - R0009 - Senior Study - (12.13 SQM)	● Office (3)	
B00F - R0014 - Seminar - (43.96 SQM)	● Office (10)	
B00F - R0015 - Main Area - (344.61 SQM)	Not Applicable	Circulation or storage space.
B00F - R0017 - Tea Room - (5.51 SQM)	Not Applicable	Circulation or storage space.
B00G - R0001 - Staff Kitchen - (16.83 SQM)	● Office (4)	
B00G - R0002 - Movement - (21.94 SQM)	Not Applicable	Circulation or storage space.
B00G - R0007 - Multi-Purpose Space - (450.59 SQM)	● Student Space (209)	
B00G - R0008 - Stage - (93.49 SQM)	Not Applicable	Circulation or storage space.
B00H - R0002 - Fitness Laboratory - (24.64 SQM)	● Student Space (11)	
B00H - R0004 - Fitness Laboratory - (69.71 SQM)	● Student Space (32)	
B00K - R0001 - Lecture Space - (64.38 SQM) - Teaching Space: 2	● Student Space (29)	
B00K - R0002 - Tiered Learning Area - (91.7 SQM)	● Student Space (42)	
B00K - R0005 - Movement - (7.04 SQM)	Not Applicable	Circulation or storage space.
B00K - R0008 - Performance Workshop - (28.38 SQM)	● Student Space (13)	
B00K - R0009 - Movement - (17.76 SQM)	Not Applicable	Circulation or storage space.
B00K - R1002 - Movement - (21.93 SQM)	Not Applicable	Circulation or storage space.
OS 600 14567 - OS 600 14567 - Learning Unit - Small - (57 SQM)	● Student Space (26)	
OS 600 15774 - OS 600 15774 - Learning Unit - Small - (57 SQM)	● Student Space (26)	
OS 600 17413 - OS 600 17413 - Learning Unit - Small - (57 SQM)	● Student Space (26)	
OS 600 18235 - OS 600 18235 - Learning Unit - Small - (57 SQM)	● Student Space (26)	
OS 601 11204 - OS 601 11204 - Learning Unit - Standard/Withdrawal - (76 SQM)	● Student Space (35)	
OS 601 12810 - OS 601 12810 - Learning Unit - Standard/Withdrawal - (76 SQM)	● Student Space (35)	
OS 601 19481 - OS 601 19481 - Learning Unit - Standard/Withdrawal - (76 SQM)	● Student Space (35)	
OS 602 11876 - OS 602 11876 - Learning Unit - Standard With P.A.A. - (76 SQM)	● Student Space (35)	