

VENTILATION AUDIT REPORT

| | |
|-------------------------------|-------------------------------------|
| SCHOOL: | Concord Public School (1607) |
| AMU REGION: | South Western Sydney |
| STATE ELECTORATE: | Drummoyne |
| LOCAL GOVERNMENT AREA: | Canada Bay |

1607 - Concord Public School
Site Plan (12257)

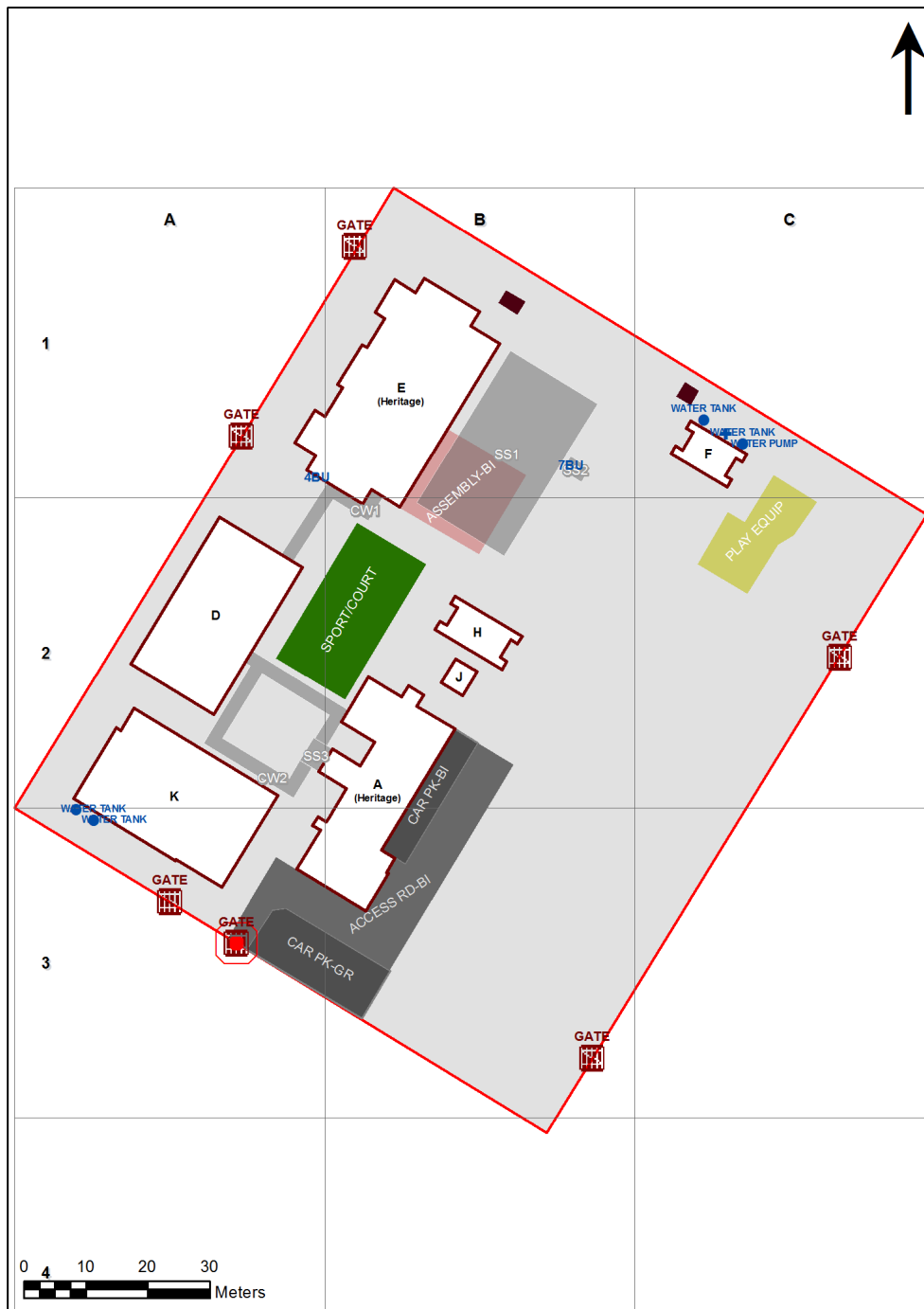

1:766

Printed: 20-Mar-2020

Ventilation Audit Key

| Category | Description |
|---|--|
|  | Category A Operate this space in line with COVID safe school operations . It has the required level of natural ventilation. NB. Circulation and storage areas should not be used for groups or gatherings. |
|  | Category B This space should be occupied at 1 person per 4m ² to comply with COVID safe school operations and the guided use of spaces . The report details the number of people who can be accommodated safely in each of the identified spaces. |

| Entity Location | Audit Condition Classification (Capacity) | Comment |
|--|---|-------------------------------|
| B00A - R0001 - Home Base - (46.73 SQM) - Teaching Space: 1 | ● Student Space (21) | |
| B00A - R0002 - Staff Room - (49.15 SQM) | ● Office (12) | |
| B00A - R0003 - Duplicating Workroom - (43.67 SQM) | ● Office (10) | |
| B00A - R0006 - Principal - (18.07 SQM) | ● Office (4) | |
| B00A - R0007 - Clerical Office - (17.17 SQM) | ● Office (4) | |
| B00A - R0008 - Deputy Principal - (9.12 SQM) | ● Office (2) | |
| B00A - R0009 - Sick Bay - (10.15 SQM) | ● Student Space (4) | |
| B00A - R0010 - Entry Vestibule - (14.98 SQM) | Not Applicable | Circulation or storage space. |
| B00A - R0011 - Movement - (23.8 SQM) | Not Applicable | Circulation or storage space. |
| B00A - R0013 - Movement - (53.79 SQM) | Not Applicable | Circulation or storage space. |
| B00A - R0014 - Canteen - (17.52 SQM) | Not Applicable | Circulation or storage space. |
| B00A - R1001 - Home Base - (48.77 SQM) - Teaching Space: 1 | ● Student Space (22) | |
| B00A - R1002 - Home Base - (49.81 SQM) - Teaching Space: 1 | ● Student Space (23) | |
| B00A - R1003 - Home Base - (48.37 SQM) - Teaching Space: 1 | ● Student Space (22) | |
| B00A - R1004 - Practical Activities - 1hb - (12.72 SQM) | ● Student Space (5) | |
| B00A - R1005 - Home Base - (61.06 SQM) - Teaching Space: 1 | ● Student Space (28) | |
| B00A - R1006 - Movement - (13.34 SQM) | Not Applicable | Circulation or storage space. |
| B00A - R1007 - Movement - (16.04 SQM) | Not Applicable | Circulation or storage space. |
| B00A - R1008 - Practical Activities - 1hb - (47.02 SQM) | ● Student Space (21) | |
| B00A - R1009 - Withdrawal Space - 1hb - (17.61 SQM) | ● Student Space (8) | |
| B00A - R1010 - Movement - (7.4 SQM) | Not Applicable | Circulation or storage space. |
| B00D - R0006 - Reading Area - (157.66 SQM) | ● Student Space (73) | |
| B00D - R0008 - Special Programs Room - (43.06 SQM) | ● Student Space (19) | |
| B00E - R0002 - Practical Activities - 1hb - (10.58 SQM) | ● Student Space (4) | |
| B00E - R0003 - Home Base - (36.76 SQM) - Teaching Space: 1 | ● Student Space (17) | |
| B00E - R0004 - Practical Activities - 1hb - (11.73 SQM) | ● Student Space (5) | |
| B00E - R0006 - Home Base - (47.21 SQM) - Teaching Space: 1 | ● Student Space (21) | |
| B00E - R0008 - Movement - (16.37 SQM) | Not Applicable | Circulation or storage space. |
| B00E - R0014 - Staff Room Annexe - (16.87 SQM) | ● Office (4) | |
| B00E - R0021 - Movement - (15.94 SQM) | Not Applicable | Circulation or storage space. |
| B00E - R0022 - Movement - (12.79 SQM) | Not Applicable | Circulation or storage space. |
| B00E - R0023 - Movement - (45.1 SQM) | Not Applicable | Circulation or storage space. |
| B00E - R0024 - Movement - (12.97 SQM) | Not Applicable | Circulation or storage space. |
| B00E - R0027 - Home Base - (47.85 SQM) - Teaching Space: 1 | ● Student Space (22) | |
| B00E - R0028 - Home Base - (36.68 SQM) - Teaching Space: 1 | ● Student Space (17) | |
| B00E - R0029 - Home Base - (99.37 SQM) - Teaching Space: 1 | ● Student Space (46) | |
| B00E - R0030 - Home Base - (35.53 SQM) - Teaching Space: 1 | ● Student Space (16) | |
| B00E - R1001 - Home Base - (48.64 SQM) - Teaching Space: 1 | ● Student Space (22) | |
| B00E - R1002 - Home Base - (48.44 SQM) - Teaching Space: 1 | ● Student Space (22) | |
| B00E - R1003 - Home Base - (48.3 SQM) - Teaching Space: 1 | ● Student Space (22) | |
| B00E - R1004 - Home Base - (48.99 SQM) - Teaching Space: 1 | ● Student Space (22) | |
| B00E - R1008 - Movement - (89.35 SQM) | Not Applicable | Circulation or storage space. |
| B00K - R0001 - Communal Space - (144.46 SQM) | ● Student Space (67) | |
| B00K - R0002 - Raised Platform - (60.59 SQM) | Not Applicable | Circulation or storage space. |
| B00K - R0016 - Movement - (7.1 SQM) | Not Applicable | Circulation or storage space. |
| B00K - R0017 - Movement - (12.03 SQM) | Not Applicable | Circulation or storage space. |
| B00K - R0018 - Movement - (11.68 SQM) | Not Applicable | Circulation or storage space. |