

VENTILATION AUDIT REPORT

SCHOOL:	Coffs Harbour Public School (1584)
AMU REGION:	North Coast
STATE ELECTORATE:	Coffs Harbour
LOCAL GOVERNMENT AREA:	Coffs Harbour

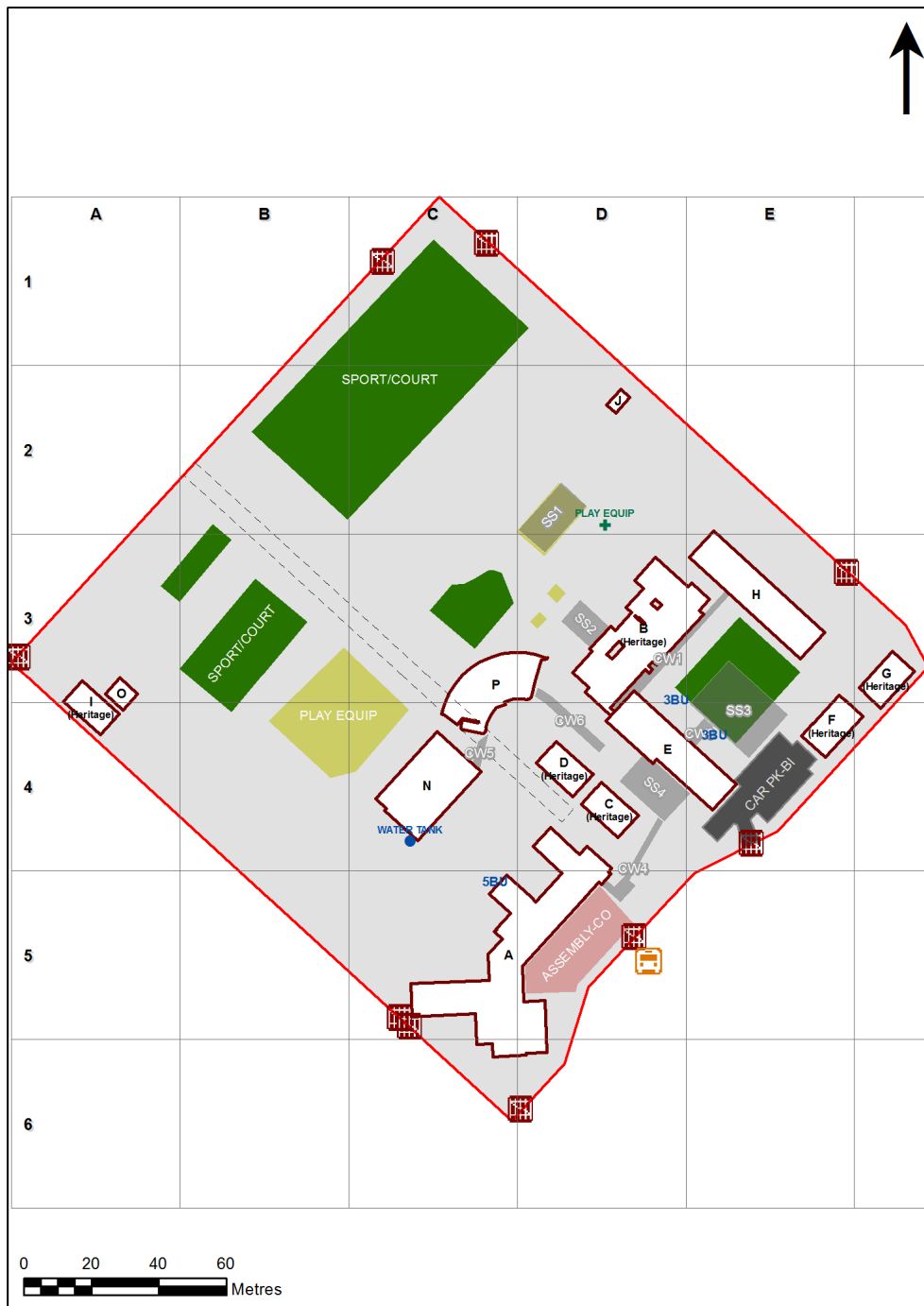

1584 - Coffs Harbour Public School
Site Plan (11653)



1:1,406

Printed: 12-Sep-2020

Ventilation Audit Key

Category	Description
	Category A Operate this space in line with COVID safe school operations . It has the required level of natural ventilation. NB. Circulation and storage areas should not be used for groups or gatherings.
	Category B This space should be occupied at 1 person per 4m ² to comply with COVID safe school operations and the guided use of spaces . The report details the number of people who can be accommodated safely in each of the identified spaces.

Entity Location	Audit Condition Classification (Capacity)	Comment
B00A - R0001 - Movement - (7.14 SQM)	Not Applicable	Circulation or storage space.
B00A - R0002 - Movement - (82.82 SQM)	Not Applicable	Circulation or storage space.
B00A - R0004 - Withdrawal Space - 1hb - (9.98 SQM)	● Student Space (4)	
B00A - R0005 - Deputy Principal - (16.24 SQM)	● Office (4)	
B00A - R0012 - Home Base - (51.21 SQM) - Teaching Space: 1	● Student Space (23)	
B00A - R0013 - Home Base - (51.62 SQM) - Teaching Space: 1	● Student Space (23)	
B00A - R0018 - Movement - (5.5 SQM)	Not Applicable	Circulation or storage space.
B00A - R0019 - Home Base - (51.46 SQM) - Teaching Space: 1	● Student Space (23)	
B00A - R0020 - Withdrawal Space - 1hb - (30.15 SQM)	● Student Space (13)	
B00A - R0022 - Home Base - S - (51.55 SQM) - Teaching Space: 1	● Student Space (23)	
B00A - R0023 - Practical Activities - S - 1hb - (8.75 SQM)	● Student Space (4)	
B00A - R0025 - Movement - (68.8 SQM)	Not Applicable	Circulation or storage space.
B00A - R0027 - Home Base - (68.18 SQM) - Teaching Space: 1	● Student Space (31)	
B00A - R0028 - Home Base - (67.23 SQM) - Teaching Space: 1	● Student Space (31)	
B00A - R0029 - Movement - (23.21 SQM)	Not Applicable	Circulation or storage space.
B00A - R0031 - Practical Activities - 1hb - (8.23 SQM)	● Student Space (3)	
B00A - R0043 - Practical Activities - 2hb - (52.47 SQM)	● Student Space (24)	
B00A - R0044 - Home Base - (49.25 SQM) - Teaching Space: 1	● Student Space (22)	
B00A - R0045 - Home Base - (49.71 SQM) - Teaching Space: 1	● Student Space (23)	
B00A - R0046 - Withdrawal Space - 2hb - (11.36 SQM)	● Student Space (5)	
B00A - R1002 - Movement - (77.37 SQM)	Not Applicable	Circulation or storage space.
B00A - R1003 - Withdrawal Space - 1hb - (10.23 SQM)	● Student Space (4)	
B00A - R1004 - Practical Activities - 1hb - (19.88 SQM)	● Student Space (9)	
B00A - R1005 - Home Base - (31.92 SQM) - Teaching Space: 1	● Student Space (14)	
B00A - R1007 - Home Base - (51.48 SQM) - Teaching Space: 1	● Student Space (23)	
B00A - R1008 - Practical Activities - 1hb - (10.27 SQM)	● Student Space (4)	
B00A - R1009 - Home Base - (51.46 SQM) - Teaching Space: 1	● Student Space (23)	
B00A - R1011 - Home Base - (51.46 SQM) - Teaching Space: 1	● Student Space (23)	
B00A - R9002 - Movement - (41.73 SQM)	Not Applicable	Circulation or storage space.
B00A - R9004 - Canteen - (10.18 SQM)	Not Applicable	Circulation or storage space.
B00A - R9007 - Canteen - (16.1 SQM)	Not Applicable	Circulation or storage space.
B00B - R0001 - Deputy Principal - (14.92 SQM)	● Office (3)	
B00B - R0002 - Interview - (13.4 SQM)	● Office (3)	
B00B - R0003 - Practical Activities - S - 1hb - (18.38 SQM)	● Student Space (8)	
B00B - R0005 - Movement - (16.23 SQM)	Not Applicable	Circulation or storage space.
B00B - R0006 - Staff Room Annexe - (16.19 SQM)	● Office (4)	
B00B - R0007 - Practical Activities - P - 1hb - (51.53 SQM)	● Student Space (23)	
B00B - R0010 - Movement - (91.76 SQM)	Not Applicable	Circulation or storage space.
B00B - R0011 - Practical Activities - 1hb - (8.36 SQM)	● Student Space (3)	
B00B - R0012 - Home Base - (36.84 SQM) - Teaching Space: 1	● Student Space (17)	
B00B - R0017 - Withdrawal Space - 1hb - (13.76 SQM)	● Student Space (6)	
B00B - R0018 - Practical Activities - 1hb - (8.62 SQM)	● Student Space (3)	
B00B - R0019 - Home Base - S - (37.21 SQM) - Teaching Space: 1	● Student Space (17)	
B00B - R0020 - Practical Activities - S - 1hb - (16.13 SQM)	● Student Space (7)	
B00B - R0031 - Staff Room - (71.9 SQM)	● Office (17)	
B00B - R0032 - Staff Kitchen - (18.16 SQM)	● Office (4)	
B00C - R0002 - Home Base - (44.13 SQM) - Teaching Space: 1	● Student Space (20)	
B00C - R0003 - Home Base - (44.13 SQM) - Teaching Space: 1	● Student Space (20)	

Entity Location	Audit Condition Classification (Capacity)	Comment
B00D - R0002 - Home Base - (44.33 SQM) - Teaching Space: 1	● Student Space (20)	
B00D - R0003 - Home Base - (44.21 SQM) - Teaching Space: 1	● Student Space (20)	
B00E - R0031 - Entry Vestibule - (18.68 SQM)	Not Applicable	Circulation or storage space.
B00E - R0032 - Clerical Office - (48.37 SQM)	● Office (12)	
B00E - R0033 - Movement - (21.26 SQM)	Not Applicable	Circulation or storage space.
B00E - R0034 - Sick Bay - (11.98 SQM)	● Student Space (5)	
B00E - R0035 - Interview - (12.6 SQM)	● Office (3)	
B00E - R0036 - Deputy Principal - Type 1 - (10.51 SQM)	● Office (2)	
B00E - R0037 - Deputy Principal - Type 1 - (14.39 SQM)	● Office (3)	
B00E - R0040 - Staff Room Annexe - (16.37 SQM)	● Office (4)	
B00E - R0041 - Staff Room - (39.54 SQM)	● Office (9)	
B00E - R0044 - Interview - (13.13 SQM)	● Office (3)	
B00E - R0045 - Principal - (13.35 SQM)	● Office (3)	
B00E - R0046 - Staff Kitchen - (8.92 SQM)	● Office (2)	
B00F - R0004 - Home Base - (43.44 SQM) - Teaching Space: 1	● Student Space (20)	
B00F - R0005 - Home Base - (41.3 SQM) - Teaching Space: 1	● Student Space (19)	
B00G - R0002 - Staff Room Annexe - (6.35 SQM)	● Office (1)	
B00G - R0005 - Home Base - (89.15 SQM) - Teaching Space: 1	● Student Space (41)	
B00H - M0002 - Movement - (8.14 SQM)	Not Applicable	Circulation or storage space.
B00H - M0004 - Movement - (8.08 SQM)	Not Applicable	Circulation or storage space.
B00H - R0007 - Movement - (5.2 SQM)	Not Applicable	Circulation or storage space.
B00H - R0014 - Special Programs Room - (91.35 SQM)	● Student Space (42)	
B00H - R0015 - Practical Activities - 1hb - (26.01 SQM)	● Student Space (12)	
B00H - R1001 - Movement - (82.95 SQM)	Not Applicable	Circulation or storage space.
B00H - R1002 - Home Base - (57.44 SQM) - Teaching Space: 1	● Student Space (26)	
B00H - R1004 - Movement - (13.7 SQM)	Not Applicable	Circulation or storage space.
B00H - R1006 - Home Base - (57.51 SQM) - Teaching Space: 1	● Student Space (26)	
B00H - R1007 - Home Base - (57.44 SQM) - Teaching Space: 1	● Student Space (26)	
B00H - R1009 - Movement - (13.76 SQM)	Not Applicable	Circulation or storage space.
B00H - R1012 - Home Base - (57.58 SQM) - Teaching Space: 1	● Student Space (26)	
B00N - R0001 - Communal Space - (146.66 SQM)	● Student Space (68)	
B00N - R0002 - Raised Platform - (60.64 SQM)	Not Applicable	Circulation or storage space.
B00N - R0016 - Movement - (7.01 SQM)	Not Applicable	Circulation or storage space.
B00N - R0017 - Movement - (11.22 SQM)	Not Applicable	Circulation or storage space.
B00P - R1001 - Reading Area - (253.53 SQM)	● Student Space (117)	