

VENTILATION AUDIT REPORT

SCHOOL:	Chifley College Shalvey Campus (8496)
AMU REGION:	Western Sydney
STATE ELECTORATE:	Mount Druitt
LOCAL GOVERNMENT AREA:	Blacktown

8496 - Chifley College Shalvey Campus
Site Plan (10688)

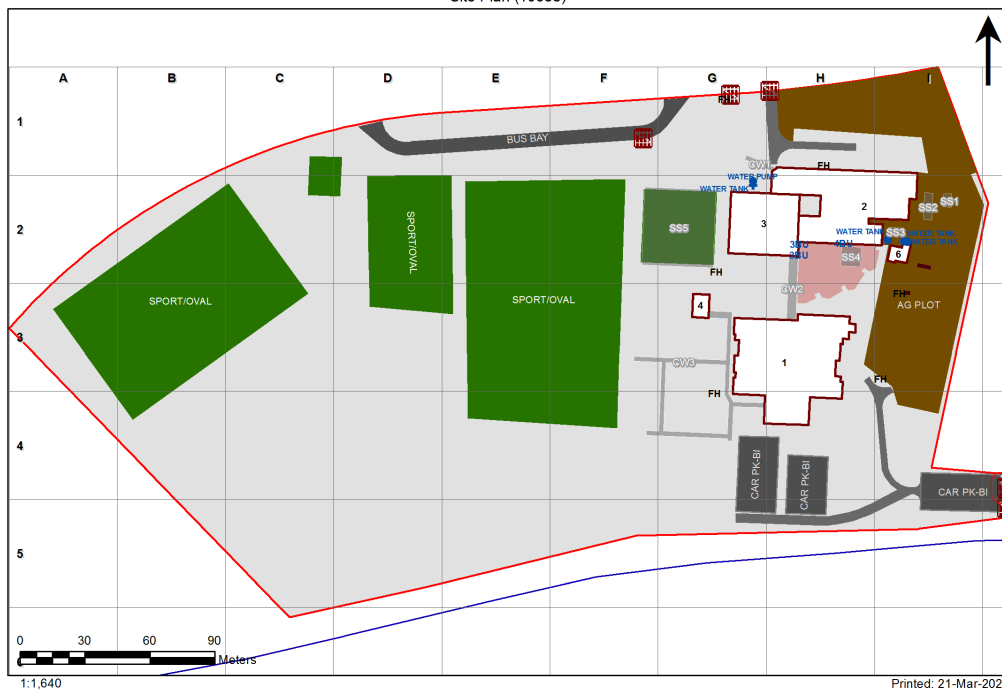







Printed: 21-Mar-2020

Ventilation Audit Key

Category	Description
	Category A Operate this space in line with COVID safe school operations . It has the required level of natural ventilation. NB. Circulation and storage areas should not be used for groups or gatherings.
	Category B This space should be occupied at 1 person per 4m ² to comply with COVID safe school operations and the guided use of spaces . The report details the number of people who can be accommodated safely in each of the identified spaces.

Entity Location	Audit Condition Classification (Capacity)	Comment
B001 - R0005 - General Learning Space - (89.06 SQM) - Teaching Space: 1	Student Space (41)	
B001 - R0006 - Commonroom - (92.35 SQM)	Office (23)	
B001 - R0007 - General Learning Space - (52.94 SQM) - Teaching Space: 1	Student Space (24)	
B001 - R0008 - General Learning Space - (53.31 SQM) - Teaching Space: 1	Student Space (24)	
B001 - R0009 - General Learning Space - (52.22 SQM) - Teaching Space: 1	Student Space (24)	
B001 - R0010 - Staff Study - (27.21 SQM)	Office (6)	
B001 - R0019 - Interview/Office - Type 1 - (10.99 SQM)	Office (2)	
B001 - R0020 - General Learning Space - (48.89 SQM) - Teaching Space: 1	Student Space (22)	
B001 - R0021 - General Learning Space - (51.78 SQM) - Teaching Space: 1	Student Space (24)	
B001 - R0022 - General Learning Space - (52 SQM) - Teaching Space: 1	Student Space (24)	
B001 - R0023 - General Learning Space - (54.7 SQM) - Teaching Space: 1	Student Space (25)	
B001 - R0024 - Interview/Office - Type 1 - (18.8 SQM)	Office (4)	
B001 - R0025 - Leading Teacher - (15.85 SQM)	Office (3)	
B001 - R0026 - Movement - (18.6 SQM)	Not Applicable	Circulation or storage space.
B001 - R0031 - Duplicating Workroom - (13.97 SQM)	Office (3)	
B001 - R0034 - Duplicating Workroom - (10.02 SQM)	Office (2)	
B001 - R0036 - Principal Office - (14.58 SQM)	Office (3)	
B001 - R0037 - Principal Office - (12.15 SQM)	Office (3)	
B001 - R0038 - Deputy Principal Office - (20.1 SQM)	Office (5)	
B001 - R0043 - Administration - Clerical - (28.43 SQM)	Office (7)	
B001 - R0045 - Public Entry - (19.27 SQM)	Not Applicable	Circulation or storage space.
B001 - R0046 - Deputy Principal - (14.11 SQM)	Office (3)	
B001 - R0048 - General Learning Space - (54.4 SQM) - Teaching Space: 1	Student Space (25)	
B001 - R0049 - General Learning Space - (52 SQM) - Teaching Space: 1	Student Space (24)	
B001 - R0056 - General Learning Space - (52.08 SQM) - Teaching Space: 1	Student Space (24)	
B001 - R0061 - Movement - (46.19 SQM)	Not Applicable	Circulation or storage space.
B001 - R0062 - Movement - (10.69 SQM)	Not Applicable	Circulation or storage space.
B001 - R0063 - Workshop - (123.11 SQM)	Student Space (57)	
B001 - R0066 - Darkroom Space - (31.95 SQM)	Office (7)	
B001 - R0070 - Staff Study - (43.98 SQM)	Office (10)	
B001 - R0081 - Public Entry - (20.76 SQM)	Not Applicable	Circulation or storage space.
B001 - R0083 - Movement - (310.89 SQM)	Not Applicable	Circulation or storage space.
B001 - R1001 - Laboratory L.S. - (87.65 SQM) - Teaching Space: 1	Student Space (40)	
B001 - R1002 - Preparation - (50.71 SQM)	Not Applicable	Circulation or storage space.
B001 - R1004 - Laboratory L.S. - (89.24 SQM) - Teaching Space: 1	Student Space (41)	
B001 - R1007 - General Learning Space - (52.22 SQM) - Teaching Space: 1	Student Space (24)	
B001 - R1008 - General Learning Space - (52.58 SQM) - Teaching Space: 1	Student Space (24)	
B001 - R1009 - Interview/Office - Type 1 - (27.06 SQM)	Office (6)	
B001 - R1012 - Teachers Aides - (39.33 SQM)	Office (9)	
B001 - R1013 - General Learning Space - (51.64 SQM) - Teaching Space: 1	Student Space (23)	
B001 - R1030 - General Learning Space - (52 SQM) - Teaching Space: 1	Student Space (24)	
B001 - R1031 - General Learning Space - (54.56 SQM) - Teaching Space: 1	Student Space (25)	
B001 - R1032 - General Learning Space - (52.08 SQM) - Teaching Space: 1	Student Space (24)	
B001 - R1033 - Computer Learning Space - (52.57 SQM) - Teaching Space: 1	Student Space (24)	
B001 - R1035 - Staff Study - (42.43 SQM)	Office (10)	
B001 - R1036 - General Learning Space - (51.79 SQM) - Teaching Space: 1	Student Space (24)	
B001 - R1037 - General Learning Space - (54.63 SQM) - Teaching Space: 1	Student Space (25)	

Entity Location	Audit Condition Classification (Capacity)	Comment
B001 - R1038 - Seminar - (15.84 SQM)	Office (3)	
B001 - R1042 - Seminar - (13.87 SQM)	Office (3)	
B001 - R1044 - Movement - (332.4 SQM)	Not Applicable	Circulation or storage space.
B001 - R1046 - Staff Study - (28.72 SQM)	Office (7)	
B001 - R1048 - Gymnasium - (106.91 SQM)	Student Space (49)	
B001 - R1057 - Movement - (6.16 SQM)	Not Applicable	Circulation or storage space.
B001 - R1061 - Main Area - (313.93 SQM)	Not Applicable	Circulation or storage space.
B001 - R2001 - Main Area - (182.11 SQM)	Not Applicable	Circulation or storage space.
B001 - R2004 - Leading Teacher - (15.97 SQM)	Office (3)	
B001 - R2005 - Seminar - (16.09 SQM)	Office (4)	
B001 - R2006 - Seminar - (15.84 SQM)	Office (3)	
B001 - R2008 - Laboratory L.S. - (87.66 SQM) - Teaching Space: 1	Student Space (40)	
B001 - R2009 - Preparation - (36.69 SQM)	Not Applicable	Circulation or storage space.
B001 - R2010 - Darkroom Space - (12.28 SQM)	Office (3)	
B001 - R2013 - Laboratory L.S. - (89.25 SQM) - Teaching Space: 1	Student Space (41)	
B001 - R2014 - Music Learning Space - (85.81 SQM) - Teaching Space: 1	Student Space (39)	
B001 - R2015 - Study Space - (13.33 SQM)	Not Applicable	Circulation or storage space.
B001 - R2016 - Study Space - (13.4 SQM)	Not Applicable	Circulation or storage space.
B001 - R2018 - Music Learning Space - (65.4 SQM) - Teaching Space: 1	Student Space (30)	
B001 - R2019 - Movement - (16.39 SQM)	Not Applicable	Circulation or storage space.
B001 - R2020 - Special Learning Space - (65.09 SQM) - Teaching Space: 1	Student Space (30)	
B001 - R2023 - Commonroom - (25.29 SQM)	Office (6)	
B001 - R2024 - Special Learning Space - (49.68 SQM) - Teaching Space: 1	Student Space (23)	
B001 - R2026 - Special Learning Space - (52.01 SQM) - Teaching Space: 1	Student Space (24)	
B001 - R2027 - General Learning Space - (52.01 SQM) - Teaching Space: 1	Student Space (24)	
B001 - R2028 - General Learning Space - (54.64 SQM) - Teaching Space: 1	Student Space (25)	
B001 - R2029 - General Learning Space - (54.64 SQM) - Teaching Space: 1	Student Space (25)	
B001 - R2030 - General Learning Space - (51.72 SQM) - Teaching Space: 1	Student Space (23)	
B001 - R2031 - Staff Study - (42.44 SQM)	Office (10)	
B001 - R2032 - Staff Study - (46.75 SQM)	Office (11)	
B001 - R2033 - General Learning Space - (52 SQM) - Teaching Space: 1	Student Space (24)	
B001 - R2034 - Computer Learning Space - (52.36 SQM) - Teaching Space: 1	Student Space (24)	
B001 - R2040 - Movement - (16.34 SQM)	Not Applicable	Circulation or storage space.
B001 - R2046 - Movement - (269.33 SQM)	Not Applicable	Circulation or storage space.
B002 - R0001 - General Assistants - (14.75 SQM)	Office (3)	
B002 - R0003 - Materials Technology L.S. - (173.14 SQM) - Teaching Space: 1	Student Space (80)	
B002 - R0006 - Staff Study - (26.82 SQM)	Office (6)	
B002 - R0007 - Design L.S. - (66.09 SQM) - Teaching Space: 1	Student Space (30)	
B002 - R0019 - Movement - (77.03 SQM)	Not Applicable	Circulation or storage space.
B002 - R0021 - Workshop Area - (59.5 SQM)	Student Space (27)	
B002 - R0022 - Materials Technology L.S. - (83.76 SQM) - Teaching Space: 1	Student Space (38)	
B002 - R0023 - Wood Technology Bay - (13.89 SQM)	Not Applicable	Circulation or storage space.
B002 - R0028 - Materials Technology L.S. - (81.92 SQM) - Teaching Space: 1	Student Space (38)	
B002 - R0029 - Design L.S. - (52.91 SQM) - Teaching Space: 1	Student Space (24)	
B002 - R0030 - Staff Study - (43.23 SQM)	Office (10)	
B002 - R0034 - Movement - (41.11 SQM)	Not Applicable	Circulation or storage space.
B002 - R0038 - Food Technology L.S. - (83.3 SQM) - Teaching Space: 1	Student Space (38)	
B002 - R0039 - Food/Research Space - (14.98 SQM)	Not Applicable	Circulation or storage space.
B002 - R0040 - Preparation - (17 SQM)	Not Applicable	Circulation or storage space.

Entity Location	Audit Condition Classification (Capacity)	Comment
B002 - R0041 - Food Technology L.S. - (82.84 SQM) - Teaching Space: 1	 Student Space (38)	
B002 - R0042 - Design L.S. - (65.91 SQM) - Teaching Space: 1	 Student Space (30)	
B002 - R0045 - Design L.S. - (66.55 SQM) - Teaching Space: 1	 Student Space (30)	
B002 - R0047 - General Learning Space - (58.86 SQM) - Teaching Space: 1	 Student Space (27)	
B002 - R0048 - Workshop - (107.65 SQM)	 Student Space (49)	
B002 - R0049 - Practice/Seminar - (19.47 SQM)	Not Applicable	Circulation or storage space.
B002 - R0050 - Practice/Seminar - (19.28 SQM)	Not Applicable	Circulation or storage space.
B002 - R0052 - Movement - (74.52 SQM)	Not Applicable	Circulation or storage space.
B002 - R0053 - Movement - (26.41 SQM)	Not Applicable	Circulation or storage space.
B003 - R0001 - Multi-Purpose Space - (457.16 SQM)	 Student Space (212)	
B003 - R0013 - Student Canteen - (54.7 SQM)	Not Applicable	Circulation or storage space.
B003 - R0014 - Movement - (107.3 SQM)	Not Applicable	Circulation or storage space.
B004 - R0004 - Movement - (23.73 SQM)	Not Applicable	Circulation or storage space.