

VENTILATION AUDIT REPORT

SCHOOL:	Cheltenham Girls High School (8208)
AMU REGION:	Northern Sydney
STATE ELECTORATE:	Epping
LOCAL GOVERNMENT AREA:	Hornsby

8208 - Cheltenham Girls High School
Site Plan (10229)

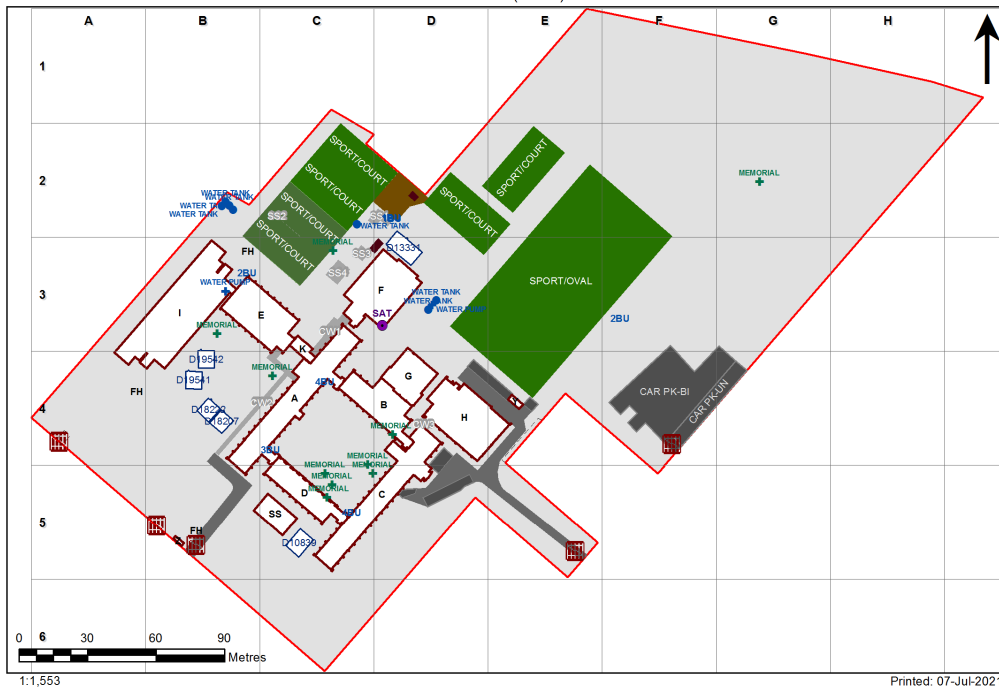

1:1,553

Printed: 07-Jul-2021



Ventilation Audit Key

Category	Description
	Category A Operate this space in line with COVID safe school operations . It has the required level of natural ventilation. NB. Circulation and storage areas should not be used for groups or gatherings.
	Category B This space should be occupied at 1 person per 4m ² to comply with COVID safe school operations and the guided use of spaces . The report details the number of people who can be accommodated safely in each of the identified spaces.

Entity Location	Audit Condition Classification (Capacity)	Comment
B00A - R0011 - Food Technology L.S. - (88.61 SQM) - Teaching Space: 1	● Student Space (41)	
B00A - R0013 - Preparation - Materials - (15.61 SQM)	Not Applicable	Circulation or storage space.
B00A - R0014 - Staff Study - (43.67 SQM)	● Office (10)	
B00A - R0015 - General Learning Space - (43.54 SQM)	● Student Space (20)	
B00A - R0018 - Laboratory L.S. - (99.16 SQM) - Teaching Space: 1	● Student Space (46)	
B00A - R0020 - Food Technology L.S. - (68.4 SQM) - Teaching Space: 1	● Student Space (31)	
B00A - R0021 - Preparation - Materials - (33.92 SQM)	Not Applicable	Circulation or storage space.
B00A - R0028 - Food Technology L.S. - (69.73 SQM) - Teaching Space: 1	● Student Space (32)	
B00A - R0029 - Movement - (198.45 SQM)	Not Applicable	Circulation or storage space.
B00A - R0030 - Movement - (5.76 SQM)	Not Applicable	Circulation or storage space.
B00A - R1001 - Design L.S. - (69.75 SQM) - Teaching Space: 1	● Student Space (32)	
B00A - R1003 - Design L.S. - (65.97 SQM) - Teaching Space: 1	● Student Space (30)	
B00A - R1009 - General Learning Space - (66.11 SQM) - Teaching Space: 1	● Student Space (30)	
B00A - R1010 - General Learning Space - (66.13 SQM) - Teaching Space: 1	● Student Space (30)	
B00A - R1011 - General Learning Space - (65.95 SQM) - Teaching Space: 1	● Student Space (30)	
B00A - R1012 - General Learning Space - (65.78 SQM) - Teaching Space: 1	● Student Space (30)	
B00A - R1013 - General Learning Space - (52.66 SQM) - Teaching Space: 1	● Student Space (24)	
B00A - R1014 - Staff Study - (18.81 SQM)	● Office (4)	
B00A - R1016 - Computer Learning Space - (69.34 SQM) - Teaching Space: 1	● Student Space (32)	
B00A - R1023 - Movement - (166.46 SQM)	Not Applicable	Circulation or storage space.
B00A - R1026 - Movement - (22.99 SQM)	Not Applicable	Circulation or storage space.
B00B - R0015 - Movement - (5.97 SQM)	Not Applicable	Circulation or storage space.
B00B - R0024 - Movement - (21.77 SQM)	Not Applicable	Circulation or storage space.
B00B - R1001 - General Learning Space - (65.73 SQM) - Teaching Space: 1	● Student Space (30)	
B00B - R1002 - General Learning Space - (66.13 SQM) - Teaching Space: 1	● Student Space (30)	
B00B - R1003 - General Learning Space - (52.87 SQM) - Teaching Space: 1	● Student Space (24)	
B00B - R1004 - General Learning Space - (52.22 SQM) - Teaching Space: 1	● Student Space (24)	
B00B - R1005 - Movement - (72.84 SQM)	Not Applicable	Circulation or storage space.
B00B - R1007 - Movement - (15.26 SQM)	Not Applicable	Circulation or storage space.
B00C - R0001 - Movement Studio - (80.58 SQM)	Not Applicable	Circulation or storage space.
B00C - R0008 - Deputy Principal Office - (16.94 SQM)	● Office (4)	
B00C - R0011 - Deputy Principal Office - (25.54 SQM)	● Office (6)	
B00C - R0012 - Staff Study - (38.95 SQM)	● Office (9)	
B00C - R0013 - Leading Teacher - (8.82 SQM)	● Office (2)	
B00C - R0014 - Interview/Office - Type 1 - (9.7 SQM)	● Office (2)	
B00C - R0016 - Clinic - Girls - (26.11 SQM)	● Office (6)	
B00C - R0018 - Interview/Office - Type 1 - (8.29 SQM)	● Office (2)	
B00C - R0021 - Administration - Clerical - (8.25 SQM)	● Office (2)	
B00C - R0024 - Staff Study - (52.22 SQM)	● Office (13)	
B00C - R0025 - Movement - (63.5 SQM)	Not Applicable	Circulation or storage space.
B00C - R0026 - Movement - (11.95 SQM)	Not Applicable	Circulation or storage space.
B00C - R0027 - Commonroom - (107.39 SQM)	● Office (26)	
B00C - R0028 - Staff Kitchen - (8.39 SQM)	● Office (2)	
B00C - R0030 - Administration - Executive - (25.74 SQM)	● Office (6)	
B00C - R0031 - Administration - Clerical - (47.66 SQM)	● Office (11)	
B00C - R0032 - Student Reception - (45.27 SQM)	Not Applicable	Circulation or storage space.
B00C - R0034 - Principal Office - (26.58 SQM)	● Office (6)	
B00C - R1001 - General Learning Space - (78.52 SQM) - Teaching Space: 1	● Student Space (36)	
B00C - R1005 - Staff Study - (17.59 SQM)	● Office (4)	

Entity Location	Audit Condition Classification (Capacity)	Comment
B00C - R1007 - General Learning Space - (52.01 SQM) - Teaching Space: 1	● Student Space (24)	
B00C - R1008 - General Learning Space - (51.93 SQM) - Teaching Space: 1	● Student Space (24)	
B00C - R1013 - General Learning Space - (52.37 SQM) - Teaching Space: 1	● Student Space (24)	
B00C - R1014 - Art Learning Space - (78.3 SQM) - Teaching Space: 1	● Student Space (36)	
B00C - R1022 - Movement - (37.25 SQM)	Not Applicable	Circulation or storage space.
B00C - R1023 - Movement - (36.93 SQM)	Not Applicable	Circulation or storage space.
B00C - R1024 - Movement - (21.32 SQM)	Not Applicable	Circulation or storage space.
B00C - R1025 - Art Learning Space - (76.14 SQM)	● Student Space (35)	
B00C - R1027 - Performance Workspace - (52.15 SQM) - Teaching Space: 1	● Student Space (24)	
B00D - R0006 - General Learning Space - (64.95 SQM) - Teaching Space: 1	● Student Space (30)	
B00D - R0007 - General Learning Space - (64.25 SQM) - Teaching Space: 1	● Student Space (29)	
B00D - R0011 - Movement - (21.64 SQM)	Not Applicable	Circulation or storage space.
B00D - R0012 - Staff Study - (23.2 SQM)	● Office (5)	
B00D - R0014 - Staff Study - (50.74 SQM)	● Office (12)	
B00D - R0016 - Leading Teacher - (16.05 SQM)	● Office (4)	
B00D - R0018 - Movement - (67.45 SQM)	Not Applicable	Circulation or storage space.
B00D - R1001 - General Learning Space - (52.15 SQM) - Teaching Space: 1	● Student Space (24)	
B00D - R1002 - General Learning Space - (52.15 SQM) - Teaching Space: 1	● Student Space (24)	
B00D - R1003 - Computer Learning Space - (65.39 SQM) - Teaching Space: 1	● Student Space (30)	
B00D - R1004 - General Learning Space - (65.24 SQM) - Teaching Space: 1	● Student Space (30)	
B00D - R1005 - Movement - (55.05 SQM)	Not Applicable	Circulation or storage space.
B00D - R1007 - Movement - (15.97 SQM)	Not Applicable	Circulation or storage space.
B00E - R0001 - Laboratory L.S. - (86.79 SQM) - Teaching Space: 1	● Student Space (40)	
B00E - R0002 - Preparation - Science - (28.09 SQM)	Not Applicable	Circulation or storage space.
B00E - R0004 - Laboratory L.S. - (86.86 SQM) - Teaching Space: 1	● Student Space (40)	
B00E - R0006 - Staff Study - (26.18 SQM)	● Office (6)	
B00E - R0009 - General Learning Space - (52.36 SQM) - Teaching Space: 1	● Student Space (24)	
B00E - R0025 - Laboratory L.S. - (65.78 SQM) - Teaching Space: 1	● Student Space (30)	
B00E - R0026 - Staff Study - (24.26 SQM)	● Office (6)	
B00E - R0028 - Movement - (90.49 SQM)	Not Applicable	Circulation or storage space.
B00E - R1006 - General Learning Space - (52.87 SQM) - Teaching Space: 1	● Student Space (24)	
B00E - R1008 - Staff Study - (26.22 SQM)	● Office (6)	
B00E - R1009 - Music Learning Space - (50.43 SQM) - Teaching Space: 1	● Student Space (23)	
B00E - R1010 - Music Learning Space - (49.5 SQM)	● Student Space (22)	
B00E - R1015 - Music Learning Space - (79.6 SQM) - Teaching Space: 1	● Student Space (36)	
B00E - R1018 - Movement - (91.64 SQM)	Not Applicable	Circulation or storage space.
B00E - R1021 - General Learning Space - (59.28 SQM) - Teaching Space: 1	● Student Space (27)	
B00E - R1022 - Art Learning Space - (57.31 SQM) - Teaching Space: 1	● Student Space (26)	
B00F - M1002 - Interview/Office - Type 1 - (15.34 SQM)	● Office (3)	
B00F - M1004 - Senior Study - (67.84 SQM)	● Office (16)	
B00F - M1005 - Senior Study - (38.25 SQM)	● Office (9)	
B00F - R0001 - Laboratory L.S. - (91.25 SQM) - Teaching Space: 1	● Student Space (42)	
B00F - R0005 - Laboratory L.S. - (91.16 SQM) - Teaching Space: 1	● Student Space (42)	
B00F - R0006 - Laboratory L.S. - (91.15 SQM) - Teaching Space: 1	● Student Space (42)	
B00F - R0010 - Laboratory L.S. - (91.14 SQM) - Teaching Space: 1	● Student Space (42)	
B00F - R0013 - Movement - (40.23 SQM)	Not Applicable	Circulation or storage space.
B00F - R0021 - Preparation - Science - (48.42 SQM)	Not Applicable	Circulation or storage space.
B00F - R1001 - Interview/Meeting - (12.7 SQM)	● Office (3)	
B00F - R1002 - Interview/Meeting - (11.63 SQM)	● Office (2)	

Entity Location	Audit Condition Classification (Capacity)	Comment
B00F - R1006 - Seminar - (11.66 SQM)	Office (2)	
B00F - R1007 - Seminar - (12.73 SQM)	Office (3)	
B00F - R1008 - Main Area - (287.74 SQM)	Not Applicable	Circulation or storage space.
B00F - R1009 - General Learning Space - (69.94 SQM) - Teaching Space: 1	Student Space (32)	
B00F - R1010 - Main Entry - (34.18 SQM)	Not Applicable	Circulation or storage space.
B00F - R1016 - Audio Visual Workroom - (27.94 SQM)	Student Space (12)	
B00F - R1024 - Tea Room - (5.81 SQM)	Not Applicable	Circulation or storage space.
B00G - R0002 - Student Canteen - (82.25 SQM)	Not Applicable	Circulation or storage space.
B00H - M0005 - Audio Visual Workroom - (17.43 SQM)	Student Space (8)	
B00H - R0002 - Multi-Purpose Space - (411.86 SQM)	Student Space (191)	
B00H - R0008 - Movement - (12.26 SQM)	Not Applicable	Circulation or storage space.
B00H - R0010 - Stage - (91.44 SQM)	Not Applicable	Circulation or storage space.
B00H - R0011 - Movement - (12.78 SQM)	Not Applicable	Circulation or storage space.
B00H - R9003 - General Assistants - (29.18 SQM)	Office (7)	
B00I - R0002 - General Learning Space - (60.2 SQM) - Teaching Space: 1	Student Space (27)	
B00I - R0003 - General Learning Space - (60.12 SQM) - Teaching Space: 1	Student Space (27)	
B00I - R0005 - General Learning Space - (59.9 SQM) - Teaching Space: 1	Student Space (27)	
B00I - R0007 - General Learning Space - (60.66 SQM) - Teaching Space: 1	Student Space (28)	
B00I - R0008 - General Learning Space - (59.9 SQM) - Teaching Space: 1	Student Space (27)	
B00I - R0009 - General Learning Space - (65.43 SQM) - Teaching Space: 1	Student Space (30)	
B00I - R0016 - Fitness Laboratory - (49.8 SQM)	Student Space (23)	
B00I - R0017 - General Learning Space - (59.72 SQM) - Teaching Space: 1	Student Space (27)	
B00I - R0018 - General Learning Space - (59.53 SQM) - Teaching Space: 1	Student Space (27)	
B00I - R0022 - Movement - (101.65 SQM)	Not Applicable	Circulation or storage space.
B00I - R0029 - Staff Study - (61.12 SQM)	Office (15)	
B00I - R1002 - General Learning Space - (60.44 SQM) - Teaching Space: 1	Student Space (28)	
B00I - R1003 - General Learning Space - (60.36 SQM) - Teaching Space: 1	Student Space (28)	
B00I - R1004 - Seminar - Type 1 - (25.1 SQM)	Office (6)	
B00I - R1005 - General Learning Space - (60.13 SQM) - Teaching Space: 1	Student Space (27)	
B00I - R1006 - Staff Study - (24.76 SQM)	Office (6)	
B00I - R1007 - General Learning Space - (60.13 SQM) - Teaching Space: 1	Student Space (27)	
B00I - R1008 - General Learning Space - (60.43 SQM) - Teaching Space: 1	Student Space (28)	
B00I - R1009 - Computer Learning Space - (64.75 SQM) - Teaching Space: 1	Student Space (30)	
B00I - R1010 - Movement - (16.95 SQM)	Not Applicable	Circulation or storage space.
B00I - R1014 - General Learning Space - (59.88 SQM) - Teaching Space: 1	Student Space (27)	
B00I - R1015 - General Learning Space - (59.79 SQM) - Teaching Space: 1	Student Space (27)	
B00I - R1016 - Independent Learning Space - (49.93 SQM) - Teaching Space: 1	Student Space (23)	
B00I - R1017 - General Learning Space - (59.79 SQM) - Teaching Space: 1	Student Space (27)	
B00I - R1018 - General Learning Space - (60.55 SQM) - Teaching Space: 1	Student Space (28)	
B00I - R1021 - Movement - (101.37 SQM)	Not Applicable	Circulation or storage space.
B00I - R1027 - Staff Study - (61.12 SQM)	Office (15)	
B0SS - R0001 - Senior Study - (89.93 SQM)	Office (22)	
B0SS - R0003 - Senior Study - (7.73 SQM)	Office (1)	
B0SS - R0004 - Senior Study - (7.59 SQM)	Office (1)	
NS 200 10850 - NS 200 10850 - Art Learning Space/Workshop/Bulk Store - (95 SQM)	Not Applicable	Circulation or storage space.
OS 600 18207 - OS 600 18207 - Learning Unit - Small - (57 SQM)	Student Space (26)	
OS 600 18222 - OS 600 18222 - Learning Unit - Small - (57 SQM)	Student Space (26)	
OS 600 19541 - OS 600 19541 - Learning Unit - Small - (57 SQM)	Student Space (26)	

Entity Location	Audit Condition Classification (Capacity)	Comment
OS 600 19542 - OS 600 19542 - Learning Unit - Small - (57 SQM)	 Student Space (26)	
OS 601 10839 - OS 601 10839 - Learning Unit - Standard/Withdrawal - (76 SQM)	 Student Space (35)	
OS 760 13331 - OS 760 13331 - Woodwork/Store - (114 SQM)	Not Applicable	Circulation or storage space.