

# VENTILATION AUDIT REPORT

SCHOOL:	Charlestown East Public School (4194)
AMU REGION:	Hunter/Central Coast
STATE ELECTORATE:	Charlestown
LOCAL GOVERNMENT AREA:	Lake Macquarie

4194 - Charlestown East Public School  
Site Plan (10248)

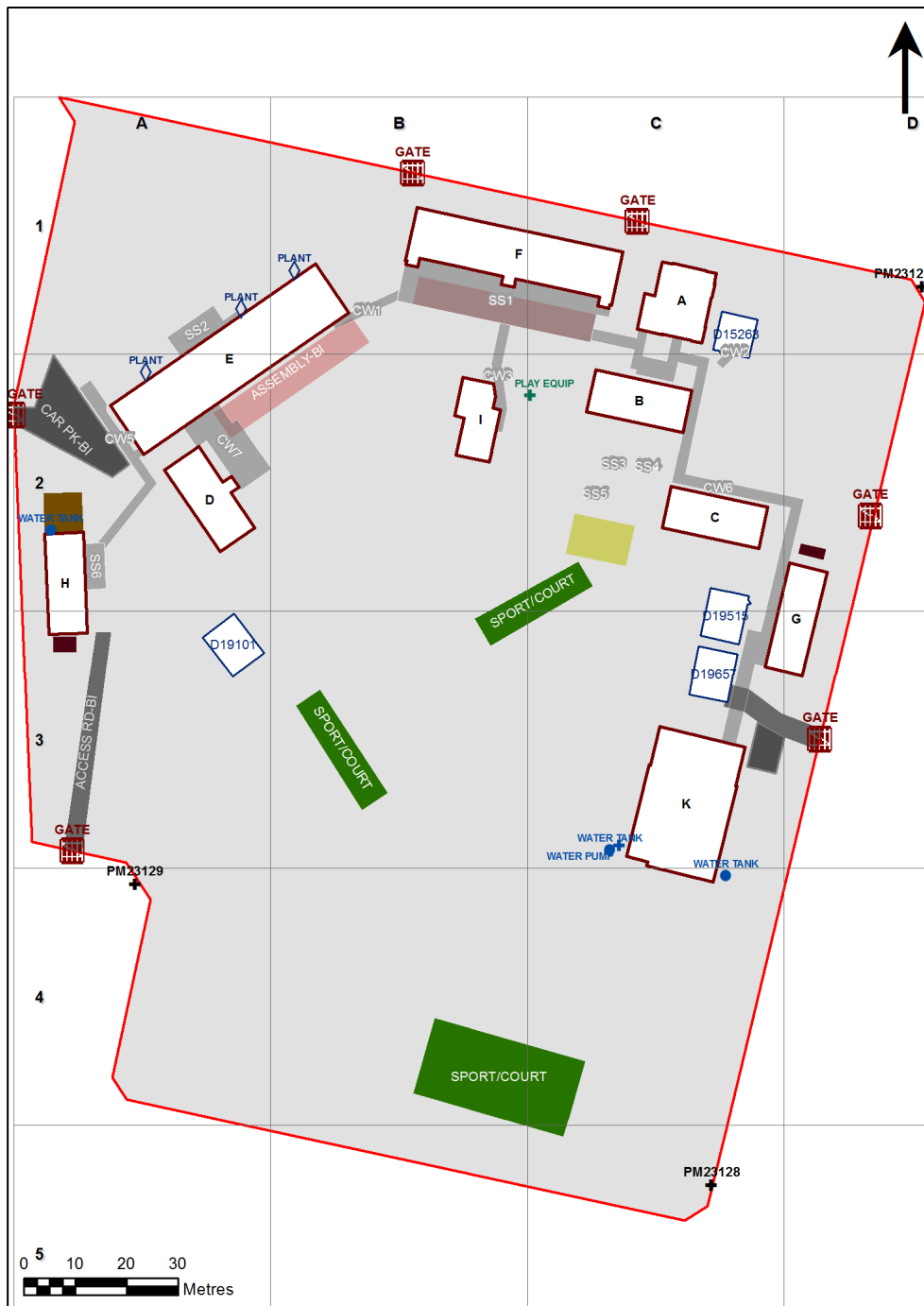

1:922

Printed: 28-Aug-2021

## Ventilation Audit Key

Category	Description
	Category A Operate this space in line with <a href="#">COVID safe school operations</a> . It has the required level of natural ventilation. NB. Circulation and storage areas should not be used for groups or gatherings.
	Category B This space should be occupied at 1 person per 4m <sup>2</sup> to comply with <a href="#">COVID safe school operations and the guided use of spaces</a> . The report details the number of people who can be accommodated safely in each of the identified spaces.

Entity Location	Audit Condition Classification (Capacity)	Comment
B00A - R0001 - Staff Room - (32.41 SQM)	Office (8)	
B00A - R0004 - Duplicating Workroom - (10.91 SQM)	Office (2)	
B00A - R0007 - Clerical Office - (18.36 SQM)	Office (4)	
B00A - R0008 - Entry Vestibule - (6.79 SQM)	Not Applicable	Circulation or storage space.
B00A - R0009 - Movement - (17.22 SQM)	Not Applicable	Circulation or storage space.
B00A - R0015 - Principal - (23.75 SQM)	Office (5)	
B00A - R0016 - Movement - (14.01 SQM)	Not Applicable	Circulation or storage space.
B00B - R0002 - Home Base - (58.81 SQM) - Teaching Space: 1	Student Space (27)	
B00B - R0004 - Movement - (16.59 SQM)	Not Applicable	Circulation or storage space.
B00B - R0006 - Home Base - (58.88 SQM) - Teaching Space: 1	Student Space (27)	
B00C - R0001 - Home Base - (58.56 SQM) - Teaching Space: 1	Student Space (27)	
B00C - R0004 - Movement - (5.33 SQM)	Not Applicable	Circulation or storage space.
B00C - R0007 - Home Base - (58.42 SQM) - Teaching Space: 1	Student Space (27)	
B00D - R0001 - Home Base - (58.19 SQM) - Teaching Space: 1	Student Space (26)	
B00D - R0006 - Movement - (7.05 SQM)	Not Applicable	Circulation or storage space.
B00D - R0009 - Home Base - (58.34 SQM) - Teaching Space: 1	Student Space (27)	
B00D - R0010 - Movement - (5.13 SQM)	Not Applicable	Circulation or storage space.
B00D - R0012 - Practical Activities - 2hb - (8.77 SQM)	Student Space (4)	
B00E - R0001 - Movement - (85.21 SQM)	Not Applicable	Circulation or storage space.
B00E - R0003 - Withdrawal Space - 1hb - (25.79 SQM)	Student Space (11)	
B00E - R0006 - Movement - (5.66 SQM)	Not Applicable	Circulation or storage space.
B00E - R0007 - Staff Room Annexe - (14.94 SQM)	Office (3)	
B00E - R0008 - Practical Activities - 1hb - (15.74 SQM)	Student Space (7)	
B00E - R0009 - Home Base - (67.42 SQM) - Teaching Space: 1	Student Space (31)	
B00E - R0010 - Movement - (12.37 SQM)	Not Applicable	Circulation or storage space.
B00E - R0011 - Home Base - (73.73 SQM) - Teaching Space: 1	Student Space (34)	
B00E - R0013 - Practical Activities - 1hb - (15.02 SQM)	Student Space (6)	
B00E - R0015 - Home Base - (74.05 SQM) - Teaching Space: 1	Student Space (34)	
B00E - R0016 - Movement - (12.39 SQM)	Not Applicable	Circulation or storage space.
B00E - R0017 - Home Base - (67.09 SQM) - Teaching Space: 1	Student Space (31)	
B00E - R0018 - Practical Activities - 1hb - (16.43 SQM)	Student Space (7)	
B00F - R0008 - Home Base - (67.01 SQM) - Teaching Space: 1	Student Space (31)	
B00F - R0009 - Home Base - (67.09 SQM) - Teaching Space: 1	Student Space (31)	
B00F - R0013 - Reading Area - (135.04 SQM)	Student Space (62)	
B00F - R0015 - Movement - (16.98 SQM)	Not Applicable	Circulation or storage space.
B00F - R9001 - Communal Space - (85.45 SQM)	Student Space (39)	
B00G - R0004 - Movement - (15.01 SQM)	Not Applicable	Circulation or storage space.
B00G - R0005 - Movement - (18.84 SQM)	Not Applicable	Circulation or storage space.
B00G - R0006 - Movement - (18.6 SQM)	Not Applicable	Circulation or storage space.
B00G - R0007 - Movement - (15 SQM)	Not Applicable	Circulation or storage space.
B00H - R0001 - Movement - (15.9 SQM)	Not Applicable	Circulation or storage space.
B00H - R0002 - Movement - (17.09 SQM)	Not Applicable	Circulation or storage space.
B00H - R0005 - Movement - (15.53 SQM)	Not Applicable	Circulation or storage space.
B00H - R0006 - Movement - (16.93 SQM)	Not Applicable	Circulation or storage space.
B00I - R0002 - Canteen - (18.68 SQM)	Not Applicable	Circulation or storage space.
B00K - R0002 - Communal Space - (143.78 SQM)	Student Space (66)	
B00K - R0003 - Movement - (5.59 SQM)	Not Applicable	Circulation or storage space.
B00K - R0004 - Raised Platform - (62.19 SQM)	Not Applicable	Circulation or storage space.
B00K - R0006 - Movement - (13.44 SQM)	Not Applicable	Circulation or storage space.
OS 520 15263 - OS 520 15263 - Staff Study - (57 SQM)	Office (14)	
OS 602 19515 - OS 602 19515 - Learning Unit - Standard With P.A.A. - (76 SQM)	Student Space (35)	

Entity Location	Audit Condition Classification (Capacity)	Comment
OS 606 19101 - OS 606 19101 - Learning Unit - Standard With P.A.A A/C - (76 SQM)	● Student Space (35)	
OS 606 19657 - OS 606 19657 - Learning Unit - Standard With P.A.A A/C - (76 SQM)	● Student Space (35)	