

VENTILATION AUDIT REPORT

SCHOOL:	Cessnock High School (8108)
AMU REGION:	Hunter/Central Coast
STATE ELECTORATE:	Cessnock
LOCAL GOVERNMENT AREA:	Cessnock

8108 - Cessnock High School
Site Plan (13465)

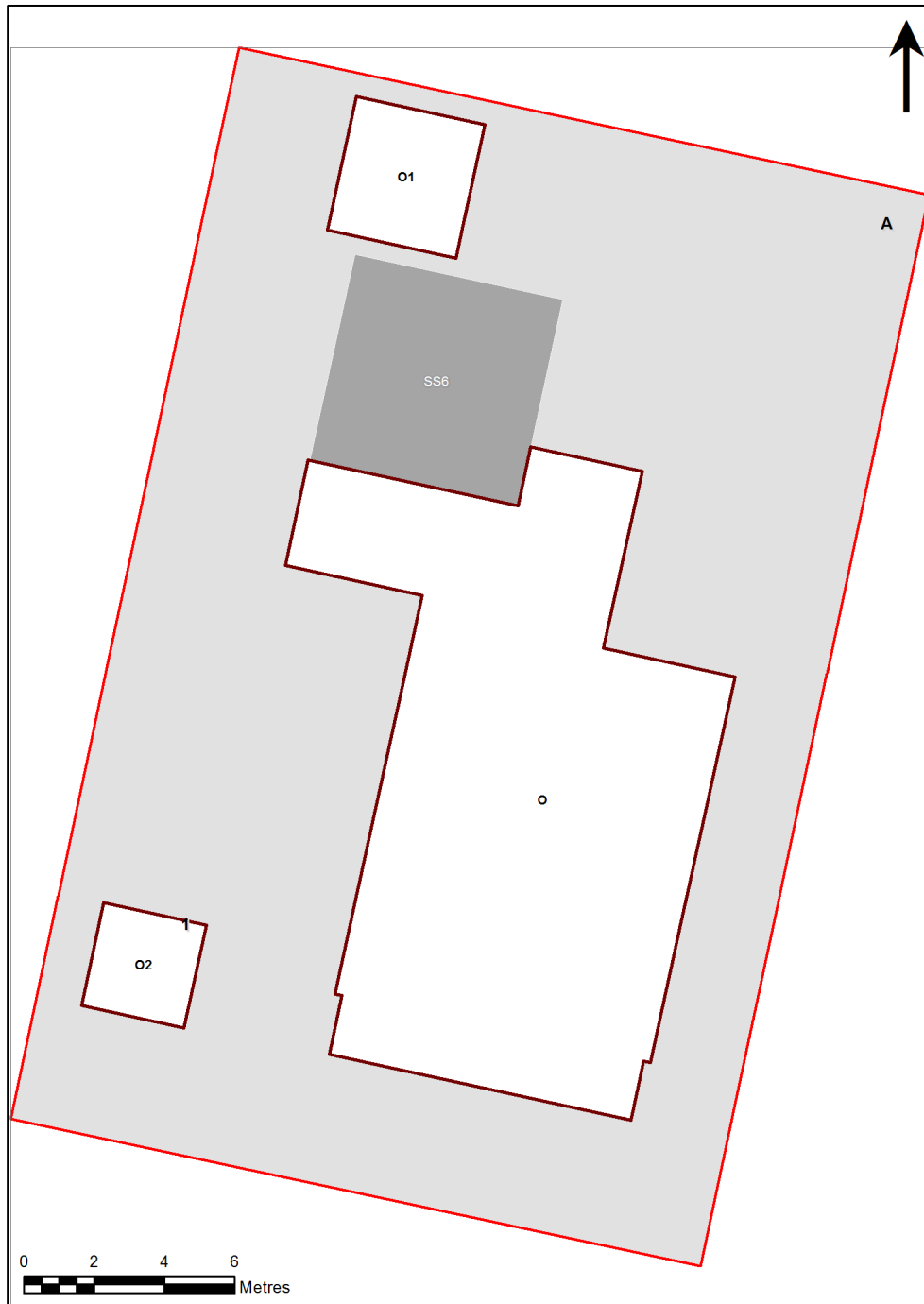

1:135

Printed: 28-Jun-2021



Ventilation Audit Key

Category	Description
	Category A Operate this space in line with COVID safe school operations . It has the required level of natural ventilation. NB. Circulation and storage areas should not be used for groups or gatherings.
	Category B This space should be occupied at 1 person per 4m ² to comply with COVID safe school operations and the guided use of spaces . The report details the number of people who can be accommodated safely in each of the identified spaces.

Entity Location	Audit Condition Classification (Capacity)	Comment
B00A - R0007 - General Learning Space - (53.64 SQM) - Teaching Space: 1	● Student Space (24)	
B00A - R0008 - General Learning Space - (54.76 SQM) - Teaching Space: 1	● Student Space (25)	
B00A - R0009 - Preparation - (16.41 SQM)	Not Applicable	Circulation or storage space.
B00A - R0011 - General Learning Space - (53.09 SQM) - Teaching Space: 1	● Student Space (24)	
B00A - R0012 - General Learning Space - (53.08 SQM) - Teaching Space: 1	● Student Space (24)	
B00A - R0022 - Staff Study - (36.83 SQM)	○ Office (9)	
B00A - R0023 - General Assistants - (8.1 SQM)	○ Office (2)	
B00A - R0026 - Movement - (43.97 SQM)	Not Applicable	Circulation or storage space.
B00A - R0027 - Movement - (120.63 SQM)	Not Applicable	Circulation or storage space.
B00A - R0028 - Movement - (5.12 SQM)	Not Applicable	Circulation or storage space.
B00A - R0040 - Administration - Clerical - (14.87 SQM)	○ Office (3)	
B00A - R0042 - Interview/Office - Type 1 - (14.9 SQM)	○ Office (3)	
B00A - R0049 - General Learning Space - (43.6 SQM) - Teaching Space: 1	● Student Space (20)	
B00A - R0050 - Music Learning Space - (54.21 SQM) - Teaching Space: 1	● Student Space (25)	
B00A - R0051 - Music Learning Space - (54.22 SQM) - Teaching Space: 1	● Student Space (25)	
B00A - R0053 - Movement - (5.24 SQM)	Not Applicable	Circulation or storage space.
B00A - R0057 - Leading Teacher - (11.98 SQM)	○ Office (2)	
B00A - R0058 - Administration - Clerical - (5.4 SQM)	○ Office (1)	
B00A - R0059 - Movement - (32.57 SQM)	Not Applicable	Circulation or storage space.
B00A - R0061 - Duplicating Workroom - (31.78 SQM)	○ Office (7)	
B00A - R0063 - Clinic - Girls - (11.31 SQM)	○ Office (2)	
B00A - R0064 - Clinic - Boys - (10.96 SQM)	○ Office (2)	
B00A - R0065 - Principal Office - (19.92 SQM)	○ Office (4)	
B00A - R0067 - Staff Study - (16.08 SQM)	○ Office (4)	
B00A - R0068 - General Learning Space - (44.83 SQM) - Teaching Space: 1	● Student Space (20)	
B00A - R0069 - Science Laboratory - (51.98 SQM)	● Student Space (24)	
B00A - R0071 - Movement - (25.64 SQM)	Not Applicable	Circulation or storage space.
B00A - R0077 - Movement - (12.26 SQM)	Not Applicable	Circulation or storage space.
B00A - R0078 - Movement - (92.47 SQM)	Not Applicable	Circulation or storage space.
B00A - R0079 - Interview/Meeting - (43.18 SQM)	○ Office (10)	
B00A - R0080 - Staff Lounge - (77.77 SQM)	○ Office (19)	
B00A - R0081 - Staff Kitchen - (9.71 SQM)	○ Office (2)	
B00A - R0082 - Principal Office - (30.97 SQM)	○ Office (7)	
B00A - R0083 - Administration - Clerical - (55.11 SQM)	○ Office (13)	
B00A - R1002 - Staff Study - (31.03 SQM)	○ Office (7)	
B00A - R1003 - Staff Study - (5.73 SQM)	○ Office (1)	
B00A - R1004 - Movement - (15.88 SQM)	Not Applicable	Circulation or storage space.
B00A - R1005 - Computer Learning Space - (55.04 SQM) - Teaching Space: 1	● Student Space (25)	
B00A - R1007 - General Learning Space - (55.05 SQM) - Teaching Space: 1	● Student Space (25)	
B00A - R1008 - General Learning Space - (55.34 SQM) - Teaching Space: 1	● Student Space (25)	
B00A - R1009 - Preparation - (17.04 SQM)	Not Applicable	Circulation or storage space.
B00A - R1010 - Laboratory L.S. - (99.18 SQM) - Teaching Space: 1	● Student Space (46)	
B00A - R1011 - Preparation - (17.04 SQM)	Not Applicable	Circulation or storage space.
B00A - R1017 - General Learning Space - (55.01 SQM) - Teaching Space: 1	● Student Space (25)	
B00A - R1018 - General Learning Space - (55.03 SQM) - Teaching Space: 1	● Student Space (25)	
B00A - R1019 - General Learning Space - (44.78 SQM) - Teaching Space: 1	● Student Space (20)	
B00A - R1021 - Staff Study - (16.59 SQM)	○ Office (4)	
B00A - R1023 - General Learning Space - (44.42 SQM) - Teaching Space: 1	● Student Space (20)	

Entity Location	Audit Condition Classification (Capacity)	Comment
B00A - R1024 - General Learning Space - (55 SQM) - Teaching Space: 1	● Student Space (25)	
B00A - R1025 - Science Laboratory - (47.02 SQM)	● Student Space (21)	
B00A - R1026 - General Learning Space - (49.25 SQM) - Teaching Space: 1	● Student Space (22)	
B00A - R1030 - Movement - (231.09 SQM)	Not Applicable	Circulation or storage space.
B00A - R1032 - Staff Study - (16 SQM)	● Office (4)	
B00A - R1033 - Deputy Principal Office - (11.76 SQM)	● Office (2)	
B00A - R1034 - Staff Lounge - (20.58 SQM)	● Office (5)	
B00A - R9005 - Movement - (48.27 SQM)	Not Applicable	Circulation or storage space.
B00A - R9009 - Movement - (17.86 SQM)	Not Applicable	Circulation or storage space.
B00B - M0003 - Seminar - (10.04 SQM)	● Office (2)	
B00B - M0010 - Movement - (17.24 SQM)	Not Applicable	Circulation or storage space.
B00B - M0011 - Main Area - (261.26 SQM)	Not Applicable	Circulation or storage space.
B00B - R0001 - Movement - (40.51 SQM)	Not Applicable	Circulation or storage space.
B00B - R0005 - Main Area - (184.85 SQM)	Not Applicable	Circulation or storage space.
B00B - R0006 - Seminar - (17.9 SQM)	● Office (4)	
B00B - R0007 - Seminar - (18.12 SQM)	● Office (4)	
B00B - R0008 - Audio Visual Workroom - (46.3 SQM)	● Student Space (21)	
B00B - R0009 - Workroom - (48.43 SQM)	● Office (12)	
B00B - R0011 - Movement - (18.2 SQM)	Not Applicable	Circulation or storage space.
B00C - R0006 - Laboratory L.S. - (86.14 SQM) - Teaching Space: 1	● Student Space (39)	
B00C - R0007 - Preparation - (28.21 SQM)	Not Applicable	Circulation or storage space.
B00C - R0015 - Art Learning Space - (60.12 SQM) - Teaching Space: 1	● Student Space (27)	
B00C - R0018 - Art Learning Space - (53.4 SQM) - Teaching Space: 1	● Student Space (24)	
B00C - R0019 - Staff Study - (26.04 SQM)	● Office (6)	
B00C - R0029 - General Learning Space - (39.23 SQM) - Teaching Space: 1	● Student Space (18)	
B00C - R0030 - Staff Kitchen - (20.8 SQM)	● Office (5)	
B00C - R0031 - Movement - (10.19 SQM)	Not Applicable	Circulation or storage space.
B00C - R0032 - Movement - (92.66 SQM)	Not Applicable	Circulation or storage space.
B00C - R0034 - General Learning Space - (87.82 SQM) - Teaching Space: 1	● Student Space (40)	
B00C - R1001 - Darkroom Space - (26.59 SQM)	● Office (6)	
B00C - R1002 - General Learning Space - (52.46 SQM) - Teaching Space: 1	● Student Space (24)	
B00C - R1003 - Staff Study - (26.01 SQM)	● Office (6)	
B00C - R1008 - General Learning Space - (52.45 SQM) - Teaching Space: 1	● Student Space (24)	
B00C - R1009 - General Learning Space - (66.13 SQM) - Teaching Space: 1	● Student Space (30)	
B00C - R1011 - General Learning Space - (66.12 SQM) - Teaching Space: 1	● Student Space (30)	
B00C - R1014 - Computer Learning Space - (66.45 SQM) - Teaching Space: 1	● Student Space (30)	
B00C - R1015 - Laboratory L.S. - (66.6 SQM) - Teaching Space: 1	● Student Space (30)	
B00C - R1018 - General Learning Space - (39.34 SQM) - Teaching Space: 1	● Student Space (18)	
B00C - R1019 - Staff Study - (13.19 SQM)	● Office (3)	
B00C - R1020 - Staff Study - (12.93 SQM)	● Office (3)	
B00C - R1025 - Movement - (160.23 SQM)	Not Applicable	Circulation or storage space.
B00C - R1026 - General Learning Space - (39.85 SQM) - Teaching Space: 1	● Student Space (18)	
B00C - R1027 - Science Laboratory - (46.16 SQM)	● Student Space (21)	
B00C - R1028 - Preparation - Science - (33.14 SQM)	Not Applicable	Circulation or storage space.
B00D - R0010 - Design/Technology L.S. - (47.86 SQM) - Teaching Space: 1	● Student Space (22)	
B00D - R0012 - Movement - (5.8 SQM)	Not Applicable	Circulation or storage space.
B00D - R0013 - Staff Study - (8.92 SQM)	● Office (2)	
B00D - R0017 - Staff Study - (24.15 SQM)	● Office (6)	
B00D - R0022 - Movement - (10.26 SQM)	Not Applicable	Circulation or storage space.

Entity Location	Audit Condition Classification (Capacity)	Comment
B00D - R0031 - Food Technology L.S. - (84.16 SQM) - Teaching Space: 1	● Student Space (39)	
B00D - R0032 - Interview/Office - Type 1 - (32.48 SQM)	● Office (8)	
B00D - R0036 - Movement - (92.61 SQM)	Not Applicable	Circulation or storage space.
B00D - R0038 - Preparation - (25.19 SQM)	Not Applicable	Circulation or storage space.
B00D - R0041 - Kitchen - Type 1 - (117.62 SQM)	● Student Space (54)	
B00D - R0042 - Preparation - (12.05 SQM)	Not Applicable	Circulation or storage space.
B00D - R0043 - Staff Study - (26.9 SQM)	● Office (6)	
B00D - R1004 - Materials Technology L.S. - (67.52 SQM) - Teaching Space: 1	● Student Space (31)	
B00D - R1005 - Performance Workspace - (67.15 SQM) - Teaching Space: 1	● Student Space (31)	
B00D - R1009 - General Learning Space - (47.62 SQM) - Teaching Space: 1	● Student Space (22)	
B00D - R1010 - Staff Study - (8.15 SQM)	● Office (2)	
B00D - R1011 - Staff Study - (7.14 SQM)	● Office (1)	
B00D - R1016 - Movement - (95.58 SQM)	Not Applicable	Circulation or storage space.
B00E - R0001 - Staff Study - (20.66 SQM)	● Office (5)	
B00E - R0004 - Computer Learning Space - (52.69 SQM) - Teaching Space: 1	● Student Space (24)	
B00E - R0005 - Materials Technology L.S. - (77.35 SQM) - Teaching Space: 1	● Student Space (35)	
B00E - R0007 - Staff Study - (7.71 SQM)	● Office (1)	
B00E - R0008 - Materials Technology L.S. - (105.01 SQM) - Teaching Space: 1	● Student Space (48)	
B00E - R0009 - Staff Study - (7.87 SQM)	● Office (1)	
B00E - R0012 - Design L.S. - (85.04 SQM) - Teaching Space: 1	● Student Space (39)	
B00E - R0016 - Design L.S. - (75.73 SQM) - Teaching Space: 1	● Student Space (35)	
B00E - R0017 - Staff Study - (7.51 SQM)	● Office (1)	
B00E - R0019 - Materials Technology L.S. - (104.27 SQM) - Teaching Space: 1	● Student Space (48)	
B00E - R0021 - Staff Study - (7.84 SQM)	● Office (1)	
B00E - R0022 - Materials Technology L.S. - (105.14 SQM) - Teaching Space: 1	● Student Space (48)	
B00E - R0024 - Movement - (113.97 SQM)	Not Applicable	Circulation or storage space.
B00E - R0034 - Staff Study - (16.2 SQM)	● Office (4)	
B00F - R0006 - Staff Study - (9.74 SQM)	● Office (2)	
B00F - R0007 - Staff Study - (20.96 SQM)	● Office (5)	
B00F - R0008 - Movement - (9.41 SQM)	Not Applicable	Circulation or storage space.
B00F - R0009 - General Learning Space - (48.91 SQM) - Teaching Space: 1	● Student Space (22)	
B00F - R0010 - General Learning Space - (49.04 SQM) - Teaching Space: 1	● Student Space (22)	
B00F - R0011 - General Learning Space - (48.91 SQM) - Teaching Space: 1	● Student Space (22)	
B00F - R0013 - Movement - (92.12 SQM)	Not Applicable	Circulation or storage space.
B00F - R0016 - Movement - (6.41 SQM)	Not Applicable	Circulation or storage space.
B00F - R1001 - Staff Kitchen - (6.69 SQM)	● Office (1)	
B00F - R1004 - Staff Study - (8.29 SQM)	● Office (2)	
B00F - R1009 - General Learning Space - (48.67 SQM) - Teaching Space: 1	● Student Space (22)	
B00F - R1010 - General Learning Space - (48.48 SQM) - Teaching Space: 1	● Student Space (22)	
B00F - R1011 - General Learning Space - (48.47 SQM) - Teaching Space: 1	● Student Space (22)	
B00F - R1013 - Movement - (84.69 SQM)	Not Applicable	Circulation or storage space.
B00F - R1016 - Computer Learning Space - (38.68 SQM) - Teaching Space: 1	● Student Space (17)	
B00G - R0003 - Kitchen - Type 2 - (7.67 SQM)	● Student Space (3)	
B00G - R0004 - Movement - (13.91 SQM)	Not Applicable	Circulation or storage space.
B00G - R0005 - Practical Activities - (39.37 SQM)	● Student Space (18)	
B00G - R0006 - General Learning Space - (78.64 SQM) - Teaching Space: 1	● Student Space (36)	
B00G - R0007 - Practical Activities - (15.28 SQM)	● Student Space (7)	
B00H - R0001 - Multi-Purpose Space - (641.48 SQM)	● Student Space (297)	

Entity Location	Audit Condition Classification (Capacity)	Comment
B00H - R0002 - Stage - (111.55 SQM)	Not Applicable	Circulation or storage space.
B00H - R0008 - Student Canteen - (60.89 SQM)	Not Applicable	Circulation or storage space.
B00H - R0019 - Movement - (8.3 SQM)	Not Applicable	Circulation or storage space.
B00H - R0025 - Staff Study - (46.52 SQM)	 Office (11)	
B00I - R0001 - General Learning Space - (44.2 SQM) - Teaching Space: 1	 Student Space (20)	
B00I - R0002 - Movement - (9.4 SQM)	Not Applicable	Circulation or storage space.