

VENTILATION AUDIT REPORT

SCHOOL:	Camdenville Public School (1483)
AMU REGION:	Sydney
STATE ELECTORATE:	Newtown
LOCAL GOVERNMENT AREA:	Inner West

1483 - Camdenville Public School
Site Plan (12277)

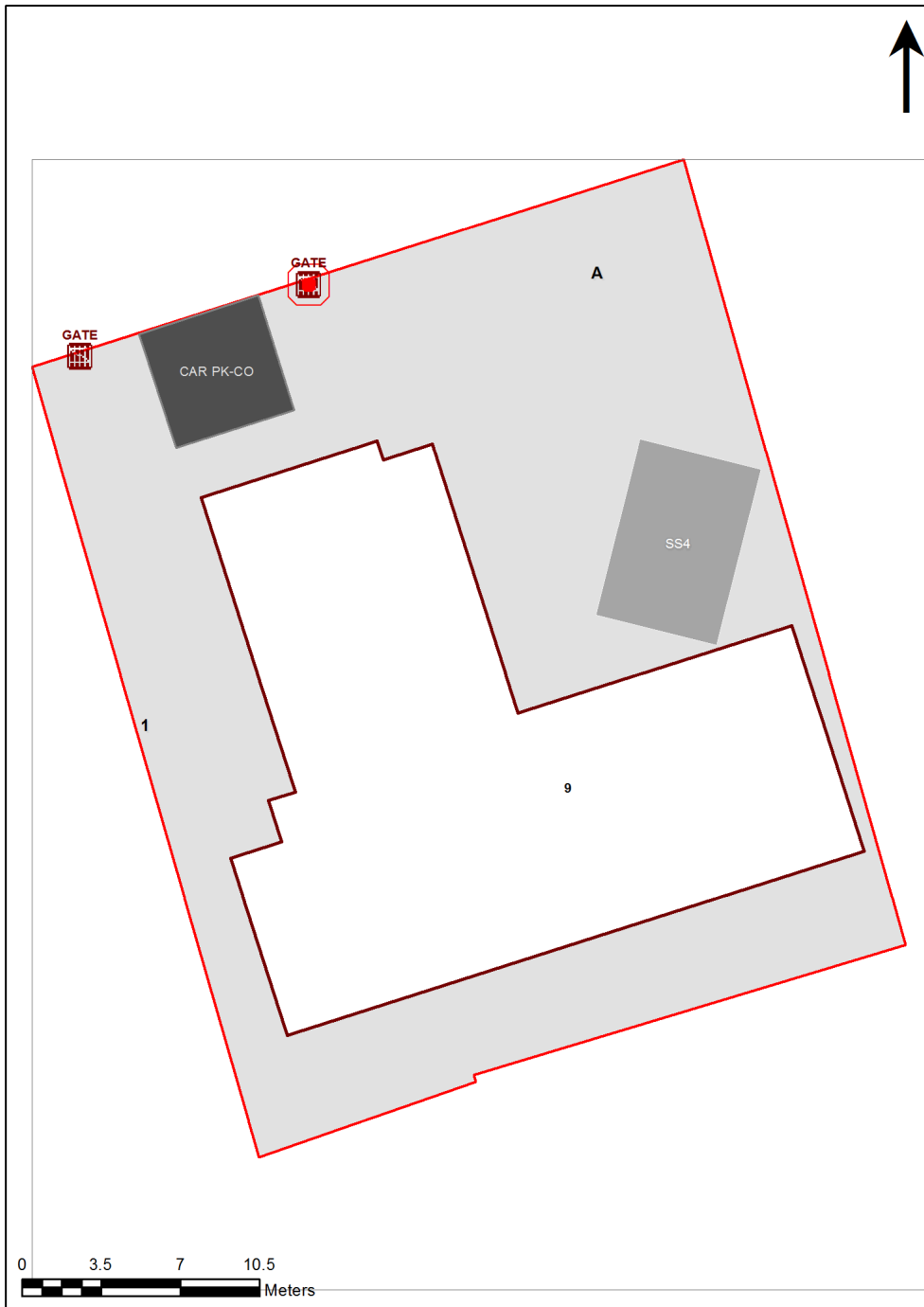

1:210

Printed: 20-Mar-2020

Ventilation Audit Key

Category	Description
	Category A Operate this space in line with COVID safe school operations . It has the required level of natural ventilation. NB. Circulation and storage areas should not be used for groups or gatherings.
	Category B This space should be occupied at 1 person per 4m ² to comply with COVID safe school operations and the guided use of spaces . The report details the number of people who can be accommodated safely in each of the identified spaces.

Entity Location	Audit Condition Classification (Capacity)	Comment
B001 - R0001 - Home Base - (95.85 SQM) - Teaching Space: 1	● Student Space (44)	
B001 - R0002 - Movement - (12.52 SQM)	Not Applicable	Circulation or storage space.
B001 - R0003 - Movement - (8.26 SQM)	Not Applicable	Circulation or storage space.
B001 - R0006 - Home Base - (64.67 SQM) - Teaching Space: 1	● Student Space (30)	
B001 - R0007 - Special Programs Room - (64.81 SQM)	● Student Space (30)	
B001 - R0011 - Movement - (5.99 SQM)	Not Applicable	Circulation or storage space.
B001 - R0012 - Practical Activities - 1hb - (35.92 SQM)	● Student Space (16)	
B001 - R0013 - Movement - (40.1 SQM)	Not Applicable	Circulation or storage space.
B001 - R0014 - Movement - (40.05 SQM)	Not Applicable	Circulation or storage space.
B001 - R1001 - Practical Activities - 1hb - (36.05 SQM)	● Student Space (16)	
B001 - R1002 - Movement - (21.25 SQM)	Not Applicable	Circulation or storage space.
B001 - R1003 - Home Base - (65.05 SQM) - Teaching Space: 1	● Student Space (30)	
B001 - R1004 - Home Base - (65.05 SQM) - Teaching Space: 1	● Student Space (30)	
B001 - R1007 - Home Base - (95.8 SQM) - Teaching Space: 1	● Student Space (44)	
B002 - R0011 - Movement - (48.08 SQM)	Not Applicable	Circulation or storage space.
B002 - R0015 - Communal Space - (110 SQM)	● Student Space (51)	
B002 - R0016 - Movement - (9.5 SQM)	Not Applicable	Circulation or storage space.
B002 - R0017 - Raised Platform - (25.01 SQM)	Not Applicable	Circulation or storage space.
B002 - R1015 - Movement - (5.14 SQM)	Not Applicable	Circulation or storage space.
B003 - R0002 - Home Base - (79.29 SQM) - Teaching Space: 1	● Student Space (36)	
B003 - R0004 - Practical Activities - 1hb - (51.55 SQM)	● Student Space (23)	
B003 - R0008 - Home Base - (50.29 SQM) - Teaching Space: 1	● Student Space (23)	
B003 - R0009 - Home Base - (62.55 SQM) - Teaching Space: 1	● Student Space (29)	
B003 - R0014 - Home Base - (35.98 SQM) - Teaching Space: 1	● Student Space (16)	
B003 - R0015 - Home Base - (35.19 SQM) - Teaching Space: 1	● Student Space (16)	
B005 - R0001 - Interview - (15.6 SQM)	○ Office (3)	
B005 - R0007 - Staff Room Annexe - (37.84 SQM)	○ Office (9)	
B005 - R0008 - Movement - (8.92 SQM)	Not Applicable	Circulation or storage space.
B005 - R0011 - Staff Room - (68.33 SQM)	○ Office (17)	
B005 - R0017 - Canteen - (28.33 SQM)	Not Applicable	Circulation or storage space.
B005 - R0019 - Seminar/Study - (38.59 SQM)	○ Office (9)	
B005 - R0020 - Reading Area - (113.46 SQM)	● Student Space (52)	
B005 - R0021 - Movement - (7.4 SQM)	Not Applicable	Circulation or storage space.
B005 - R0024 - Duplicating Workroom - (13.49 SQM)	○ Office (3)	
B005 - R0025 - Duplicating Workroom - (6 SQM)	○ Office (1)	
B005 - R0026 - Sick Bay - (8.76 SQM)	● Student Space (4)	
B005 - R0027 - Clerical Office - (25.88 SQM)	○ Office (6)	
B005 - R0029 - Movement - (22.17 SQM)	Not Applicable	Circulation or storage space.
B005 - R0030 - Movement - (16.38 SQM)	Not Applicable	Circulation or storage space.
B005 - R0032 - Principal - (17.07 SQM)	○ Office (4)	
B005 - R0035 - Deputy Principal - (12.99 SQM)	○ Office (3)	
B005 - R0036 - Movement - (14.99 SQM)	Not Applicable	Circulation or storage space.
B005 - R0037 - Interview - (7.96 SQM)	○ Office (1)	
B005 - R0038 - Movement - (20.81 SQM)	Not Applicable	Circulation or storage space.
B006 - R0001 - Home Base - (94.53 SQM) - Teaching Space: 1	● Student Space (43)	
B006 - R0006 - Movement - (8.19 SQM)	Not Applicable	Circulation or storage space.
B006 - R0007 - Home Base - (95.02 SQM) - Teaching Space: 1	● Student Space (44)	
B006 - R1001 - Home Base - (57.35 SQM) - Teaching Space: 1	● Student Space (26)	
B006 - R1008 - Home Base - (57.35 SQM) - Teaching Space: 1	● Student Space (26)	

Entity Location	Audit Condition Classification (Capacity)	Comment
B006 - R1009 - Home Base - (57.22 SQM) - Teaching Space: 1	● Student Space (26)	
B006 - R1012 - Movement - (20.61 SQM)	Not Applicable	Circulation or storage space.
B006 - R1015 - Home Base - (57.21 SQM) - Teaching Space: 1	● Student Space (26)	
B009 - R0004 - Home Base - Pre - (68.19 SQM) - Teaching Space: 1	● Student Space (31)	
B009 - R0005 - Movement - (50.55 SQM)	Not Applicable	Circulation or storage space.
B009 - R0006 - Movement - (15.85 SQM)	Not Applicable	Circulation or storage space.
B009 - R0010 - Home Base - Pre - (68.11 SQM) - Teaching Space: 1	● Student Space (31)	
B009 - R0015 - Movement - (35.83 SQM)	Not Applicable	Circulation or storage space.
B009 - R0016 - Practical Activities - Pre - (21.62 SQM)	● Student Space (10)	