

# VENTILATION AUDIT REPORT

<b>SCHOOL:</b>	<b>Bullimbal School (5569)</b>
<b>AMU REGION:</b>	<b>North Western NSW</b>
<b>STATE ELECTORATE:</b>	<b>Tamworth</b>
<b>LOCAL GOVERNMENT AREA:</b>	<b>Tamworth</b>

5569 - Bullimbal School  
Site Plan (12614)

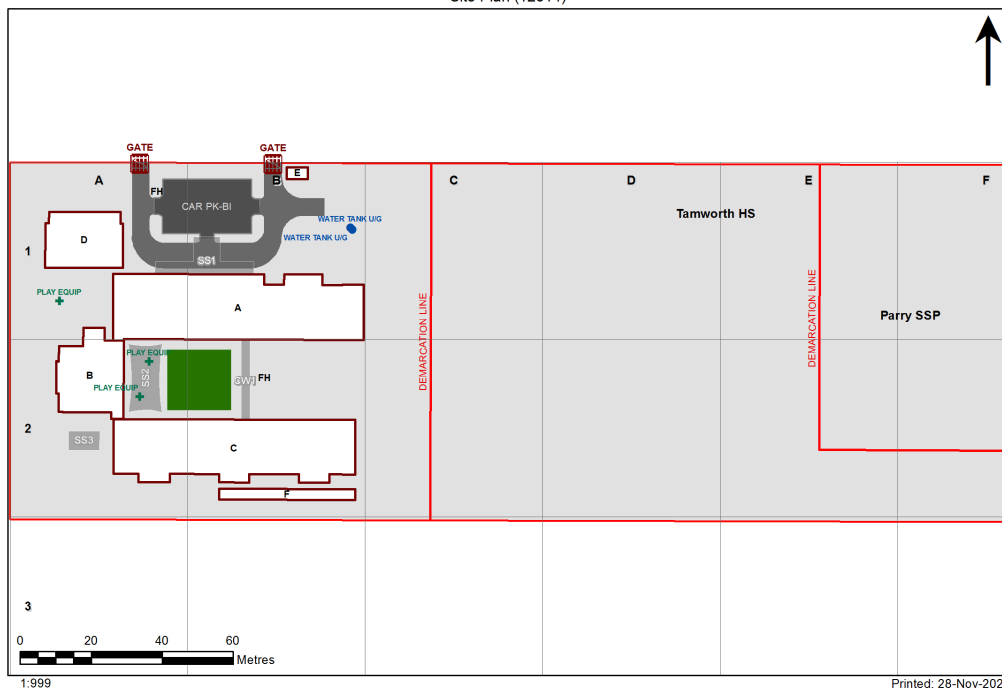

1:999

Printed: 28-Nov-2020

## Ventilation Audit Key

Category	Description
	Category A Operate this space in line with <a href="#">COVID safe school operations</a> . It has the required level of natural ventilation. NB. Circulation and storage areas should not be used for groups or gatherings.
	Category B This space should be occupied at 1 person per 4m <sup>2</sup> to comply with <a href="#">COVID safe school operations and the guided use of spaces</a> . The report details the number of people who can be accommodated safely in each of the identified spaces.

Entity Location	Audit Condition Classification (Capacity)	Comment
B00A - R0002 - Entry Vestibule - (18.49 SQM)	Not Applicable	Circulation or storage space.
B00A - R0003 - Interview - (13.04 SQM)	Office (3)	
B00A - R0004 - Movement - (42.71 SQM)	Not Applicable	Circulation or storage space.
B00A - R0005 - Principal - (16.91 SQM)	Office (4)	
B00A - R0006 - Deputy Principal - (16.87 SQM)	Office (4)	
B00A - R0009 - Staff Kitchen - (13.46 SQM)	Office (3)	
B00A - R0010 - Staff Room - (34.15 SQM)	Office (8)	
B00A - R0011 - Staff Room Annexe - (18.93 SQM)	Office (4)	
B00A - R0016 - Sick Bay - (6.16 SQM)	Student Space (2)	
B00A - R0017 - Clerical/Printing - (23.63 SQM)	Not Applicable	Circulation or storage space.
B00A - R0018 - Clerical/Printing - (8.83 SQM)	Not Applicable	Circulation or storage space.
B00A - R0020 - Reading Area - (70.63 SQM)	Student Space (32)	
B00A - R0030 - Withdrawal Space - 1hb - (9.53 SQM)	Student Space (4)	
B00A - R0032 - Home Base - (58.69 SQM) - Teaching Space: 1	Student Space (27)	
B00A - R0038 - Home Base - (58.54 SQM) - Teaching Space: 1	Student Space (27)	
B00A - R0040 - Withdrawal Space - 1hb - (9.56 SQM)	Student Space (4)	
B00A - R0043 - Practical Activities - 1hb - (22.62 SQM)	Student Space (10)	
B00A - R0044 - Practical Activities - 1hb - (22.67 SQM)	Student Space (10)	
B00A - R0045 - Special Programs Room - (70.54 SQM)	Student Space (32)	
B00B - R0004 - Staff Kitchen - (20.27 SQM)	Office (5)	
B00B - R0005 - Special Programs Room - (36.86 SQM)	Student Space (17)	
B00B - R0007 - Special Programs Room - Type 2 - (60.8 SQM)	Student Space (28)	
B00C - R0002 - Practical Activities - (22.54 SQM)	Student Space (10)	
B00C - R0003 - Home Base - (58.53 SQM) - Teaching Space: 1	Student Space (27)	
B00C - R0005 - Withdrawal Space - 1hb - (9.59 SQM)	Student Space (4)	
B00C - R0013 - Home Base - (58.53 SQM) - Teaching Space: 1	Student Space (27)	
B00C - R0014 - Practical Activities - 1hb - (22.56 SQM)	Student Space (10)	
B00C - R0015 - Withdrawal Space - 1hb - (9.56 SQM)	Student Space (4)	
B00C - R0020 - Withdrawal Space - 1hb - (9.59 SQM)	Student Space (4)	
B00C - R0022 - Home Base - (58.53 SQM) - Teaching Space: 1	Student Space (27)	
B00C - R0023 - Practical Activities - 1hb - (22.57 SQM)	Student Space (10)	
B00C - R0026 - Home Base - (58.45 SQM) - Teaching Space: 1	Student Space (27)	
B00C - R0028 - Withdrawal Space - 1hb - (9.59 SQM)	Student Space (4)	
B00C - R0031 - Practical Activities - 1hb - (22.53 SQM)	Student Space (10)	
B00C - R0034 - Withdrawal Space - 1hb - (9.56 SQM)	Student Space (4)	
B00C - R0035 - Practical Activities - (22.56 SQM)	Student Space (10)	
B00C - R0036 - Home Base - (58.53 SQM) - Teaching Space: 1	Student Space (27)	
B00C - R0041 - Withdrawal Space - 1hb - (9.63 SQM)	Student Space (4)	
B00C - R0044 - Home Base - (58.53 SQM) - Teaching Space: 1	Student Space (27)	
B00C - R0045 - Practical Activities - 1hb - (22.56 SQM)	Student Space (10)	
B00D - R0003 - Movement - (15.7 SQM)	Not Applicable	Circulation or storage space.
B00D - R0004 - Hydrotherapy - Pool - (180.13 SQM)	Not Applicable	Circulation or storage space.