

VENTILATION AUDIT REPORT

SCHOOL:	Bonalbo Central School (1290)
AMU REGION:	North Coast
STATE ELECTORATE:	Lismore
LOCAL GOVERNMENT AREA:	Kyogle

1290 - Bonalbo Central School
Site Plan (12354)

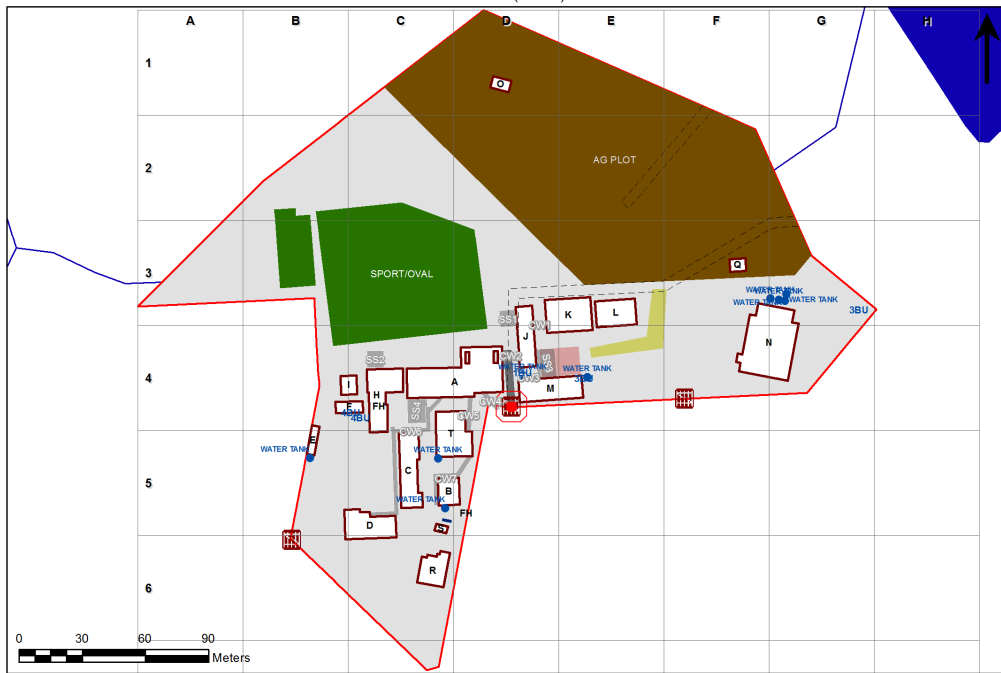

1:1,687

Printed: 20-Mar-2020

Ventilation Audit Key

Category	Description
	Category A Operate this space in line with COVID safe school operations . It has the required level of natural ventilation. NB. Circulation and storage areas should not be used for groups or gatherings.
	Category B This space should be occupied at 1 person per 4m ² to comply with COVID safe school operations and the guided use of spaces . The report details the number of people who can be accommodated safely in each of the identified spaces.

Entity Location	Audit Condition Classification (Capacity)	Comment
B00A - R0017 - Laboratory L.S. - (91.87 SQM) - Teaching Space: 1	● Student Space (42)	
B00A - R0026 - Movement - (34.53 SQM)	Not Applicable	Circulation or storage space.
B00A - R0027 - Clerical Office - (28.87 SQM)	● Office (7)	
B00A - R0028 - Duplicating Workroom - (15.44 SQM)	● Office (3)	
B00A - R0032 - Principal - (20.75 SQM)	● Office (5)	
B00A - R0033 - Deputy Principal - (17.97 SQM)	● Office (4)	
B00A - R0034 - Interview - (12.86 SQM)	● Office (3)	
B00A - R0038 - General Learning Space - (90.31 SQM) - Teaching Space: 1	● Student Space (41)	
B00A - R0039 - General Learning Space - (49.14 SQM) - Teaching Space: 1	● Student Space (22)	
B00A - R1002 - Staff Room Annexe - (33.45 SQM)	● Office (8)	
B00A - R1003 - Staff Room - (54.25 SQM)	● Office (13)	
B00A - R1011 - Reading Area - (162.87 SQM)	● Student Space (75)	
B00A - R1013 - Seminar/Study - (21.9 SQM)	● Office (5)	
B00B - R0004 - Music Learning Space - (71.38 SQM) - Teaching Space: 1	● Student Space (33)	
B00B - R0005 - Practice/Seminar - (24.38 SQM)	Not Applicable	Circulation or storage space.
B00C - R0001 - Staff Room Annexe - (14.37 SQM)	● Office (3)	
B00C - R0002 - Movement - (5.87 SQM)	Not Applicable	Circulation or storage space.
B00C - R0003 - Staff Room Annexe - (10.69 SQM)	● Office (2)	
B00C - R0006 - Computer Learning Space - (50.93 SQM) - Teaching Space: 1	● Student Space (23)	
B00C - R0007 - Withdrawal Space - 1hb - (6.2 SQM)	● Student Space (2)	
B00C - R0009 - General Learning Space - (60.06 SQM) - Teaching Space: 1	● Student Space (27)	
B00C - R0012 - General Learning Space - (47.95 SQM) - Teaching Space: 1	● Student Space (22)	
B00C - R0013 - Interview - (9.48 SQM)	● Office (2)	
B00D - R0008 - Art Learning Space - (73.26 SQM) - Teaching Space: 1	● Student Space (33)	
B00D - R0012 - Food Technology L.S. - (129.75 SQM) - Teaching Space: 1	● Student Space (60)	
B00D - R9003 - Darkroom Space - (30.45 SQM)	● Office (7)	
B00H - R0004 - Metal Technology Bay - (141.87 SQM)	Not Applicable	Circulation or storage space.
B00H - R0006 - Wood Technology Bay - (44.83 SQM)	Not Applicable	Circulation or storage space.
B00H - R0007 - Wood Technology Bay - (88.06 SQM)	Not Applicable	Circulation or storage space.
B00J - R0011 - Canteen - (32.02 SQM)	Not Applicable	Circulation or storage space.
B00J - R0012 - Movement - (43.87 SQM)	Not Applicable	Circulation or storage space.
B00K - R0007 - Practical Activities - 1hb - (20.62 SQM)	● Student Space (9)	
B00K - R0008 - Home Base - (51.15 SQM) - Teaching Space: 1	● Student Space (23)	
B00K - R0009 - Home Base - (51.23 SQM) - Teaching Space: 1	● Student Space (23)	
B00K - R0010 - Practical Activities - 1hb - (20.62 SQM)	● Student Space (9)	
B00L - R0002 - Practical Activities - 1hb - (20.62 SQM)	● Student Space (9)	
B00L - R0003 - Home Base - (51.15 SQM) - Teaching Space: 1	● Student Space (23)	
B00L - R0004 - Home Base - (51.23 SQM) - Teaching Space: 1	● Student Space (23)	
B00L - R0005 - Practical Activities - 1hb - (20.62 SQM)	● Student Space (9)	
B00M - R0007 - Home Base - (71.66 SQM) - Teaching Space: 1	● Student Space (33)	
B00M - R0008 - Practical Activities - 1hb - (14.22 SQM)	● Student Space (6)	
B00M - R0010 - Movement - (6.44 SQM)	Not Applicable	Circulation or storage space.
B00M - R0013 - Deputy Principal - (22.38 SQM)	● Office (5)	
B00M - R0015 - Staff Room Annexe - (31.96 SQM)	● Office (7)	
B00M - R0016 - General Learning Space - (56.24 SQM) - Teaching Space: 1	● Student Space (26)	
B00N - R0003 - Communal Space - (464.96 SQM)	● Student Space (215)	

Entity Location	Audit Condition Classification (Capacity)	Comment
B00N - R0007 - Movement - (7.42 SQM)	Not Applicable	Circulation or storage space.
B00N - R0009 - Staff Room Annexe - (16.05 SQM)	Office (4)	
B00N - R0015 - Movement - (22.95 SQM)	Not Applicable	Circulation or storage space.
B00N - R0016 - Raised Platform - (46.35 SQM)	Not Applicable	Circulation or storage space.
B00N - R0018 - Movement - (17.41 SQM)	Not Applicable	Circulation or storage space.
B00O - R0001 - Movement - (46.12 SQM)	Not Applicable	Circulation or storage space.
B00R - R0001 - Movement - (35.55 SQM)	Not Applicable	Circulation or storage space.
B00R - R0002 - Staff Room Annexe - (15.23 SQM)	Office (3)	
B00R - R0004 - Interview - (15.79 SQM)	Office (3)	
B00R - R0005 - Interview - (19.91 SQM)	Office (4)	
B00R - R0006 - Interview - (15.67 SQM)	Office (3)	
B00R - R0008 - Staff Kitchen - (13.71 SQM)	Office (3)	
B00R - R0009 - Entry Vestibule - (12.71 SQM)	Not Applicable	Circulation or storage space.
B00T - R0001 - General Learning Space - Type 3 - (59.85 SQM) - Teaching Space: 1	Student Space (27)	
B00T - R0002 - Science Laboratory - (59.85 SQM)	Student Space (27)	
B00T - R0003 - Preparation - Science - (30.06 SQM)	Not Applicable	Circulation or storage space.
B00T - R0004 - Staff Room Annexe - (21 SQM)	Office (5)	
B00T - R0005 - Seminar - Type 2 - (21 SQM)	Office (5)	
B00T - R0007 - Movement - (6.14 SQM)	Not Applicable	Circulation or storage space.
B00T - R0010 - Outdoor Learning Space - Type 4 - (85.81 SQM)	Not Applicable	Circulation or storage space.