

# VENTILATION AUDIT REPORT

<b>SCHOOL:</b>	<b>Blackheath Public School (1246)</b>
<b>AMU REGION:</b>	<b>Western Sydney</b>
<b>STATE ELECTORATE:</b>	<b>Blue Mountains</b>
<b>LOCAL GOVERNMENT AREA:</b>	<b>Blue Mountains</b>

1246 - Blackheath Public School  
Site Plan (12001)

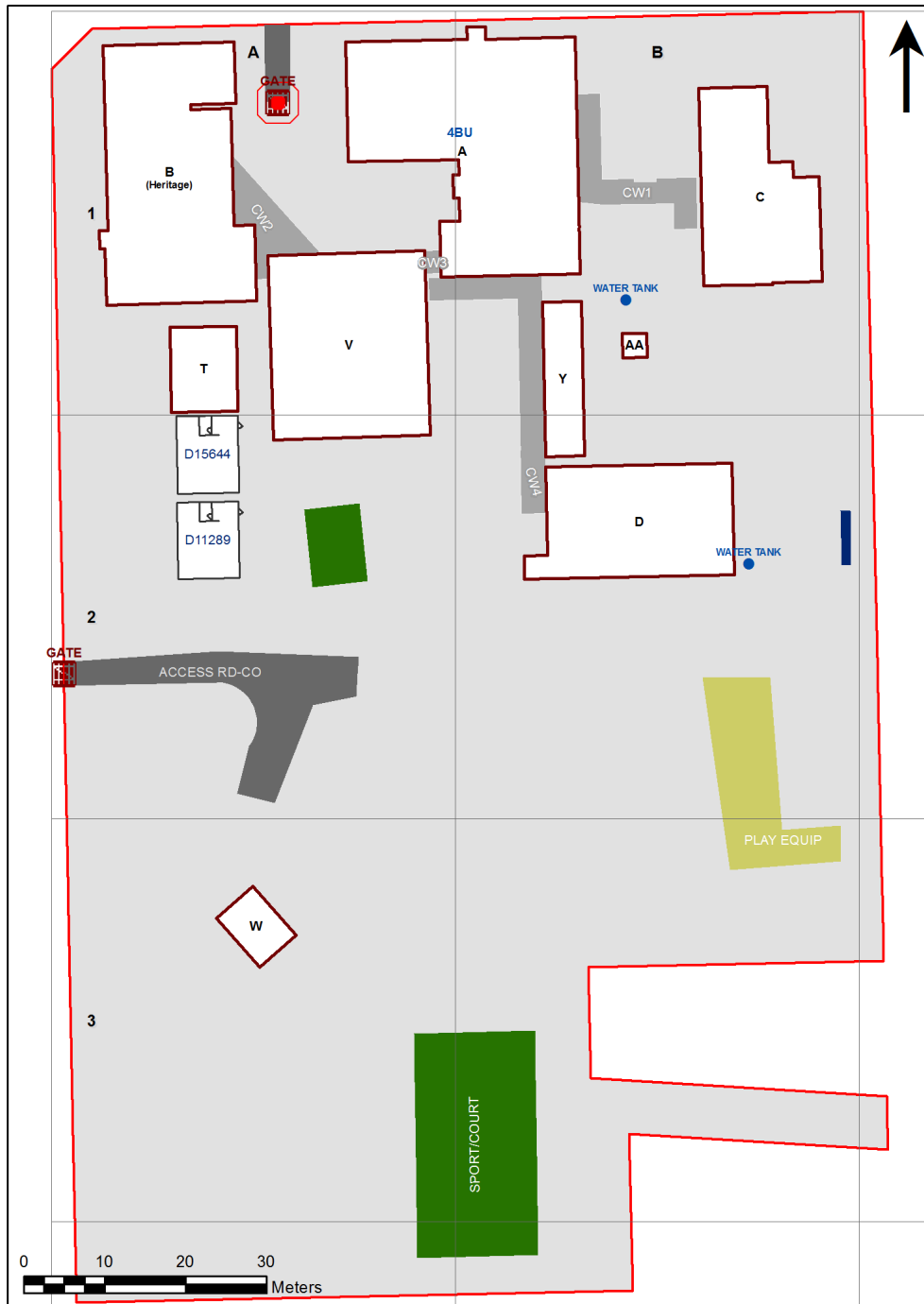





1:587

Printed: 20-Mar-2020

## Ventilation Audit Key

Category	Description
	Category A Operate this space in line with <a href="#">COVID safe school operations</a> . It has the required level of natural ventilation. NB. Circulation and storage areas should not be used for groups or gatherings.
	Category B This space should be occupied at 1 person per 4m <sup>2</sup> to comply with <a href="#">COVID safe school operations and the guided use of spaces</a> . The report details the number of people who can be accommodated safely in each of the identified spaces.

Entity Location	Audit Condition Classification (Capacity)	Comment
B00A - R0001 - Practical Activities - (18.49 SQM)	● Student Space (8)	
B00A - R0002 - Home Base - (52.76 SQM) - Teaching Space: 1	● Student Space (24)	
B00A - R0006 - Home Base - (52.76 SQM) - Teaching Space: 1	● Student Space (24)	
B00A - R0007 - Practical Activities - (18.01 SQM)	● Student Space (8)	
B00A - R0009 - Duplicating Workroom - (13.31 SQM)	● Office (3)	
B00A - R0011 - Sick Bay - (13.19 SQM)	● Student Space (6)	
B00A - R0012 - Deputy Principal - (11.59 SQM)	● Office (2)	
B00A - R0013 - Clerical Office - (12.02 SQM)	● Office (3)	
B00A - R0014 - Movement - (10.8 SQM)	Not Applicable	Circulation or storage space.
B00A - R0016 - Entry Vestibule - (19.99 SQM)	Not Applicable	Circulation or storage space.
B00A - R0018 - Principal - (15.91 SQM)	● Office (3)	
B00A - R0026 - Movement - (15.55 SQM)	Not Applicable	Circulation or storage space.
B00A - R0029 - Movement - (6.4 SQM)	Not Applicable	Circulation or storage space.
B00A - R0031 - Canteen - (38.86 SQM)	Not Applicable	Circulation or storage space.
B00A - R0032 - Movement - (102.55 SQM)	Not Applicable	Circulation or storage space.
B00A - R1001 - Practical Activities - (18 SQM)	● Student Space (8)	
B00A - R1002 - Home Base - (52.84 SQM) - Teaching Space: 1	● Student Space (24)	
B00A - R1004 - Movement - (35.27 SQM)	Not Applicable	Circulation or storage space.
B00A - R1005 - Home Base - (52.64 SQM) - Teaching Space: 1	● Student Space (24)	
B00A - R1006 - Practical Activities - (17.68 SQM)	● Student Space (8)	
B00A - R1007 - Reading Area - (145.07 SQM)	● Student Space (67)	
B00A - R1009 - Audio Visual Workroom - (9.22 SQM)	● Student Space (4)	
B00A - R1012 - Movement - (14.22 SQM)	Not Applicable	Circulation or storage space.
B00A - R1016 - Interview - (13.99 SQM)	● Office (3)	
B00A - R1017 - Reading Area - (36.96 SQM)	● Student Space (17)	
B00A - R1019 - Movement - (6.2 SQM)	Not Applicable	Circulation or storage space.
B00B - R0001 - Movement - (31.89 SQM)	Not Applicable	Circulation or storage space.
B00B - R0002 - Home Base - (47.58 SQM) - Teaching Space: 1	● Student Space (22)	
B00B - R0003 - Movement - (56.32 SQM)	Not Applicable	Circulation or storage space.
B00B - R0005 - Practical Activities - 1hb - (28.98 SQM)	● Student Space (13)	
B00B - R0009 - Home Base - (54.68 SQM) - Teaching Space: 1	● Student Space (25)	
B00B - R0010 - Home Base - (54.73 SQM) - Teaching Space: 1	● Student Space (25)	
B00B - R0012 - Withdrawal Space - 2hb - (46.89 SQM)	● Student Space (21)	
B00B - R0013 - Home Base - (64.57 SQM) - Teaching Space: 1	● Student Space (29)	
B00C - R0001 - Outdoor Learning Area - (79.48 SQM)	Not Applicable	Circulation or storage space.
B00C - R0002 - Home Base - (86.96 SQM) - Teaching Space: 1	● Student Space (40)	
B00C - R0003 - Movement - (12.08 SQM)	Not Applicable	Circulation or storage space.
B00C - R0008 - Practical Activities - (14.63 SQM)	● Student Space (6)	
B00C - R0009 - Home Base - (66.66 SQM) - Teaching Space: 1	● Student Space (30)	
B00D - R0002 - Practical Activities - 1hb - (18.61 SQM)	● Student Space (8)	
B00D - R0004 - Home Base - (59.61 SQM) - Teaching Space: 1	● Student Space (27)	
B00D - R0005 - Withdrawal Space - 2hb - (11.34 SQM)	● Student Space (5)	
B00D - R0006 - Home Base - (59.61 SQM) - Teaching Space: 1	● Student Space (27)	
B00D - R0008 - Practical Activities - 1hb - (18.58 SQM)	● Student Space (8)	
B00D - R0009 - Special Programs Room - (33.35 SQM)	● Student Space (15)	
B00T - R0001 - Movement - (12.32 SQM)	Not Applicable	Circulation or storage space.
B00T - R0002 - Staff Room - (47.08 SQM)	● Office (11)	
B00V - R0001 - Movement - (108.8 SQM)	Not Applicable	Circulation or storage space.
B00V - R0002 - Communal Space - (189.89 SQM)	● Student Space (88)	

Entity Location	Audit Condition Classification (Capacity)	Comment
B00V - R0006 - Staff Kitchen - (8.28 SQM)	 Office (2)	
B00V - R0011 - Stage - (20.9 SQM)	Not Applicable	Circulation or storage space.
B00V - R0014 - General Assistants - (12.78 SQM)	 Office (3)	
OS 602 11289 - OS 602 11289 - Learning Unit - Standard With P.A.A. - (76 SQM)	 Student Space (35)	
OS 602 15644 - OS 602 15644 - Learning Unit - Standard With P.A.A. - (76 SQM)	 Student Space (35)	