

VENTILATION AUDIT REPORT

SCHOOL:	Beverley Park School (5508)
AMU REGION:	South Western Sydney
STATE ELECTORATE:	Campbelltown
LOCAL GOVERNMENT AREA:	Campbelltown

5508 - Beverley Park School
Site Plan (10218)

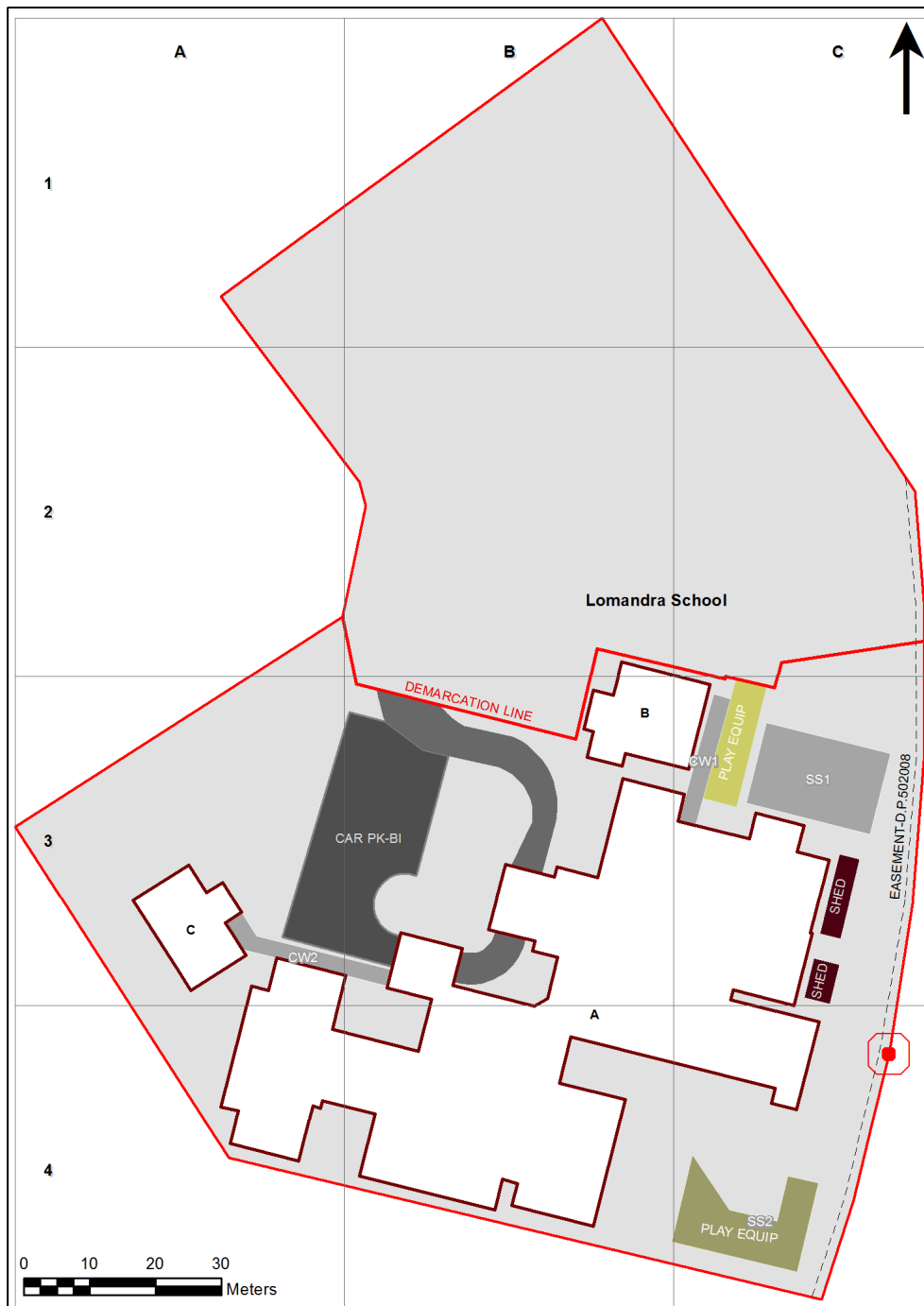

1:720

Printed: 21-Mar-2020

Ventilation Audit Key

Category	Description
	Category A Operate this space in line with COVID safe school operations . It has the required level of natural ventilation. NB. Circulation and storage areas should not be used for groups or gatherings.
	Category B This space should be occupied at 1 person per 4m ² to comply with COVID safe school operations and the guided use of spaces . The report details the number of people who can be accommodated safely in each of the identified spaces.

Entity Location	Audit Condition Classification (Capacity)	Comment
B00A - R0002 - Home Base - M - (60.04 SQM) - Teaching Space: 1	● Student Space (27)	
B00A - R0003 - Practical Activities - M - 1hb - (11.5 SQM)	● Student Space (5)	
B00A - R0011 - Home Base - M - (60.74 SQM) - Teaching Space: 1	● Student Space (28)	
B00A - R0015 - Staff Room - (35.03 SQM)	● Office (8)	
B00A - R0016 - Entry Vestibule - (34.69 SQM)	Not Applicable	Circulation or storage space.
B00A - R0021 - Movement - (226.88 SQM)	Not Applicable	Circulation or storage space.
B00A - R0025 - Home Base - M - (70.47 SQM) - Teaching Space: 1	● Student Space (32)	
B00A - R0032 - Movement - (24.87 SQM)	Not Applicable	Circulation or storage space.
B00A - R0033 - Staff Room Annexe - (5.89 SQM)	● Office (1)	
B00A - R0034 - Withdrawal - S - (8.76 SQM)	● Student Space (4)	
B00A - R0036 - Home Base - S - (71.17 SQM) - Teaching Space: 1	● Student Space (33)	
B00A - R0040 - Staff Room Annexe - (14.26 SQM)	● Office (3)	
B00A - R0041 - Interview - (14.86 SQM)	● Office (3)	
B00A - R0045 - Home Base - S - (60.11 SQM) - Teaching Space: 1	● Student Space (27)	
B00A - R0046 - Home Base - M - (59.49 SQM) - Teaching Space: 1	● Student Space (27)	
B00A - R0049 - Movement - (10.65 SQM)	Not Applicable	Circulation or storage space.
B00A - R0050 - Movement - (115.31 SQM)	Not Applicable	Circulation or storage space.
B00A - R0052 - Movement - (25.74 SQM)	Not Applicable	Circulation or storage space.
B00A - R0053 - Reading Area - (143.63 SQM)	● Student Space (66)	
B00A - R0060 - Home Base - S - (71.67 SQM) - Teaching Space: 1	● Student Space (33)	
B00A - R0061 - Home Base - S - (74.7 SQM) - Teaching Space: 1	● Student Space (34)	
B00A - R0062 - Movement - (21.36 SQM)	Not Applicable	Circulation or storage space.
B00A - R0068 - Movement - (24.5 SQM)	Not Applicable	Circulation or storage space.
B00A - R0069 - Movement - (69.35 SQM)	Not Applicable	Circulation or storage space.
B00A - R0070 - Movement - (25.44 SQM)	Not Applicable	Circulation or storage space.
B00A - R0072 - Staff Kitchen - (12.92 SQM)	● Office (3)	
B00A - R0073 - Home Base/Practical Activities - S - (87.42 SQM) - Teaching Space: 1	● Student Space (40)	
B00A - R0075 - Movement - (50.82 SQM)	Not Applicable	Circulation or storage space.
B00A - R0077 - Movement - (61.66 SQM)	Not Applicable	Circulation or storage space.
B00A - R0084 - Staff Room Annexe - (15.55 SQM)	● Office (3)	
B00A - R0087 - Clerical Office - (14.96 SQM)	● Office (3)	
B00A - R0088 - Principal - (18.8 SQM)	● Office (4)	
B00A - R0089 - Communal Space - (96.68 SQM)	● Student Space (44)	
B00B - R0001 - Hydrotherapy - Pool - (126.36 SQM)	Not Applicable	Circulation or storage space.
B00C - R0002 - Communal Space - (113.77 SQM)	● Student Space (52)	