

# VENTILATION AUDIT REPORT

<b>SCHOOL:</b>	<b>Berkeley West Public School (4180)</b>
<b>AMU REGION:</b>	<b>Southern NSW</b>
<b>STATE ELECTORATE:</b>	<b>Wollongong</b>
<b>LOCAL GOVERNMENT AREA:</b>	<b>Wollongong</b>

4180 - Berkeley West Public School  
Site Plan (10873)

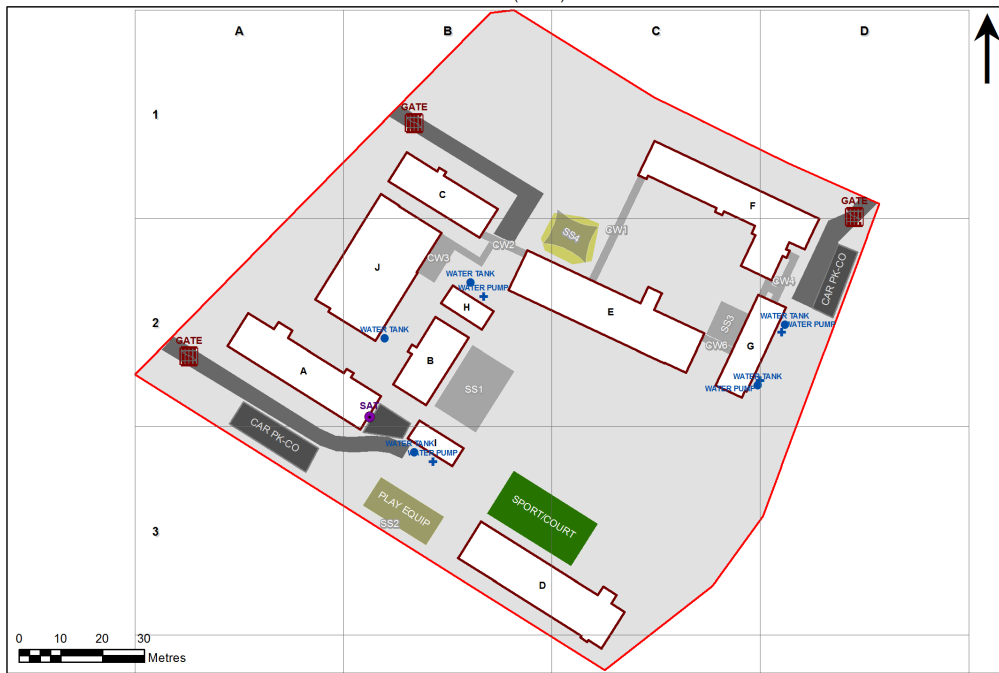

1:851

Printed: 30-Mar-2021

## Ventilation Audit Key

Category	Description
	Category A Operate this space in line with <a href="#">COVID safe school operations</a> . It has the required level of natural ventilation. NB. Circulation and storage areas should not be used for groups or gatherings.
	Category B This space should be occupied at 1 person per 4m <sup>2</sup> to comply with <a href="#">COVID safe school operations and the guided use of spaces</a> . The report details the number of people who can be accommodated safely in each of the identified spaces.

Entity Location	Audit Condition Classification (Capacity)	Comment
B00A - R0001 - Home Base - (68.02 SQM) - Teaching Space: 1	● Student Space (31)	
B00A - R0029 - Staff Room Annexe - (19.19 SQM)	● Office (4)	
B00A - R0030 - Entry Vestibule - (21.12 SQM)	Not Applicable	Circulation or storage space.
B00A - R0031 - Clerical Office - (27.25 SQM)	● Office (6)	
B00A - R0032 - Clerical Office/Workroom - (10.82 SQM)	● Office (2)	
B00A - R0033 - Principal - (16 SQM)	● Office (4)	
B00A - R0036 - Movement - (5.97 SQM)	Not Applicable	Circulation or storage space.
B00A - R0037 - Movement - (25.65 SQM)	Not Applicable	Circulation or storage space.
B00A - R0041 - Deputy Principal - Type 1 - (13.55 SQM)	● Office (3)	
B00A - R0043 - Sick Bay - (13.59 SQM)	● Student Space (6)	
B00A - R0044 - Interview - (13.55 SQM)	● Office (3)	
B00A - R0046 - Staff Kitchen - (10.26 SQM)	● Office (2)	
B00A - R0047 - Staff Room - (37 SQM)	● Office (9)	
B00B - R0009 - Reading Area - (134.36 SQM)	● Student Space (62)	
B00C - R0001 - Movement - (12.45 SQM)	Not Applicable	Circulation or storage space.
B00C - R0006 - Home Base - (58.23 SQM) - Teaching Space: 1	● Student Space (27)	
B00C - R0010 - Movement - (6.32 SQM)	Not Applicable	Circulation or storage space.
B00C - R0011 - Home Base - (58.7 SQM) - Teaching Space: 1	● Student Space (27)	
B00D - R0001 - Movement - (86.88 SQM)	Not Applicable	Circulation or storage space.
B00D - R0002 - Movement - (7.64 SQM)	Not Applicable	Circulation or storage space.
B00D - R0008 - Home Base - (56.24 SQM) - Teaching Space: 1	● Student Space (26)	
B00D - R0009 - Home Base - (56.32 SQM) - Teaching Space: 1	● Student Space (26)	
B00D - R0012 - Home Base - (56.55 SQM) - Teaching Space: 1	● Student Space (26)	
B00D - R0016 - Entry Vestibule - (7.19 SQM)	Not Applicable	Circulation or storage space.
B00D - R0017 - Interview - (16.44 SQM)	● Office (4)	
B00D - R1001 - Movement - (85.89 SQM)	Not Applicable	Circulation or storage space.
B00D - R1006 - Home Base - (58.03 SQM) - Teaching Space: 1	● Student Space (26)	
B00D - R1007 - Home Base - (58.26 SQM) - Teaching Space: 1	● Student Space (27)	
B00D - R1010 - Home Base - (58.35 SQM) - Teaching Space: 1	● Student Space (27)	
B00D - R1014 - Movement - (5.97 SQM)	Not Applicable	Circulation or storage space.
B00D - R1017 - Staff Room Annexe - (19.32 SQM)	● Office (4)	
B00D - R9004 - Movement - (100.68 SQM)	Not Applicable	Circulation or storage space.
B00D - R9006 - Movement - (15.17 SQM)	Not Applicable	Circulation or storage space.
B00E - R0002 - Movement - (23.1 SQM)	Not Applicable	Circulation or storage space.
B00E - R0005 - Home Base - (86.93 SQM) - Teaching Space: 1	● Student Space (40)	
B00E - R0006 - Home Base - (60.07 SQM) - Teaching Space: 1	● Student Space (27)	
B00E - R0008 - Movement - (5.25 SQM)	Not Applicable	Circulation or storage space.
B00E - R0011 - Movement - (44.97 SQM)	Not Applicable	Circulation or storage space.
B00E - R0012 - Home Base - (58.64 SQM) - Teaching Space: 1	● Student Space (27)	
B00E - R0016 - Movement - (16.87 SQM)	Not Applicable	Circulation or storage space.
B00E - R0019 - Home Base - (57.68 SQM) - Teaching Space: 1	● Student Space (26)	
B00E - R1001 - Home Base - (57.9 SQM) - Teaching Space: 1	● Student Space (26)	
B00E - R1003 - Movement - (8.61 SQM)	Not Applicable	Circulation or storage space.
B00E - R1005 - Staff Room Annexe - (57.74 SQM) - Teaching Space: 1	● Office (14)	
B00E - R1006 - Home Base - (58.95 SQM) - Teaching Space: 1	● Student Space (27)	
B00E - R1009 - Movement - (21.62 SQM)	Not Applicable	Circulation or storage space.
B00E - R1011 - Home Base - (58.07 SQM)	● Student Space (26)	
B00F - R0005 - Entry Vestibule - (11.64 SQM)	Not Applicable	Circulation or storage space.
B00F - R0009 - Movement - (6.43 SQM)	Not Applicable	Circulation or storage space.
B00F - R0010 - Movement - (12.2 SQM)	Not Applicable	Circulation or storage space.

Entity Location	Audit Condition Classification (Capacity)	Comment
B00F - R0020 - Movement - (6.1 SQM)	Not Applicable	Circulation or storage space.
B00F - R0022 - Raised Platform - (21.86 SQM)	Not Applicable	Circulation or storage space.
B00F - R0024 - Communal Space - (111.03 SQM)	● Student Space (51)	
B00F - R0027 - Movement - (6.06 SQM)	Not Applicable	Circulation or storage space.
B00J - R0001 - Communal Space - (140.17 SQM)	● Student Space (65)	
B00J - R0002 - Raised Platform - (63.22 SQM)	Not Applicable	Circulation or storage space.
B00J - R0016 - Movement - (6.97 SQM)	Not Applicable	Circulation or storage space.
B00J - R0017 - Movement - (16.38 SQM)	Not Applicable	Circulation or storage space.
B00J - R0020 - Canteen - (26.58 SQM)	Not Applicable	Circulation or storage space.