

VENTILATION AUDIT REPORT

SCHOOL:	Bathurst Public School (1150)
AMU REGION:	North Western NSW
STATE ELECTORATE:	Bathurst
LOCAL GOVERNMENT AREA:	Bathurst

1150 - Bathurst Public School
Site Plan (10089)

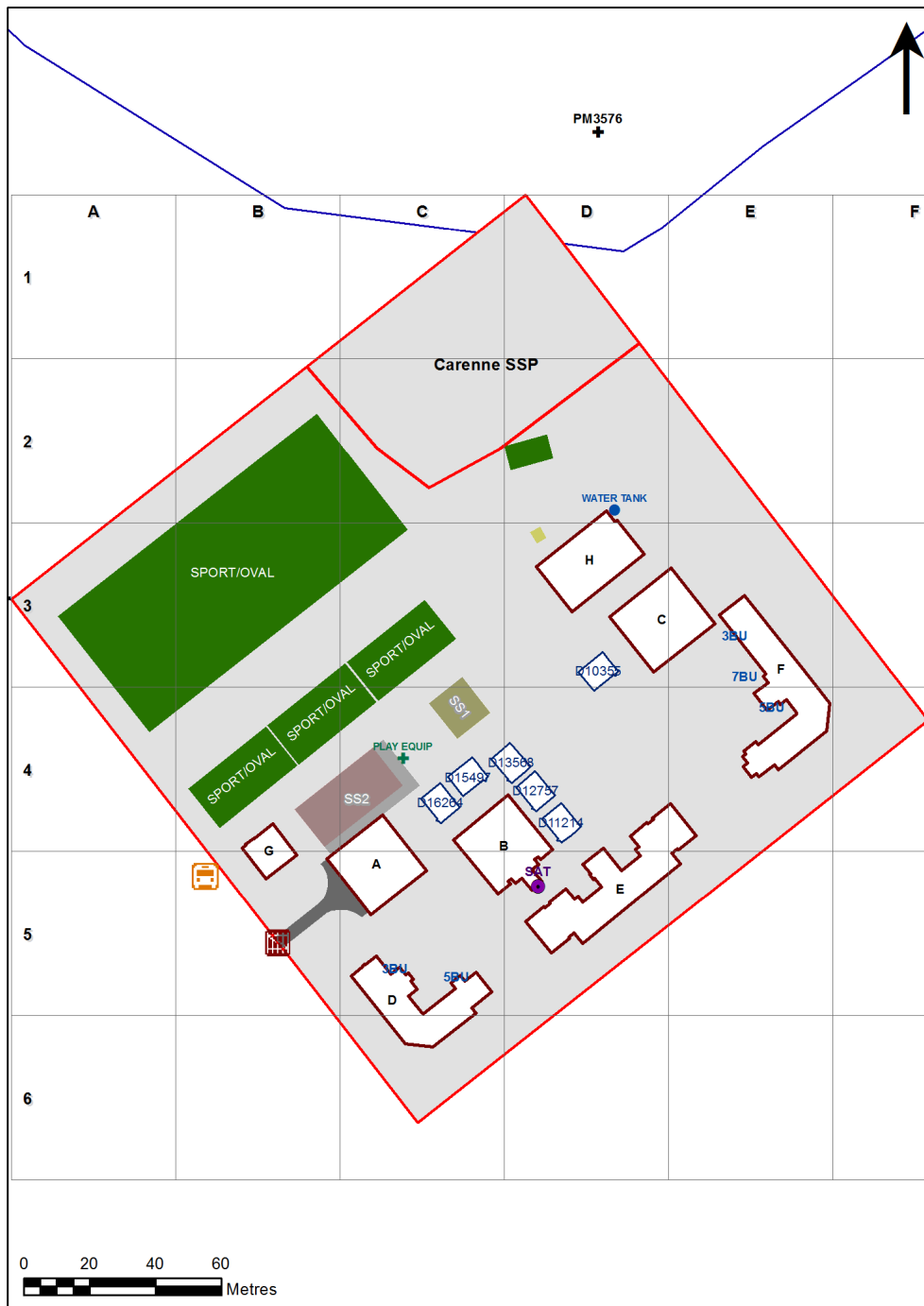

1:1,442

Printed: 21-May-2021

Ventilation Audit Key

Category	Description
	Category A Operate this space in line with COVID safe school operations . It has the required level of natural ventilation. NB. Circulation and storage areas should not be used for groups or gatherings.
	Category B This space should be occupied at 1 person per 4m ² to comply with COVID safe school operations and the guided use of spaces . The report details the number of people who can be accommodated safely in each of the identified spaces.

Entity Location	Audit Condition Classification (Capacity)	Comment
B00A - R0001 - Movement - (91.66 SQM)	Not Applicable	Circulation or storage space.
B00A - R0002 - Movement - (237.57 SQM)	Not Applicable	Circulation or storage space.
B00A - R0004 - Canteen - (27.11 SQM)	Not Applicable	Circulation or storage space.
B00B - R0001 - Movement - (74.6 SQM)	Not Applicable	Circulation or storage space.
B00B - R0002 - Movement - (6.3 SQM)	Not Applicable	Circulation or storage space.
B00B - R0003 - Home Base - (72.38 SQM) - Teaching Space: 1	● Student Space (33)	
B00B - R0004 - Practical Activities - 1hb - (20.47 SQM)	● Student Space (9)	
B00B - R0005 - Home Base - (60.38 SQM) - Teaching Space: 1	● Student Space (28)	
B00B - R0006 - Practical Activities - 1hb - (17.08 SQM)	● Student Space (7)	
B00B - R0007 - Home Base - (71.69 SQM) - Teaching Space: 1	● Student Space (33)	
B00B - R0008 - Practical Activities - 1hb - (20.14 SQM)	● Student Space (9)	
B00B - R0009 - Home Base - (60.52 SQM) - Teaching Space: 1	● Student Space (28)	
B00B - R0010 - Practical Activities - 1hb - (17.22 SQM)	● Student Space (7)	
B00B - R1001 - Reading Area - (209.36 SQM)	● Student Space (97)	
B00B - R1002 - Reading Area - (52.7 SQM)	● Student Space (24)	
B00B - R1012 - Movement - (15.91 SQM)	Not Applicable	Circulation or storage space.
B00C - R0001 - Home Base - (92.67 SQM) - Teaching Space: 1	● Student Space (42)	
B00C - R0003 - Practical Activities - 1hb - (20.07 SQM)	● Student Space (9)	
B00C - R0004 - Home Base - (92.74 SQM) - Teaching Space: 1	● Student Space (43)	
B00C - R0005 - Practical Activities - 1hb - (20.1 SQM)	● Student Space (9)	
B00C - R0009 - Practical Activities - 1hb - (17.52 SQM)	● Student Space (8)	
B00C - R0011 - Home Base - (86.14 SQM) - Teaching Space: 1	● Student Space (39)	
B00C - R0012 - Movement - (97.34 SQM)	Not Applicable	Circulation or storage space.
B00E - R0003 - Principal - (20.18 SQM)	● Office (5)	
B00E - R0004 - Duplicating Workroom - (46.18 SQM)	● Office (11)	
B00E - R0006 - Movement - (39.26 SQM)	Not Applicable	Circulation or storage space.
B00E - R0016 - Movement - (47.04 SQM)	Not Applicable	Circulation or storage space.
B00E - R0017 - Home Base - (62.49 SQM) - Teaching Space: 1	● Student Space (28)	
B00E - R0023 - Deputy Principal - (22.36 SQM)	● Office (5)	
B00E - R0025 - Staff Room Annexe - (21.19 SQM)	● Office (5)	
B00E - R0028 - Movement - (34.46 SQM)	Not Applicable	Circulation or storage space.
B00E - R0032 - Staff Kitchen - (21.36 SQM)	● Office (5)	
B00E - R0033 - Staff Room - (54.5 SQM)	● Office (13)	
B00E - R0034 - Special Programs Room - (50.04 SQM)	● Student Space (23)	
B00E - R0035 - Entry Vestibule - (33.92 SQM)	Not Applicable	Circulation or storage space.
B00E - R0036 - Clerical Office/Workroom - (62.54 SQM)	● Office (15)	
B00E - R0037 - Clerical Office/Workroom - (17.65 SQM)	● Office (4)	
B00E - R0038 - Clerical Office/Workroom - (28.16 SQM)	● Office (7)	
B00E - R1001 - Home Base - (48.47 SQM) - Teaching Space: 1	● Student Space (22)	
B00E - R1002 - Home Base - (47.71 SQM) - Teaching Space: 1	● Student Space (22)	
B00E - R1003 - Home Base - (47.28 SQM) - Teaching Space: 1	● Student Space (21)	
B00E - R1004 - Home Base - (46.58 SQM) - Teaching Space: 1	● Student Space (21)	
B00E - R1005 - Home Base - (49.25 SQM) - Teaching Space: 1	● Student Space (22)	
B00E - R1007 - Movement - (90.15 SQM)	Not Applicable	Circulation or storage space.
B00F - R0002 - Movement - (8.67 SQM)	Not Applicable	Circulation or storage space.
B00F - R0007 - Home Base - (47.74 SQM) - Teaching Space: 1	● Student Space (22)	
B00F - R0009 - Staff Room Annexe - (13.83 SQM)	● Office (3)	
B00F - R0011 - Withdrawal Space - 1hb - (22.91 SQM)	● Student Space (10)	
B00F - R0012 - Movement - (87.54 SQM)	Not Applicable	Circulation or storage space.

Entity Location	Audit Condition Classification (Capacity)	Comment
B00F - R0015 - Staff Room Annexe - (12.84 SQM)	Office (3)	
B00F - R0017 - Movement - (10.21 SQM)	Not Applicable	Circulation or storage space.
B00F - R0018 - Staff Room Annexe - (8.72 SQM)	Office (2)	
B00F - R0019 - Home Base - (47.15 SQM) - Teaching Space: 1	Student Space (21)	
B00F - R0020 - Home Base - (47.81 SQM) - Teaching Space: 1	Student Space (22)	
B00F - R0029 - Communal Space - (170 SQM)	Student Space (78)	
B00F - R0030 - Raised Platform - (26.41 SQM)	Not Applicable	Circulation or storage space.
B00F - R1001 - Movement - (7.2 SQM)	Not Applicable	Circulation or storage space.
B00F - R1002 - Staff Room Annexe - (11.26 SQM)	Office (2)	
B00F - R1003 - Clerical Office/Workroom - (32.44 SQM)	Office (8)	
B00F - R1004 - Withdrawal Space - 1hb - (14.59 SQM)	Student Space (6)	
B00F - R1005 - Staff Room Annexe - (47.68 SQM)	Office (11)	
B00F - R1009 - Interview - (21.58 SQM)	Office (5)	
B00F - R1010 - Staff Kitchen - (8.85 SQM)	Office (2)	
B00F - R1012 - Movement - (40.35 SQM)	Not Applicable	Circulation or storage space.
B00F - R1013 - Home Base - (46.95 SQM) - Teaching Space: 1	Student Space (21)	
B00F - R1014 - Home Base - (47.61 SQM) - Teaching Space: 1	Student Space (22)	
B00F - R1015 - Movement - (25.48 SQM)	Not Applicable	Circulation or storage space.
B00F - R1016 - Practical Activities - 1hb - (9.06 SQM)	Student Space (4)	
B00F - R9004 - Practical Activities - 1hb - (64.3 SQM)	Student Space (29)	
B00G - R0001 - Dental Clinic - (50.38 SQM)	Office (12)	
B00G - R0002 - Dental Clinic - (11.95 SQM)	Office (2)	
B00G - R0003 - Dental Clinic - (5.13 SQM)	Office (1)	
B00G - R0005 - Dental Clinic - (12.78 SQM)	Office (3)	
B00G - R0008 - Dental Clinic - (16.32 SQM)	Office (4)	
B00G - R0010 - Dental Clinic - (8.88 SQM)	Office (2)	
B00G - R0011 - Dental Clinic - (7.85 SQM)	Office (1)	
B00H - R0001 - Communal Space - (144.75 SQM)	Student Space (67)	
B00H - R0002 - Raised Platform - (59.62 SQM)	Not Applicable	Circulation or storage space.
B00H - R0003 - Movement - (5.94 SQM)	Not Applicable	Circulation or storage space.
B00H - R0005 - Movement - (11.28 SQM)	Not Applicable	Circulation or storage space.
OH 045 17012 - OH 045 17012 - OSHC Hub 45 - (247 SQM)	Student Space (114)	
OS 602 10355 - OS 602 10355 - Learning Unit - Standard With P.A.A. - (76 SQM)	Student Space (35)	
OS 602 12757 - OS 602 12757 - Learning Unit - Standard With P.A.A. - (76 SQM)	Student Space (35)	
OS 602 13568 - OS 602 13568 - Learning Unit - Standard With P.A.A. - (76 SQM)	Student Space (35)	
OS 602 15497 - OS 602 15497 - Learning Unit - Standard With P.A.A. - (76 SQM)	Student Space (35)	
OS 602 16264 - OS 602 16264 - Learning Unit - Standard With P.A.A. - (76 SQM)	Student Space (35)	
OS 603 11214 - OS 603 11214 - Learning Unit - Standard With P.A.A. A/C - (76 SQM)	Student Space (35)	
OS 603 15829 - OS 603 15829 - Learning Unit - Standard With P.A.A. A/C - (76 SQM)	Student Space (35)	