

# VENTILATION AUDIT REPORT

<b>SCHOOL:</b>	<b>Barham Public School (1135)</b>
<b>AMU REGION:</b>	<b>Southern NSW</b>
<b>STATE ELECTORATE:</b>	<b>Murray</b>
<b>LOCAL GOVERNMENT AREA:</b>	<b>Murray River</b>

1135 - Barham Public School  
Site Plan (10353)

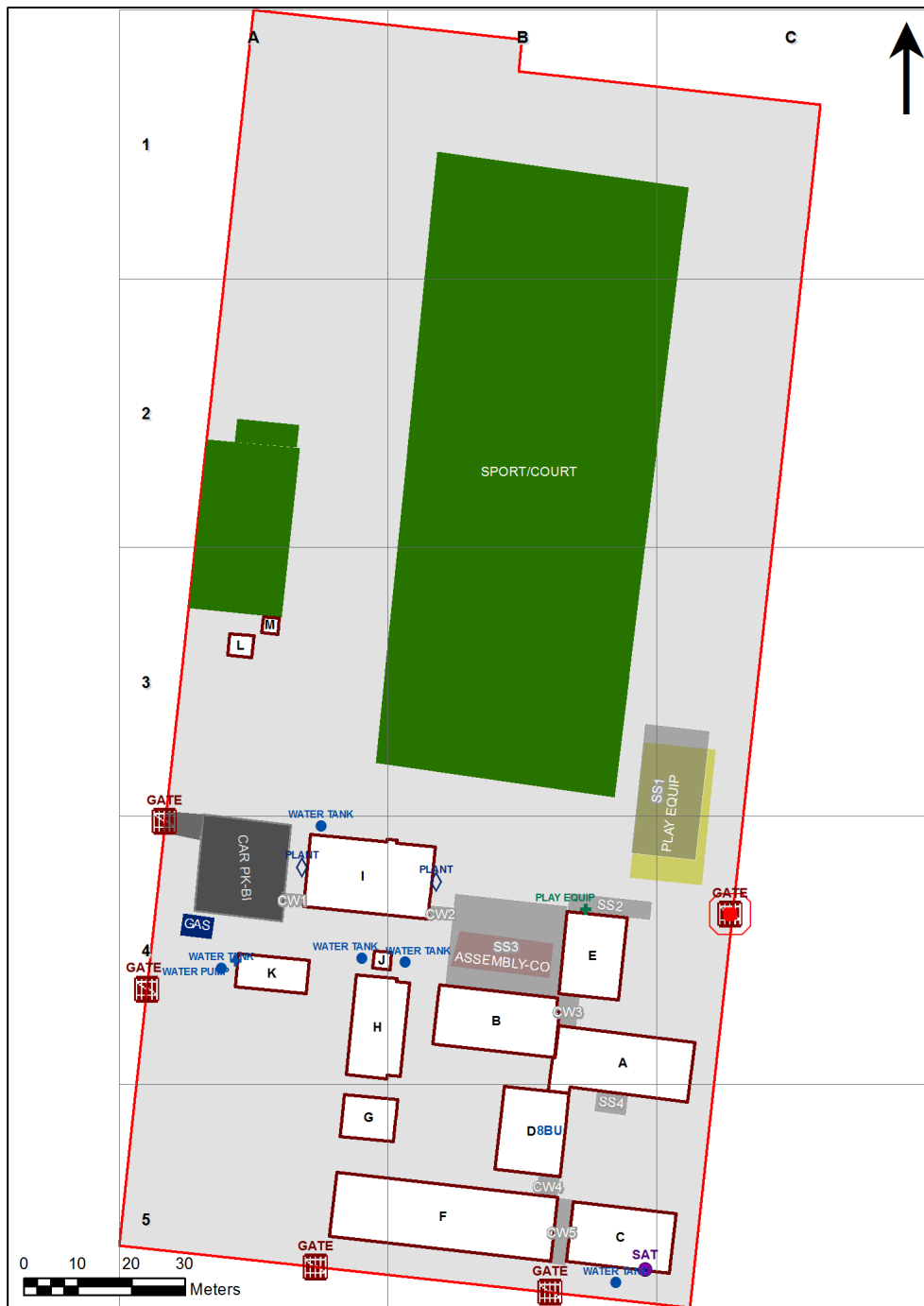

1:882

Printed: 20-Mar-2020

## Ventilation Audit Key

Category	Description
	Category A Operate this space in line with <a href="#">COVID safe school operations</a> . It has the required level of natural ventilation. NB. Circulation and storage areas should not be used for groups or gatherings.
	Category B This space should be occupied at 1 person per 4m <sup>2</sup> to comply with <a href="#">COVID safe school operations and the guided use of spaces</a> . The report details the number of people who can be accommodated safely in each of the identified spaces.

Entity Location	Audit Condition Classification (Capacity)	Comment
B00A - R0001 - Principal - (23.46 SQM)	Office (5)	
B00A - R0002 - Clerical Office - (12.92 SQM)	Office (3)	
B00A - R0003 - Movement - (12.63 SQM)	Not Applicable	Circulation or storage space.
B00A - R0004 - Home Base - (57.08 SQM) - Teaching Space: 1	Student Space (26)	
B00A - R0008 - Staff Room Annexe - (29.13 SQM)	Office (7)	
B00A - R0009 - Movement - (91.2 SQM)	Not Applicable	Circulation or storage space.
B00B - R0001 - Movement - (53.93 SQM)	Not Applicable	Circulation or storage space.
B00B - R0005 - Home Base - (85.16 SQM) - Teaching Space: 1	Student Space (39)	
B00B - R0006 - Home Base - (56.6 SQM) - Teaching Space: 1	Student Space (26)	
B00C - R0001 - Movement - (46.45 SQM)	Not Applicable	Circulation or storage space.
B00C - R0002 - Home Base - (58.12 SQM) - Teaching Space: 1	Student Space (26)	
B00C - R0005 - Movement - (15.83 SQM)	Not Applicable	Circulation or storage space.
B00C - R0006 - Staff Room Annexe - (27.75 SQM)	Office (6)	
B00C - R0009 - Movement - (14.96 SQM)	Not Applicable	Circulation or storage space.
B00C - R1002 - Reading Area - (90.65 SQM)	Student Space (42)	
B00C - R1006 - Movement - (11.87 SQM)	Not Applicable	Circulation or storage space.
B00C - R1008 - Movement - (28.85 SQM)	Not Applicable	Circulation or storage space.
B00D - R0001 - Movement - (61.83 SQM)	Not Applicable	Circulation or storage space.
B00E - R0001 - Movement - (24.31 SQM)	Not Applicable	Circulation or storage space.
B00E - R0006 - Movement - (59.51 SQM)	Not Applicable	Circulation or storage space.
B00F - R0001 - Movement - (68.09 SQM)	Not Applicable	Circulation or storage space.
B00F - R0003 - Staff Room Annexe - (5.65 SQM)	Office (1)	
B00F - R0004 - Home Base - (67.02 SQM) - Teaching Space: 1	Student Space (31)	
B00F - R0005 - Home Base - (72.66 SQM) - Teaching Space: 1	Student Space (33)	
B00F - R0006 - Home Base - (45.48 SQM) - Teaching Space: 1	Student Space (21)	
B00F - R0007 - Home Base - (45.35 SQM) - Teaching Space: 1	Student Space (21)	
B00F - R0012 - Movement - (11.54 SQM)	Not Applicable	Circulation or storage space.
B00F - R0013 - Practical Activities - (15.75 SQM)	Student Space (7)	
B00F - R0017 - Practical Activities - (13.46 SQM)	Student Space (6)	
B00F - R0018 - Practical Activities - (16.64 SQM)	Student Space (7)	
B00F - R0020 - Special Programs Room - (30.44 SQM)	Student Space (14)	
B00F - R0021 - Movement - (21.86 SQM)	Not Applicable	Circulation or storage space.
B00G - R0001 - Movement - (14.19 SQM)	Not Applicable	Circulation or storage space.
B00G - R0002 - Special Programs Room - (41.35 SQM)	Student Space (19)	
B00H - R0002 - Withdrawal Space - 1hb - (14.77 SQM)	Student Space (6)	
B00H - R0004 - Home Base - (53.12 SQM) - Teaching Space: 1	Student Space (24)	
B00H - R0007 - Special Programs Room - (27.26 SQM)	Student Space (12)	
B00H - R0010 - Movement - (26.36 SQM)	Not Applicable	Circulation or storage space.
B00I - R0001 - Home Base - (59.69 SQM) - Teaching Space: 1	Student Space (27)	
B00I - R0003 - Practical Activities - (18.78 SQM)	Student Space (8)	
B00I - R0004 - Withdrawal Space - 2hb - (11.47 SQM)	Student Space (5)	
B00I - R0005 - Practical Activities - (18.89 SQM)	Student Space (8)	
B00I - R0006 - Home Base - (59.9 SQM) - Teaching Space: 1	Student Space (27)	
B00I - R0008 - Special Programs Room - (38.53 SQM)	Student Space (17)	