

VENTILATION AUDIT REPORT

SCHOOL:	Balranald Central School (1115)
AMU REGION:	Southern NSW
STATE ELECTORATE:	Murray
LOCAL GOVERNMENT AREA:	Balranald

1115 - Balranald Central School
Site Plan (12303)

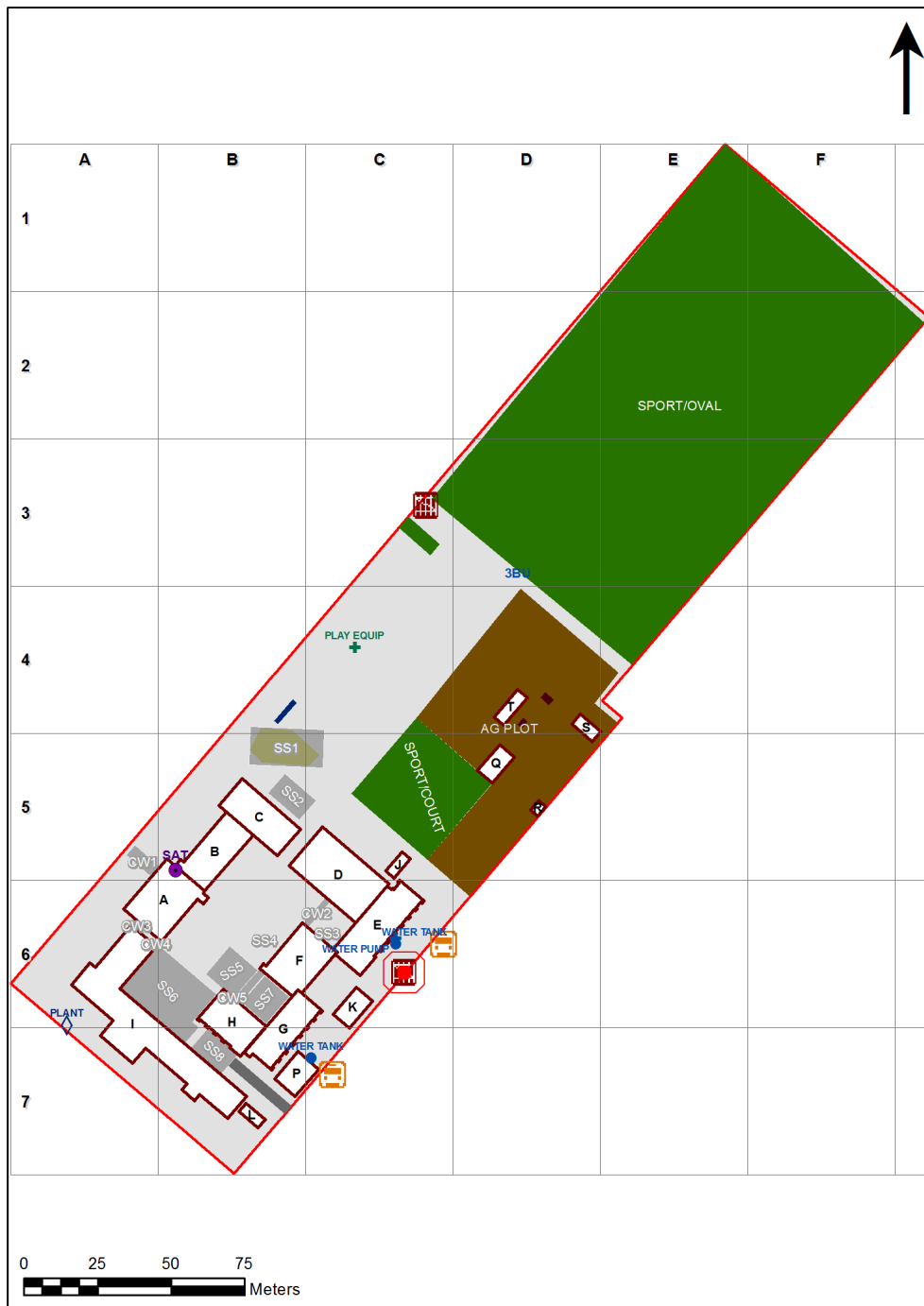

1:1,609

Printed: 20-Mar-2020

Ventilation Audit Key

Category	Description
	Category A Operate this space in line with COVID safe school operations . It has the required level of natural ventilation. NB. Circulation and storage areas should not be used for groups or gatherings.
	Category B This space should be occupied at 1 person per 4m ² to comply with COVID safe school operations and the guided use of spaces . The report details the number of people who can be accommodated safely in each of the identified spaces.

Entity Location	Audit Condition Classification (Capacity)	Comment
B00A - R0001 - Movement - (43.01 SQM)	Not Applicable	Circulation or storage space.
B00A - R0002 - Staff Room - (77.9 SQM)	Office (19)	
B00A - R0003 - Entry Vestibule - (15.54 SQM)	Not Applicable	Circulation or storage space.
B00A - R0004 - Principal - (24.46 SQM)	Office (6)	
B00A - R0005 - Clerical Office/Workroom - (24.42 SQM)	Office (6)	
B00A - R0006 - Staff Room Annexe - (13.42 SQM)	Office (3)	
B00A - R0009 - Duplicating Workroom - (7.38 SQM)	Office (1)	
B00A - R0015 - Movement - (40.8 SQM)	Not Applicable	Circulation or storage space.
B00A - R0016 - Movement - (14.99 SQM)	Not Applicable	Circulation or storage space.
B00A - R0017 - Movement - (25.22 SQM)	Not Applicable	Circulation or storage space.
B00A - R1003 - Seminar/Study - (26.53 SQM)	Office (6)	
B00A - R1010 - Movement - (10.36 SQM)	Not Applicable	Circulation or storage space.
B00A - R1013 - Movement - (24.07 SQM)	Not Applicable	Circulation or storage space.
B00A - R1016 - Reading Area - (189.25 SQM)	Student Space (87)	
B00B - R0003 - Home Base - (44.54 SQM) - Teaching Space: 1	Student Space (20)	
B00B - R0012 - Practical Activities - 1hb - (26.05 SQM)	Student Space (12)	
B00B - R0016 - Art Learning Space - (65.5 SQM) - Teaching Space: 1	Student Space (30)	
B00B - R1001 - Movement - (61.76 SQM)	Not Applicable	Circulation or storage space.
B00B - R1002 - Staff Room Annexe - (21.12 SQM)	Office (5)	
B00B - R1003 - General Learning Space - (70.72 SQM) - Teaching Space: 1	Student Space (32)	
B00B - R1004 - General Learning Space - (70.49 SQM) - Teaching Space: 1	Student Space (32)	
B00C - R0001 - Movement - (60.55 SQM)	Not Applicable	Circulation or storage space.
B00C - R0010 - Movement - (19.24 SQM)	Not Applicable	Circulation or storage space.
B00C - R0016 - Home Base - (73.28 SQM) - Teaching Space: 1	Student Space (33)	
B00C - R0017 - Practical Activities - (20.6 SQM)	Student Space (9)	
B00C - R0019 - Home Base - (45.32 SQM) - Teaching Space: 1	Student Space (21)	
B00C - R0020 - Practical Activities - (20.32 SQM)	Student Space (9)	
B00C - R1001 - Movement - (83.34 SQM)	Not Applicable	Circulation or storage space.
B00C - R1004 - Deputy Principal - (12.04 SQM)	Office (3)	
B00C - R1011 - Practical Activities - (21.16 SQM)	Student Space (9)	
B00C - R1013 - Home Base - (45.42 SQM) - Teaching Space: 1	Student Space (21)	
B00C - R1014 - Home Base - (45.16 SQM) - Teaching Space: 1	Student Space (20)	
B00C - R1015 - Practical Activities - (20.19 SQM)	Student Space (9)	
B00D - R0001 - Movement - (70.72 SQM)	Not Applicable	Circulation or storage space.
B00D - R0005 - Multi-Purpose Space - (247.26 SQM)	Student Space (114)	
B00D - R0012 - Staff Kitchen - (9.34 SQM)	Office (2)	
B00D - R0013 - Movement - (18.33 SQM)	Not Applicable	Circulation or storage space.
B00D - R0020 - Stage - (49.15 SQM)	Not Applicable	Circulation or storage space.
B00E - R0001 - Laboratory L.S. - (98.01 SQM) - Teaching Space: 1	Student Space (45)	
B00E - R0002 - Preparation - (47.97 SQM)	Not Applicable	Circulation or storage space.
B00E - R0003 - Laboratory L.S. - (96.3 SQM) - Teaching Space: 1	Student Space (44)	
B00E - R0007 - Movement - (29.26 SQM)	Not Applicable	Circulation or storage space.
B00E - R0010 - Movement - (33.27 SQM)	Not Applicable	Circulation or storage space.
B00F - R0001 - Movement - (93.85 SQM)	Not Applicable	Circulation or storage space.
B00F - R0004 - Movement - (46.96 SQM)	Not Applicable	Circulation or storage space.
B00G - R0002 - Seminar - (26.39 SQM)	Office (6)	
B00G - R0004 - Withdrawal Space - 1hb - (9.42 SQM)	Student Space (4)	
B00G - R0005 - General Learning Space - (52.85 SQM) - Teaching Space: 1	Student Space (24)	
B00G - R0006 - Seminar - (25.84 SQM)	Office (6)	
B00G - R0007 - Seminar/Study - (26.79 SQM)	Office (6)	

Entity Location	Audit Condition Classification (Capacity)	Comment
B00G - R0008 - Movement - (69.66 SQM)	Not Applicable	Circulation or storage space.
B00G - R1001 - General Learning Space - (54.03 SQM) - Teaching Space: 1	● Student Space (25)	
B00G - R1005 - General Learning Space - (52.93 SQM) - Teaching Space: 1	● Student Space (24)	
B00G - R1006 - General Learning Space - (52.79 SQM) - Teaching Space: 1	● Student Space (24)	
B00G - R1009 - Movement - (62.38 SQM)	Not Applicable	Circulation or storage space.
B00G - R1010 - Movement - (9.29 SQM)	Not Applicable	Circulation or storage space.
B00H - R0002 - Canteen - (46.71 SQM)	Not Applicable	Circulation or storage space.
B00H - R0004 - Movement - (87.76 SQM)	Not Applicable	Circulation or storage space.
B00H - R0006 - Movement - (43.49 SQM)	Not Applicable	Circulation or storage space.
B00I - R0001 - Movement - (183.38 SQM)	Not Applicable	Circulation or storage space.
B00I - R0004 - Staff Room Annexe - (25.77 SQM)	● Office (6)	
B00I - R0017 - Staff Room - (11.75 SQM)	● Office (2)	
B00I - R0018 - Staff Room Annexe - (14.68 SQM)	● Office (3)	
B00I - R0028 - Deputy Principal - Type 1 - (25.77 SQM)	● Office (6)	
B00I - R0030 - Workshop Area - (112.22 SQM)	● Student Space (52)	
B00I - R0031 - Seminar - (58.62 SQM)	● Office (14)	
B00I - R0032 - Design/Technology L.S. - (44.55 SQM) - Teaching Space: 1	● Student Space (20)	
B00I - R0033 - Interview - (6.81 SQM)	● Office (1)	
B00I - R0034 - Movement - (28.28 SQM)	Not Applicable	Circulation or storage space.
B00I - R0037 - Seminar - (32.18 SQM)	● Office (8)	
B00I - R0038 - Food Technology L.S. - (79.35 SQM) - Teaching Space: 1	● Student Space (36)	
B00I - R0039 - Preparation - (18.39 SQM)	Not Applicable	Circulation or storage space.
B00T - R0001 - Growing/Breeding - (52.33 SQM)	Not Applicable	Circulation or storage space.