

# VENTILATION AUDIT REPORT

<b>SCHOOL:</b>	<b>Austinmer Public School (1076)</b>
<b>AMU REGION:</b>	<b>Southern NSW</b>
<b>STATE ELECTORATE:</b>	<b>Keira</b>
<b>LOCAL GOVERNMENT AREA:</b>	<b>Wollongong</b>

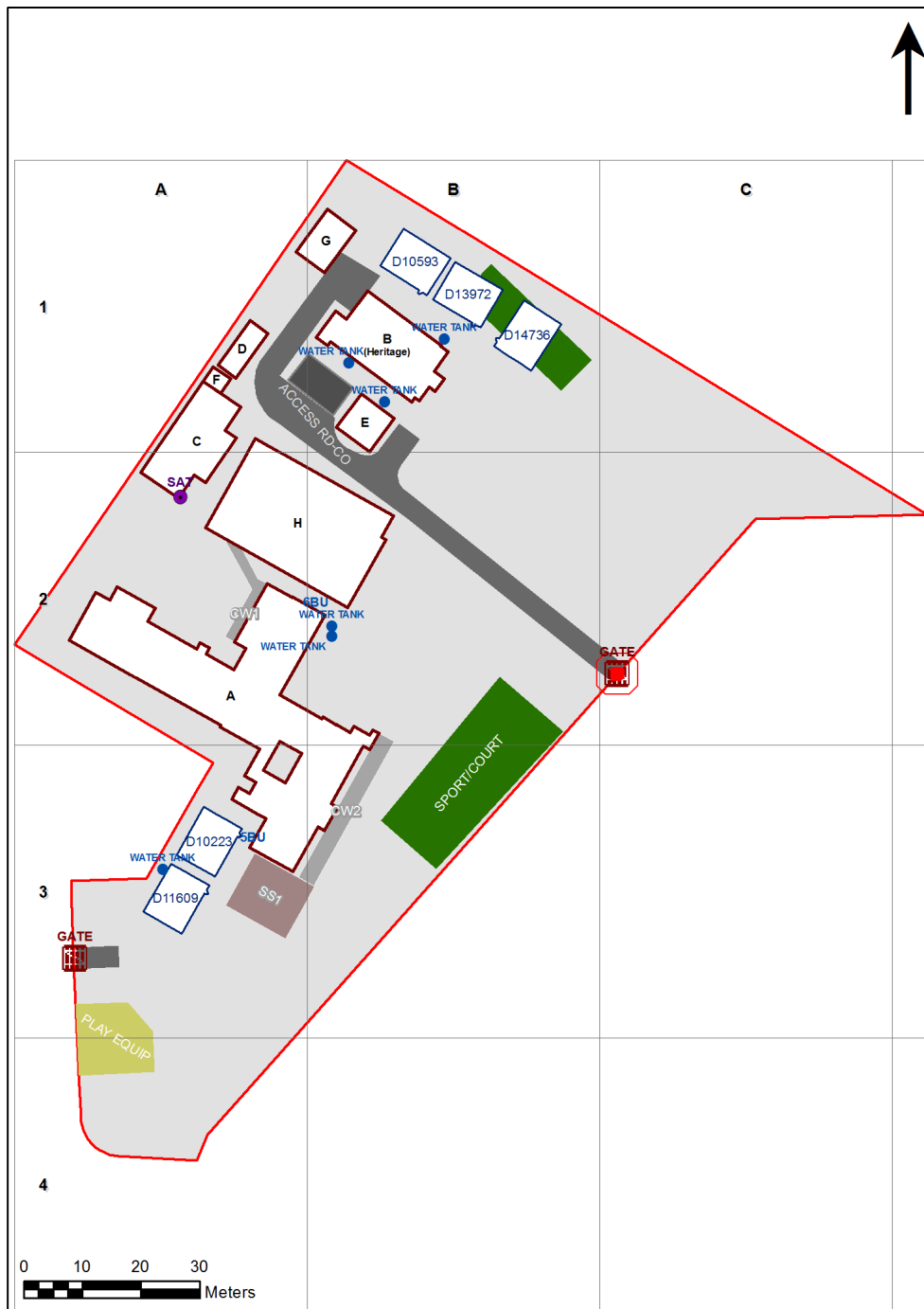

1076 - Austinmer Public School  
Site Plan (10195)



1:811

Printed: 20-Mar-2020

## Ventilation Audit Key

Category	Description
	Category A Operate this space in line with <a href="#">COVID safe school operations</a> . It has the required level of natural ventilation. NB. Circulation and storage areas should not be used for groups or gatherings.
	Category B This space should be occupied at 1 person per 4m <sup>2</sup> to comply with <a href="#">COVID safe school operations and the guided use of spaces</a> . The report details the number of people who can be accommodated safely in each of the identified spaces.

Entity Location	Audit Condition Classification (Capacity)	Comment
B00A - R0001 - Home Base - (42.73 SQM) - Teaching Space: 1	● Student Space (19)	
B00A - R0005 - Withdrawal Space - 1hb - (11.07 SQM)	● Student Space (5)	
B00A - R0006 - Movement - (28.92 SQM)	Not Applicable	Circulation or storage space.
B00A - R0008 - Withdrawal Space - 1hb - (42.38 SQM)	● Student Space (19)	
B00A - R0009 - Movement - (26.07 SQM)	Not Applicable	Circulation or storage space.
B00A - R0011 - Reading Area - (93.62 SQM)	● Student Space (43)	
B00A - R0015 - Movement - (8.01 SQM)	Not Applicable	Circulation or storage space.
B00A - R0016 - Movement - (25.13 SQM)	Not Applicable	Circulation or storage space.
B00A - R0018 - Home Base - (48.27 SQM) - Teaching Space: 1	● Student Space (22)	
B00A - R0019 - Movement - (32.87 SQM)	Not Applicable	Circulation or storage space.
B00A - R0020 - Home Base - (52.3 SQM) - Teaching Space: 1	● Student Space (24)	
B00A - R0024 - Practical Activities - 1hb - (5.42 SQM)	● Student Space (2)	
B00A - R0026 - Home Base - (50.43 SQM) - Teaching Space: 1	● Student Space (23)	
B00A - R0027 - Home Base - (65.94 SQM) - Teaching Space: 1	● Student Space (30)	
B00A - R0030 - Withdrawal Space - 1hb - (7.26 SQM)	● Student Space (3)	
B00A - R0031 - Practical Activities - 1hb - (6.15 SQM)	● Student Space (2)	
B00A - R0034 - Movement - (18.24 SQM)	Not Applicable	Circulation or storage space.
B00A - R9001 - Home Base - (63.37 SQM) - Teaching Space: 1	● Student Space (29)	
B00A - R9002 - Practical Activities - 1hb - (5.57 SQM)	● Student Space (2)	
B00A - R9003 - Movement - (22.88 SQM)	Not Applicable	Circulation or storage space.
B00A - R9006 - Home Base - (57.74 SQM) - Teaching Space: 1	● Student Space (26)	
B00A - R9012 - Movement - (5.3 SQM)	Not Applicable	Circulation or storage space.
B00B - R0001 - Entry Vestibule - (8.56 SQM)	Not Applicable	Circulation or storage space.
B00B - R0002 - Movement - (5.48 SQM)	Not Applicable	Circulation or storage space.
B00B - R0003 - Principal - (19.07 SQM)	● Office (4)	
B00B - R0005 - Clerical Office - (17.73 SQM)	● Office (4)	
B00B - R0006 - Deputy Principal - (15.44 SQM)	● Office (3)	
B00B - R0007 - Clerical Office/Workroom - (23.2 SQM)	● Office (5)	
B00B - R0009 - Sick Bay - (9.59 SQM)	● Student Space (4)	
B00B - R0010 - Staff Room - (28.05 SQM)	● Office (7)	
B00B - R0012 - Staff Kitchen - (14.36 SQM)	● Office (3)	
B00C - R0001 - Communal Space - (61.78 SQM)	● Student Space (28)	
B00C - R0003 - Movement - (20.79 SQM)	Not Applicable	Circulation or storage space.
B00D - R0001 - Withdrawal Space - 1hb - (31.86 SQM)	● Student Space (14)	
B00E - R0001 - Canteen - (22.56 SQM)	Not Applicable	Circulation or storage space.
B00E - R0004 - Movement - (13.15 SQM)	Not Applicable	Circulation or storage space.
B00H - R0001 - Communal Space - (145.09 SQM)	● Student Space (67)	
B00H - R0002 - Raised Platform - (60.8 SQM)	Not Applicable	Circulation or storage space.
B00H - R0016 - Movement - (7.51 SQM)	Not Applicable	Circulation or storage space.
B00H - R0017 - Movement - (12 SQM)	Not Applicable	Circulation or storage space.
OS 602 10593 - OS 602 10593 - Learning Unit - Standard With P.A.A. - (76 SQM)	● Student Space (35)	
OS 602 11609 - OS 602 11609 - Learning Unit - Standard With P.A.A. - (76 SQM)	● Student Space (35)	
OS 602 13972 - OS 602 13972 - Learning Unit - Standard With P.A.A. - (76 SQM)	● Student Space (35)	
OS 602 14736 - OS 602 14736 - Learning Unit - Standard With P.A.A. - (76 SQM)	● Student Space (35)	
OS 603 10223 - OS 603 10223 - Learning Unit - Standard With P.A.A. A/C - (76 SQM)	● Student Space (35)	