

VENTILATION AUDIT REPORT

SCHOOL:	Asquith Boys High School (8245)
AMU REGION:	Northern Sydney
STATE ELECTORATE:	Hornsby
LOCAL GOVERNMENT AREA:	Hornsby

8245 - Asquith Boys High School
Site Plan (11361)

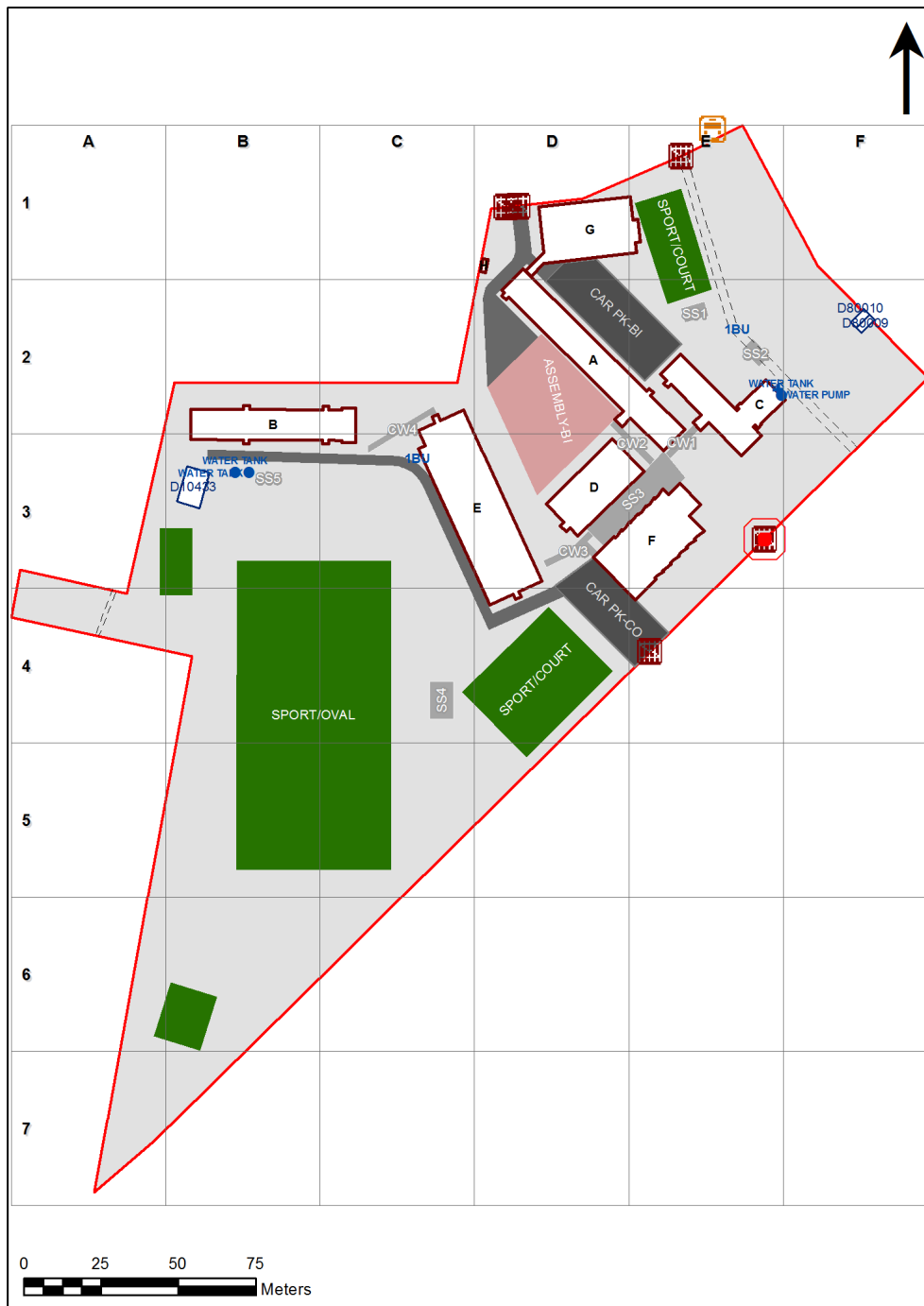

1:1,535



Printed: 21-Mar-2020

Ventilation Audit Key

Category	Description
	Category A Operate this space in line with COVID safe school operations . It has the required level of natural ventilation. NB. Circulation and storage areas should not be used for groups or gatherings.
	Category B This space should be occupied at 1 person per 4m ² to comply with COVID safe school operations and the guided use of spaces . The report details the number of people who can be accommodated safely in each of the identified spaces.

Entity Location	Audit Condition Classification (Capacity)	Comment
B00A - M0001 - Movement - (7.75 SQM)	Not Applicable	Circulation or storage space.
B00A - R0001 - Laboratory L.S. - (93.58 SQM) - Teaching Space: 1	● Student Space (43)	
B00A - R0002 - Preparation - Science - (21.2 SQM)	Not Applicable	Circulation or storage space.
B00A - R0005 - Tiered Learning Area - (55.68 SQM)	● Student Space (25)	
B00A - R0011 - Staff Study - (52.01 SQM)	○ Office (13)	
B00A - R0016 - Movement - (129.96 SQM)	Not Applicable	Circulation or storage space.
B00A - R0024 - Preparation - (87.3 SQM)	Not Applicable	Circulation or storage space.
B00A - R0025 - Preparation - (87.66 SQM)	Not Applicable	Circulation or storage space.
B00A - R0026 - Preparation - (27.16 SQM)	Not Applicable	Circulation or storage space.
B00A - R1001 - General Learning Space - (69.1 SQM) - Teaching Space: 1	● Student Space (32)	
B00A - R1002 - General Learning Space - (55.84 SQM) - Teaching Space: 1	● Student Space (25)	
B00A - R1009 - Computer Learning Space - (55.53 SQM) - Teaching Space: 1	● Student Space (25)	
B00A - R1011 - General Learning Space - (55.99 SQM) - Teaching Space: 1	● Student Space (25)	
B00A - R1013 - General Learning Space - (79.98 SQM) - Teaching Space: 1	● Student Space (37)	
B00A - R1014 - General Learning Space - (55.99 SQM) - Teaching Space: 1	● Student Space (25)	
B00A - R1015 - Computer Learning Space - (55.74 SQM) - Teaching Space: 1	● Student Space (25)	
B00A - R1019 - Movement - (122.89 SQM)	Not Applicable	Circulation or storage space.
B00A - R1020 - Staff Study - (27.05 SQM)	○ Office (6)	
B00A - R1022 - Staff Study - (23.05 SQM)	○ Office (5)	
B00B - R0006 - Metal Technology L.S. - (75.71 SQM) - Teaching Space: 1	● Student Space (35)	
B00B - R0015 - Movement - (10.13 SQM)	Not Applicable	Circulation or storage space.
B00B - R0016 - Movement - (10.96 SQM)	Not Applicable	Circulation or storage space.
B00B - R0017 - Workshop - (37.78 SQM)	● Student Space (17)	
B00B - R0018 - Staff Kitchen - (5.52 SQM)	○ Office (1)	
B00B - R0019 - Staff Study - (24.9 SQM)	○ Office (6)	
B00B - R0021 - Metal Technology L.S. - (75.09 SQM) - Teaching Space: 1	● Student Space (34)	
B00B - R0022 - Welding Area - (7.19 SQM)	Not Applicable	Circulation or storage space.
B00B - R0024 - Food Technology L.S. - (80.43 SQM) - Teaching Space: 1	● Student Space (37)	
B00B - R0025 - Preparation - Materials - (11.76 SQM)	Not Applicable	Circulation or storage space.
B00B - R0027 - Seminar - (32.16 SQM)	○ Office (8)	
B00B - R1006 - Wood Technology L.S. - (86.15 SQM) - Teaching Space: 1	● Student Space (39)	
B00B - R1013 - Metal Technology L.S. - (83.17 SQM) - Teaching Space: 1	● Student Space (38)	
B00B - R1016 - Movement - (10.92 SQM)	Not Applicable	Circulation or storage space.
B00B - R1017 - Wood Technology L.S. - (85.47 SQM) - Teaching Space: 1	● Student Space (39)	
B00B - R1018 - Movement - (17.73 SQM)	Not Applicable	Circulation or storage space.
B00C - R0001 - Tea Room - (15.1 SQM)	Not Applicable	Circulation or storage space.
B00C - R0002 - Interview/Office - Type 1 - (14.46 SQM)	○ Office (3)	
B00C - R0003 - Principal Office - (20.58 SQM)	○ Office (5)	
B00C - R0007 - Administration - Clerical - (18.3 SQM)	○ Office (4)	
B00C - R0013 - Movement - (12.1 SQM)	Not Applicable	Circulation or storage space.
B00C - R0014 - Computer Learning Space - (51.07 SQM) - Teaching Space: 1	● Student Space (23)	
B00C - R0015 - Administration - Clerical - (14.33 SQM)	○ Office (3)	
B00C - R0016 - Deputy Principal Office - (14.79 SQM)	○ Office (3)	
B00C - R0017 - Clinic - Boys - (14.63 SQM)	○ Office (3)	
B00C - R0020 - Administration - Executive - (20.22 SQM)	○ Office (5)	
B00C - R0021 - Administration - Clerical - (26.84 SQM)	○ Office (6)	
B00C - R0026 - Administration - Clerical - (14.42 SQM)	○ Office (3)	
B00C - R0027 - Public Reception - (76.42 SQM)	Not Applicable	Circulation or storage space.
B00D - R0004 - Student Canteen - (49.83 SQM)	Not Applicable	Circulation or storage space.

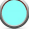
Entity Location	Audit Condition Classification (Capacity)	Comment
B00D - R0015 - General Assistants - (6.84 SQM)	Office (1)	
B00E - R0003 - Staff Study - (25.37 SQM)	Office (6)	
B00E - R0004 - General Learning Space - (52.87 SQM) - Teaching Space: 1	Student Space (24)	
B00E - R0006 - General Learning Space - (52.8 SQM) - Teaching Space: 1	Student Space (24)	
B00E - R0008 - Fitness Laboratory - (52.59 SQM)	Student Space (24)	
B00E - R0009 - Fitness Laboratory - (5.93 SQM)	Student Space (2)	
B00E - R0010 - Main Area - (294.26 SQM)	Not Applicable	Circulation or storage space.
B00E - R0014 - Movement - (23.91 SQM)	Not Applicable	Circulation or storage space.
B00E - R0017 - Interview/Meeting - (34.96 SQM)	Office (8)	
B00E - R0022 - Movement - (26.68 SQM)	Not Applicable	Circulation or storage space.
B00E - R0024 - Computer Learning Space - (39.43 SQM) - Teaching Space: 1	Student Space (18)	
B00E - R0029 - Movement - (81.52 SQM)	Not Applicable	Circulation or storage space.
B00E - R0033 - Art Learning Space - (63.66 SQM) - Teaching Space: 1	Student Space (29)	
B00E - R1001 - Staff Study - (38.66 SQM)	Office (9)	
B00E - R1002 - General Learning Space - (39.29 SQM) - Teaching Space: 1	Student Space (18)	
B00E - R1003 - General Learning Space - (52.8 SQM) - Teaching Space: 1	Student Space (24)	
B00E - R1004 - General Learning Space - (51.93 SQM) - Teaching Space: 1	Student Space (24)	
B00E - R1005 - General Learning Space - (52.5 SQM) - Teaching Space: 1	Student Space (24)	
B00E - R1008 - General Learning Space - (52.58 SQM) - Teaching Space: 1	Student Space (24)	
B00E - R1009 - General Learning Space - (65.38 SQM) - Teaching Space: 1	Student Space (30)	
B00E - R1015 - General Learning Space - (52.8 SQM) - Teaching Space: 1	Student Space (24)	
B00E - R1016 - General Learning Space - (52 SQM) - Teaching Space: 1	Student Space (24)	
B00E - R1018 - Staff Study - (52.66 SQM)	Office (13)	
B00E - R1021 - General Learning Space - (52.73 SQM) - Teaching Space: 1	Student Space (24)	
B00E - R1022 - General Learning Space - (53.17 SQM) - Teaching Space: 1	Student Space (24)	
B00E - R1023 - General Learning Space - (65.75 SQM) - Teaching Space: 1	Student Space (30)	
B00E - R1025 - Movement - (187.85 SQM)	Not Applicable	Circulation or storage space.
B00F - M0007 - Movement - (7.5 SQM)	Not Applicable	Circulation or storage space.
B00F - R0001 - Entry - (7.23 SQM)	Not Applicable	Circulation or storage space.
B00F - R0002 - Staff Kitchen - (9.85 SQM)	Office (2)	
B00F - R0003 - Multi-Purpose Space - (379.56 SQM)	Student Space (176)	
B00F - R0004 - Stage - (122.56 SQM)	Not Applicable	Circulation or storage space.
B00G - M0001 - Movement - (30.27 SQM)	Not Applicable	Circulation or storage space.
B00G - R0006 - Performance Workspace - (53.9 SQM) - Teaching Space: 1	Student Space (25)	
B00G - R0009 - Commonroom - (66.31 SQM)	Office (16)	
B00G - R0010 - Staff Kitchen - (12.78 SQM)	Office (3)	
B00G - R0021 - Staff Study - (25.63 SQM)	Office (6)	
B00G - R0024 - Preparation - (85.05 SQM)	Not Applicable	Circulation or storage space.
B00G - R0025 - Preparation - (37.86 SQM)	Not Applicable	Circulation or storage space.
B00G - R0026 - Preparation - (85.83 SQM)	Not Applicable	Circulation or storage space.
B00G - R0027 - Movement - (88.8 SQM)	Not Applicable	Circulation or storage space.
B00G - R1001 - Music Learning Space - (65.47 SQM) - Teaching Space: 1	Student Space (30)	
B00G - R1003 - Art Learning Space - (66.29 SQM) - Teaching Space: 1	Student Space (30)	
B00G - R1005 - Visual Arts Workshop - (25.15 SQM)	Student Space (11)	
B00G - R1007 - Dark Room - (6.16 SQM)	Office (1)	
B00G - R1015 - Movement - (77.26 SQM)	Not Applicable	Circulation or storage space.
B00G - R1020 - Photographic Studio - (22.78 SQM)	Office (5)	
B00G - R1021 - Art Learning Space - (104.37 SQM) - Teaching Space: 1	Student Space (48)	
B00G - R1023 - Performance Workshop - (25.81 SQM)	Student Space (11)	

Entity Location	Audit Condition Classification (Capacity)	Comment
B00G - R1024 - Seminar - (26.84 SQM)	 Office (6)	
OS 710 10433 - OS 710 10433 - Home Science/Pantry/Laundry - (95 SQM)	 Office (23)	