

VENTILATION AUDIT REPORT

SCHOOL:	Arthur Phillip High School (8892)
AMU REGION:	Western Sydney
STATE ELECTORATE:	Parramatta
LOCAL GOVERNMENT AREA:	Parramatta

8892 - Arthur Phillip High School
Site Plan (12065)

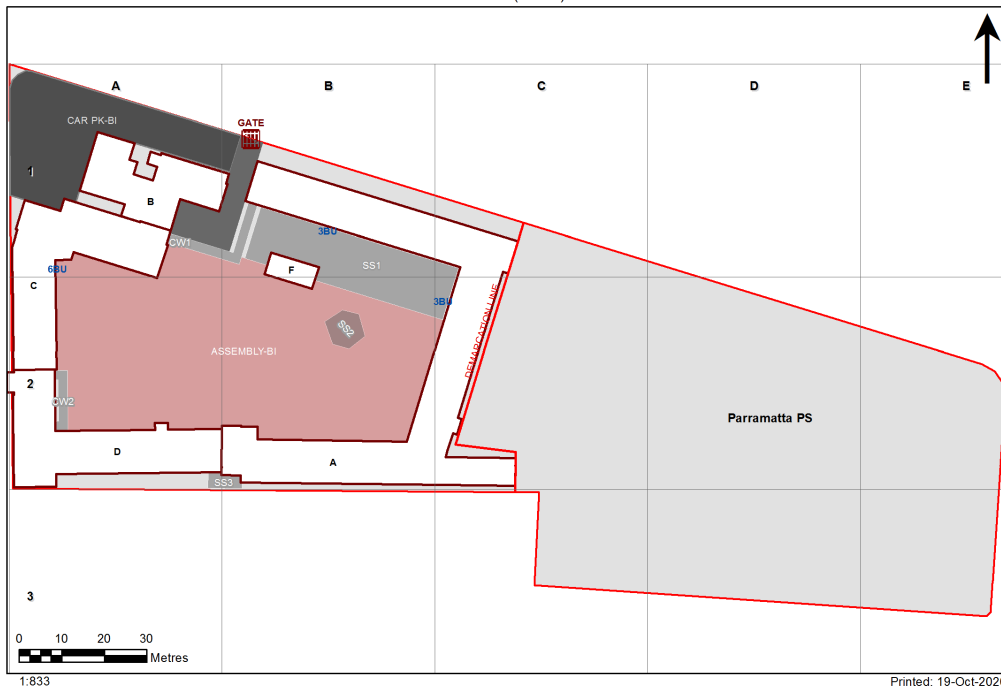

1:833

Printed: 19-Oct-2020

Ventilation Audit Key

Category	Description
	Category A Operate this space in line with COVID safe school operations . It has the required level of natural ventilation. NB. Circulation and storage areas should not be used for groups or gatherings.
	Category B This space should be occupied at 1 person per 4m ² to comply with COVID safe school operations and the guided use of spaces . The report details the number of people who can be accommodated safely in each of the identified spaces.

Entity Location	Audit Condition Classification (Capacity)	Comment
A - 1.12 - Design L.S. - (56.24 SQM) - Teaching Space: 1	● Student Space (26)	
A - 1.13 - Art Learning Space - (55.79 SQM) - Teaching Space: 1	● Student Space (25)	
A - 1.16 - Staff Study - (11.35 SQM)	○ Office (2)	
A - 1.20 - Staff Study - (24.24 SQM)	○ Office (6)	
A - 1.22 - Laboratory L.S. - (91.68 SQM) - Teaching Space: 1	● Student Space (42)	
A - 1.24 - Preparation - (28.52 SQM)	Not Applicable	Circulation or storage space.
A - 1.25 - Laboratory L.S. - (95.2 SQM) - Teaching Space: 1	● Student Space (44)	
A - 1.26 - Special Learning Space - (25.98 SQM) - Teaching Space: 1	● Student Space (12)	
A - 1.30 - Movement - (13.52 SQM)	Not Applicable	Circulation or storage space.
A - 1.31 - Staff Study - (51.55 SQM)	○ Office (12)	
A - 1.32 - General Learning Space - (66.13 SQM) - Teaching Space: 1	● Student Space (30)	
A - 1.33 - General Learning Space - (52.36 SQM) - Teaching Space: 1	● Student Space (24)	
A - 1.34 - General Learning Space - (52.37 SQM) - Teaching Space: 1	● Student Space (24)	
A - 1.36 - Staff Study - (14.02 SQM)	○ Office (3)	
A - 1.39 - Movement - (288.97 SQM)	Not Applicable	Circulation or storage space.
A - 1.4 - Materials Technology L.S. - (86.28 SQM) - Teaching Space: 1	● Student Space (40)	
A - 1.41 - Movement - (10.08 SQM)	Not Applicable	Circulation or storage space.
A - 1.6 - Wood Technology Bay - (16.3 SQM)	Not Applicable	Circulation or storage space.
A - 1.8 - Materials Technology L.S. - (78.97 SQM) - Teaching Space: 1	● Student Space (36)	
A - 1.9 - Staff Study - (20.48 SQM)	○ Office (5)	
A - 2.11 - General Learning Space - (50.46 SQM) - Teaching Space: 1	● Student Space (23)	
A - 2.12 - General Learning Space - (53.67 SQM) - Teaching Space: 1	● Student Space (24)	
A - 2.13 - General Learning Space - (50.59 SQM) - Teaching Space: 1	● Student Space (23)	
A - 2.15 - Clinic - Girls - (11.5 SQM)	○ Office (2)	
A - 2.19 - Staff Study - (24.38 SQM)	○ Office (6)	
A - 2.21 - Laboratory L.S. - (91.53 SQM) - Teaching Space: 1	● Student Space (42)	
A - 2.22 - Preparation - (28.52 SQM)	Not Applicable	Circulation or storage space.
A - 2.24 - Laboratory L.S. - (95.2 SQM) - Teaching Space: 1	● Student Space (44)	
A - 2.25 - Special Learning Space - (25.49 SQM) - Teaching Space: 1	● Student Space (11)	
A - 2.30 - Audio Visual Workroom - (27.75 SQM)	● Student Space (12)	
A - 2.31 - Workroom - (28.62 SQM)	○ Office (7)	
A - 2.33 - Main Area - (248.87 SQM)	Not Applicable	Circulation or storage space.
A - 2.34 - Seminar - (10.49 SQM)	○ Office (2)	
A - 2.35 - Seminar - (10.43 SQM)	○ Office (2)	
A - 2.36 - Seminar - (12.11 SQM)	○ Office (3)	
A - 2.37 - Movement - (8.97 SQM)	Not Applicable	Circulation or storage space.
A - 2.39 - Movement - (224.11 SQM)	Not Applicable	Circulation or storage space.
A - 2.4 - Music Learning Space - (26.4 SQM) - Teaching Space: 1	● Student Space (12)	
A - 2.5 - Music Learning Space - (59.4 SQM) - Teaching Space: 1	● Student Space (27)	
A - 2.7 - Music Learning Space - (59.11 SQM) - Teaching Space: 1	● Student Space (27)	
A - 2.8 - General Learning Space - (53.75 SQM) - Teaching Space: 1	● Student Space (24)	
A - G.10 - Materials Technology L.S. - (99.8 SQM) - Teaching Space: 1	● Student Space (46)	
A - G.12 - Movement - (146.37 SQM)	Not Applicable	Circulation or storage space.
A - G.16 - Design L.S. - (66.29 SQM) - Teaching Space: 1	● Student Space (30)	
A - G.20 - Interview/Meeting - (11.42 SQM)	○ Office (2)	
A - G.36 - Movement - (197.66 SQM)	Not Applicable	Circulation or storage space.
A - G.4 - Movement - (28.46 SQM)	Not Applicable	Circulation or storage space.
A - G.41 - Movement - (16.94 SQM)	Not Applicable	Circulation or storage space.

Entity Location	Audit Condition Classification (Capacity)	Comment
A - G.48 - General Assistants - (33.28 SQM)	Office (8)	
A - G.49 - Clinic - Boys - (9.06 SQM)	Office (2)	
A - G.5 - Design L.S. - (105.2 SQM) - Teaching Space: 1	Student Space (48)	
A - G.50 - Movement - (9.31 SQM)	Not Applicable	Circulation or storage space.
A - G.51 - Food Technology L.S. - (74.02 SQM) - Teaching Space: 1	Student Space (34)	
A - G.52 - Preparation - (7.51 SQM)	Not Applicable	Circulation or storage space.
A - G.53 - Staff Study - (51.79 SQM)	Office (12)	
A - G.54 - Food Technology L.S. - (90.67 SQM) - Teaching Space: 1	Student Space (42)	
A - G.56 - Preparation - (12.86 SQM)	Not Applicable	Circulation or storage space.
A - G.58 - General Learning Space - (16.81 SQM) - Teaching Space: 1	Student Space (7)	
A - G.6 - Metal Technology Bay - (23.51 SQM)	Not Applicable	Circulation or storage space.
A - G.7 - Metal Technology Bay - (14.39 SQM)	Not Applicable	Circulation or storage space.
A - G.9 - Welding Area - (7.8 SQM)	Not Applicable	Circulation or storage space.
B - G.12 - Movement - (16.33 SQM)	Not Applicable	Circulation or storage space.
B - G.2 - General Learning Space - (53.73 SQM) - Teaching Space: 1	Student Space (24)	
B - G.3 - Commonroom - (109.54 SQM)	Office (27)	
B - G.5 - Principal Office - (21.08 SQM)	Office (5)	
B - G.7 - Movement - (18.86 SQM)	Not Applicable	Circulation or storage space.
B - G.8 - Movement - (17.93 SQM)	Not Applicable	Circulation or storage space.
B - G.9 - Administration - Clerical - (54.48 SQM)	Office (13)	
C - 1.1 - Movement - (18.66 SQM)	Not Applicable	Circulation or storage space.
C - 1.10 - General Learning Space - (48.41 SQM) - Teaching Space: 1	Student Space (22)	
C - 1.11 - General Learning Space - (48.98 SQM) - Teaching Space: 1	Student Space (22)	
C - 1.12 - General Learning Space - (48.59 SQM) - Teaching Space: 1	Student Space (22)	
C - 1.13 - Movement - (118.43 SQM)	Not Applicable	Circulation or storage space.
C - 1.2 - Movement - (52.67 SQM)	Not Applicable	Circulation or storage space.
C - 1.3 - General Learning Space - (49.93 SQM) - Teaching Space: 1	Student Space (23)	
C - 1.4 - General Learning Space - (49.68 SQM) - Teaching Space: 1	Student Space (23)	
C - 1.5 - General Learning Space - (49.41 SQM) - Teaching Space: 1	Student Space (22)	
C - 1.6 - Movement - (5.88 SQM)	Not Applicable	Circulation or storage space.
C - 1.7 - Staff Study - (52.63 SQM)	Office (13)	
C - 1.8 - Staff Study - (15.23 SQM)	Office (3)	
C - G.1 - Movement - (18.38 SQM)	Not Applicable	Circulation or storage space.
C - G.10 - Performance Workshop - (51.76 SQM)	Student Space (24)	
C - G.11 - Interview/Meeting - (15.09 SQM)	Office (3)	
C - G.13 - Administration - Clerical - (8.23 SQM)	Office (2)	
C - G.14 - Movement - (118.2 SQM)	Not Applicable	Circulation or storage space.
C - G.15 - General Learning Space - (47.3 SQM) - Teaching Space: 1	Student Space (21)	
C - G.16 - General Learning Space - (47.49 SQM) - Teaching Space: 1	Student Space (22)	
C - G.17 - General Learning Space - (47.24 SQM) - Teaching Space: 1	Student Space (21)	
C - G.2 - Movement - (52.77 SQM)	Not Applicable	Circulation or storage space.
C - G.3 - Deputy Principal Office - (23.58 SQM)	Office (5)	
C - G.5 - Leading Teacher - (20.32 SQM)	Office (5)	
C - G.6 - General Learning Space - (47.48 SQM) - Teaching Space: 1	Student Space (22)	
C - G.7 - General Learning Space - (47.8 SQM) - Teaching Space: 1	Student Space (22)	
D - 1.1 - Movement - (34.15 SQM)	Not Applicable	Circulation or storage space.
D - 1.10 - General Learning Space - (57.38 SQM) - Teaching Space: 1	Student Space (26)	
D - 1.11 - General Learning Space - (54.56 SQM) - Teaching Space: 1	Student Space (25)	
D - 1.12 - Staff Study - (31.69 SQM)	Office (7)	
D - 1.13 - Movement - (106.51 SQM)	Not Applicable	Circulation or storage space.

Entity Location	Audit Condition Classification (Capacity)	Comment
D - 1.3 - Computer Learning Space - (95.11 SQM) - Teaching Space: 1	Student Space (44)	
D - 1.4 - Staff Study - (17.13 SQM)	Office (4)	
D - 1.6 - Computer Learning Space - (51.02 SQM) - Teaching Space: 1	Student Space (23)	
D - 1.8 - Senior Study - (26.73 SQM)	Office (6)	
D - 1.9 - Computer Learning Space - (55.6 SQM) - Teaching Space: 1	Student Space (25)	
D - G.1 - Movement - (42.1 SQM)	Not Applicable	Circulation or storage space.
D - G.10 - Interview/Meeting - (18.22 SQM)	Office (4)	
D - G.11 - Special Learning Space - (8.61 SQM) - Teaching Space: 1	Student Space (3)	
D - G.12 - Staff Study - (27.39 SQM)	Office (6)	
D - G.15 - Art Learning Space - (70.17 SQM) - Teaching Space: 1	Student Space (32)	
D - G.17 - Art Learning Space - (55.96 SQM) - Teaching Space: 1	Student Space (25)	
D - G.18 - Darkroom Space - (19.9 SQM)	Office (4)	
D - G.20 - Movement - (117.51 SQM)	Not Applicable	Circulation or storage space.
D - G.21 - Movement - (7.46 SQM)	Not Applicable	Circulation or storage space.
D - G.4 - Laboratory L.S. - (96.04 SQM) - Teaching Space: 1	Student Space (44)	
D - G.5 - Preparation - (25.84 SQM)	Not Applicable	Circulation or storage space.
D - G.6 - General Learning Space - (51.08 SQM) - Teaching Space: 1	Student Space (23)	
DS 615 18155 - DS 615 18155 - Learning Unit - Quad with PAA 2 Storey - (304 SQM)	Student Space (141)	
DS 615 18229 - DS 615 18229 - Learning Unit - Quad with PAA 2 Storey - (304 SQM)	Student Space (141)	
DS 615 18230 - DS 615 18230 - Learning Unit - Quad with PAA 2 Storey - (304 SQM)	Student Space (141)	
DS 615 18232 - DS 615 18232 - Learning Unit - Quad with PAA 2 Storey - (304 SQM)	Student Space (141)	
F - G.1 - Student Canteen - (43.24 SQM)	Not Applicable	Circulation or storage space.
G - 1.10 - Interview/Meeting - (11.5 SQM)	Office (2)	
G - 1.11 - Interview/Meeting - (11.5 SQM)	Office (2)	
G - 1.12 - Interview/Meeting - (11.5 SQM)	Office (2)	
G - 1.19 - Staff Study - (89.12 SQM)	Office (22)	
G - 1.2 - Staff Kitchen - (10.57 SQM)	Office (2)	
G - 1.28 - Kitchen - Type 1 - (22.47 SQM)	Student Space (10)	
G - 1.3 - Movement - (59.01 SQM)	Not Applicable	Circulation or storage space.
G - 1.7 - Staff Lounge - (316.37 SQM)	Office (79)	
G - 1.8 - Interview/Meeting - (11.62 SQM)	Office (2)	
G - 1.9 - Interview/Meeting - (11.5 SQM)	Office (2)	
G - G.28 - Student Canteen - (92.72 SQM)	Not Applicable	Circulation or storage space.
G - G.29 - Movement - (141.18 SQM)	Not Applicable	Circulation or storage space.
G - G.30 - Movement - (11.54 SQM)	Not Applicable	Circulation or storage space.
G - G.34 - Audio Visual Workroom - (6.08 SQM)	Student Space (2)	
G - G.36 - Gymnasium - (1314.9 SQM)	Student Space (610)	
G - G.38 - Fitness Laboratory - (96.16 SQM)	Student Space (44)	
G - G.48 - Movement - (10.53 SQM)	Not Applicable	Circulation or storage space.
G - G.50 - Movement - (11.47 SQM)	Not Applicable	Circulation or storage space.
G - LG1.1 - Student Canteen - (66.67 SQM)	Not Applicable	Circulation or storage space.
G - LG1.19 - Movement - (22.68 SQM)	Not Applicable	Circulation or storage space.
G - LG1.22 - Movement - (6.04 SQM)	Not Applicable	Circulation or storage space.
G - LG1.23 - Movement - (82.6 SQM)	Not Applicable	Circulation or storage space.
H - 1.12 - Kitchen - Type 1 - (10.83 SQM)	Student Space (5)	
H - 1.13 - Food/Research Space - (163.47 SQM)	Not Applicable	Circulation or storage space.
H - 1.14 - Food/Research Space - (143.07 SQM)	Not Applicable	Circulation or storage space.
H - 1.15 - Food/Research Space - (196.37 SQM)	Not Applicable	Circulation or storage space.
H - 1.17 - Design/Technology L.S. - (105.26 SQM) - Teaching Space: 1	Student Space (48)	
H - 1.18 - Design/Technology L.S. - (60.55 SQM) - Teaching Space: 1	Student Space (28)	

Entity Location	Audit Condition Classification (Capacity)	Comment
H - 1.19 - Design/Technology L.S. - (106.76 SQM) - Teaching Space: 1	● Student Space (49)	
H - 1.27 - Movement - (18.77 SQM)	Not Applicable	Circulation or storage space.
H - 1.31 - Movement - (6.18 SQM)	Not Applicable	Circulation or storage space.
H - 1.34 - Movement - (5.99 SQM)	Not Applicable	Circulation or storage space.
H - 1.37 - Movement - (6.18 SQM)	Not Applicable	Circulation or storage space.
H - 1.40 - Movement - (5.99 SQM)	Not Applicable	Circulation or storage space.
H - 1.43 - Movement - (8.61 SQM)	Not Applicable	Circulation or storage space.
H - 1.44 - Movement - (7.33 SQM)	Not Applicable	Circulation or storage space.
H - 10.2 - Movement - (5.17 SQM)	Not Applicable	Circulation or storage space.
H - 2.10 - General Learning Space X4 - (575.18 SQM) - Teaching Space: 4	● Student Space (266)	
H - 2.11 - Staff Lounge - (100.94 SQM)	● Office (25)	
H - 2.12 - General Learning Space - (71.4 SQM) - Teaching Space: 1	● Student Space (33)	
H - 2.13 - Practical Activities - (66.65 SQM)	● Student Space (30)	
H - 2.14 - General Learning Space - (66.53 SQM) - Teaching Space: 1	● Student Space (30)	
H - 2.15 - Practical Activities - (71.36 SQM)	● Student Space (33)	
H - 2.16 - Music Learning Space - (74.24 SQM) - Teaching Space: 1	● Student Space (34)	
H - 2.17 - Isolation Space - (6.9 SQM)	● Office (1)	
H - 2.18 - Isolation Space - (6.21 SQM)	● Office (1)	
H - 2.19 - Isolation Space - (6.12 SQM)	● Office (1)	
H - 2.20 - Isolation Space - (22.22 SQM)	● Office (5)	
H - 2.26 - Tiered Learning Area - (26.07 SQM)	● Student Space (12)	
H - 2.29 - Movement - (27.83 SQM)	Not Applicable	Circulation or storage space.
H - 2.30 - Movement - (17.71 SQM)	Not Applicable	Circulation or storage space.
H - 2.31 - Movement - (6.16 SQM)	Not Applicable	Circulation or storage space.
H - 2.34 - Movement - (5.87 SQM)	Not Applicable	Circulation or storage space.
H - 2.37 - Movement - (6.21 SQM)	Not Applicable	Circulation or storage space.
H - 2.40 - Movement - (6.02 SQM)	Not Applicable	Circulation or storage space.
H - 3.10 - General Learning Space X4 - (583.14 SQM) - Teaching Space: 4	● Student Space (270)	
H - 3.11 - Staff Study - (104.14 SQM)	● Office (26)	
H - 3.12 - Practical Activities - (66.84 SQM)	● Student Space (31)	
H - 3.13 - Practical Activities - (67.22 SQM)	● Student Space (31)	
H - 3.14 - General Learning Space - (72.12 SQM) - Teaching Space: 1	● Student Space (33)	
H - 3.15 - Seminar - (18.33 SQM)	● Office (4)	
H - 3.16 - Seminar - (20.51 SQM)	● Office (5)	
H - 3.17 - Study Space - (5.98 SQM)	Not Applicable	Circulation or storage space.
H - 3.18 - Study Space - (5.99 SQM)	Not Applicable	Circulation or storage space.
H - 3.20 - Isolation Space - (21.96 SQM)	● Office (5)	
H - 3.21 - General Learning Space - (71.64 SQM) - Teaching Space: 1	● Student Space (33)	
H - 3.22 - Movement - (17.62 SQM)	Not Applicable	Circulation or storage space.
H - 3.23 - General Learning Space - (64.04 SQM) - Teaching Space: 1	● Student Space (29)	
H - 3.24 - Tiered Learning Area - (22.08 SQM)	● Student Space (10)	
H - 3.34 - Movement - (6.18 SQM)	Not Applicable	Circulation or storage space.
H - 3.37 - Movement - (5.99 SQM)	Not Applicable	Circulation or storage space.
H - 3.40 - Movement - (6.18 SQM)	Not Applicable	Circulation or storage space.
H - 3.43 - Movement - (5.99 SQM)	Not Applicable	Circulation or storage space.
H - 3.46 - Tiered Learning Area - (5.31 SQM)	● Student Space (2)	
H - 4.10 - General Learning Space X4 - (644.22 SQM) - Teaching Space: 4	● Student Space (298)	
H - 4.11 - Study Space - (105.25 SQM)	Not Applicable	Circulation or storage space.
H - 4.12 - General Learning Space - (71.09 SQM) - Teaching Space: 1	● Student Space (32)	
H - 4.13 - General Learning Space - (71.43 SQM) - Teaching Space: 1	● Student Space (33)	

Entity Location	Audit Condition Classification (Capacity)	Comment
H - 4.15 - Seminar - Type 1 - (18.29 SQM)	Office (4)	
H - 4.16 - Seminar - Type 1 - (20.32 SQM)	Office (5)	
H - 4.17 - Isolation Space - (5.98 SQM)	Office (1)	
H - 4.18 - Isolation Space - (5.99 SQM)	Office (1)	
H - 4.19 - Isolation Space - (5.99 SQM)	Office (1)	
H - 4.20 - Isolation Space - (21.96 SQM)	Office (5)	
H - 4.21 - Practical Activities - (66.82 SQM)	Student Space (31)	
H - 4.22 - Practical Activities - (66.63 SQM)	Student Space (30)	
H - 4.26 - Movement - (5.99 SQM)	Not Applicable	Circulation or storage space.
H - 4.28 - Movement - (6.18 SQM)	Not Applicable	Circulation or storage space.
H - 4.32 - Movement - (5.99 SQM)	Not Applicable	Circulation or storage space.
H - 4.34 - Movement - (6.18 SQM)	Not Applicable	Circulation or storage space.
H - 4.37 - Movement - (17.62 SQM)	Not Applicable	Circulation or storage space.
H - 4.46 - Tiered Learning Area - (22.08 SQM)	Student Space (10)	
H - 5.10 - Metal Technology Bay - (168.93 SQM)	Not Applicable	Circulation or storage space.
H - 5.14 - Welding Area - (20.75 SQM)	Not Applicable	Circulation or storage space.
H - 5.15 - Metal Technology Bay - (15.16 SQM)	Not Applicable	Circulation or storage space.
H - 5.16 - Materials Technology L.S. - (143.26 SQM) - Teaching Space: 1	Student Space (66)	
H - 5.18 - Wood Technology Bay - (136.45 SQM)	Not Applicable	Circulation or storage space.
H - 5.19 - General Learning Space - Type 6 - (91.37 SQM) - Teaching Space: 1	Student Space (42)	
H - 5.20 - Materials Workshop - Type 2 - (21.73 SQM)	Student Space (10)	
H - 5.21 - Visual Arts Workshop - (97.25 SQM)	Student Space (45)	
H - 5.24 - General Learning Space - (214.91 SQM) - Teaching Space: 1	Student Space (99)	
H - 5.25 - General Learning Space - (94.08 SQM) - Teaching Space: 1	Student Space (43)	
H - 5.26 - Visual Arts Workshop - (99.99 SQM)	Student Space (46)	
H - 5.27 - Visual Arts Workshop - (95.02 SQM)	Student Space (44)	
H - 5.33 - Visual Arts Workshop - (92.12 SQM)	Student Space (42)	
H - 5.37 - Movement - (6.18 SQM)	Not Applicable	Circulation or storage space.
H - 5.40 - Movement - (5.99 SQM)	Not Applicable	Circulation or storage space.
H - 5.43 - Movement - (6.18 SQM)	Not Applicable	Circulation or storage space.
H - 5.46 - Movement - (5.99 SQM)	Not Applicable	Circulation or storage space.
H - 6.10 - General Learning Space X4 - (581.76 SQM) - Teaching Space: 4	Student Space (269)	
H - 6.11 - Practical Activities - (105.25 SQM)	Student Space (48)	
H - 6.12 - General Learning Space - (71.9 SQM) - Teaching Space: 1	Student Space (33)	
H - 6.13 - Practical Activities - (66.94 SQM)	Student Space (31)	
H - 6.14 - General Learning Space - (67.06 SQM) - Teaching Space: 1	Student Space (31)	
H - 6.15 - Practical Activities - (71.74 SQM)	Student Space (33)	
H - 6.16 - Music Learning Space - (74.88 SQM) - Teaching Space: 1	Student Space (34)	
H - 6.17 - Isolation Space - (5.98 SQM)	Office (1)	
H - 6.18 - Isolation Space - (5.99 SQM)	Office (1)	
H - 6.19 - Isolation Space - (5.99 SQM)	Office (1)	
H - 6.20 - Isolation Space - (21.96 SQM)	Office (5)	
H - 6.21 - Movement - (17.62 SQM)	Not Applicable	Circulation or storage space.
H - 6.22 - Tiered Learning Area - (22.08 SQM)	Student Space (10)	
H - 6.23 - Movement - (27.3 SQM)	Not Applicable	Circulation or storage space.
H - 6.31 - Movement - (6.18 SQM)	Not Applicable	Circulation or storage space.
H - 6.33 - Movement - (5.99 SQM)	Not Applicable	Circulation or storage space.
H - 6.35 - Movement - (6.18 SQM)	Not Applicable	Circulation or storage space.
H - 6.37 - Movement - (5.99 SQM)	Not Applicable	Circulation or storage space.
H - 7.10 - General Learning Space X4 - (583.14 SQM) - Teaching Space: 4	Student Space (270)	

Entity Location	Audit Condition Classification (Capacity)	Comment
H - 7.11 - Practical Activities - (104.14 SQM)	Student Space (48)	
H - 7.12 - General Learning Space - Type 6 - (66.84 SQM) - Teaching Space: 1	Student Space (31)	
H - 7.13 - General Learning Space - Type 6 - (67.22 SQM) - Teaching Space: 1	Student Space (31)	
H - 7.14 - Isolation Space - (64.04 SQM)	Office (16)	
H - 7.15 - Seminar - (18.33 SQM)	Office (4)	
H - 7.16 - Seminar - (20.51 SQM)	Office (5)	
H - 7.17 - Isolation Space - (5.98 SQM)	Office (1)	
H - 7.18 - Isolation Space - (5.99 SQM)	Office (1)	
H - 7.19 - Isolation Space - (5.99 SQM)	Office (1)	
H - 7.20 - Isolation Space - (21.96 SQM)	Office (5)	
H - 7.21 - General Learning Space - (71.64 SQM) - Teaching Space: 1	Student Space (33)	
H - 7.22 - General Learning Space - (72.12 SQM) - Teaching Space: 1	Student Space (33)	
H - 7.24 - Movement - (17.62 SQM)	Not Applicable	Circulation or storage space.
H - 7.34 - Movement - (6.18 SQM)	Not Applicable	Circulation or storage space.
H - 7.37 - Movement - (5.99 SQM)	Not Applicable	Circulation or storage space.
H - 7.40 - Movement - (6.18 SQM)	Not Applicable	Circulation or storage space.
H - 7.43 - Movement - (5.99 SQM)	Not Applicable	Circulation or storage space.
H - 7.47 - Tiered Learning Area - (22.08 SQM)	Student Space (10)	
H - 8.10 - General Learning Space X4 - (579.96 SQM) - Teaching Space: 4	Student Space (269)	
H - 8.11 - Study Space - (105.25 SQM)	Not Applicable	Circulation or storage space.
H - 8.12 - Tutorial Centre - (71.09 SQM)	Student Space (32)	
H - 8.13 - Practical Activities - (66.82 SQM)	Student Space (31)	
H - 8.14 - Practical Activities - (71.43 SQM)	Student Space (33)	
H - 8.15 - General Learning Space - (64.25 SQM) - Teaching Space: 1	Student Space (29)	
H - 8.16 - Seminar - (18.29 SQM)	Office (4)	
H - 8.17 - Seminar - (20.32 SQM)	Office (5)	
H - 8.18 - Study Space - (5.99 SQM)	Not Applicable	Circulation or storage space.
H - 8.19 - Study Space - (5.99 SQM)	Not Applicable	Circulation or storage space.
H - 8.20 - Study Space - (5.98 SQM)	Not Applicable	Circulation or storage space.
H - 8.21 - Isolation Space - (21.96 SQM)	Office (5)	
H - 8.24 - Tutorial Centre - (66.63 SQM)	Student Space (30)	
H - 8.25 - Tiered Learning Area - (22.08 SQM)	Student Space (10)	
H - 8.32 - Movement - (6.18 SQM)	Not Applicable	Circulation or storage space.
H - 8.35 - Movement - (5.99 SQM)	Not Applicable	Circulation or storage space.
H - 8.38 - Movement - (6.18 SQM)	Not Applicable	Circulation or storage space.
H - 8.41 - Movement - (5.99 SQM)	Not Applicable	Circulation or storage space.
H - 8.46 - Movement - (17.62 SQM)	Not Applicable	Circulation or storage space.
H - 9.10 - General Learning Space - (57.68 SQM) - Teaching Space: 1	Student Space (26)	
H - 9.11 - Science Laboratory - (130.86 SQM)	Student Space (60)	
H - 9.12 - Seminar - (26.38 SQM)	Office (6)	
H - 9.14 - General Learning Space - (44.9 SQM) - Teaching Space: 1	Student Space (20)	
H - 9.15 - General Learning Space - (57.85 SQM) - Teaching Space: 1	Student Space (26)	
H - 9.16 - Science Laboratory - (123.76 SQM)	Student Space (57)	
H - 9.19 - Preparation - Science - (42.87 SQM)	Not Applicable	Circulation or storage space.
H - 9.20 - Seminar - (20.55 SQM)	Office (5)	
H - 9.21 - Science Laboratory - (123.7 SQM)	Student Space (57)	
H - 9.22 - General Learning Space - (55.32 SQM) - Teaching Space: 1	Student Space (25)	
H - 9.23 - Science Laboratory - (124.69 SQM)	Student Space (57)	
H - 9.24 - Science Laboratory - (130.72 SQM)	Student Space (60)	

Entity Location	Audit Condition Classification (Capacity)	Comment
H - 9.25 - General Learning Space - (44.87 SQM) - Teaching Space: 1	● Student Space (20)	
H - 9.26 - Movement - (9.9 SQM)	Not Applicable	Circulation or storage space.
H - 9.32 - Movement - (5.84 SQM)	Not Applicable	Circulation or storage space.
H - 9.35 - Movement - (5.99 SQM)	Not Applicable	Circulation or storage space.
H - 9.37 - Movement - (5.84 SQM)	Not Applicable	Circulation or storage space.
H - 9.40 - Movement - (5.99 SQM)	Not Applicable	Circulation or storage space.
H - 9.42 - Movement - (9.89 SQM)	Not Applicable	Circulation or storage space.
H - G.10 - Performance Workshop - (138.4 SQM)	● Student Space (64)	
H - G.11 - Performance Workshop - (99.15 SQM)	● Student Space (46)	
H - G.12 - Practice/Seminar - (14.37 SQM)	Not Applicable	Circulation or storage space.
H - G.13 - Practice/Seminar - (13.71 SQM)	Not Applicable	Circulation or storage space.
H - G.14 - Practice/Seminar - (10.85 SQM)	Not Applicable	Circulation or storage space.
H - G.15 - Practice/Seminar - (11.78 SQM)	Not Applicable	Circulation or storage space.
H - G.16 - Tiered Learning Area - (274.39 SQM)	● Student Space (127)	
H - G.17 - Movement - (191.97 SQM)	Not Applicable	Circulation or storage space.
H - G.20 - Movement - (365.27 SQM)	Not Applicable	Circulation or storage space.
H - G.21 - Movement - (6.18 SQM)	Not Applicable	Circulation or storage space.
H - G.24 - Movement - (5.99 SQM)	Not Applicable	Circulation or storage space.
H - G.36 - Movement - (6.18 SQM)	Not Applicable	Circulation or storage space.
H - G.39 - Movement - (5.96 SQM)	Not Applicable	Circulation or storage space.
H - G.7 - Music Learning Space - (66.55 SQM) - Teaching Space: 1	● Student Space (30)	
H - LG1.18 - Interview/Meeting - (10.99 SQM)	● Office (2)	
H - LG1.19 - Interview/Meeting - (11.39 SQM)	● Office (2)	
H - LG1.20 - Interview/Meeting - (10.99 SQM)	● Office (2)	
H - LG1.21 - Interview/Meeting - (13.94 SQM)	● Office (3)	
H - LG1.22 - Interview/Meeting - (10.99 SQM)	● Office (2)	
H - LG1.23 - Interview/Meeting - (11.39 SQM)	● Office (2)	
H - LG1.24 - Interview/Meeting - (11.03 SQM)	● Office (2)	
H - LG1.25 - Staff Lounge - (52.08 SQM)	● Office (13)	
H - LG1.26 - Interview/Meeting - (11.03 SQM)	● Office (2)	
H - LG1.27 - Interview/Meeting - (11.42 SQM)	● Office (2)	
H - LG1.28 - Interview/Meeting - (11.03 SQM)	● Office (2)	
H - LG1.32 - Tiered Learning Area - (102.65 SQM)	● Student Space (47)	
H - LG1.36 - Movement - (9.54 SQM)	Not Applicable	Circulation or storage space.
H - LG1.39 - Movement - (5.96 SQM)	Not Applicable	Circulation or storage space.
H - LG1.45 - Movement - (8.02 SQM)	Not Applicable	Circulation or storage space.
H - LG1.46 - Movement - (135.2 SQM)	Not Applicable	Circulation or storage space.
H - LG1.47 - Movement - (17.76 SQM)	Not Applicable	Circulation or storage space.
H - LG1.48 - Public Entry - (95.63 SQM)	Not Applicable	Circulation or storage space.
H - LG1.50 - Movement - (7.55 SQM)	Not Applicable	Circulation or storage space.
H - LG1.52 - Movement - (5.99 SQM)	Not Applicable	Circulation or storage space.
H - LG1.54 - Interview/Meeting - (13.91 SQM)	● Office (3)	
H - LG1.55 - Movement - (6.18 SQM)	Not Applicable	Circulation or storage space.
H - LG1.56 - Movement - (7.76 SQM)	Not Applicable	Circulation or storage space.
H - LG1.59 - Movement - (53.39 SQM)	Not Applicable	Circulation or storage space.
H - LG1.60 - Staff Study - (59.95 SQM)	● Office (14)	
H - LG1.61 - Staff Study - (41.17 SQM)	● Office (10)	
H - LG1.62 - Administration - Clerical - (19.6 SQM)	● Office (4)	
H - LG1.63 - Movement - (53.87 SQM)	Not Applicable	Circulation or storage space.
H - LG1.64 - Administration - Clerical - (28.73 SQM)	● Office (7)	
H - LG1.65 - Student Reception - (59.85 SQM)	Not Applicable	Circulation or storage space.

Entity Location	Audit Condition Classification (Capacity)	Comment
H - LG1.70 - Movement - (23.38 SQM)	Not Applicable	Circulation or storage space.
H - LG1.71 - Stage - (184.79 SQM)	Not Applicable	Circulation or storage space.
H - M2.10 - General Learning Space - (66.53 SQM) - Teaching Space: 1	● Student Space (30)	
H - M2.11 - General Learning Space - (71.66 SQM) - Teaching Space: 1	● Student Space (33)	
H - M2.12 - Seminar - (20.45 SQM)	○ Office (5)	
H - M2.13 - Seminar - (18.3 SQM)	○ Office (4)	
H - M2.14 - General Learning Space - (64.33 SQM) - Teaching Space: 1	● Student Space (29)	
H - M2.15 - Tiered Learning Area - (16.63 SQM)	● Student Space (7)	
H - M2.20 - Movement - (6.18 SQM)	Not Applicable	Circulation or storage space.
H - M2.23 - Movement - (5.99 SQM)	Not Applicable	Circulation or storage space.
H - M2.26 - Movement - (6.18 SQM)	Not Applicable	Circulation or storage space.
H - M2.29 - Movement - (5.99 SQM)	Not Applicable	Circulation or storage space.
H - M2.34 - Movement - (43.56 SQM)	Not Applicable	Circulation or storage space.
H - M2.8 - General Learning Space - (71.57 SQM) - Teaching Space: 1	● Student Space (33)	
H - M2.9 - General Learning Space - (66.89 SQM) - Teaching Space: 1	● Student Space (31)	
H - M3.10 - General Learning Space - (64.25 SQM) - Teaching Space: 1	● Student Space (29)	
H - M3.11 - Seminar - (18.52 SQM)	○ Office (4)	
H - M3.12 - Seminar - (20.37 SQM)	○ Office (5)	
H - M3.13 - Practical Activities - (66.56 SQM)	● Student Space (30)	
H - M3.14 - General Learning Space - (71.38 SQM) - Teaching Space: 1	● Student Space (33)	
H - M3.16 - Movement - (42.62 SQM)	Not Applicable	Circulation or storage space.
H - M3.17 - Tiered Learning Area - (16.56 SQM)	● Student Space (7)	
H - M3.23 - Movement - (6.18 SQM)	Not Applicable	Circulation or storage space.
H - M3.26 - Movement - (5.99 SQM)	Not Applicable	Circulation or storage space.
H - M3.29 - Movement - (6.18 SQM)	Not Applicable	Circulation or storage space.
H - M3.32 - Movement - (5.99 SQM)	Not Applicable	Circulation or storage space.
H - M3.8 - General Learning Space - (71.28 SQM) - Teaching Space: 1	● Student Space (33)	
H - M3.9 - Practical Activities - (66.55 SQM)	● Student Space (30)	
H - M4.10 - Movement - (64.26 SQM)	Not Applicable	Circulation or storage space.
H - M4.11 - Seminar - (39.42 SQM)	○ Office (9)	
H - M4.12 - Practical Activities - (67.03 SQM)	● Student Space (31)	
H - M4.13 - Practical Activities - (66.9 SQM)	● Student Space (31)	
H - M4.22 - Movement - (6.18 SQM)	Not Applicable	Circulation or storage space.
H - M4.25 - Movement - (5.99 SQM)	Not Applicable	Circulation or storage space.
H - M4.28 - Movement - (6.18 SQM)	Not Applicable	Circulation or storage space.
H - M4.31 - Movement - (5.99 SQM)	Not Applicable	Circulation or storage space.
H - M4.34 - Tiered Learning Area - (16.38 SQM)	● Student Space (7)	
H - M4.35 - Movement - (43.48 SQM)	Not Applicable	Circulation or storage space.
H - M4.8 - General Learning Space - (71.79 SQM) - Teaching Space: 1	● Student Space (33)	
H - M4.9 - General Learning Space - (71.87 SQM) - Teaching Space: 1	● Student Space (33)	
H - M6.10 - General Learning Space - (67.06 SQM) - Teaching Space: 1	● Student Space (31)	
H - M6.11 - Practical Activities - (71.74 SQM)	● Student Space (33)	
H - M6.12 - Isolation Space - (63.54 SQM)	○ Office (15)	
H - M6.13 - Seminar - Type 1 - (20.62 SQM)	○ Office (5)	
H - M6.14 - Seminar - Type 1 - (18.28 SQM)	○ Office (4)	
H - M6.15 - Tiered Learning Area - (15.93 SQM)	● Student Space (7)	
H - M6.16 - Movement - (43.12 SQM)	Not Applicable	Circulation or storage space.
H - M6.22 - Movement - (6.18 SQM)	Not Applicable	Circulation or storage space.
H - M6.24 - Movement - (5.99 SQM)	Not Applicable	Circulation or storage space.

Entity Location	Audit Condition Classification (Capacity)	Comment
H - M6.26 - Movement - (6.18 SQM)	Not Applicable	Circulation or storage space.
H - M6.28 - Movement - (5.99 SQM)	Not Applicable	Circulation or storage space.
H - M6.8 - General Learning Space - (71.94 SQM) - Teaching Space: 1	● Student Space (33)	
H - M6.9 - Practical Activities - (66.94 SQM)	● Student Space (31)	
H - M7.10 - Seminar - Type 1 - (36.41 SQM)	○ Office (9)	
H - M7.11 - Seminar - Type 1 - (17.84 SQM)	○ Office (4)	
H - M7.12 - Seminar - Type 1 - (20.47 SQM)	○ Office (5)	
H - M7.13 - Isolation Space - (107.83 SQM)	○ Office (26)	
H - M7.14 - Seminar - Type 1 - (39.37 SQM)	○ Office (9)	
H - M7.15 - Movement - (126.67 SQM)	Not Applicable	Circulation or storage space.
H - M7.16 - Tiered Learning Area - (16.56 SQM)	● Student Space (7)	
H - M7.25 - Movement - (5.99 SQM)	Not Applicable	Circulation or storage space.
H - M7.8 - Seminar - Type 1 - (39 SQM)	○ Office (9)	
H - M7.9 - Seminar - Type 1 - (36.41 SQM)	○ Office (9)	
H - M8.10 - Seminar - (36.41 SQM)	○ Office (9)	
H - M8.11 - Seminar - (17.84 SQM)	○ Office (4)	
H - M8.12 - Seminar - (20.3 SQM)	○ Office (5)	
H - M8.13 - Movement - (122.67 SQM)	Not Applicable	Circulation or storage space.
H - M8.14 - Seminar - (39.52 SQM)	○ Office (9)	
H - M8.15 - General Learning Space - (107.51 SQM) - Teaching Space: 1	● Student Space (49)	
H - M8.16 - Tiered Learning Area - (17.4 SQM)	● Student Space (8)	
H - M8.23 - Movement - (6.18 SQM)	Not Applicable	Circulation or storage space.
H - M8.26 - Movement - (5.99 SQM)	Not Applicable	Circulation or storage space.
H - M8.29 - Movement - (6.18 SQM)	Not Applicable	Circulation or storage space.
H - M8.32 - Movement - (5.99 SQM)	Not Applicable	Circulation or storage space.
H - M8.8 - Seminar - (39.05 SQM)	○ Office (9)	
H - M8.9 - Seminar - (36.48 SQM)	○ Office (9)	