

# VENTILATION AUDIT REPORT

|                               |   |
|-------------------------------|---|
| <b>SCHOOL:</b>                | <b>Albion Park Public School (1015)</b> |
| <b>AMU REGION:</b>            | <b>Southern NSW</b>                     |
| <b>STATE ELECTORATE:</b>      | <b>Kiama</b>                            |
| <b>LOCAL GOVERNMENT AREA:</b> | <b>Shellharbour</b>                     |

1015 - Albion Park Public School  
Site Plan (13271)

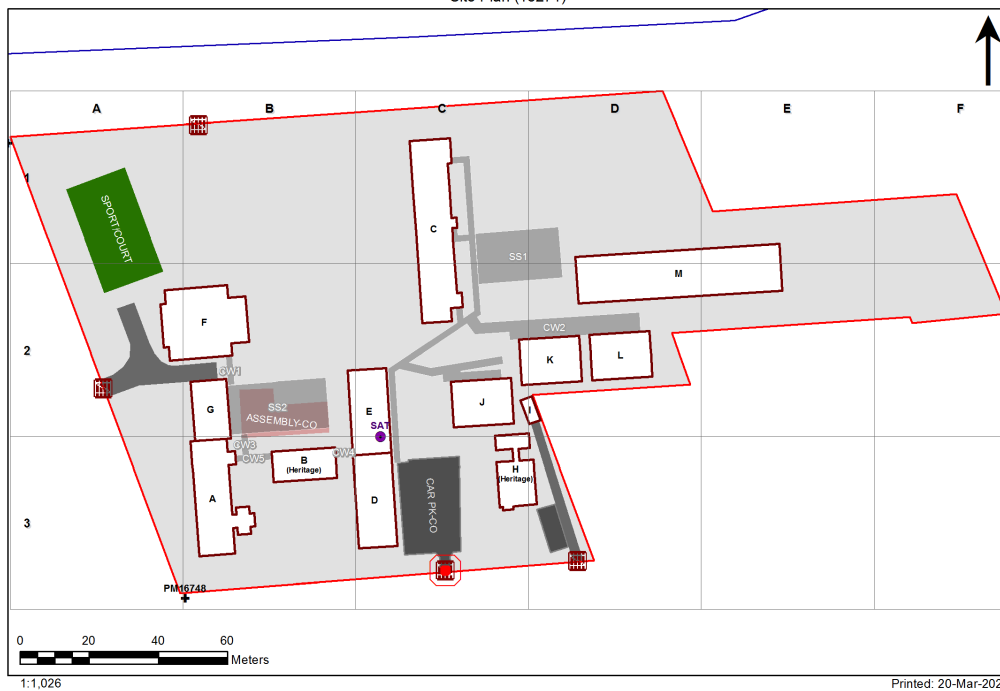

1:1,026

Printed: 20-Mar-2020

## Ventilation Audit Key

| Category  | Description  |
|---|--|
|  | Category A<br>Operate this space in line with <a href="#">COVID safe school operations</a> . It has the required level of natural ventilation.<br>NB. Circulation and storage areas should not be used for groups or gatherings.   |
|  | Category B<br>This space should be occupied at 1 person per 4m <sup>2</sup> to comply with <a href="#">COVID safe school operations and the guided use of spaces</a> .<br>The report details the number of people who can be accommodated safely in each of the identified spaces. |

| Entity Location  | Audit Condition Classification (Capacity) | Comment                       |
|--|---|-------------------------------|
| B00A - R0001 - Home Base - (53.63 SQM) - Teaching Space: 1     | ● Student Space (24)                      |                               |
| B00A - R0002 - Practical Activities - 1hb - (11.11 SQM)        | ● Student Space (5)                       |                               |
| B00A - R0004 - Movement - (22.02 SQM)                          | Not Applicable                            | Circulation or storage space. |
| B00A - R0005 - Movement - (7.33 SQM)                           | Not Applicable                            | Circulation or storage space. |
| B00A - R0006 - Movement - (7.55 SQM)                           | Not Applicable                            | Circulation or storage space. |
| B00A - R0013 - Movement - (56.68 SQM)                          | Not Applicable                            | Circulation or storage space. |
| B00A - R0015 - Withdrawal Space - 1hb - (19 SQM)               | ● Student Space (8)                       |                               |
| B00A - R0018 - Movement - (7.04 SQM)                           | Not Applicable                            | Circulation or storage space. |
| B00A - R0020 - Practical Activities - (7.98 SQM)               | ● Student Space (3)                       |                               |
| B00A - R0021 - Home Base - (57.02 SQM) - Teaching Space: 1     | ● Student Space (26)                      |                               |
| B00A - R0022 - Home Base - (56.95 SQM) - Teaching Space: 1     | ● Student Space (26)                      |                               |
| B00A - R0023 - Practical Activities - (9.56 SQM)               | ● Student Space (4)                       |                               |
| B00A - R1001 - Home Base - (53.82 SQM) - Teaching Space: 1     | ● Student Space (24)                      |                               |
| B00A - R1003 - Practical Activities - 1hb - (11.34 SQM)        | ● Student Space (5)                       |                               |
| B00A - R1010 - Movement - (61.29 SQM)                          | Not Applicable                            | Circulation or storage space. |
| B00A - R1011 - Withdrawal Space - 1hb - (20.21 SQM)            | ● Student Space (9)                       |                               |
| B00A - R1012 - Staff Room Annexe - (19.03 SQM)                 | ● Office (4)                              |                               |
| B00A - R1016 - Practical Activities - (9.64 SQM)               | ● Student Space (4)                       |                               |
| B00A - R1017 - Home Base - (56.88 SQM) - Teaching Space: 1     | ● Student Space (26)                      |                               |
| B00A - R1018 - Home Base - (56.88 SQM) - Teaching Space: 1     | ● Student Space (26)                      |                               |
| B00A - R1019 - Practical Activities - (9.7 SQM)                | ● Student Space (4)                       |                               |
| B00B - R0001 - Staff Room Annexe - (27.02 SQM)                 | ● Office (6)                              |                               |
| B00B - R0002 - Special Programs Room - (49.47 SQM)             | ● Student Space (22)                      |                               |
| B00B - R0007 - Movement - (44.3 SQM)                           | Not Applicable                            | Circulation or storage space. |
| B00C - R0005 - Practical Activities - M - 1hb - (10.95 SQM)    | ● Student Space (5)                       |                               |
| B00C - R0006 - Home Base - M - (62.18 SQM) - Teaching Space: 1 | ● Student Space (28)                      |                               |
| B00C - R0007 - Practical Activities - 1hb - (6.95 SQM)         | ● Student Space (3)                       |                               |
| B00C - R0008 - Home Base - (66.15 SQM) - Teaching Space: 1     | ● Student Space (30)                      |                               |
| B00C - R0010 - Movement - (7.89 SQM)                           | Not Applicable                            | Circulation or storage space. |
| B00C - R0013 - Home Base - (69.6 SQM) - Teaching Space: 1      | ● Student Space (32)                      |                               |
| B00C - R0014 - Home Base - (85.35 SQM) - Teaching Space: 1     | ● Student Space (39)                      |                               |
| B00C - R0019 - Movement - (11.24 SQM)                          | Not Applicable                            | Circulation or storage space. |
| B00C - R0020 - Withdrawal Space - 1hb - (15.63 SQM)            | ● Student Space (7)                       |                               |
| B00C - R0022 - Movement - (85.14 SQM)                          | Not Applicable                            | Circulation or storage space. |
| B00D - R0001 - Movement - (7.94 SQM)                           | Not Applicable                            | Circulation or storage space. |
| B00D - R0002 - Entry Vestibule - (21.49 SQM)                   | Not Applicable                            | Circulation or storage space. |
| B00D - R0003 - Clerical Office/Workroom - (17.48 SQM)          | ● Office (4)                              |                               |
| B00D - R0004 - Duplicating Workroom - (19.72 SQM)              | ● Office (4)                              |                               |
| B00D - R0005 - Principal - (16.73 SQM)                         | ● Office (4)                              |                               |
| B00D - R0010 - Movement - (33.66 SQM)                          | Not Applicable                            | Circulation or storage space. |
| B00D - R0012 - Staff Room - (61.57 SQM)                        | ● Office (15)                             |                               |
| B00D - R0014 - Sick Bay - (8.61 SQM)                           | ● Student Space (3)                       |                               |
| B00D - R0015 - Deputy Principal - (13.01 SQM)                  | ● Office (3)                              |                               |
| B00D - R0016 - Deputy Principal - (13.09 SQM)                  | ● Office (3)                              |                               |
| B00D - R0017 - Interview - (13.09 SQM)                         | ● Office (3)                              |                               |
| B00E - R0001 - Movement - (55.56 SQM)                          | Not Applicable                            | Circulation or storage space. |
| B00E - R0006 - Reading Area - (153.15 SQM)                     | ● Student Space (71)                      |                               |
| B00F - R0002 - Communal Space - (170.07 SQM)                   | ● Student Space (78)                      |                               |

| Entity Location  | Audit Condition Classification (Capacity) | Comment                       |
|--|---|-------------------------------|
| B00F - R0003 - Raised Platform - (37 SQM)                  | Not Applicable                            | Circulation or storage space. |
| B00F - R0017 - Canteen - (24.72 SQM)                       | Not Applicable                            | Circulation or storage space. |
| B00F - R0020 - Movement - (71.39 SQM)                      | Not Applicable                            | Circulation or storage space. |
| B00G - R0001 - Movement - (21.1 SQM)                       | Not Applicable                            | Circulation or storage space. |
| B00G - R0002 - Movement - (21.56 SQM)                      | Not Applicable                            | Circulation or storage space. |
| B00J - R0001 - Movement - (38.48 SQM)                      | Not Applicable                            | Circulation or storage space. |
| B00J - R0002 - Practical Activities - 1hb - (19.4 SQM)     | ● Student Space (9)                       |                               |
| B00J - R0004 - Home Base - (59.2 SQM) - Teaching Space: 1  | ● Student Space (27)                      |                               |
| B00J - R0005 - Withdrawal Space - 2hb - (11.36 SQM)        | ● Student Space (5)                       |                               |
| B00J - R0006 - Home Base - (59.2 SQM) - Teaching Space: 1  | ● Student Space (27)                      |                               |
| B00J - R0008 - Practical Activities - 1hb - (19.4 SQM)     | ● Student Space (9)                       |                               |
| B00K - R0001 - Movement - (38.47 SQM)                      | Not Applicable                            | Circulation or storage space. |
| B00K - R0002 - Practical Activities - 1hb - (19.4 SQM)     | ● Student Space (9)                       |                               |
| B00K - R0004 - Home Base - (59.2 SQM) - Teaching Space: 1  | ● Student Space (27)                      |                               |
| B00K - R0005 - Withdrawal Space - 2hb - (11.36 SQM)        | ● Student Space (5)                       |                               |
| B00K - R0006 - Home Base - (59.19 SQM) - Teaching Space: 1 | ● Student Space (27)                      |                               |
| B00K - R0008 - Practical Activities - 1hb - (19.41 SQM)    | ● Student Space (9)                       |                               |
| B00L - R0001 - Movement - (38.47 SQM)                      | Not Applicable                            | Circulation or storage space. |
| B00L - R0002 - Practical Activities - 1hb - (19.4 SQM)     | ● Student Space (9)                       |                               |
| B00L - R0004 - Home Base - (59.2 SQM) - Teaching Space: 1  | ● Student Space (27)                      |                               |
| B00L - R0005 - Withdrawal Space - 2hb - (11.36 SQM)        | ● Student Space (5)                       |                               |
| B00L - R0006 - Home Base - (59.19 SQM) - Teaching Space: 1 | ● Student Space (27)                      |                               |
| B00L - R0008 - Practical Activities - 1hb - (19.41 SQM)    | ● Student Space (9)                       |                               |
| B00M - R0005 - Practical Activities - (19.2 SQM)           | ● Student Space (8)                       |                               |
| B00M - R0007 - Home Base - (61.06 SQM) - Teaching Space: 1 | ● Student Space (28)                      |                               |
| B00M - R0008 - Withdrawal Space - 2hb - (11.78 SQM)        | ● Student Space (5)                       |                               |
| B00M - R0009 - Home Base - (61.82 SQM) - Teaching Space: 1 | ● Student Space (28)                      |                               |
| B00M - R0011 - Practical Activities - (19.42 SQM)          | ● Student Space (9)                       |                               |
| B00M - R0012 - Practical Activities - (19.54 SQM)          | ● Student Space (9)                       |                               |
| B00M - R0014 - Home Base - (61.46 SQM) - Teaching Space: 1 | ● Student Space (28)                      |                               |
| B00M - R0015 - Withdrawal Space - 2hb - (11.81 SQM)        | ● Student Space (5)                       |                               |
| B00M - R0016 - Home Base - (61.71 SQM) - Teaching Space: 1 | ● Student Space (28)                      |                               |
| B00M - R0018 - Practical Activities - (19.44 SQM)          | ● Student Space (9)                       |                               |
| B00M - R0019 - Practical Activities - (19.45 SQM)          | ● Student Space (9)                       |                               |
| B00M - R0021 - Home Base - (61.79 SQM) - Teaching Space: 1 | ● Student Space (28)                      |                               |
| B00M - R0022 - Withdrawal Space - 2hb - (11.78 SQM)        | ● Student Space (5)                       |                               |
| B00M - R0023 - Home Base - (61.25 SQM) - Teaching Space: 1 | ● Student Space (28)                      |                               |
| B00M - R0025 - Practical Activities - (19.29 SQM)          | ● Student Space (8)                       |                               |