

VENTILATION AUDIT REPORT Version 2

SCHOOL:	Sydney Secondary College Leichhardt Campus (8507)
AMU REGION:	Sydney
STATE ELECTORATE:	Balmain
LOCAL GOVERNMENT AREA:	Inner West

8507 - Sydney Secondary College Leichhardt Campus
Site Plan (12762)

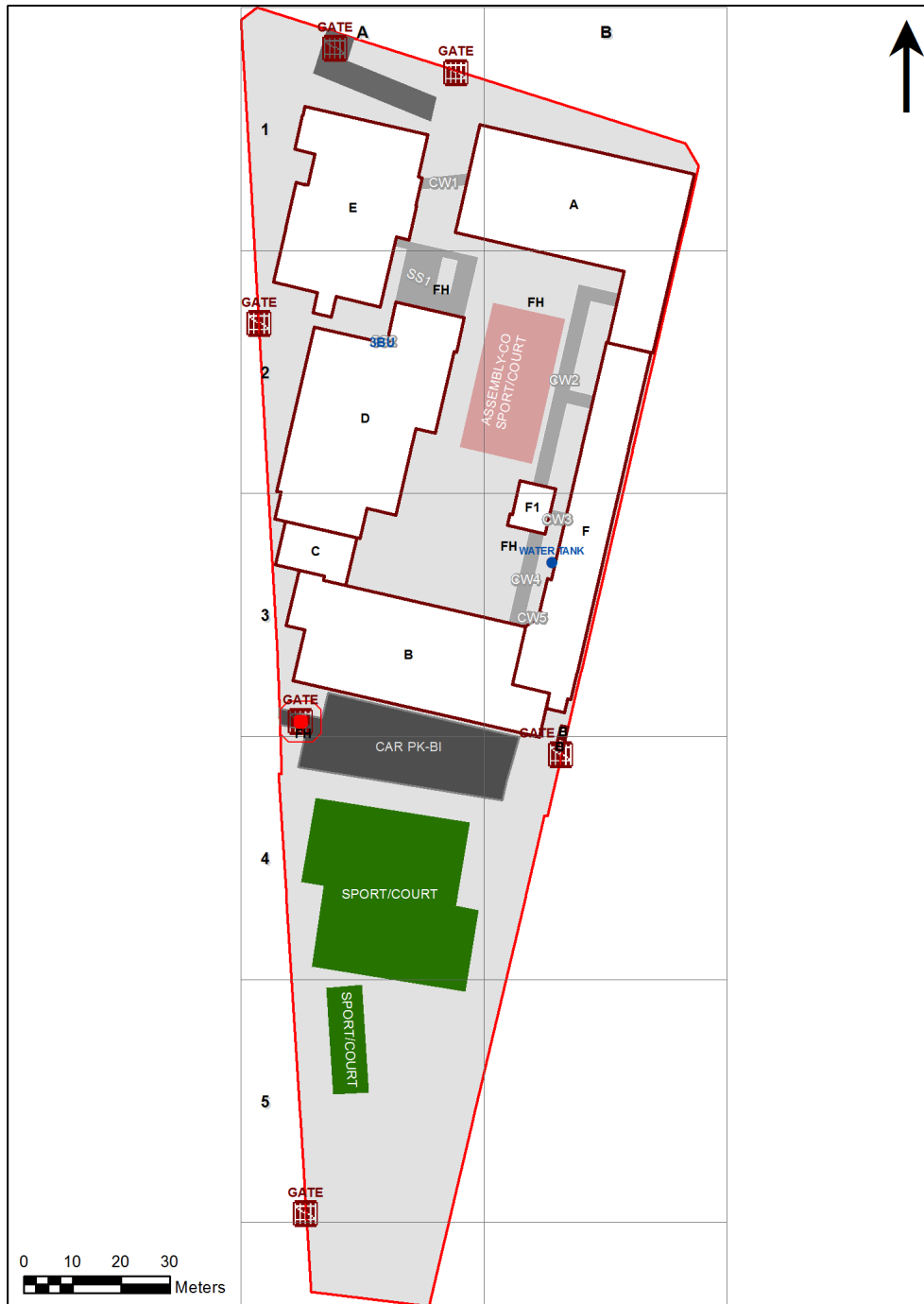

1:975

Printed: 21-Mar-2020

Site plan is indicative only and is included to show building numbers used by the Department.

Ventilation Audit Key

Category	Description
	Category A Operate this space in line with COVID safe school operations . It has the required level of natural ventilation. NB. Circulation and storage areas should not be used for groups or gatherings.
	Category B This space should be occupied at 1 person per 4m ² to comply with COVID safe school operations and the guided use of spaces . The report details the number of people who can be accommodated safely in each of the identified spaces.

Entity Location	Audit Condition Classification (Capacity)	Comment
B00A - R0010 - Computer Learning Space - (44.45 SQM) - Teaching Space: 1	Student Space (24)	
B00A - R0011 - General Learning Space - (67.72 SQM) - Teaching Space: 1	Student Space (37)	
B00A - R0014 - Art Learning Space - (67.46 SQM) - Teaching Space: 1	Student Space (37)	
B00A - R0016 - General Learning Space - (65.34 SQM) - Teaching Space: 1	Student Space (36)	
B00A - R0017 - Art Learning Space - (65.87 SQM) - Teaching Space: 1	Student Space (36)	
B00A - R0018 - Movement - (157.85 SQM)	Not Applicable	Circulation or storage space.
B00A - R0020 - General Learning Space - (68.1 SQM) - Teaching Space: 1	Student Space (37)	
B00A - R0025 - Food Technology L.S. - (85.41 SQM) - Teaching Space: 1	Student Space (47)	
B00A - R0026 - Food/Research Space - (15.14 SQM)	Not Applicable	Circulation or storage space.
B00A - R0027 - Food/Research Space - (16.07 SQM)	Not Applicable	Circulation or storage space.
B00A - R0028 - Food Technology L.S. - (84.67 SQM) - Teaching Space: 1	Student Space (47)	
B00A - R0031 - Movement - (14.04 SQM)	Not Applicable	Circulation or storage space.
B00A - R0035 - Movement - (30.35 SQM)	Not Applicable	Circulation or storage space.
B00A - R0037 - Dark Room - (23.77 SQM)	Office (5)	
B00A - R1001 - Staff Study - (19.97 SQM)	Office (4)	
B00A - R1006 - Seminar - Type 1 - (21.42 SQM)	Office (5)	
B00A - R1009 - General Learning Space - (66.91 SQM) - Teaching Space: 1	Student Space (37)	
B00A - R1010 - General Learning Space - (67.46 SQM) - Teaching Space: 1	Student Space (37)	
B00A - R1011 - General Learning Space - (69.03 SQM) - Teaching Space: 1	Student Space (38)	
B00A - R1012 - Design L.S. - (65.62 SQM) - Teaching Space: 1	Student Space (36)	
B00A - R1015 - General Learning Space - (65.62 SQM) - Teaching Space: 1	Student Space (36)	
B00A - R1020 - Computer Learning Space - (66.54 SQM) - Teaching Space: 1	Student Space (36)	
B00A - R1028 - Movement - (10.9 SQM)	Not Applicable	Circulation or storage space.
B00A - R1029 - Movement - (163.09 SQM)	Not Applicable	Circulation or storage space.
B00A - R1032 - General Learning Space - (65.69 SQM) - Teaching Space: 1	Student Space (36)	
B00A - R1034 - General Learning Space - (43.99 SQM) - Teaching Space: 1	Student Space (24)	
B00A - R1035 - General Learning Space - (43.47 SQM) - Teaching Space: 1	Student Space (24)	
B00A - R1036 - Movement - (34.3 SQM)	Not Applicable	Circulation or storage space.
B00A - R1037 - Movement - (11.07 SQM)	Not Applicable	Circulation or storage space.
B00A - R1038 - Staff Study - (167.42 SQM)	Office (41)	
B00B - R0009 - Student Reception - (26.18 SQM)	Not Applicable	Circulation or storage space.
B00B - R0019 - Entry - (8.01 SQM)	Not Applicable	Circulation or storage space.
B00B - R0022 - Staff Study - (134.33 SQM)	Office (33)	
B00B - R0023 - Movement - (252.59 SQM)	Not Applicable	Circulation or storage space.
B00B - R0024 - General Learning Space - (63.24 SQM) - Teaching Space: 1	Student Space (35)	
B00B - R0026 - General Learning Space - (63.67 SQM) - Teaching Space: 1	Student Space (35)	
B00B - R0029 - Duplicating Workroom - (35.18 SQM)	Office (8)	
B00B - R0032 - Staff Study - (11.58 SQM)	Office (2)	
B00B - R0034 - Sick Bay - (10.89 SQM)	Student Space (5)	
B00B - R0035 - Entry - (7.82 SQM)	Not Applicable	Circulation or storage space.
B00B - R0037 - Staff Study - (11.54 SQM)	Office (2)	
B00B - R0039 - Sick Bay - (11.02 SQM)	Student Space (5)	
B00B - R0040 - Interview/Meeting - (24.68 SQM)	Office (6)	
B00B - R0043 - Deputy Principal Office - (14.15 SQM)	Office (3)	
B00B - R0044 - Interview/Office - Type 1 - (12.25 SQM)	Office (3)	
B00B - R0045 - Staff Study - (12.73 SQM)	Office (3)	
B00B - R0049 - Principal Office - (21.26 SQM)	Office (5)	

Entity Location	Audit Condition Classification (Capacity)	Comment
B00B - R0050 - Deputy Principal Office - (14.09 SQM)	Office (3)	
B00B - R0051 - Staff Kitchen - (6.62 SQM)	Office (1)	
B00B - R0054 - Staff Kitchen - (17.63 SQM)	Office (4)	
B00B - R0055 - Commonroom - (69.82 SQM)	Office (17)	
B00B - R0056 - Administration - Clerical - (65.36 SQM)	Office (16)	
B00B - R0057 - Administration - Executive - (12.46 SQM)	Office (3)	
B00B - R1001 - General Learning Space - (53.53 SQM) - Teaching Space: 1	Student Space (29)	
B00B - R1002 - General Learning Space - (52.72 SQM) - Teaching Space: 1	Student Space (29)	
B00B - R1004 - General Learning Space - (52.79 SQM) - Teaching Space: 1	Student Space (29)	
B00B - R1006 - Special Learning Space - (52.72 SQM) - Teaching Space: 1	Student Space (29)	
B00B - R1008 - General Learning Space - (52.72 SQM) - Teaching Space: 1	Student Space (29)	
B00B - R1009 - General Learning Space - (52.65 SQM) - Teaching Space: 1	Student Space (29)	
B00B - R1010 - General Learning Space - (53.45 SQM) - Teaching Space: 1	Student Space (29)	
B00B - R1012 - Staff Study - (28.75 SQM)	Office (7)	
B00B - R1013 - General Learning Space - (53.52 SQM) - Teaching Space: 1	Student Space (29)	
B00B - R1015 - General Learning Space - (52.86 SQM) - Teaching Space: 1	Student Space (29)	
B00B - R1016 - General Learning Space - (66.39 SQM) - Teaching Space: 1	Student Space (36)	
B00B - R1018 - General Learning Space - (52.65 SQM) - Teaching Space: 1	Student Space (29)	
B00B - R1020 - General Learning Space - (53.44 SQM) - Teaching Space: 1	Student Space (29)	
B00B - R1021 - Special Learning Space - (39.58 SQM) - Teaching Space: 1	Student Space (22)	
B00B - R1029 - Movement - (225.68 SQM)	Not Applicable	Circulation or storage space.
B00B - R1031 - Entry - (17.6 SQM)	Not Applicable	Circulation or storage space.
B00C - R0019 - Performance Workshop - (87.79 SQM)	Student Space (40)	
B00C - R0020 - Movement - (44.46 SQM)	Not Applicable	Circulation or storage space.
B00D - R0006 - Student Canteen - (63.28 SQM)	Not Applicable	Circulation or storage space.
B00D - R0007 - Movement - (16.34 SQM)	Not Applicable	Circulation or storage space.
B00D - R0015 - Student Canteen - (7.32 SQM)	Not Applicable	Circulation or storage space.
B00D - R0017 - Movement - (66.55 SQM)	Not Applicable	Circulation or storage space.
B00D - R0029 - Movement - (16.12 SQM)	Not Applicable	Circulation or storage space.
B00D - R0032 - Stage - (88.45 SQM)	Not Applicable	Circulation or storage space.
B00D - R0035 - Multi-Purpose Space - (491.63 SQM)	Student Space (228)	
B00D - R1007 - Staff Study - (15.56 SQM)	Office (3)	
B00D - R1008 - Practice/Seminar - (12.57 SQM)	Not Applicable	Circulation or storage space.
B00D - R1014 - Movement - (48.77 SQM)	Not Applicable	Circulation or storage space.
B00D - R1015 - Seminar - Type 1 - (19.95 SQM)	Office (4)	
B00E - R0001 - General Learning Space - (58.63 SQM) - Teaching Space: 1	Student Space (32)	
B00E - R0002 - Preparation - (43.49 SQM)	Not Applicable	Circulation or storage space.
B00E - R0003 - Preparation - (7.47 SQM)	Not Applicable	Circulation or storage space.
B00E - R0008 - Laboratory L.S. - (91.45 SQM) - Teaching Space: 1	Student Space (50)	
B00E - R0009 - Laboratory L.S. - (91.34 SQM) - Teaching Space: 1	Student Space (50)	
B00E - R0013 - Laboratory L.S. - (89.4 SQM) - Teaching Space: 1	Student Space (49)	
B00E - R0014 - General Learning Space - (52.55 SQM) - Teaching Space: 1	Student Space (29)	
B00E - R0015 - Movement - (154.38 SQM)	Not Applicable	Circulation or storage space.
B00E - R0020 - Preparation - Science - (26.47 SQM)	Not Applicable	Circulation or storage space.
B00E - R0021 - Preparation - Science - (29.01 SQM)	Not Applicable	Circulation or storage space.
B00E - R0022 - Entry - (5.17 SQM)	Not Applicable	Circulation or storage space.
B00E - R0023 - Laboratory L.S. - (89.15 SQM) - Teaching Space: 1	Student Space (49)	
B00E - R1009 - Seminar - (12.96 SQM)	Office (3)	
B00E - R1014 - Movement - (18.76 SQM)	Not Applicable	Circulation or storage space.

Entity Location	Audit Condition Classification (Capacity)	Comment
B00E - R1015 - General Learning Space - (58.35 SQM) - Teaching Space: 1	● Student Space (32)	
B00E - R1016 - Entry - (14.46 SQM)	Not Applicable	Circulation or storage space.
B00E - R1018 - Main Area - (347.87 SQM)	Not Applicable	Circulation or storage space.
B00E - R1021 - Movement - (28.76 SQM)	Not Applicable	Circulation or storage space.
B00E - R1029 - Movement - (14.12 SQM)	Not Applicable	Circulation or storage space.
B00E - R1030 - Computer Learning Space - (67.22 SQM) - Teaching Space: 1	● Student Space (37)	
B00E - R1031 - Seminar - (11.08 SQM)	● Office (2)	
B00E - R1032 - Seminar - (10.88 SQM)	● Office (2)	
B00F - R0005 - Movement - (14.01 SQM)	Not Applicable	Circulation or storage space.
B00F - R0011 - Movement - (11.43 SQM)	Not Applicable	Circulation or storage space.
B00F - R0021 - General Assistants - (21.29 SQM)	● Office (5)	
B00F - R0028 - Design L.S. - (65.62 SQM) - Teaching Space: 1	● Student Space (36)	
B00F - R0030 - Materials Technology L.S. - (65.28 SQM) - Teaching Space: 1	● Student Space (36)	
B00F - R0032 - Wood Technology Bay - (24.55 SQM)	Not Applicable	Circulation or storage space.
B00F - R0033 - Materials Technology L.S. - (65.48 SQM) - Teaching Space: 1	● Student Space (36)	
B00F - R0034 - Fitness Laboratory - (65.72 SQM)	● Student Space (30)	
B00F - R0035 - Movement - (60.85 SQM)	Not Applicable	Circulation or storage space.
B00F - R0036 - Movement - (82.91 SQM)	Not Applicable	Circulation or storage space.
B00F - R0037 - Entry - (10.11 SQM)	Not Applicable	Circulation or storage space.
B00F - R0038 - Movement - (5.67 SQM)	Not Applicable	Circulation or storage space.
B00F - R0039 - Movement - (9.06 SQM)	Not Applicable	Circulation or storage space.
B00F - R1001 - Music Learning Space - (67.2 SQM) - Teaching Space: 1	● Student Space (37)	
B00F - R1004 - Practice/Seminar - (17.38 SQM)	Not Applicable	Circulation or storage space.
B00F - R1005 - Movement - (14.13 SQM)	Not Applicable	Circulation or storage space.
B00F - R1007 - Materials Technology L.S. - (83.34 SQM) - Teaching Space: 1	● Student Space (46)	
B00F - R1012 - Movement - (14.07 SQM)	Not Applicable	Circulation or storage space.
B00F - R1020 - Materials Technology L.S. - (82.03 SQM) - Teaching Space: 1	● Student Space (46)	
B00F - R1021 - General Learning Space - (100.5 SQM) - Teaching Space: 1	● Student Space (55)	
B0F1 - R0001 - Movement - (44.21 SQM)	Not Applicable	Circulation or storage space.
B0F1 - R1001 - Movement - (49.55 SQM)	Not Applicable	Circulation or storage space.