

VENTILATION AUDIT REPORT Version 2

| | |
|-------------------------------|--------------------------------------|
| SCHOOL: | Bathurst Public School (1150) |
| AMU REGION: | North Western NSW |
| STATE ELECTORATE: | Bathurst |
| LOCAL GOVERNMENT AREA: | Bathurst |

1150 - Bathurst Public School
Site Plan (10089)

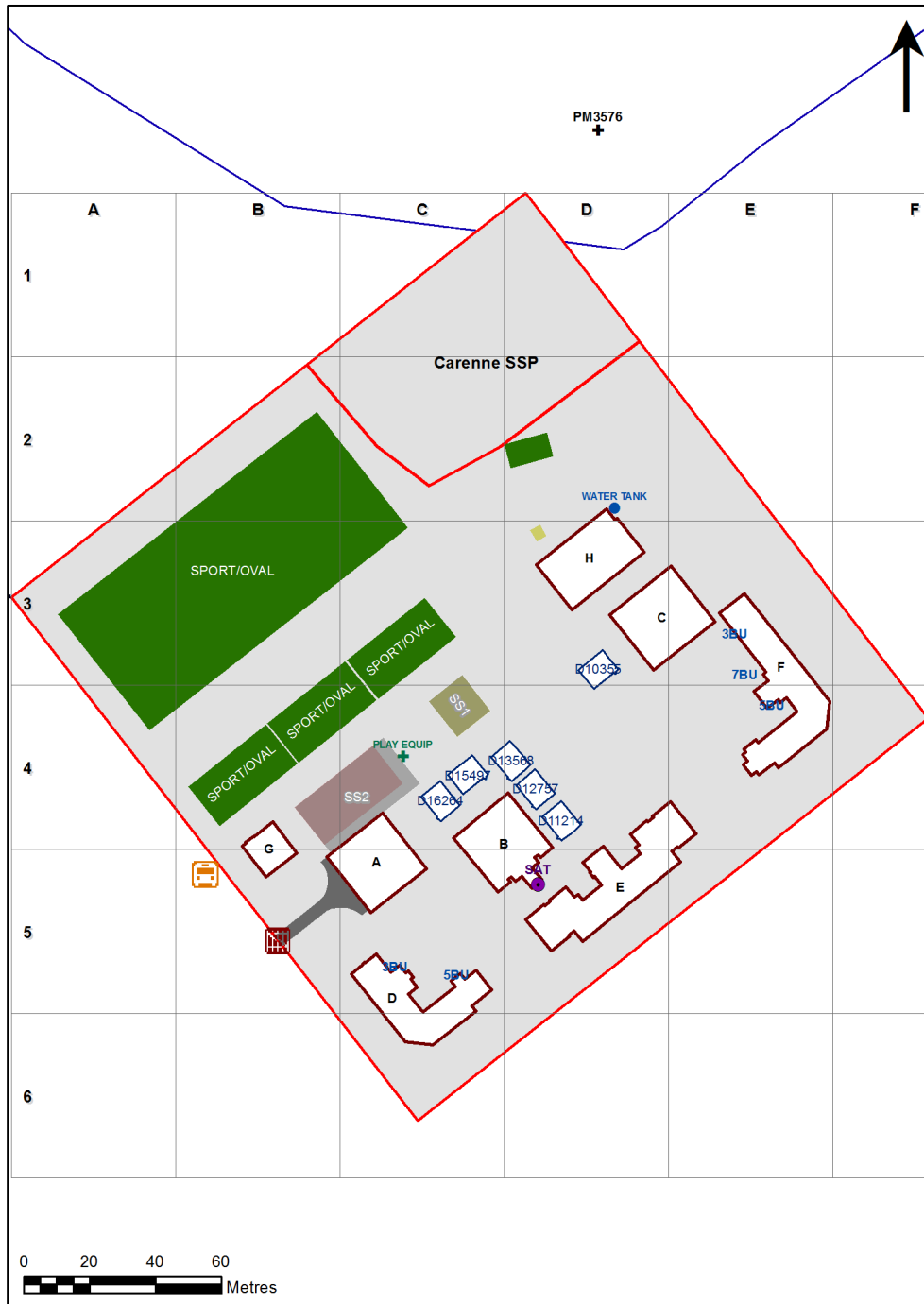

1:1,442

Printed: 21-May-2021

Site plan is indicative only and is included to show building numbers used by the Department.

Ventilation Audit Key

| Category | Description |
|---|--|
|  | Category A Operate this space in line with COVID safe school operations . It has the required level of natural ventilation. NB. Circulation and storage areas should not be used for groups or gatherings. |
|  | Category B This space should be occupied at 1 person per 4m ² to comply with COVID safe school operations and the guided use of spaces . The report details the number of people who can be accommodated safely in each of the identified spaces. |

| Entity Location | Audit Condition Classification (Capacity) | Comment |
|--|---|-------------------------------|
| B00A - R0001 - Movement - (91.66 SQM) | Not Applicable | Circulation or storage space. |
| B00A - R0002 - Movement - (237.57 SQM) | Not Applicable | Circulation or storage space. |
| B00A - R0004 - Canteen - (27.11 SQM) | Not Applicable | Circulation or storage space. |
| B00B - R0001 - Movement - (74.6 SQM) | Not Applicable | Circulation or storage space. |
| B00B - R0002 - Movement - (6.3 SQM) | Not Applicable | Circulation or storage space. |
| B00B - R0003 - Home Base - (72.38 SQM) - Teaching Space: 1 | ● Student Space (51) | |
| B00B - R0004 - Practical Activities - 1hb - (20.47 SQM) | ● Student Space (9) | |
| B00B - R0005 - Home Base - (60.38 SQM) - Teaching Space: 1 | ● Student Space (51) | |
| B00B - R0006 - Practical Activities - 1hb - (17.08 SQM) | ● Student Space (7) | |
| B00B - R0007 - Home Base - (71.69 SQM) - Teaching Space: 1 | ● Student Space (51) | |
| B00B - R0008 - Practical Activities - 1hb - (20.14 SQM) | ● Student Space (9) | |
| B00B - R0009 - Home Base - (60.52 SQM) - Teaching Space: 1 | ● Student Space (51) | |
| B00B - R0010 - Practical Activities - 1hb - (17.22 SQM) | ● Student Space (7) | |
| B00B - R1001 - Reading Area - (209.36 SQM) | ● Student Space (97) | |
| B00B - R1002 - Reading Area - (52.7 SQM) | ● Student Space (24) | |
| B00B - R1012 - Movement - (15.91 SQM) | Not Applicable | Circulation or storage space. |
| B00C - R0001 - Home Base - (92.67 SQM) - Teaching Space: 1 | ● Student Space (67) | |
| B00C - R0003 - Practical Activities - 1hb - (20.07 SQM) | ● Student Space (9) | |
| B00C - R0004 - Home Base - (92.74 SQM) - Teaching Space: 1 | ● Student Space (67) | |
| B00C - R0005 - Practical Activities - 1hb - (20.1 SQM) | ● Student Space (9) | |
| B00C - R0009 - Practical Activities - 1hb - (17.52 SQM) | ● Student Space (8) | |
| B00C - R0011 - Home Base - (86.14 SQM) - Teaching Space: 1 | ● Student Space (47) | |
| B00C - R0012 - Movement - (97.34 SQM) | Not Applicable | Circulation or storage space. |
| B00E - R0003 - Principal - (20.18 SQM) | ● Office (5) | |
| B00E - R0004 - Duplicating Workroom - (46.18 SQM) | ● Office (11) | |
| B00E - R0006 - Movement - (39.26 SQM) | Not Applicable | Circulation or storage space. |
| B00E - R0016 - Movement - (47.04 SQM) | Not Applicable | Circulation or storage space. |
| B00E - R0017 - Home Base - (62.49 SQM) - Teaching Space: 1 | ● Student Space (34) | |
| B00E - R0023 - Deputy Principal - (22.36 SQM) | ● Office (5) | |
| B00E - R0025 - Staff Room Annexe - (21.19 SQM) | ● Office (5) | |
| B00E - R0028 - Movement - (34.46 SQM) | Not Applicable | Circulation or storage space. |
| B00E - R0032 - Staff Kitchen - (21.36 SQM) | ● Office (5) | |
| B00E - R0033 - Staff Room - (54.5 SQM) | ● Office (13) | |
| B00E - R0034 - Special Programs Room - (50.04 SQM) | ● Student Space (23) | |
| B00E - R0035 - Entry Vestibule - (33.92 SQM) | Not Applicable | Circulation or storage space. |
| B00E - R0036 - Clerical Office/Workroom - (62.54 SQM) | ● Office (15) | |
| B00E - R0037 - Clerical Office/Workroom - (17.65 SQM) | ● Office (4) | |
| B00E - R0038 - Clerical Office/Workroom - (28.16 SQM) | ● Office (7) | |
| B00E - R1001 - Home Base - (48.47 SQM) - Teaching Space: 1 | ● Student Space (26) | |
| B00E - R1002 - Home Base - (47.71 SQM) - Teaching Space: 1 | ● Student Space (26) | |
| B00E - R1003 - Home Base - (47.28 SQM) - Teaching Space: 1 | ● Student Space (25) | |
| B00E - R1004 - Home Base - (46.58 SQM) - Teaching Space: 1 | ● Student Space (25) | |
| B00E - R1005 - Home Base - (49.25 SQM) - Teaching Space: 1 | ● Student Space (26) | |
| B00E - R1007 - Movement - (90.15 SQM) | Not Applicable | Circulation or storage space. |
| B00F - R0002 - Movement - (8.67 SQM) | Not Applicable | Circulation or storage space. |
| B00F - R0007 - Home Base - (47.74 SQM) - Teaching Space: 1 | ● Student Space (26) | |
| B00F - R0009 - Staff Room Annexe - (13.83 SQM) | ● Office (3) | |
| B00F - R0011 - Withdrawal Space - 1hb - (22.91 SQM) | ● Student Space (10) | |
| B00F - R0012 - Movement - (87.54 SQM) | Not Applicable | Circulation or storage space. |

| Entity Location | Audit Condition Classification (Capacity) | Comment |
|---|---|-------------------------------|
| B00F - R0015 - Staff Room Annexe - (12.84 SQM) | Office (3) | |
| B00F - R0017 - Movement - (10.21 SQM) | Not Applicable | Circulation or storage space. |
| B00F - R0018 - Staff Room Annexe - (8.72 SQM) | Office (2) | |
| B00F - R0019 - Home Base - (47.15 SQM) - Teaching Space: 1 | Student Space (25) | |
| B00F - R0020 - Home Base - (47.81 SQM) - Teaching Space: 1 | Student Space (26) | |
| B00F - R0029 - Communal Space - (170 SQM) | Student Space (78) | |
| B00F - R0030 - Raised Platform - (26.41 SQM) | Not Applicable | Circulation or storage space. |
| B00F - R1001 - Movement - (7.2 SQM) | Not Applicable | Circulation or storage space. |
| B00F - R1002 - Staff Room Annexe - (11.26 SQM) | Office (2) | |
| B00F - R1003 - Clerical Office/Workroom - (32.44 SQM) | Office (8) | |
| B00F - R1004 - Withdrawal Space - 1hb - (14.59 SQM) | Student Space (6) | |
| B00F - R1005 - Staff Room Annexe - (47.68 SQM) | Office (11) | |
| B00F - R1009 - Interview - (21.58 SQM) | Office (5) | |
| B00F - R1010 - Staff Kitchen - (8.85 SQM) | Office (2) | |
| B00F - R1012 - Movement - (40.35 SQM) | Not Applicable | Circulation or storage space. |
| B00F - R1013 - Home Base - (46.95 SQM) - Teaching Space: 1 | Student Space (25) | |
| B00F - R1014 - Home Base - (47.61 SQM) - Teaching Space: 1 | Student Space (26) | |
| B00F - R1015 - Movement - (25.48 SQM) | Not Applicable | Circulation or storage space. |
| B00F - R1016 - Practical Activities - 1hb - (9.06 SQM) | Student Space (4) | |
| B00F - R9004 - Practical Activities - 1hb - (64.3 SQM) | Student Space (29) | |
| B00G - R0001 - Dental Clinic - (50.38 SQM) | Office (12) | |
| B00G - R0002 - Dental Clinic - (11.95 SQM) | Office (2) | |
| B00G - R0003 - Dental Clinic - (5.13 SQM) | Office (1) | |
| B00G - R0005 - Dental Clinic - (12.78 SQM) | Office (3) | |
| B00G - R0008 - Dental Clinic - (16.32 SQM) | Office (4) | |
| B00G - R0010 - Dental Clinic - (8.88 SQM) | Office (2) | |
| B00G - R0011 - Dental Clinic - (7.85 SQM) | Office (1) | |
| B00H - R0001 - Communal Space - (144.75 SQM) | Student Space (67) | |
| B00H - R0002 - Raised Platform - (59.62 SQM) | Not Applicable | Circulation or storage space. |
| B00H - R0003 - Movement - (5.94 SQM) | Not Applicable | Circulation or storage space. |
| B00H - R0005 - Movement - (11.28 SQM) | Not Applicable | Circulation or storage space. |
| OH 045 17012 - OH 045 17012 - OSHC Hub 45 - (247 SQM) | Student Space (114) | |
| OS 602 10355 - OS 602 10355 - Learning Unit - Standard With P.A.A. - (76 SQM) | Student Space (35) | |
| OS 602 12757 - OS 602 12757 - Learning Unit - Standard With P.A.A. - (76 SQM) | Student Space (35) | |
| OS 602 13568 - OS 602 13568 - Learning Unit - Standard With P.A.A. - (76 SQM) | Student Space (35) | |
| OS 602 15497 - OS 602 15497 - Learning Unit - Standard With P.A.A. - (76 SQM) | Student Space (35) | |
| OS 602 16264 - OS 602 16264 - Learning Unit - Standard With P.A.A. - (76 SQM) | Student Space (35) | |
| OS 603 11214 - OS 603 11214 - Learning Unit - Standard With P.A.A. A/C - (76 SQM) | Student Space (35) | |
| OS 603 15829 - OS 603 15829 - Learning Unit - Standard With P.A.A. A/C - (76 SQM) | Student Space (35) | |