

<b>SCHOOL:</b>	<b>Alma Public School (1028)</b>
<b>AMU REGION:</b>	<b>North Western NSW</b>
<b>STATE ELECTORATE:</b>	<b>Barwon</b>
<b>LOCAL GOVERNMENT AREA:</b>	<b>Broken Hill</b>

1028 - Alma Public School  
Site Plan (10590)

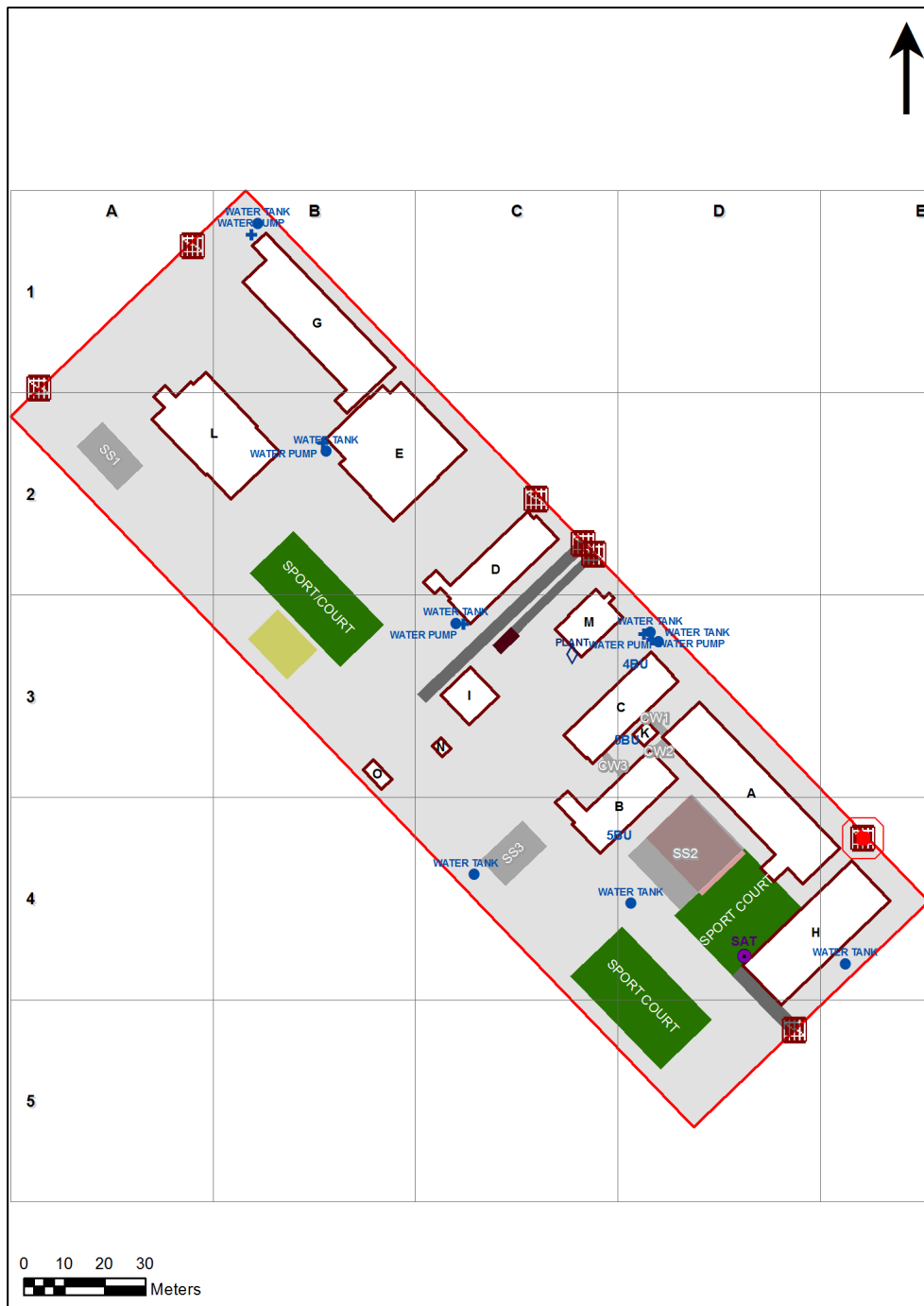

1:1,171

Printed: 20-Mar-2020

Site plan is indicative only and is included to show building numbers used by the Department.

## Ventilation Audit Key

Category	Description
	Category A Operate this space in line with <a href="#">COVID safe school operations</a> . It has the required level of natural ventilation. NB. Circulation and storage areas should not be used for groups or gatherings.
	Category B This space should be occupied at 1 person per 4m <sup>2</sup> to comply with <a href="#">COVID safe school operations and the guided use of spaces</a> . The report details the number of people who can be accommodated safely in each of the identified spaces.

Entity Location	Audit Condition Classification (Capacity)	Comment
B00A - R0003 - Home Base - (56.95 SQM) - Teaching Space: 1	● Student Space (31)	
B00A - R0004 - Movement - (6.41 SQM)	Not Applicable	Circulation or storage space.
B00A - R0005 - Home Base - (57.11 SQM) - Teaching Space: 1	● Student Space (31)	
B00A - R0008 - Movement - (13.32 SQM)	Not Applicable	Circulation or storage space.
B00A - R0012 - Home Base - (56.79 SQM) - Teaching Space: 1	● Student Space (31)	
B00A - R0013 - Home Base - (57.03 SQM) - Teaching Space: 1	● Student Space (31)	
B00A - R0016 - Movement - (13.49 SQM)	Not Applicable	Circulation or storage space.
B00A - R0019 - Home Base - (56.79 SQM) - Teaching Space: 1	● Student Space (31)	
B00A - R0020 - Movement - (218.33 SQM)	Not Applicable	Circulation or storage space.
B00A - R1003 - Home Base - (56.65 SQM) - Teaching Space: 1	● Student Space (31)	
B00A - R1004 - Movement - (6.51 SQM)	Not Applicable	Circulation or storage space.
B00A - R1005 - Home Base - (56.8 SQM) - Teaching Space: 1	● Student Space (31)	
B00A - R1008 - Movement - (13.37 SQM)	Not Applicable	Circulation or storage space.
B00A - R1012 - Home Base - (56.64 SQM) - Teaching Space: 1	● Student Space (31)	
B00A - R1013 - Home Base - (56.87 SQM) - Teaching Space: 1	● Student Space (31)	
B00A - R1016 - Movement - (13.64 SQM)	Not Applicable	Circulation or storage space.
B00A - R1019 - Home Base - (56.95 SQM) - Teaching Space: 1	● Student Space (31)	
B00A - R1020 - Movement - (192.68 SQM)	Not Applicable	Circulation or storage space.
B00A - R1021 - Movement - (17.4 SQM)	Not Applicable	Circulation or storage space.
B00B - R0001 - Movement - (38.17 SQM)	Not Applicable	Circulation or storage space.
B00B - R0003 - Raised Platform - (22.56 SQM)	Not Applicable	Circulation or storage space.
B00B - R0004 - Communal Space - (135.44 SQM)	● Student Space (62)	
B00B - R0008 - Movement - (7.01 SQM)	Not Applicable	Circulation or storage space.
B00B - R1001 - Movement - (47.63 SQM)	Not Applicable	Circulation or storage space.
B00B - R1005 - Home Base - (53.73 SQM) - Teaching Space: 1	● Student Space (29)	
B00B - R1006 - Home Base - (53.65 SQM) - Teaching Space: 1	● Student Space (29)	
B00B - R1007 - Home Base - (53.87 SQM) - Teaching Space: 1	● Student Space (29)	
B00C - R0001 - Movement - (52.25 SQM)	Not Applicable	Circulation or storage space.
B00C - R0004 - Special Programs Room - (71.94 SQM)	● Student Space (33)	
B00C - R1001 - Movement - (51.97 SQM)	Not Applicable	Circulation or storage space.
B00C - R1002 - Staff Room Annexe - (22.6 SQM)	● Office (5)	
B00C - R1003 - Home Base - (53.72 SQM) - Teaching Space: 1	● Student Space (29)	
B00C - R1004 - Staff Room - (122.51 SQM)	● Office (30)	
B00D - R1001 - Movement - (66.04 SQM)	Not Applicable	Circulation or storage space.
B00D - R1002 - Movement - (9.2 SQM)	Not Applicable	Circulation or storage space.
B00D - R1005 - Reading Area - (85.95 SQM)	● Student Space (39)	
B00D - R1006 - Reading Area - (84.74 SQM)	● Student Space (39)	
B00E - R0001 - Movement - (79.36 SQM)	Not Applicable	Circulation or storage space.
B00E - R0002 - Withdrawal Space - 1hb - (39.49 SQM)	● Student Space (18)	
B00E - R0003 - Staff Room Annexe - (10.11 SQM)	● Office (2)	
B00E - R0005 - Movement - (15.62 SQM)	Not Applicable	Circulation or storage space.
B00E - R0006 - Special Programs Room - (41.06 SQM)	● Student Space (19)	
B00E - R0008 - Home Base - (106.03 SQM) - Teaching Space: 1	● Student Space (59)	
B00E - R0009 - Communal Space - (84.13 SQM)	● Student Space (39)	
B00E - R0010 - Raised Platform - (9.04 SQM)	Not Applicable	Circulation or storage space.
B00E - R0011 - Home Base - (41.3 SQM) - Teaching Space: 1	● Student Space (23)	
B00E - R0012 - Withdrawal Space - 1hb - (37.05 SQM)	● Student Space (17)	
B00E - R0014 - Movement - (38.51 SQM)	Not Applicable	Circulation or storage space.
B00E - R0015 - Movement - (13.66 SQM)	Not Applicable	Circulation or storage space.
B00G - R0001 - Home Base - (56.36 SQM) - Teaching Space: 1	● Student Space (31)	
B00G - R0003 - Movement - (16.36 SQM)	Not Applicable	Circulation or storage space.

Entity Location	Audit Condition Classification (Capacity)	Comment
B00G - R0005 - Home Base - (56.21 SQM) - Teaching Space: 1	● Student Space (31)	
B00G - R0007 - Staff Room Annexe - (16.29 SQM)	● Office (4)	
B00G - R0012 - Movement - (35.23 SQM)	Not Applicable	Circulation or storage space.
B00G - R0013 - Staff Room Annexe - (32.18 SQM)	● Office (8)	
B00G - R0014 - Staff Room Annexe - (22.54 SQM)	● Office (5)	
B00G - R0015 - Movement - (180.96 SQM)	Not Applicable	Circulation or storage space.
B00G - R0016 - Movement - (15.16 SQM)	Not Applicable	Circulation or storage space.
B00G - R1001 - Home Base - (56.21 SQM) - Teaching Space: 1	● Student Space (31)	
B00G - R1003 - Movement - (16.18 SQM)	Not Applicable	Circulation or storage space.
B00G - R1005 - Home Base - (56.22 SQM) - Teaching Space: 1	● Student Space (31)	
B00G - R1006 - Home Base - (56.21 SQM) - Teaching Space: 1	● Student Space (31)	
B00G - R1008 - Movement - (12.91 SQM)	Not Applicable	Circulation or storage space.
B00G - R1011 - Home Base - (56.21 SQM) - Teaching Space: 1	● Student Space (31)	
B00G - R1012 - Movement - (180.02 SQM)	Not Applicable	Circulation or storage space.
B00H - R0001 - Principal - (18.95 SQM)	● Office (4)	
B00H - R0004 - Deputy Principal - (12.91 SQM)	● Office (3)	
B00H - R0006 - Entry Vestibule - (17.24 SQM)	Not Applicable	Circulation or storage space.
B00H - R0007 - Clerical Office - (13.26 SQM)	● Office (3)	
B00H - R0008 - Sick Bay - (7.68 SQM)	● Student Space (3)	
B00H - R0009 - Staff Room Annexe - (7.76 SQM)	● Office (1)	
B00H - R0013 - Movement - (14.93 SQM)	Not Applicable	Circulation or storage space.
B00H - R0014 - Duplicating Workroom - (38.54 SQM)	● Office (9)	
B00H - R0017 - Staff Kitchen - (12.4 SQM)	● Office (3)	
B00H - R0018 - Staff Room - (105.67 SQM)	● Office (26)	
B00H - R0019 - Movement - (168.47 SQM)	Not Applicable	Circulation or storage space.
B00I - R0005 - Canteen - (28.34 SQM)	Not Applicable	Circulation or storage space.
B00I - R0006 - Movement - (51.8 SQM)	Not Applicable	Circulation or storage space.
B00J - R0001 - Movement - (9.08 SQM)	Not Applicable	Circulation or storage space.
B00J - R0002 - Movement - (56.82 SQM)	Not Applicable	Circulation or storage space.
B00J - R0003 - Movement - (9.05 SQM)	Not Applicable	Circulation or storage space.
B00J - R0007 - Home Base - Pre - (51.82 SQM) - Teaching Space: 1	● Student Space (29)	
B00J - R0008 - Practical Activities - Pre - (38.8 SQM)	● Student Space (18)	
B00J - R0010 - Home Base - Pre - (46.6 SQM) - Teaching Space: 1	● Student Space (25)	
B00J - R0011 - Practical Activities - Pre - (36.72 SQM)	● Student Space (17)	
B00J - R1001 - Movement - (75.6 SQM)	Not Applicable	Circulation or storage space.
B00J - R1002 - Staff Kitchen - (10.18 SQM)	● Office (2)	
B00J - R1006 - Movement - (34.74 SQM)	Not Applicable	Circulation or storage space.
B00L - R0014 - Communal Space - (238.59 SQM)	● Student Space (110)	
B00M - R0002 - Movement - (5.18 SQM)	Not Applicable	Circulation or storage space.
B00M - R0003 - Movement - (11.92 SQM)	Not Applicable	Circulation or storage space.
B00M - R0006 - Clerical Office - (12.76 SQM)	● Office (3)	
B00M - R0009 - Clerical Office - (16.81 SQM)	● Office (4)	