



Artist impression of the Yass High School upgrade

Yass High School

Project update

April 2021

Investing in our schools

The NSW Government is investing \$7 billion over the next four years, continuing its program to deliver more than 200 new and upgraded schools to support communities across NSW. This is the largest investment in public education infrastructure in the history of NSW.

The NSW Department of Education is committed to delivering new and upgraded schools for communities across NSW. The delivery of these important projects is essential to the future learning needs of our students and supports growth in the local economy.

Project overview

An upgrade is underway for a new multi-purpose hall at Yass High School.

The hall will include a full size basketball court, storage, stage and amenities.

Progress summary

- Tenders have been received for the construction contract and are being assessed.
- The schematic designs have been finalised.
- The Development Application has been lodged.

Next steps

The Development Application (DA) has been lodged with Yass Valley Council. The application can be viewed through the Yass Valley Council webpage and community can provide a submission during the public exhibition period.

<https://www.yassvalley.nsw.gov.au/our-council/public-consultation/development-applications/>

Preparation of the site may start soon after award of the construction contract. This includes the removal of the existing covered basketball court. The main construction work will start after planning approval is granted.

Equipment used will include but not be limited to concrete trucks and excavators.

The Department of Education is committed to ensuring that work is completed safely and efficiently and with minimal impact to the local community.

Thank you for your cooperation during this important work.

For more information contact:

School Infrastructure NSW
Email: schoolinfrastructure@det.nsw.edu.au
Phone: 1300 482 651
www.schoolinfrastructure.nsw.gov.au

Schematic design of new hall

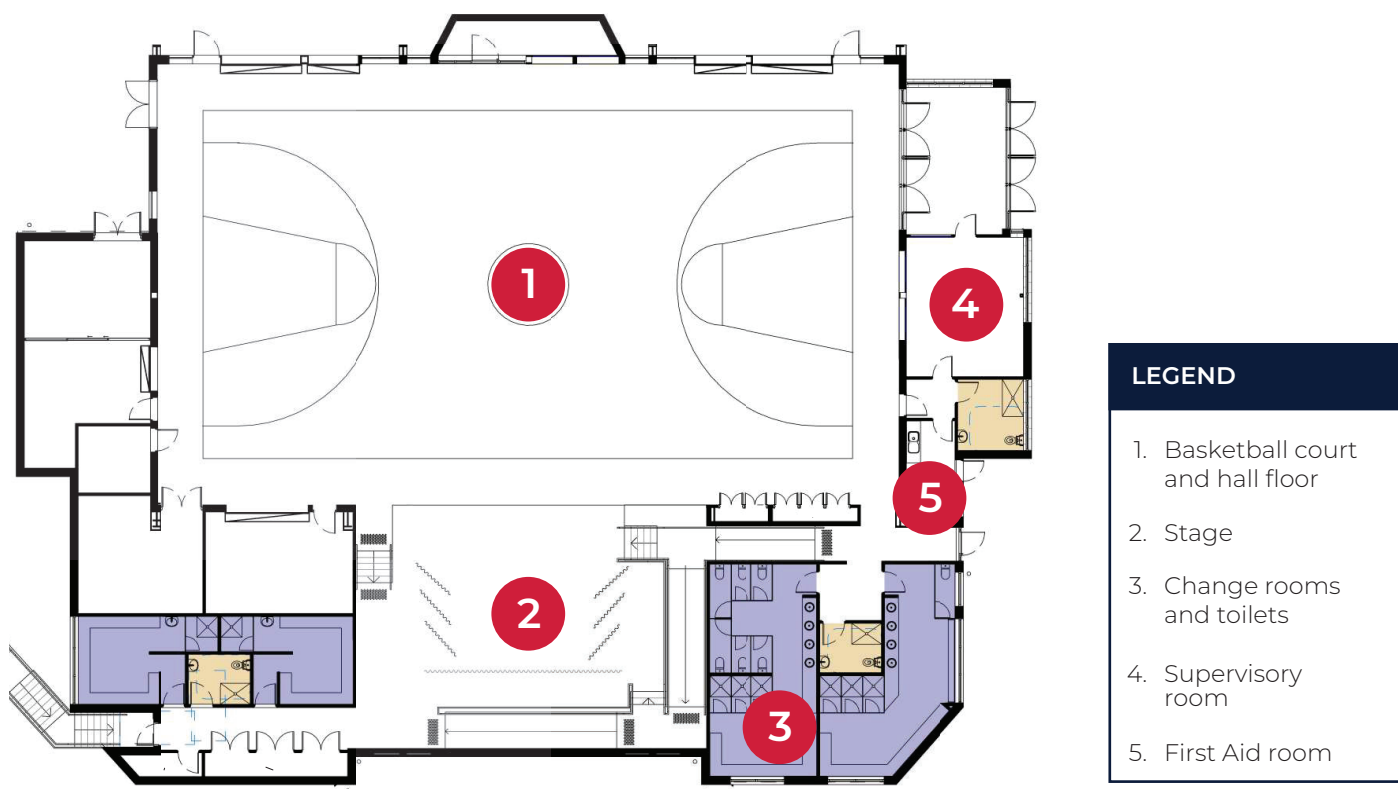

Frequently asked questions

When will the school hall be complete?

The school hall is planned to be ready for Day One, Term One, 2022, subject to planning approval.

Where will the hall be located?

The new hall will be located next to the new STEM building, at the location of the existing covered basketball court.

The current covered basketball court will be demolished and materials kept for possible relocation.

Will community groups be able to access the new hall?

At this stage, there are no formal partnerships with community groups and the new hall. Community groups who have an interest in using the new hall should contact the school.

What safety measures are in place?

The health and safety of the community is our highest priority. Temporary fencing will be erected around the construction site to secure the area and prevent public access.

All work will be undertaken in accordance with SafeWork NSW regulation. The site will be continually monitored during the project to ensure the equipment is safely stored and the site is secure.

At the NSW Department of Education, we recognise the traditional custodians of the lands and waterways where we work and live. We celebrate the First Peoples' unique cultural and spiritual relationship to Country and acknowledge the significance of Aboriginal cultures in Australia.

For more information contact:

School Infrastructure NSW
Email: schoolinfrastructure@det.nsw.edu.au
Phone: 1300 482 651
www.schoolinfrastructure.nsw.gov.au