

# Wentworth Point new high school

Works notification | 10 March 2023

## Extension to changes in pedestrian access on Burroway Road

The footpath closure on a portion of Burroway Road, from the roundabout to our Gate 2 Entry, will be extended until the end of 2023/early 2024. This is due to work that will continue to obstruct the footpath in the coming months, including the construction of retaining walls, and to minimise the community's exposure to structure and façade works. Previous communications about the path closure noted an end date of 28 March 2023.

Pedestrians will be able to continue to use the alternate route outlined in the image below. Fencing and signage will remain around the section of closed footpath. Standard traffic control also remains in place for deliveries.

This is in line with our Construction Traffic and Pedestrian Management Sub-Plan available on our website.

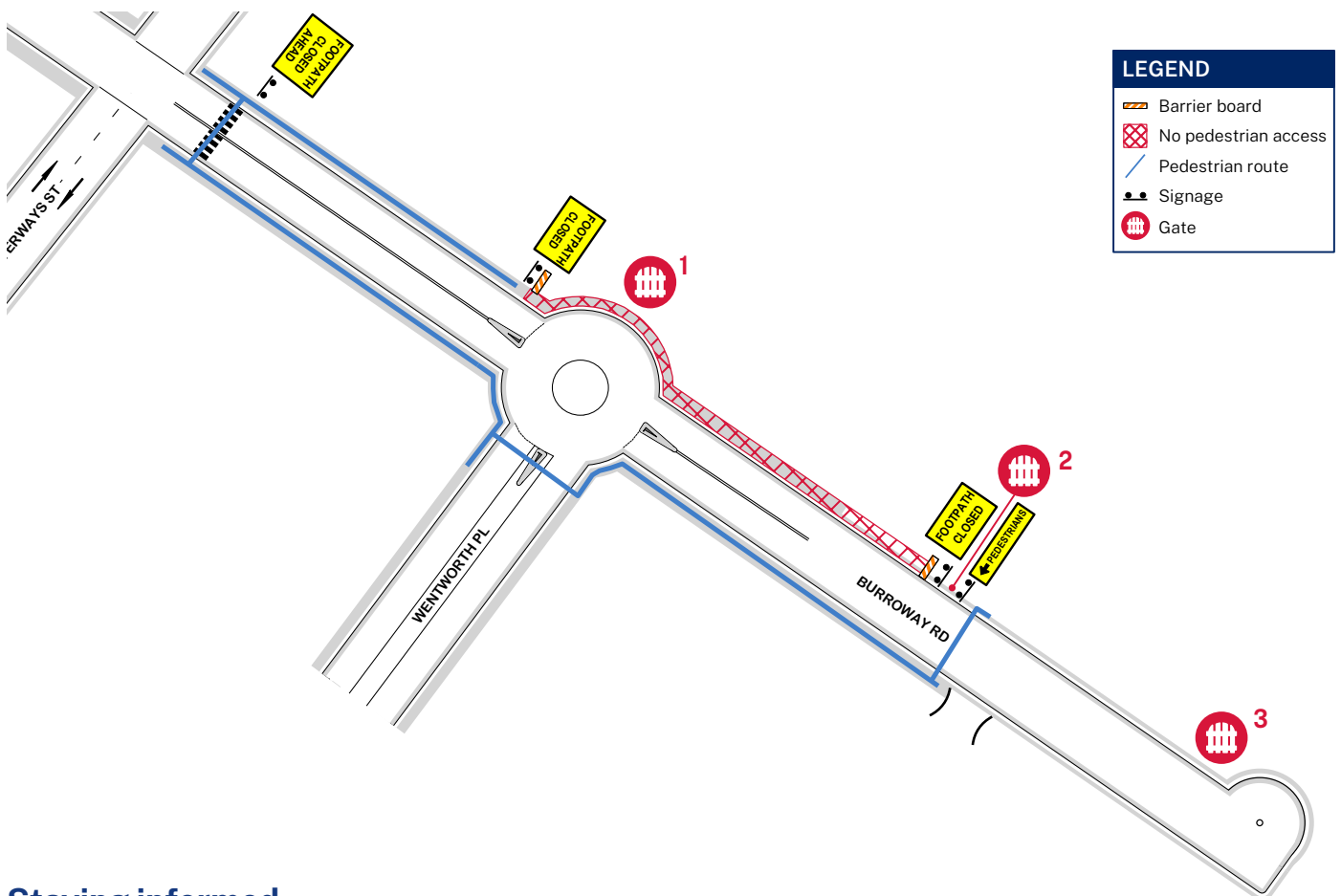

## Staying informed

School Infrastructure NSW will continue to share updates as the project progresses. Visit the project website at [edu.nsw.link/WPNHS](https://edu.nsw.link/WPNHS) for all the project details, project updates and documentation or register via the form on the 'Get involved' tab to have project updates and notifications like this emailed to you.

Thank you for your patience while we deliver this important new school infrastructure.